

COMPACT AND GRADE FREEZER AREAS TO ELEVATION = 98'-7"
 COMPACT AND GRADE COOLERS, DOCK AND MECHANICAL AREAS TO ELEVATION = 99'-6"
 COMPACT AND GRADE DOCK OFFICES / EMPLOYEE AREAS TO ELEVATION = 99'-8"

KEY NOTES

- R1** STEEL STORAGE RACKING TO BE REMOVED ENTIRE AREA OF INTERIOR RENOVATIONS REFER TO RACK PLAN AND SPECIFICATIONS FOR DISPOSAL OR STORAGE REQUIREMENTS.
- D1** INTERIOR INSULATED WALL PANEL AND STEEL GIRTS ALONG WITH PANEL CLIPS AT ROOF FRAMING AND CONCRETE CURBS AT BASE TO BE REMOVED.
- D2** INTERIOR FREEZER WALL PANEL ALONG WITH CONCRETE CURBS AT BASE TO BE REMOVED. CEILING PANELS TO REMAIN THIS AREA PROVIDE ADDITIONAL EDGE SUPPORT PRIOR TO WALL PANEL REMOVAL.
- D3** INTERIOR FREEZER WALL PANEL TO BE REMOVED TO ELEVATION 127'-6". EXISTING STEEL GIRTS ARE TO BE REMOVED. REMAINING WALL PANEL (THROUGH ROOF) IS TO BE FASTENED TO TOP CONNECTION - REFER TO SECTIONS A4.2 - CONCRETE CURBS AT BASE ARE TO BE REMOVED.
- D4** INTERIOR INSULATED WALL PANEL TO BE REMOVED TO BOTTOM OF ADJACENT LOW ROOF STRUCTURE - FIELD VERIFY ELEVATION EXISTING STEEL GIRTS ARE TO BE RAISED TO SUPPORT REMAINING WALL PANEL (THROUGH ROOF) CONCRETE CURBS AT BASE TO BE REMOVED.
- D5** AREA OF INTERIOR INSULATED CEILING PANEL REMOVAL. COORDINATE EXACT LIMITS WITH NEW WALL PLACEMENT REFER TO A1.2 AND A4.2 - PROVIDE NEW SUPPORTS AT REMAINING EDGE.
- D6** DOCK EQUIPMENT - LEVELERS, BUMPERS, TRUCK RESTRAINTS OVERHEAD DOORS AND LEVELER PITS TO BE REMOVED.
- D7** MASONRY WALL AND FOUNDATIONS TO BE REMOVED TO ELEVATION 98'-0" REFER TO STRUCTURAL DRAWINGS.
- D8** MASONRY WALL / STUD WALL ABOVE TO ROOF DECK AND FOUNDATIONS TO BE REMOVED TO ELEVATION 99'-0".
- D9** EXTERIOR WALL PANEL TO BE REMOVED - ROOF EDGE METALS TO REMAIN.
- D10** INTERIOR INSULATED WALL PANEL AND STEEL GIRTS ALONG WITH PANEL CLIPS AT ROOF FRAMING AND CONCRETE CURBS AT BASE TO BE REMOVED. STEEL DECKING AND ROOFING TO BE REMOVED AT H/L/O - ROOF REFER TO SECTION E/A4.2.
- D11** BELOW SLAB REMOVAL: 24" CONCRETE ENCASED FLOOR WARMING TUBE TO BE REMOVED - COMPACT AND GRADE AREA TO ELEVATION = 98'-7".
- D12** SOIL THIS AREA IS TO BE REMOVED TO ELEVATION 95'-0" COMPACT AND GRADE TO 99'-7" WITH NEW STRUCTURAL FILL. FIELD VERIFY EXTENT OF REMOVAL (AREA OF FROZEN SUB-MATERIAL).
- D13** DOOR UNIT FRAME AND ASSOCIATED SUPPORTS TO BE REMOVED (AT EXTERIOR DOOR STAIRS, ETC TO BE REMOVED).
- D14** AT NEW EXTERIOR FREEZER DOOR LOCATIONS SAWCUT AND REMOVE FOUNDATION WALL TO ELEVATION 98'-11"

SLAB REMOVAL NOTES

- S1** PERIMETER CONCRETE CURBS TO BE REMOVED. 8" CONCRETE SLAB AND SUBGRADE TO BE REMOVED TO 5" FROM FACE OF EXTERIOR WALL PANEL (FACE OF FOUNDATION) GRADE AREA TO ELEVATION 98'-7" REFER TO SECTIONS A4.1 - REFER TO STRUCTURAL DRAWINGS FOR COLUMN FOUNDATION REPLACEMENT.
- S2** PERIMETER CONCRETE CURBS TO BE REMOVED. 5" CONCRETE WEARING SLAB TO BE REMOVED TO FACE OF WALL PANEL. 8" RIGID INSULATION TO BE REMOVED AND 2" CONCRETE SLAB TO BE REMOVED TO 7" OF PANEL FACE. GRADE TO ELEVATION 98'-7" REFER TO SECTIONS A4.3 - REFER TO STRUCTURAL DRAWINGS FOR COLUMN FOUNDATION REPLACEMENT AT EXTERIOR COLUMNS (V1, V2, V6, V9, U1, T1, S1 AND R1) SAWCUT AND REMOVE FREEZER SUB SLAB TO A MINIMUM OF 24" FROM FACE OF COLUMN WOOD THERMAL ISOLATION BASE BEARING BLOCK.
- S3** PERIMETER CONCRETE CURBS TO BE REMOVED. 6" CONCRETE WEARING SLAB TO BE REMOVED TO FACE OF WALL PANEL. 8" RIGID INSULATION TO BE REMOVED AND 4" CONCRETE SLAB TO BE REMOVED TO 7" OF PANEL FACE. GRADE TO ELEVATION 98'-7".
- S4** 7" CONCRETE SLAB TO BE REMOVED - CONCRETE CURBS TO REMAIN AT MECHANICAL ROOM EXTERIOR WALLS - REMOVE CURBS AT DOCK AREA.
- S5** CONCRETE PLANKS AT FLOOR PIT - 6" CONCRETE SLAB AND SUB GRADE TO BE REMOVED TO ELEVATION 98'-0". ROOM PERIMETER AIR TUNNEL WALLS AND PIT FOUNDATION WALLS ARE TO BE REMOVED TO ELEVATION 98'-0" - GRADE AREA TO ELEVATION = 98'-7". REFER TO STRUCTURAL DRAWINGS FOR ADDITIONAL INFORMATION.
- S6** 6" CONCRETE SLAB AND SUBGRADE TO BE REMOVED TO ELEVATION 98'-7" REFER TO SECTIONS A4.1 - REFER TO STRUCTURAL DRAWINGS FOR COLUMN FOUNDATION REPLACEMENT.
- S7** 6" CONCRETE SLAB TO BE REMOVED.
- S8** FOUNDATION WALL TO BE REMOVED TO ELEVATION 98'-0".

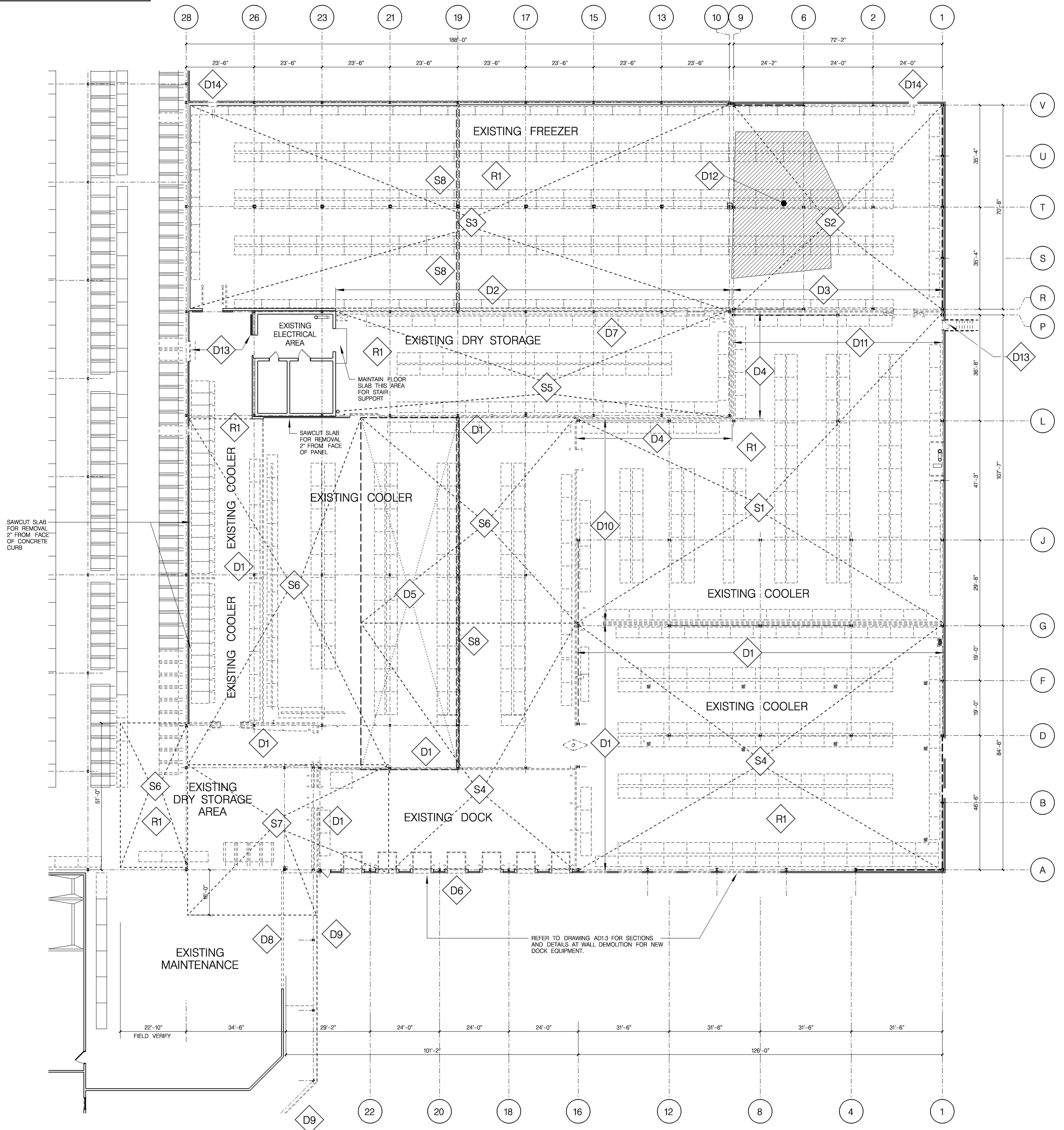

DEMOLITION FLOOR PLAN: WAREHOUSE RENOVATION

SCALE: 1/8" = 1'-0"
 EXISTING WAREHOUSE FINISH FLOOR CALLED ELEVATION = 100'-0"

GENERAL DEMOLITION NOTES:
 REFER TO DRAWINGS AD1.2, AD1.3, AND A2.2 FOR ADDITIONAL DEMOLITION INFORMATION.
 REFER TO PLUMBING, MECHANICAL AND ELECTRICAL DRAWINGS FOR ADDITIONAL DEMOLITION INFORMATION.
 REFER TO STRUCTURAL DRAWINGS FOR AREAS OF STRUCTURAL BRACING REMOVAL / REPLACEMENT.

e:\jls\barber\cgm\aed1_1\baed1_1.dgn
 11-17-04

Warehouse and Office Renovations for :		BARBER FOODS	
		Portland, Maine	
DEMOLITION FLOOR PLAN:		WAREHOUSE RENOVATIONS	
DATE: 11-17-04	DESIGNED BY: jls	PLANNERS • ENGINEERS • BUILDERS	FOOD TECH STRUCTURES, LLC
DRAWN BY: pcs/AJpc	CHECKED BY: dsW		2100 WASHINGTON STREET HANOVER, MA 02339 Tel: (781) 261-9700 Fax: (781) 261-9701
DRAWING NO. AD1.1		0412	