

EXISTING PALLET RACK FLOOR PLAN

SCALE: 1/32"=1'-0"

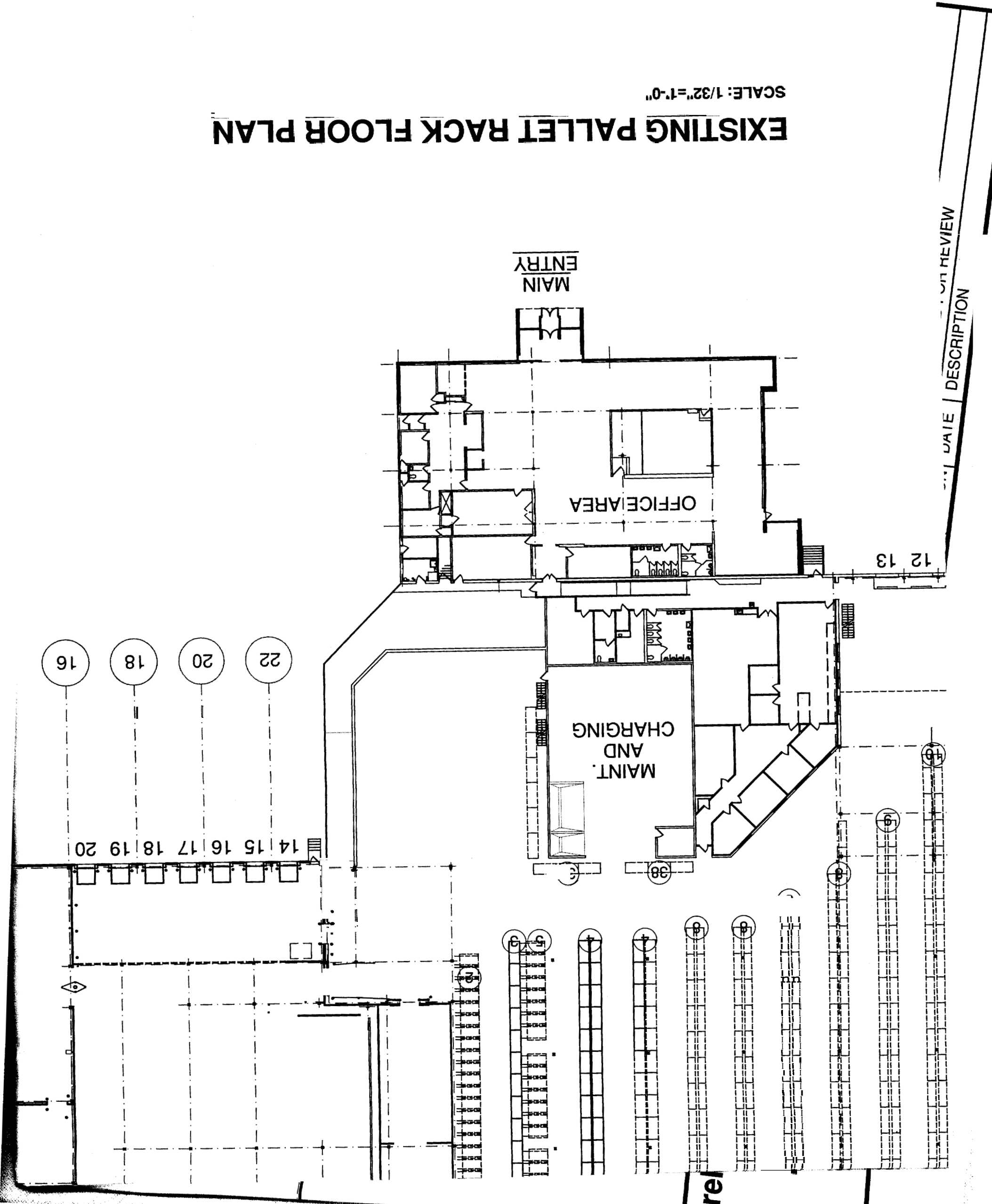

MAIN ENTRY

OFFICE AREA

MAINT. AND CHARGING

12 13

16 18 20 22

14 15 16 17 18 19 20

DATE DESCRIPTION

re/

0412

PR-1.1

DRAWING NO.

DATE: 01-13-05

DESIGNED BY: fts

DRAWN BY: MN

CHECKED BY: DSW

FOOD TECH

PLANNERS • ENGINEERS • BUILDERS

FOOD TECH STRUCTURES, LLC

2100 WASHINGTON STREET
 HANOVER, MA 02339
 Tel: (781) 261-9700
 Fax: (781) 261-9701

STING PALLET RACK

FLOOR PLAN

DEPT. OF BUILDING INSPECTION
 CITY OF PORTLAND, ME

JAN 25 2005

RECEIVED

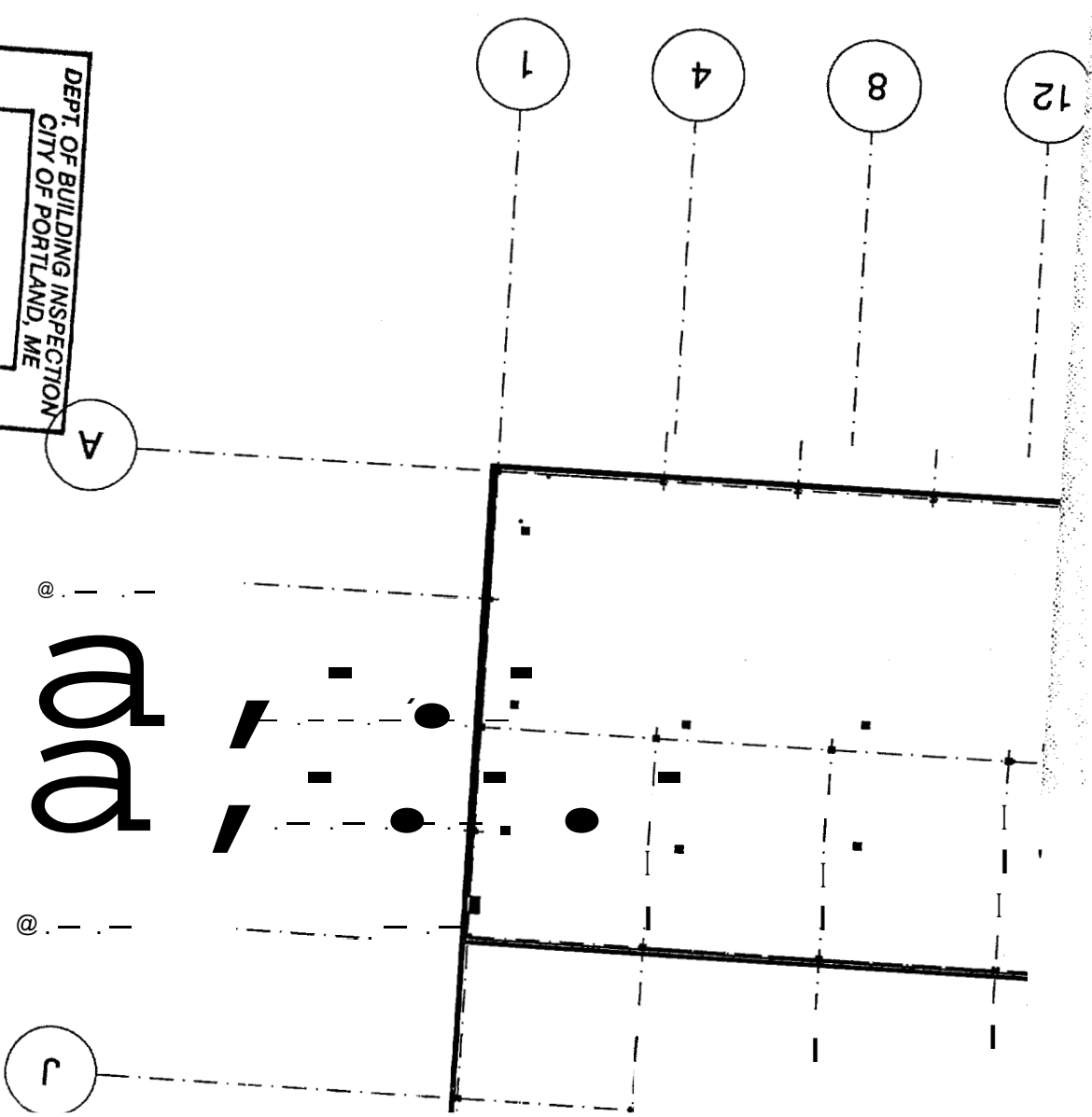

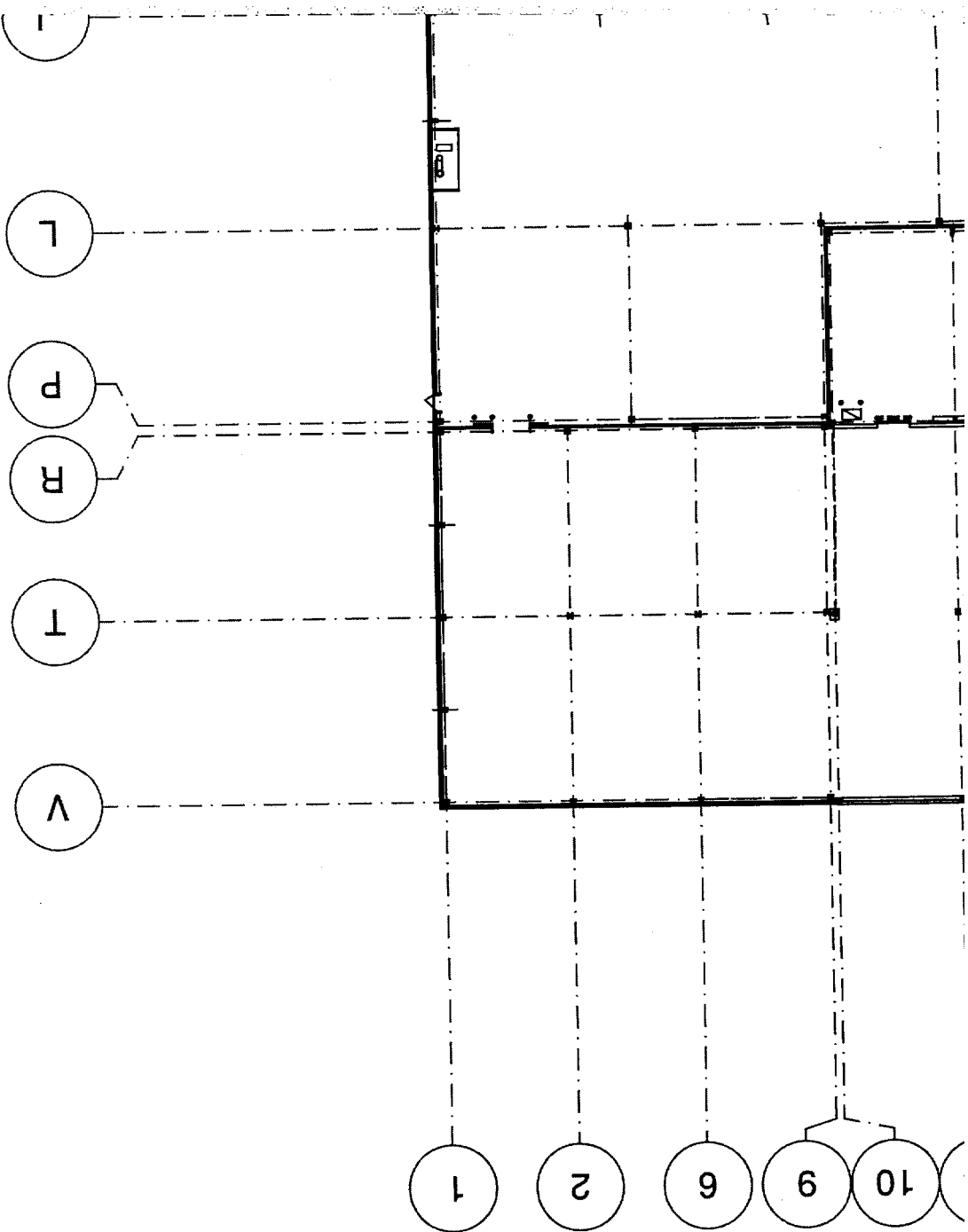

Warehouse & Office Renovations for:

BARBER FOODS

Portland, Maine

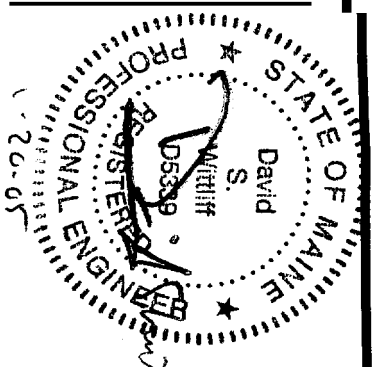

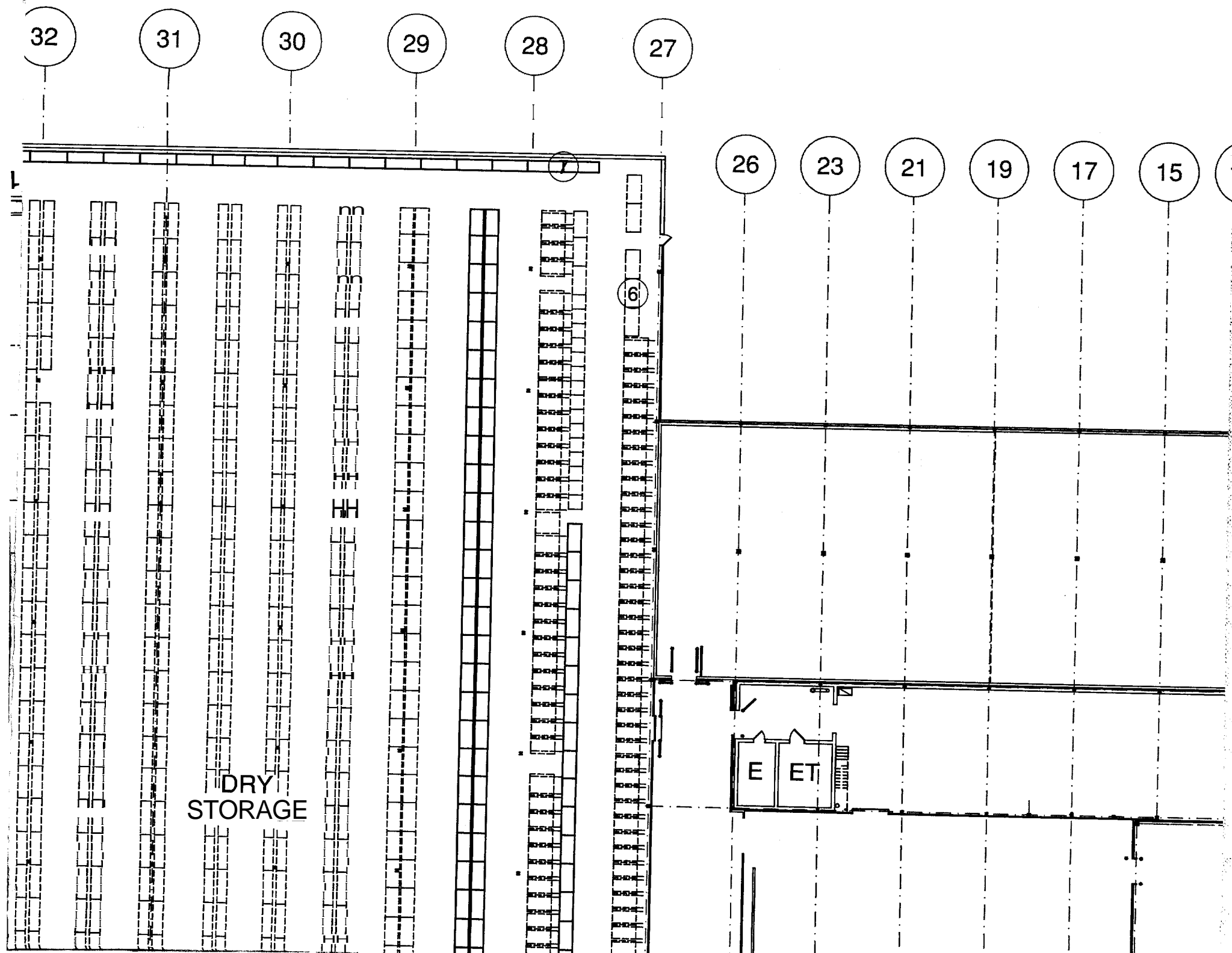

ACTION	DATE	DESCRIPTION
B	01-14-05	RELEASED FOR REVIEW
A	10-12-04	RELEASED FOR REVIEW

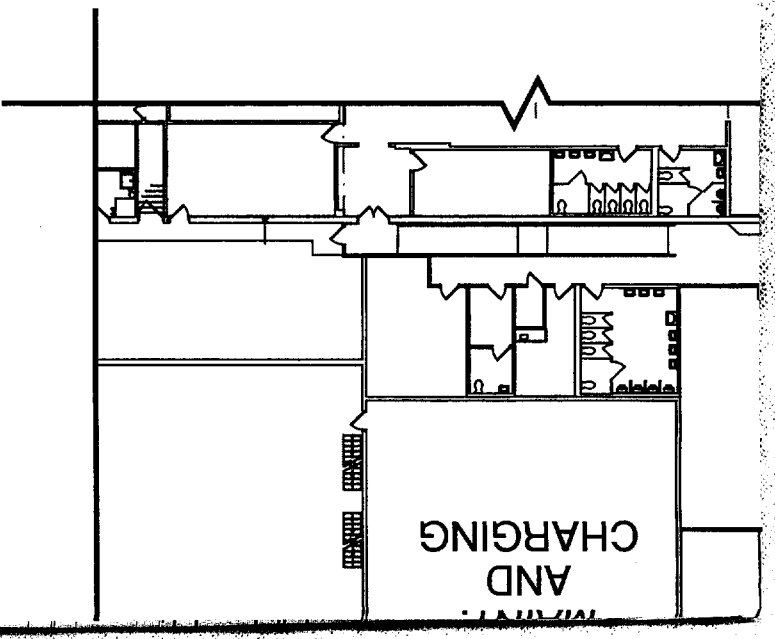

LAYOUT



- LEGEND**
-  RACK - DEMO
 -  RACK - RELOCATED
 -  RACK - EXISTING

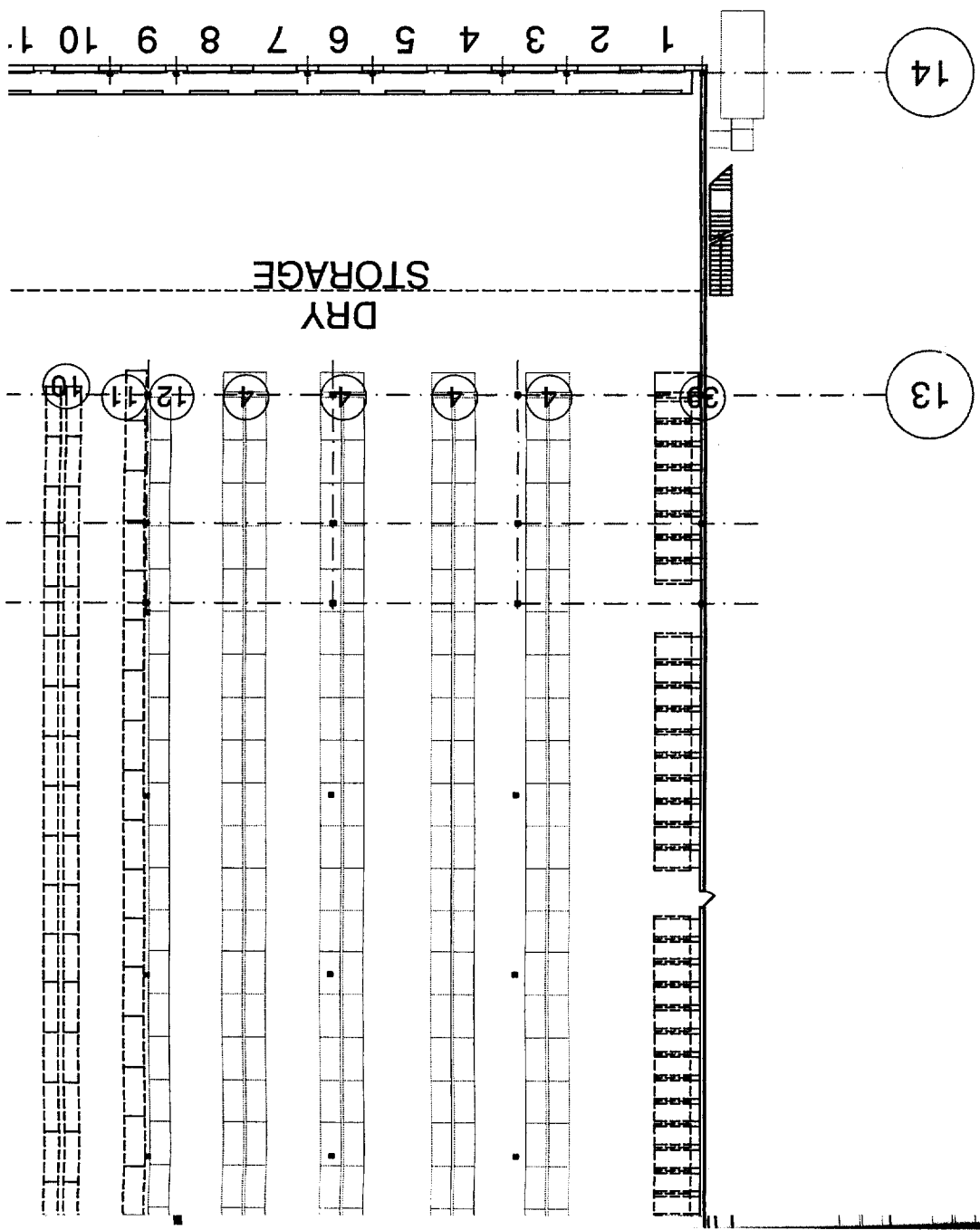

PALLET RACK PART PLAN - NE

SCALE: 1/32"=1'-0"

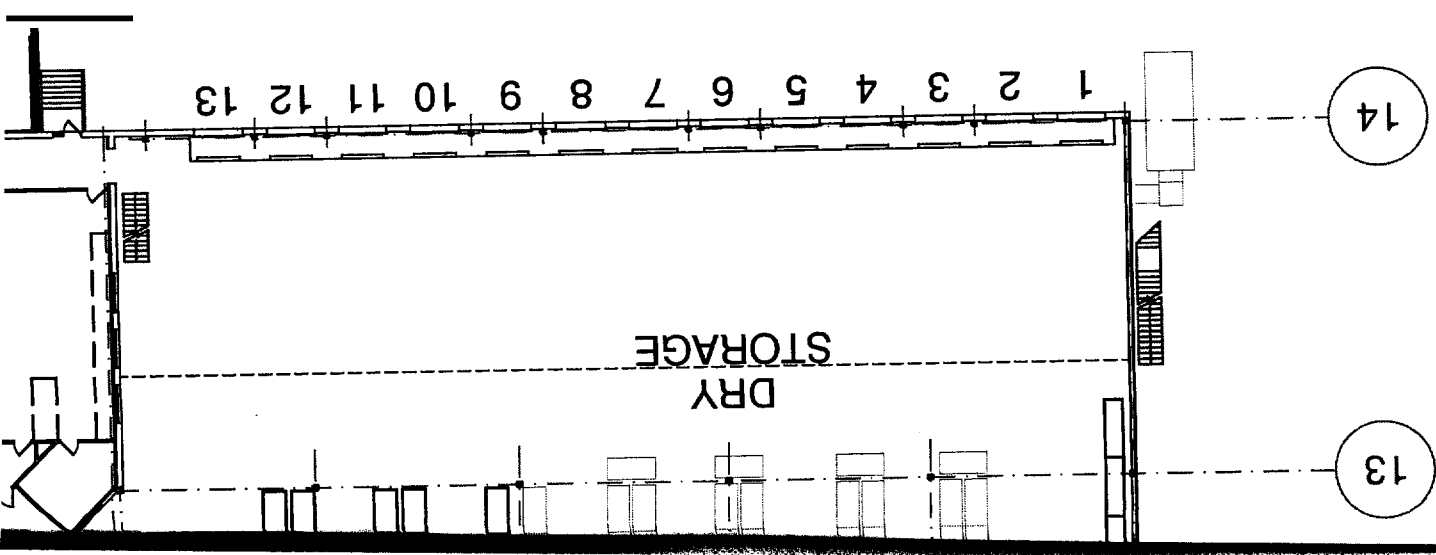

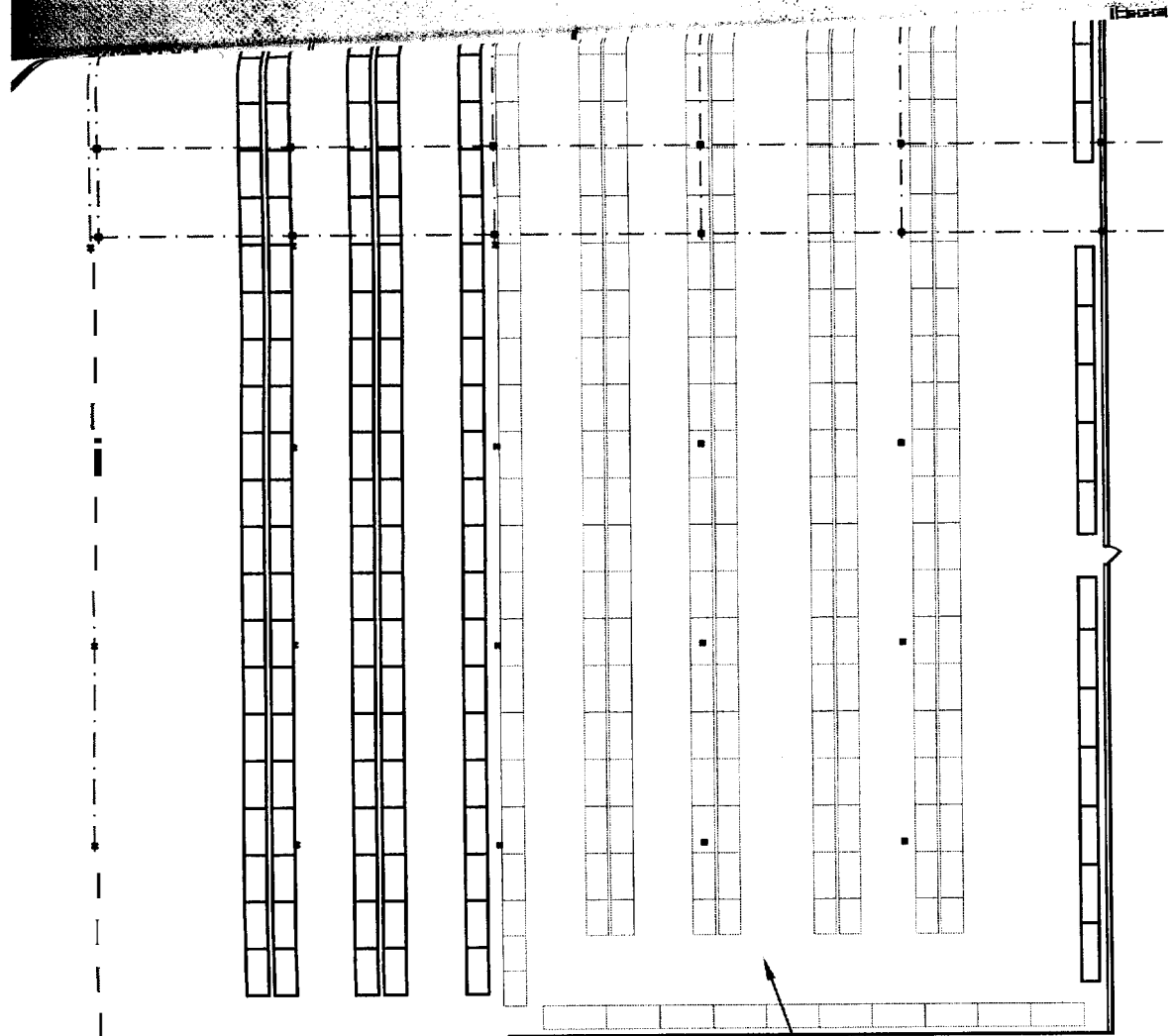

S

34

35

ALL RACK TO BE RESET FOR
RACK BED FRAMES
@ 6'-0" AND 12'-0" ABOVE
FINISHED FLOOR
(3-HIGH PALLET STORAGE)

31

32

33

