

DISPLAY THIS CARD ON PRINCIPAL FRONTAGE OF WORK



CITY OF PORTLAND

BUILDING PERMIT

This is to certify that KEVIN M YORK

Located At 153 BRAINTREE ST

Job ID: 2012-05-4107-POOL

CBL: 333- H-012-001

has permission to 14' x 54" above ground pool

provided that the person or persons, firm or corporation accepting this permit shall comply with all of the provisions of the Statutes of Maine and of the Ordinances of the City of Portland regulating the construction, maintenance and use of the buildings and structures, and of the application on file in the department.

Notification of inspection and written permission procured before this building or part thereof is lathed or otherwise closed-in. 48 HOUR NOTICE IS REQUIRED.

A final inspection must be completed by owner before this building or part thereof is occupied. If a certificate of occupancy is required, it must be

Fire Prevention Officer

Code Enforcement Officer / Plan Reviewer

THIS CARD MUST BE POSTED ON THE STREET SIDE OF THE PROPERTY
PENALTY FOR REMOVING THIS CARD



PORTLAND MAINE

Strengthening a Remarkable City, Building a Community for Life • www.portlandmaine.gov

Acting Director of Planning and Urban Development
Gregory Mitchell

Job ID: 2012-05-4107-POOL

Located At: 153 BRAINTREE ST

CBL: 333- H-012-001

Conditions of Approval:

Zoning

1. This permit is being approved on the basis of plans submitted. Any deviations shall require a separate approval before starting that work.
2. As discussed during the review process, the property must be clearly identified prior to pouring concrete and compliance with the required setbacks must be established. Due to the proximity of the setbacks of the proposed addition, it may be required to be located by a surveyor.
3. This property shall remain a single family dwelling. Any change of use shall require a separate permit application for review and approval.

Building

Separate permits are required for any electrical, plumbing, sprinkler, fire alarm HVAC systems, heating appliances, commercial hood exhaust systems and fuel tanks. Separate plans may need to be submitted for approval as a part of this process.

IMPORTANT SAFETY RULES

Read, understand, and follow all instructions carefully before installing and using this product.

Ultra Frame™ Pool

12' - 26' (366 cm - 792 cm) models



For illustrative purposes only. Accessories may not be provided with pool.

Don't forget to try these other fine Intex products: Pools, Pool Accessories, Inflatable Pools and In-Home Toys, Airbeds and Boats available at fine retailers or visit our website listed below.

INTEX®

IMPORTANT! DO NOT RETURN PRODUCT TO STORE

To purchase parts and accessories or to obtain non-technical assistance,
Visit www.intexcorp.com

For technical assistance and missing parts call us toll-free (for U.S. and Canadian Residents):

1-800-234-6839

Monday through Friday, 8:30am to 5:00pm Pacific Time

118-PO-R3-1210

OWNER'S MANUAL

PARTS REFERENCE

Before assembling your product, please take a few minutes to check the contents and become familiar with all the parts.

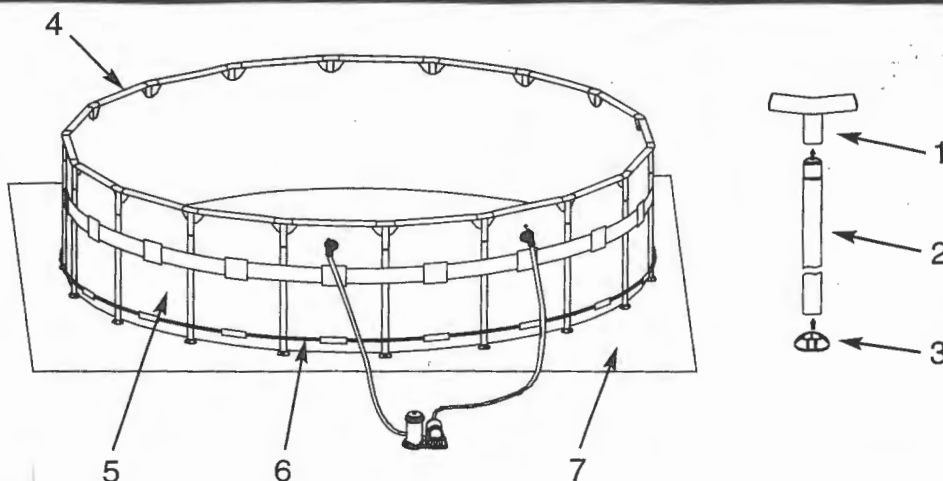

NOTE: Drawings for illustration purpose only. Actual product may vary. Not to scale.

12' (366 cm), 14' (427 cm), 16' (488 cm), 18' (549 cm), 20' (610 cm), 22' (671 cm), 24' (732 cm) & 26' (792 cm) models

REF NO.	DESCRIPTION	POOL SIZE & QUANTITIES							
		12' (366cm)	14' (427cm)	16' (488cm)	18' (549cm)	20' (610cm)	22' (671cm)	24' (732cm)	26' (792cm)
1	T - JOINT	12	14	16	18	20	22	24	26
2	VERTICAL LEG	12	14	16	18	20	22	24	26
3	LEG CAP	12	14	16	18	20	22	24	26
4	HORIZONTAL BEAM	12	14	16	18	20	22	24	26
5	POOL LINER (DRAIN VALVE CAP INCLUDED)	1	1	1	1	1	1	1	1
6	RESTRAINING ROPE (OPTIONAL)	1	1	1	1	1	1	1	1
7	GROUND CLOTH (OPTIONAL)	1	1	1	1	1	1	1	1
8	DRAIN CONNECTOR	1	1	1	1	1	1	1	1
9	DRAIN VALVE CAP	1	1	1	2	2	2	2	2
10	POOL COVER	1	1	1	1	1	1	1	1
11	STRAINER HOLE PLUG (WITH 1 EXTRA)	3	3						

REF NO.	DESCRIPTION	12' x 36" (366 cm x 91cm)	14' x 42" (427 cm x 107cm)	14' x 48" (427 cm x 122cm)	16' x 48" (488 cm x 122cm)	18' x 48" (549 cm x 122cm)	18' x 52" (549 cm x 132cm)	20' x 48" (610 cm x 122cm)	22' x 52" (671 cm x 132cm)	24' x 52" (732 cm x 132cm)	26' x 52" (792 cm x 132cm)
		SPARE PART NO.									
1	T - JOINT	11527	11359	11458	11449	11449	11450	11449	11450	11450	11450
2	VERTICAL LEG	11528	11360	11459	11452	11452	11452	11452	11452	11452	11452
3	LEG CAP	11361	11361	11361	11453	11453	11453	11453	11453	11453	11453
4	HORIZONTAL BEAM	11529	11362	11362	11451	11451	11451	11451	11451	11451	11451
5	POOL LINER (DRAIN VALVE CAP INCLUDED)	11517	11363	11518	11080	11448	10989	11291	11512	11293	11541
6	RESTRAINING ROPE (OPTIONAL)		10587	10587	10317	10317	10317	11292	11511	10420	11544
7	GROUND CLOTH (OPTIONAL)		18932	18932	18927	18933	18933	11290	11510	18935	11543
8	DRAIN CONNECTOR	10184	10184	10184	10184	10184	10184	10184	10184	10184	10184
9	DRAIN VALVE CAP	10649	11044	11044	11044	11044	11044	11044	11044	11044	11044
10	POOL COVER		11054	11054	10754	18937	18937	11289	11509	18929	11542
11	STRAINER HOLE PLUG (WITH 1 EXTRA)	10127	10127	10127							

PARTS LIST

1



2



3



4



5



6

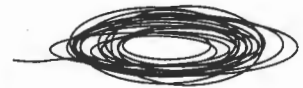

* Optional

7



* Optional

8

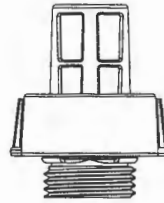

9

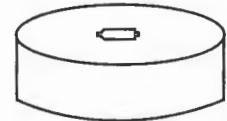

10



11

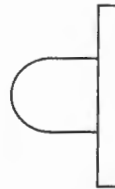

NOTE: Drawings for illustration purpose only. Actual product may vary. Not to scale.

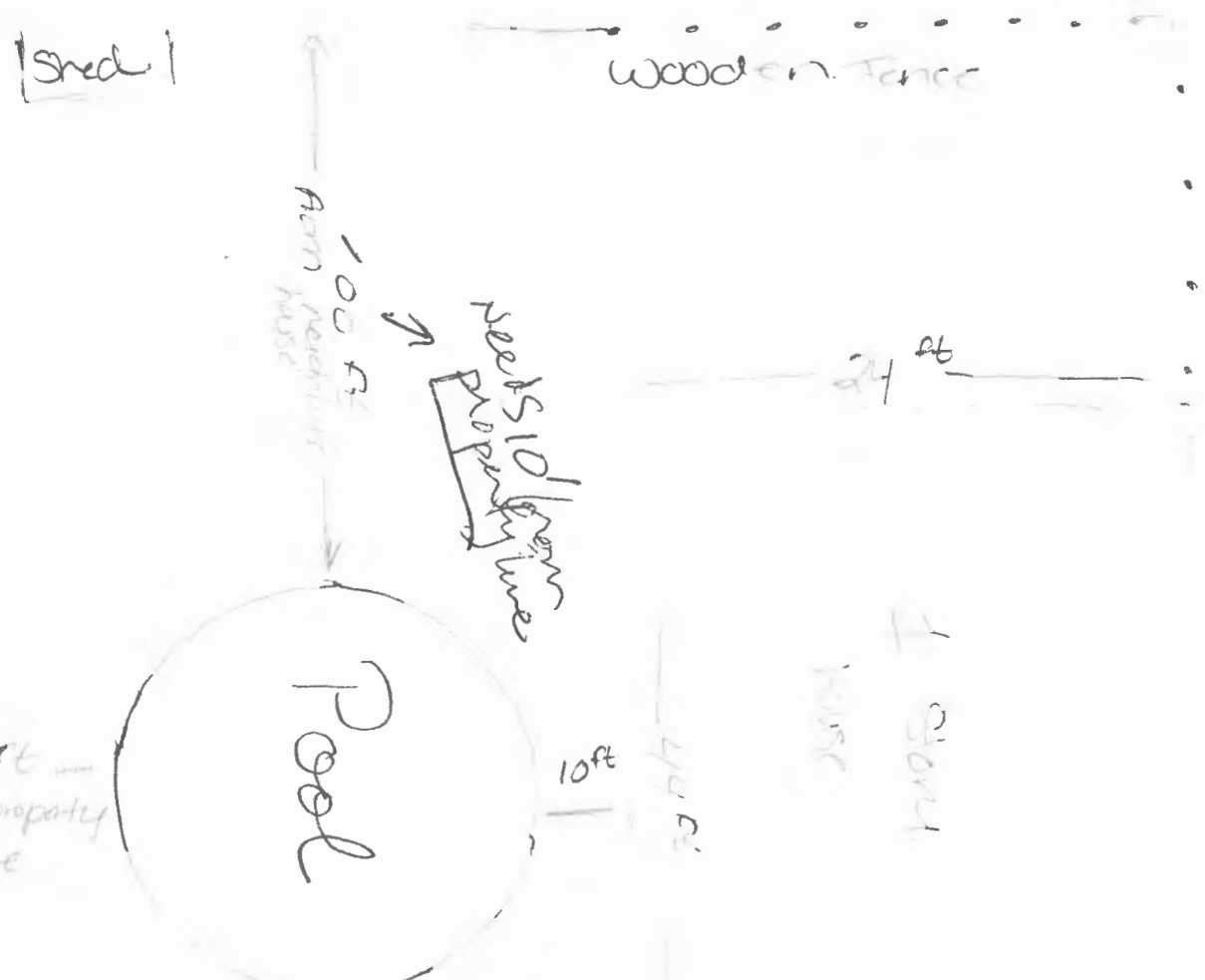

POOLS must be 10'
from principal Structure
in ALL property lines &





PORTLAND MAINE

Strengthening a Remarkable City, Building a Community for Life • www.portlandmaine.gov

Receipts Details:

Tender Information: Check , BusinessName: mastercard, Check Number: 488060

Tender Amount: 30.00

Receipt Header:

Cashier Id: gguertin

Receipt Date: 5/29/2012

Receipt Number: 44401

Receipt Details:

Referance ID:	6693	Fee Type:	BP-Constr
Receipt Number:	0	Payment Date:	
Transaction Amount:	30.00	Charge Amount:	30.00
Job ID: Job ID: 2012-05-4107-POOL - 14' x 54" above the ground pool			
Additional Comments: 153 Braintree			

Thank You for your Payment!