

City of Portland, Maine - Building or Use Permit Application

389 Congress Street, 04101 Tel: (207) 874-8703, Fax: (207) 874-8716

Permit No:
02-0104

PERMIT ISSUED

Issue Date:
SEP 23 2002

CBL: 4 04 + 33-36
332 A013001

Location of Construction: 54 Tucker Ave	Owner Name: Moreno Gilbert & <i>Kim Foster</i>	Owner Address: 54 Tucker Ave	Phone: 85868
Business Name: n/a	Contractor Name: n/a	Contractor Address: Portland	Phone:
Lessee/Buyer's Name n/a	Phone: n/a	Permit Type: Alterations - Dwellings	Zone: R3

Past Use: Single Family	Proposed Use: Single Family / Rear steps replaced, new entry way to deck.	Permit Fee: \$30.00	Cost of Work: \$900.00	CEO District: 1
Proposed Project Description: Rear steps replaced & new entry way to deck.		FIRE DEPT: <input type="checkbox"/> Approved <input type="checkbox"/> Denied	INSPECTION: Use Group: R-3 Type: 5B BOCA 1999 Signature: <i>JMB 9/23/02</i>	

PEDESTRIAN ACTIVITIES DISTRICT (P.A.D.)

Action: Approved Approved w/Conditions Denied

Signature: _____ Date: _____

Permit Taken By: gg	Date Applied For: 02/04/2002	Zoning Approval	
------------------------	---------------------------------	------------------------	--

<p>1. This permit application does not preclude the Applicant(s) from meeting applicable State and Federal Rules.</p> <p>2. Building permits do not include plumbing, septic or electrical work.</p> <p>3. Building permits are void if work is not started within six (6) months of the date of issuance. False information may invalidate a building permit and stop all work..</p>	<p>Special Zone or Reviews</p> <p><input type="checkbox"/> Shoreland</p> <p><input type="checkbox"/> Wetland <i>N/A</i></p> <p><input type="checkbox"/> Flood Zone</p> <p><input type="checkbox"/> Subdivision</p> <p><input type="checkbox"/> Site Plan</p> <p>Maj <input type="checkbox"/> Minor <input type="checkbox"/> MM <input type="checkbox"/></p> <p>Date: <i>JMB 9/23/02</i></p>	<p>Zoning Appeal</p> <p><input type="checkbox"/> Variance</p> <p><input type="checkbox"/> Miscellaneous</p> <p><input type="checkbox"/> Conditional Use</p> <p><input type="checkbox"/> Interpretation</p> <p><input type="checkbox"/> Approved</p> <p><input type="checkbox"/> Denied</p> <p>Date: _____</p>	<p>Historic Preservation</p> <p><input checked="" type="checkbox"/> Not in District or Landmark</p> <p><input type="checkbox"/> Does Not Require Review</p> <p><input type="checkbox"/> Requires Review</p> <p><input type="checkbox"/> Approved</p> <p><input type="checkbox"/> Approved w/Conditions</p> <p><input type="checkbox"/> Denied</p> <p>Date: _____</p>
---	---	---	--

CERTIFICATION

I hereby certify that I am the owner of record of the named property, or that the proposed work is authorized by the owner of record and that I have been authorized by the owner to make this application as his authorized agent and I agree to conform to all applicable laws of this jurisdiction. In addition, if a permit for work described in the application is issued, I certify that the code official's authorized representative shall have the authority to enter all areas covered by such permit at any reasonable hour to enforce the provision of the code(s) applicable to such permit.

SIGNATURE OF APPLICANT ADDRESS DATE PHONE

RESPONSIBLE PERSON IN CHARGE OF WORK, TITLE DATE PHONE

All Purpose Building Permit Application

If you or the property owner owes real estate or personal property taxes or user charges on any property within the City, payment arrangements must be made before permits of any kind are accepted.

Location/Address of Construction: <u>54 TUCKER AVE</u>		
Total Square Footage of Proposed Structure <u>144+ EXPANSION</u>	Square Footage of Lot <u>12 SPINDLE</u>	<u>13,950 SQ FT</u>
Tax Assessor's Chart, Block & Lot Chart# <u>332 - A - 013 -</u> Block# <u>001</u> Lot# <u>001</u> <u>332 - A - 012 -</u> <u>001</u>	Owner: <u>Gilbert MORENO</u> <u>Kimberly FOSTER</u>	Telephone: <u>878-5868</u>
Lessee/Buyer's Name (If Applicable)	Applicant name, address & telephone:	Cost Of Work: \$ <u>900 -</u> Fee: \$ <u>30.00</u>
Current use: <u>Single Family</u>		
If the location is currently vacant, what was prior use: _____		
Approximately how long has it been vacant: _____		
Proposed use: <u>Single Family Home</u>		
Project description: <u>RELOCATE EXISTING HOT-TUB. ON REAR OF HOUSE. 12X12 DECK WITH DECK. REAR STEPS REPLACED NEW ENTRYWAY ONE TO DECK.</u>		
Contractor's name, address & telephone:		
Who should we contact when the permit is ready: <u>Home owner</u>		
Mailing address: _____ <u>878-5868 OR Cell # 650-9461</u> Phone:		

IF THE REQUIRED INFORMATION IS NOT INCLUDED IN THE SUBMISSIONS THE PERMIT WILL BE AUTOMATICALLY DENIED AT THE DISCRETION OF THE BUILDING/PLANNING DEPARTMENT, WE MAY REQUIRE ADDITIONAL INFORMATION IN ORDER TO APPROVE THIS PERMIT.

I hereby certify that I am the Owner of record of the named property, or that the owner of record authorizes the proposed work and that I have been authorized by the owner to make this application as his/her authorized agent. I agree to conform to all applicable laws of this jurisdiction. In addition, if a permit for work described in this application is issued, I certify that the Code Official's authorized representative shall have the authority to enter all areas covered by this permit at any reasonable hour to enforce the provisions of the codes applicable to this permit.

Signature of applicant: 	Date: <u>12/4/01</u>
---	----------------------

This is not a permit, you may not commence ANY work until the permit is issued

Application ID Number: 2-0104

Department: Building

Status: Approved with Conditions

Reviewer: Jeanine Bourke

Comments: Permit was in the hold file, previously reviewed by D. Caddell

Approval Date: 09/23/2002

Given On Date: 02/05/2002

OK to Issue Permit

Name: Jeanine Bourke

Date: 09/23/2002

Date 2: []

Conditions Section:

Add New Condition From

Add New Condition

Delete Condition

Application approval based upon information provided by applicant. Any deviation from approved plans requires separate review and approval prior to work.

Solid locking cover to be installed on hot tub per owner

A separate permit is required for the hot tub pump installation

Create Date: 02/04/2002

By: jg

Update Date: 09/23/2002

By: jmb

Delete

Save

Save

Application ID Number: 2-0104

Department: Zoning Status: Approved with Conditions Reviewer: Jeanine Bourke Approval Date: 09/23/2002

Comments:

Given On Date: 03/18/2002

OK to Issue Permit Name: Jeanine Bourke Date: 09/23/2002 Date 2:

Conditions Section:

This permit is being approved on the basis of plans submitted. Any deviations shall require a separate approval before starting that work.

Per the owner, the existing 8 X 10 shed will be relocated to meet the required 5' setback from all property lines.

Create Date: 02/04/2002 By: gg Update Date: 09/23/2002 By: lmb

TUCKER Ave
135'

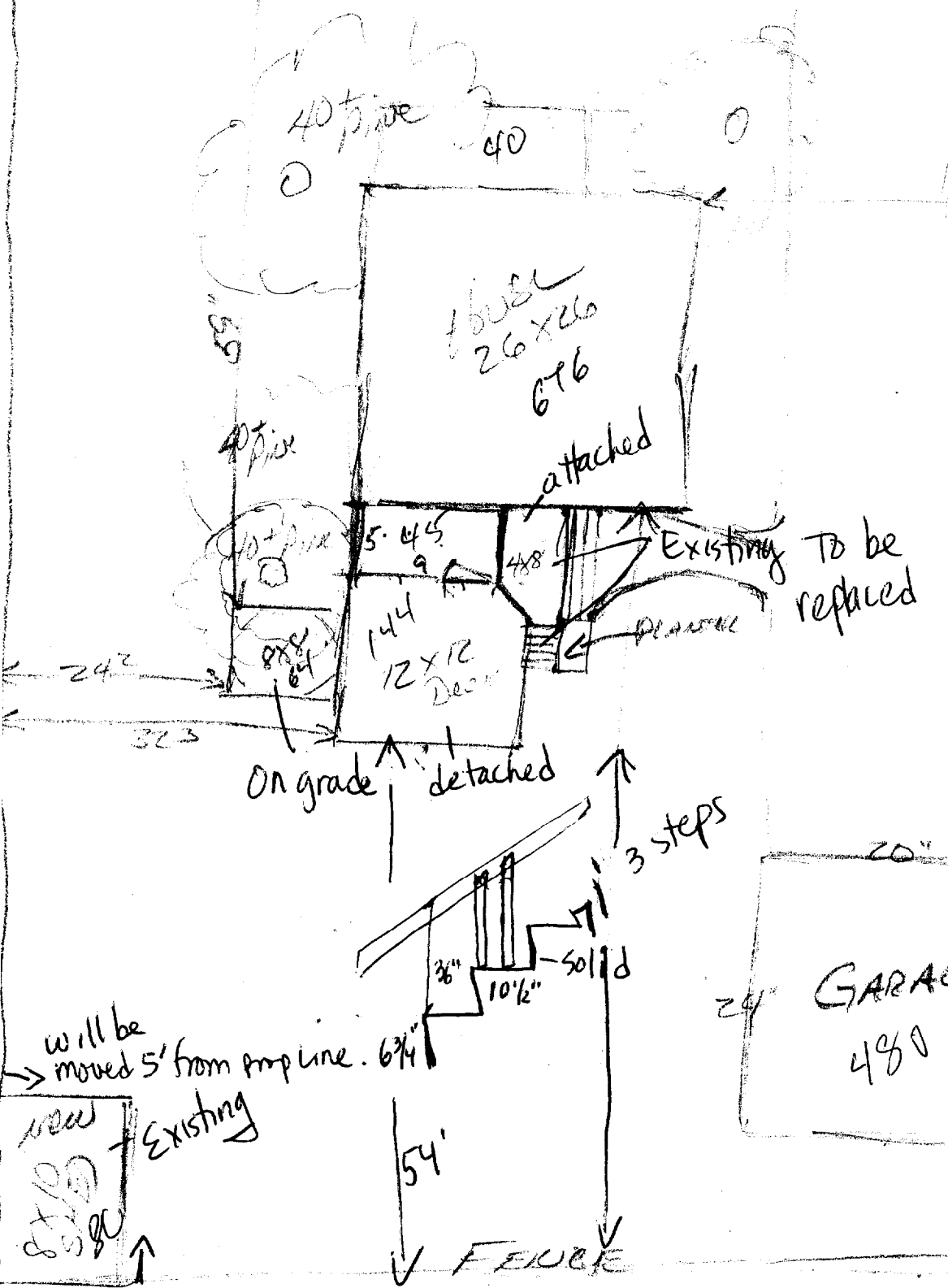

R-3 Zone
 Front - N/A
 Rear 25' Req. 54' shown
 Side 8' Req. 24' 4' 30' shown

13,050 SF x 25%
 Existing 1,347 3,262.5
 Proposed 209 1,556 #

Riverside Street

CMTC

CENTRAL MAINE
TECHNICAL COLLEGE

NAME

Gil MORENO

DATE

54 TUCKER Ave.

PROJECT _____

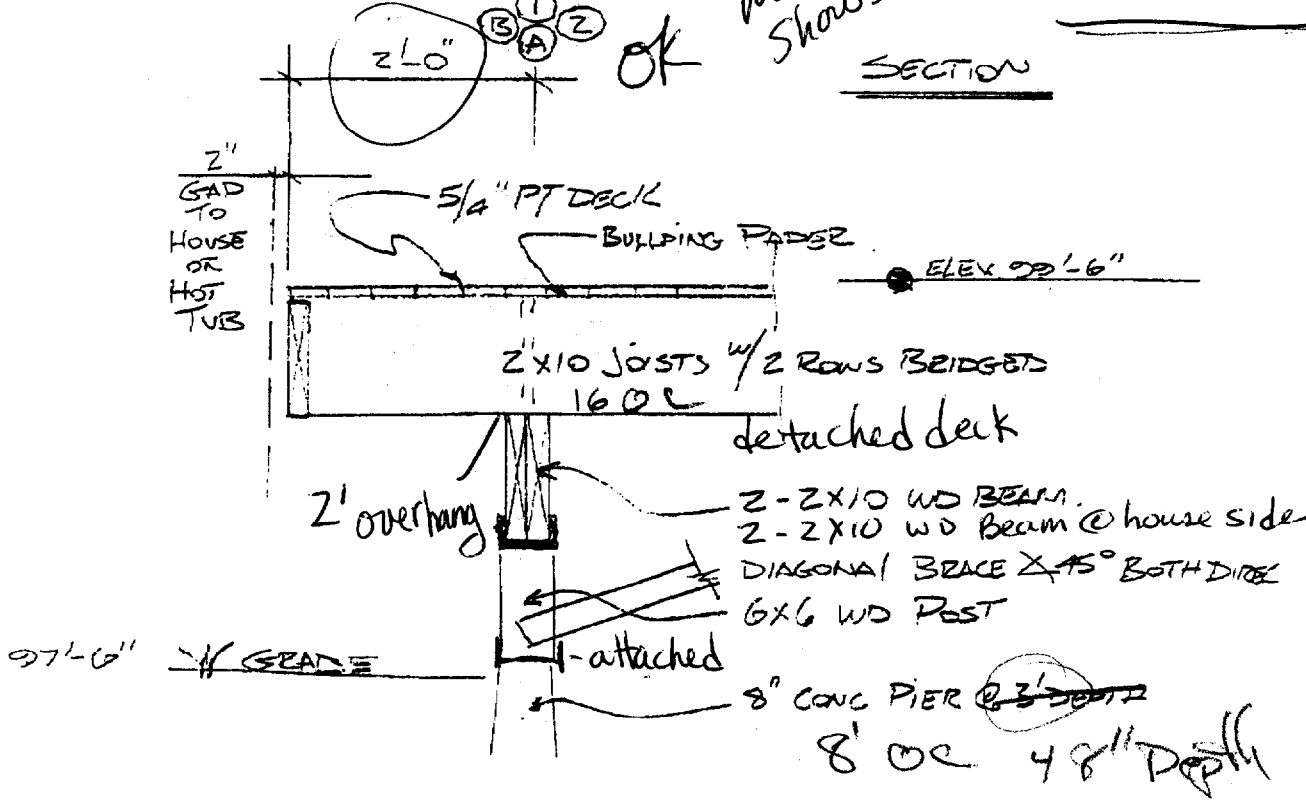
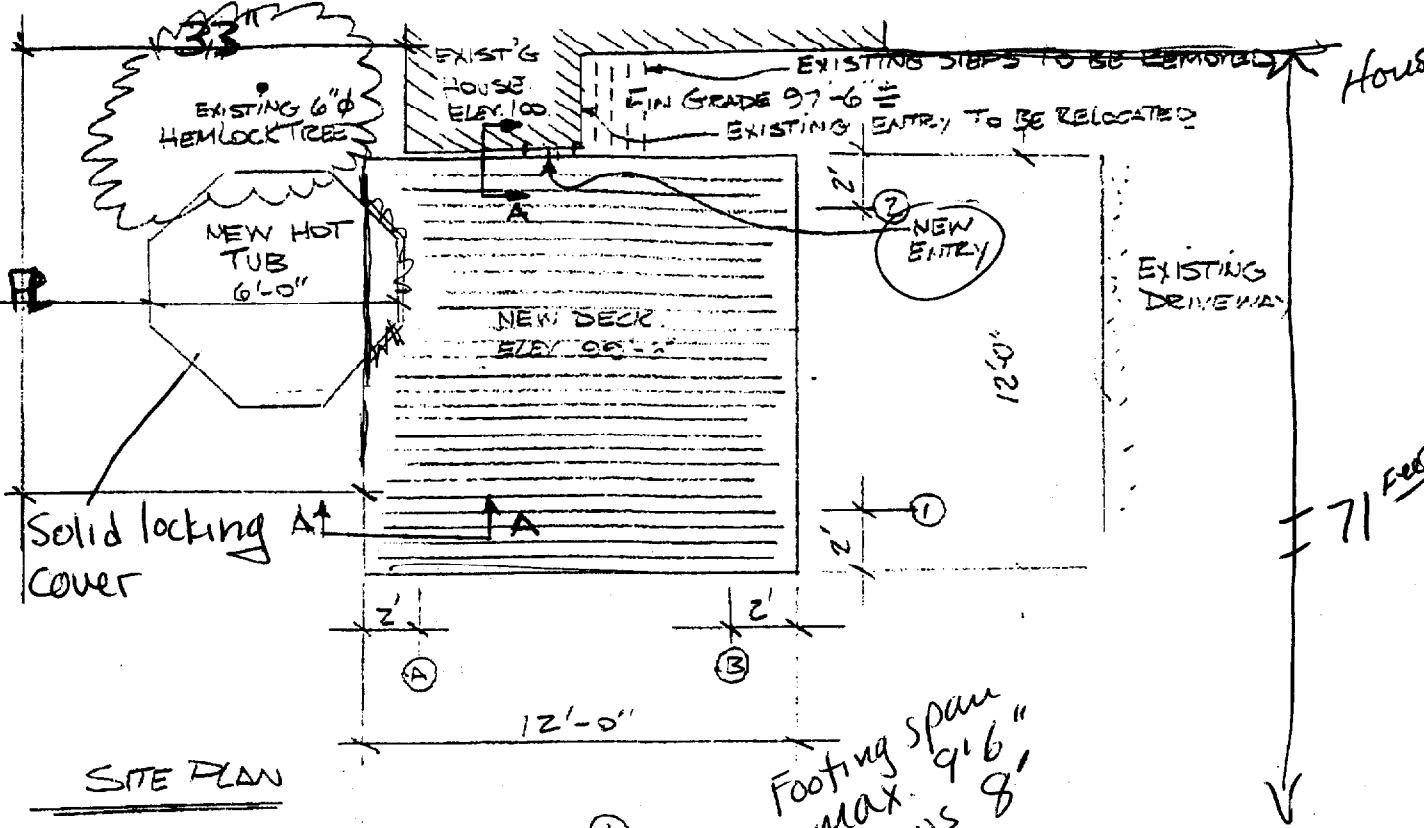

484
Model 10/10
LIFE STYLE SPA
PORTABLE
230V/115V 4 wire
50 Amp Service
C GFI x 2
1 @ Tub
1 @ Panel sub
Chlorine
Titanium

Depakone
DUALPREX SODIUM



Please see full prescribing information attached.

Form # P 04

DISPLAY THIS CARD ON PRINCIPAL FRONTAGE OF WORK

CITY OF PORTLAND

BUILDING DEPARTMENT

PERMIT

PERMIT ISSUED
SEP 23 2002
Permit Number: 020104
CITY OF PORTLAND

Please Read Application And Notes, If Any, Attached

This is to certify that Moreno Gilbert & /n/a
has permission to Rear steps replaced & new exterior way to back.
AT 54 Tucker Ave 332 A013001

provided that the person or persons, firm or corporation accepting this permit shall comply with all of the provisions of the Statutes of Maine and of the ordinances of the City of Portland regulating the construction, maintenance and use of buildings and structures, and of the application on file in this department.

Apply to Public Works for street line and grade if nature of work requires such information.

Notification of inspection must be given and work on permit must be completed before this building or part thereof is occupied or closed-in. 24 HOUR NOTICE IS REQUIRED.

A certificate of occupancy must be procured by owner before this building or part thereof is occupied.

OTHER REQUIRED APPROVALS

Fire Dept. _____
Health Dept. _____
Appeal Board _____
Other _____
Department Name

Jamie Bourke 9/23/02
Director - Building & Inspection Services

PENALTY FOR REMOVING THIS CARD