

City of Portland, Maine - Building or Use Permit Application
 389 Congress Street, 04101 Tel: (207) 874-8703, Fax: (207) 874-8716

Permit No: 09-0938	Issue Date:	CBL: 332 C021001
-----------------------	-------------	---------------------

Location of Construction: 67 TUCKER AVE	Owner Name: WILLIAMS JOANNE E	Owner Address: 67 TUCKER AVE	Phone:
Business Name:	Contractor Name: Mark Reardon	Contractor Address: 52 Woodridge drive Buxton	Phone 2079296006
Lessee/Buyer's Name	Phone:	Permit Type: HVAC	Zone: R-3

Past Use: Single Family Home	Proposed Use: Single Family Home - install a Monitor2400	Permit Fee: \$60.00	Cost of Work: \$3,400.00	CEO District: 5
Proposed Project Description: install a Monitor2400		FIRE DEPT: <input type="checkbox"/> Approved <input type="checkbox"/> Denied <i>N/A</i>	INSPECTION: Use Group: <i>U</i> Type: <i>HVAC</i> <i>JMC 2005</i>	
		Signature: _____ Signature: _____		
PEDESTRIAN ACTIVITIES DISTRICT (P.A.D.)				
Action: <input type="checkbox"/> Approved <input type="checkbox"/> Approved w/Conditions <input type="checkbox"/> Denied				
Signature: _____ Date: _____				

Permit Taken By: Ldobson	Date Applied For: 08/31/2009	Zoning Approval
-----------------------------	---------------------------------	------------------------

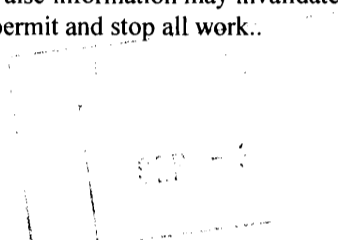
1. This permit application does not preclude the Applicant(s) from meeting applicable State and Federal Rules. 2. Building permits do not include plumbing, septic or electrical work. 3. Building permits are void if work is not started within six (6) months of the date of issuance. False information may invalidate a building permit and stop all work.. 	Special Zone or Reviews <input type="checkbox"/> Shoreland <input type="checkbox"/> Wetland <input type="checkbox"/> Flood Zone <input type="checkbox"/> Subdivision <input type="checkbox"/> Site Plan Maj <input type="checkbox"/> Minor <input type="checkbox"/> MM <input type="checkbox"/> Date: <i>8/31/09</i> <i>ABN</i>	Zoning Appeal <input type="checkbox"/> Variance <input type="checkbox"/> Miscellaneous <input type="checkbox"/> Conditional Use <input type="checkbox"/> Interpretation <input type="checkbox"/> Approved <input type="checkbox"/> Denied Date: _____	Historic Preservation <input checked="" type="checkbox"/> Not in District or Landmark <input type="checkbox"/> Does Not Require Review <input type="checkbox"/> Requires Review <input type="checkbox"/> Approved <input type="checkbox"/> Approved w/Conditions <input type="checkbox"/> Denied Date: <i>ABN</i>
--	---	---	---

CERTIFICATION

I hereby certify that I am the owner of record of the named property, or that the proposed work is authorized by the owner of record and that I have been authorized by the owner to make this application as his authorized agent and I agree to conform to all applicable laws of this jurisdiction. In addition, if a permit for work described in the application is issued, I certify that the code official's authorized representative shall have the authority to enter all areas covered by such permit at any reasonable hour to enforce the provision of the code(s) applicable to such permit.

 SIGNATURE OF APPLICANT ADDRESS DATE PHONE

 RESPONSIBLE PERSON IN CHARGE OF WORK, TITLE DATE PHONE



FILL IN AND SIGN WITH INK

APPLICATION FOR PERMIT HEATING OR POWER EQUIPMENT

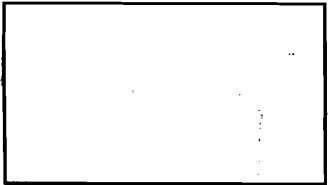

To the INSPECTOR OF BUILDINGS, PORTLAND, ME.

The undersigned hereby applies for a permit to install the following heating, cooking or power equipment in accordance with the Laws of Maine, the Building Code of the City of Portland, and the following specifications:

Location / CBL _____ Use of Building Residential Date 8-25-09
 Name and address of owner of appliance Jacquie Williams
67 Tucker Ave Portland, ME
 Installer's name and address Mark E. Reardon Inc
P.O. Box 751, Bar Mills, ME 04004 Telephone 207-642-6006

Location of appliance:
 Basement Floor
 Attic Roof

Type of Fuel:
 Gas Oil Solid

Appliance Name: Monitor 2400
 U.L. Approved Yes No

Will appliance be installed in accordance with the manufacture's installation instructions? Yes No

IF NO Explain: _____

The Type of License of Installer:
 Master Plumber # _____
 Solid Fuel # _____
 Oil # ME # MS30002653
 Gas # _____
 Other _____

Type of Chimney:
 Masonry Lined
 Factory built _____
 Metal
 Factory Built U.L. Listing # _____
 Direct Vent
 Type Monitor UL# 67 R1

Type of Fuel Tank
 Oil
 Gas

Size of Tank 275

Number of Tanks 1

Distance from Tank to Center of Flame 15' feet.

Cost of Work: \$ 3400.00
Permit Fee: \$ 70

Approved **Approved with Conditions**

Fire: _____ See attached letter or requirement
 Ele.: _____
 Bldg.: _____

Inspector's Signature _____ Date Approved _____

Signature of Installer Mark E. Reardon

White - Inspection Yellow - File Pink - Applicant's Gold - Assessor's Copy

THIS IS NOT A BOUNDARY SURVEY

This copyrighted document expires 10-08-09. Reproduction and/or dissemination after this date is unauthorized.

MORTGAGE INSPECTION OF: DEED BOOK 13294 PAGE 272 COUNTY Cumberland
PLAN BOOK --- PAGE --- LOT ---

ADDRESS: 67 Tucker Avenue, Portland, Maine

Job Number: 669-29

Inspection Date: 07-09-09

Scale: 1" = 20'

Client File #: 2009070726

Buyers: Yves Bigirimana

Sellers: Joanne E. Williams

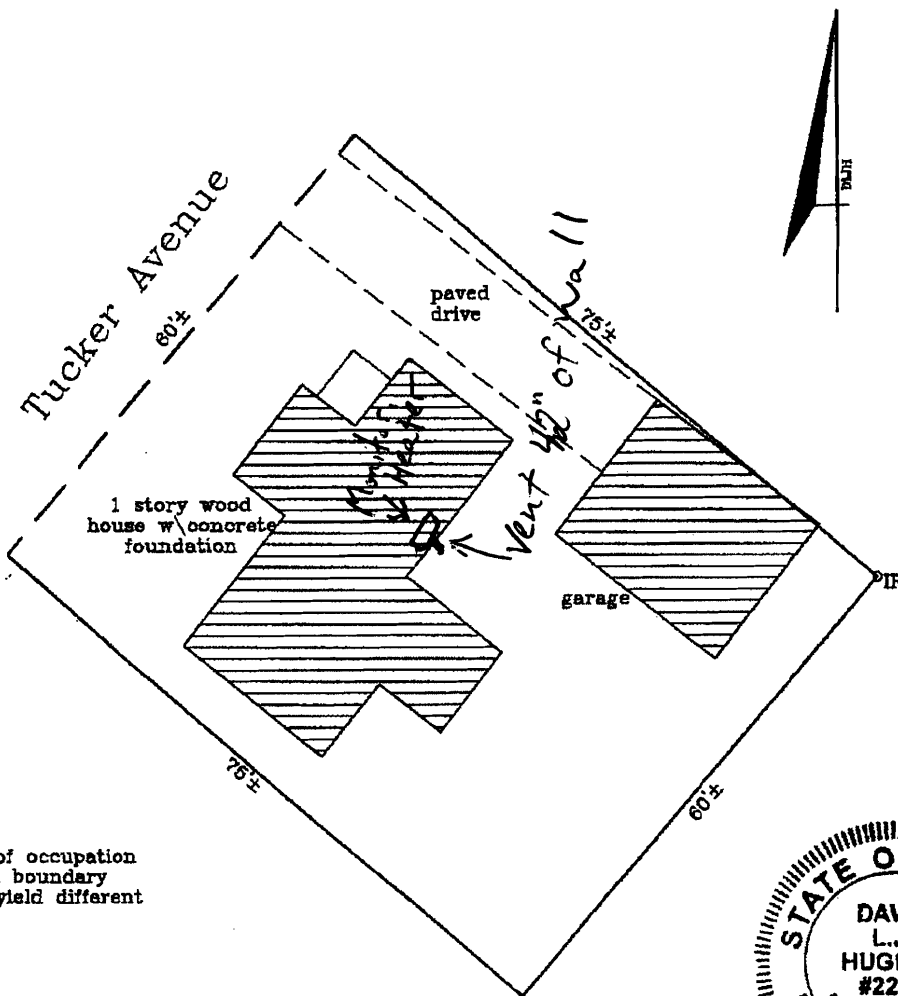

NOTE: Lines of occupation are shown. A boundary survey may yield different results

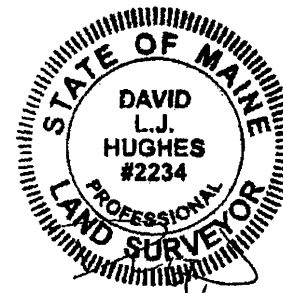

I HEREBY CERTIFY TO: Cumberland Title Services, LLC, TD Bank, N.A. and its title insurer.

Monuments found did not conflict with the deed description.

The dwelling setbacks do not violate town zoning requirements.

As delineated on the Federal Emergency Management Agency Community Panel:

The structure does not fall within the special flood hazard zone.

The land does not fall within the special flood hazard zone.

A wetlands study has not been performed.

APPARENT EASEMENTS AND RIGHTS OF WAY ARE SHOWN. OTHER ENCUMBRANCES, RECORDED OR NOT, MAY EXIST. THIS SKETCH WILL NOT REVEAL ABUTTING DEED CONFLICTS, IF ANY.

Livingston-Hughes
Professional Land Surveyors
88 Guinea Road
Kennebunkport, Maine 04046
207-967-9761 phone 207-967-4831 fax
www.livingstonhughes.com

THIS SKETCH IS FOR MORTGAGE PURPOSES ONLY

City of Portland, Maine - Building or Use Permit
 389 Congress Street, 04101 Tel: (207) 874-8703, Fax: (207) 874-8716

Permit No: 09-0938	Date Applied For: 08/28/2009	CBL: 332 C021001
------------------------------	--	----------------------------

Location of Construction: 67 TUCKER AVE	Owner Name: WILLIAMS JOANNE E	Owner Address: 67 TUCKER AVE	Phone:
Business Name:	Contractor Name: Mark Reardon	Contractor Address: 52 Woodridge drive Buxton	Phone (207) 929-6006
Lessee/Buyer's Name	Phone:	Permit Type: HVAC	

Proposed Use: Single Family Home - install a Monitor 2400	Proposed Project Description: install a Monitor 2400
---	--

Dept: Zoning **Status:** Approved with Conditions **Reviewer:** Ann Machado **Approval Date:** 08/31/2009
Note: **Ok to Issue:**
 1) This property shall remain a single family dwelling. Any change of use shall require a separate permit application for review and approval.

Dept: Building **Status:** Approved with Conditions **Reviewer:** Tammy Munson **Approval Date:** 09/03/2009
Note: **Ok to Issue:**
 1) Installation shall comply with 2003 International Mechanical Code and State of Maine Oil and Solid Fuel Board Laws and Rules

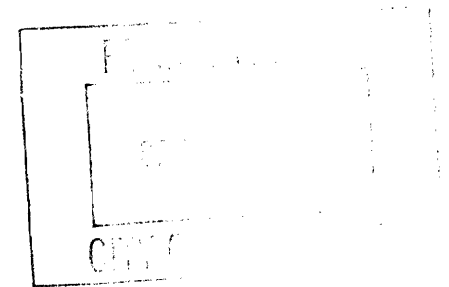

MONITOR

Keeping America's Homes Warm
For Twenty Years



Experience The Warmth!



MONITOR OWNERS RAVE ABOUT THEIR HEATERS

Monitor... The Best Cure For High Fuel Costs!

Saving money heating their homes is a top priority these days. The attractive Monitor 2200 & 2400's save hundreds of dollars in fuel costs each season. Thousands of dollars over the long life of the Monitor System! And, it is reliable, clean and safe.

The automatic Seven-Day Program can be set to deliver four time/four temperature settings each day. Match the activities of the family by programming the Monitor for each weekday and the weekend. The program's thermostat maintains a steady temperature, eliminating inefficient swings in temperature. You get the comfort you deserve.

Special Features:

Memory Back up:

Set memory can be kept in case of power failure for up to 30 minutes.

Automatic Reset After Power Failure:

Heater will automatically resume operation after power is restored.

Dual Blowers:

Separate fans for combustion and room air circulation.

Thermostatically Controlled:

Adjusts to the desired room temperature.

Indicator Lights:

Easy-to-see signals show when heater is in operation, when timer is activated & when the burner is operating.

Multiple Heat Exchanger:

Extracts 88% of heat from burner.

Easy Installation:

Includes all parts required for standard installation.

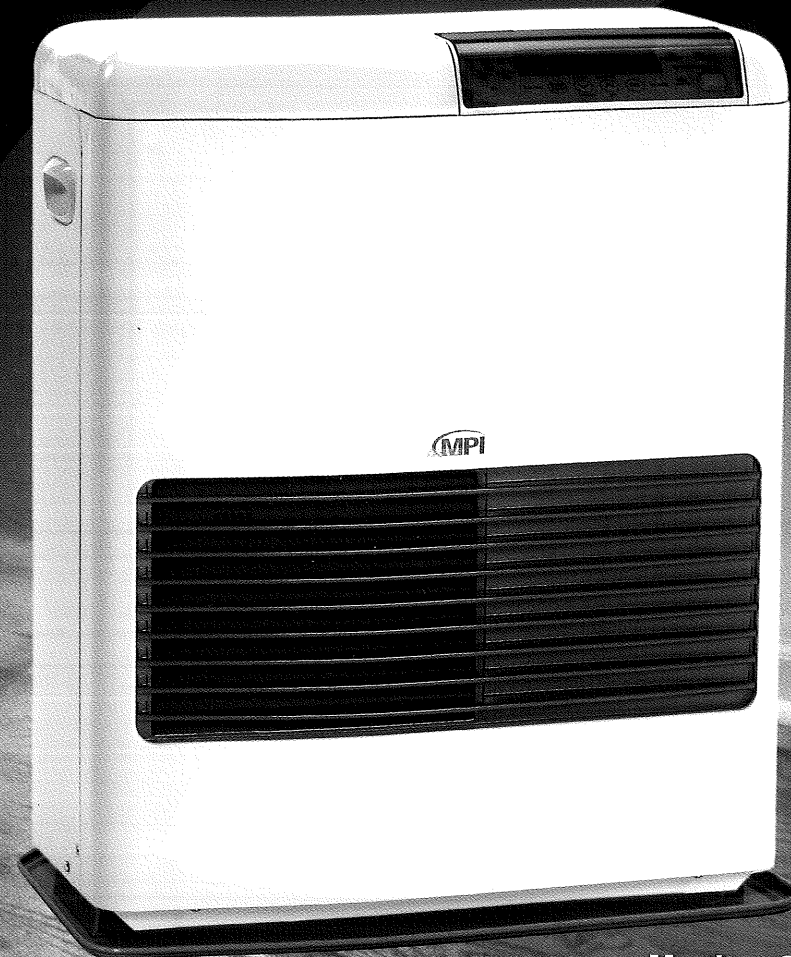

Monitor 2200

Experience The Warmth!



Special Feature

- Child Lock to prevent accidental operation by curious children.
- The easy to use control panel allows you to program time, temperature and the automatic operation mode.

Monitor 2400

Monitor 2200 and 2400

Flue Pipes:

The Monitor 2200 and 2400 comes with standard flue pipes A & B. Monitor offers a wide range of flue pipes that are threaded to accommodate many wall thicknesses.

For walls greater than 8.5" but less than 12.5", use Medium B (P/N 8051).
For walls greater than 12.5" but less than 20", use Long Adjustable (P/N 8052).

Consult your dealer about your installation.

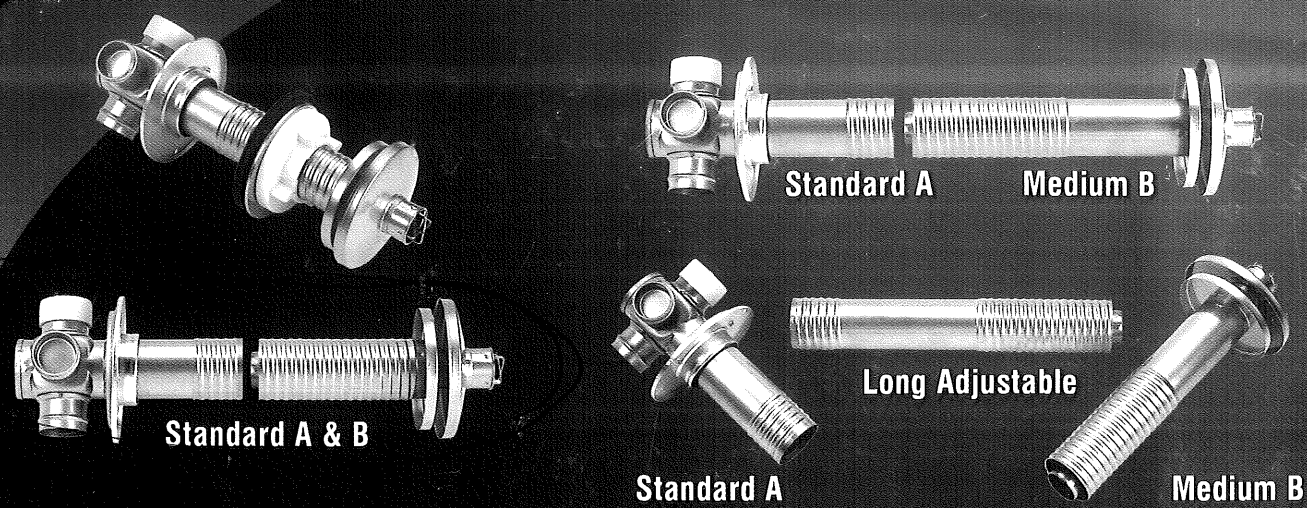
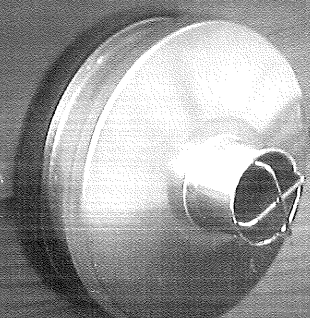

Monitor 2200 Specifications

Monitor 2200	High	High/Med.	Med./Low	Low
BTU Rating (per hour)	22,000	17,400	12,400	9,600
Fuel Consumption (gal./hr.)	.164	.13	.09	.07
BTU Output (per hour)	18,260	14,440	10,290	7,970
Heated Air Delivery (cubic ft./min.)	176	176	126	113

Power Consumption 41 Watts average consumption
 Fuel Source Separate tank or optional capsule tank
 Dimensions 26.0" H x 20.9" W x 12.4" D
 Weight 55 pounds, empty

Heating Capacity 1,000 sq. ft.
 Fuel Type K-1 Kerosene or Low Sulphur No. 1 Oil
 Power Source Electric, 120 Volts AC; 60 Hz
 Efficiency 93% Gross; 88% Net, 85% A.F.U.E.

30 minute memory backup to retain auto program

Monitor 2400 Specifications

Monitor 2400	High	High/Med.	Med./Low	Low
BTU Rating (per hour)	43,000	32,400	24,600	16,200
Fuel Consumption (gal./hr.)	.32	.24	.18	.12
BTU Output (per hour)	37,200	26,900	20,700	13,600
Heated Air Delivery (cubic ft./min.)	388	388	330	300

Power Consumption 56.5 Watts average consumption
 Fuel Source Separate tank
 Dimensions 26.0" H x 28.7" W x 14" D
 Weight 82 pounds, empty

Heating Capacity 1,800 - 2,000 sq. ft.
 Fuel Type K-1 Kerosene or Low Sulphur No. 1 Oil
 Power Source Electric, 120 Volts AC; 60 Hz
 Efficiency 93% Gross; 88% Net, 85% A.F.U.E.

30 minute memory backup to retain auto program

Part No. 1129