

DISPLAY THIS CARD ON PRINCIPAL FRONTAGE OF WORK



CITY OF PORTLAND BUILDING PERMIT

This is to certify that DAVID SPRAGUE

Located At 34 TUCKER AVE

Job ID: 2012-02-3243-HVAC/LP TANK

CBL: 332- A-041-001

has permission to Install a 120 gal LP tank and Rinnai heater
provided that the person or persons, firm or corporation accepting this permit shall comply with all of the provisions of the Statues of Maine and of the Ordinances of the City of Portland regulating the construction, maintenance and use of the buildings and structures, and of the application on file in the department.

Notification of inspection and written permission procured before this building or part thereof is lathed or otherwise closed-in. 48 HOUR NOTICE IS REQUIRED.

A final inspection must be completed by owner before this building or part thereof is occupied. If a certificate of occupancy is required, it must be

Fire Prevention Officer

[Signature] per J.R. 2/17/12

Code Enforcement Officer / Plan Reviewer

THIS CARD MUST BE POSTED ON THE STREET SIDE OF THE PROPERTY
PENALTY FOR REMOVING THIS CARD

City of Portland, Maine - Building or Use Permit Application

389 Congress Street, 04101 Tel: (207) 874-8703, FAX: (207) 8716

Job No: 2012-02-3243-HVAC	Date Applied: 2/9/2012	CBL: 332- A-041-001	
Location of Construction: 34 TUCKER AVE	Owner Name: DAVID SPRAGUE	Owner Address: 34 TUCKER AVE PORTLAND, ME 04103	Phone:
Business Name:	Contractor Name: DOWNEAST ENERGY CO	Contractor Address: 172 MAIN ST, SOUTH PORTLAND, ME 04106	Phone: 799-5585
Lessee/Buyer's Name:	Phone:	Permit Type: HVAC	Zone: R-3
Past Use: Single Family Dwelling	Proposed Use: Same: Single Family Dwelling - to install Rinnai SS6FA heating system	Cost of Work: \$2,000.00	CEO District:
		Fire Dept: <input type="checkbox"/> Approved <input type="checkbox"/> Denied <input type="checkbox"/> N/A Signature:	Inspection: Use Group: R-3 Type: LP/HVAC Signature: <i>[Signature]</i>
Proposed Project Description: Rinnai 556 FA		Pedestrian Activities District (P.A.D.)	
Permit Taken By: Brad		Zoning Approval	

1. This permit application does not preclude the Applicant(s) from meeting applicable State and Federal Rules.
2. Building Permits do not include plumbing, septic or electrical work.

Install
Date
2/20

Special Zone or Reviews	Zoning Appeal	Historic Preservation
<input type="checkbox"/> Shoreland <input type="checkbox"/> Wetlands <input type="checkbox"/> Flood Zone <input type="checkbox"/> Subdivision <input type="checkbox"/> Site Plan <input type="checkbox"/> Maj <input type="checkbox"/> Min <input checked="" type="checkbox"/> MM Date: <i>OK 2/9/12</i>	<input type="checkbox"/> Variance <input type="checkbox"/> Miscellaneous <input type="checkbox"/> Conditional Use <input type="checkbox"/> Interpretation <input type="checkbox"/> Approved <input type="checkbox"/> Denied Date:	<input checked="" type="checkbox"/> Not in Dist or Landmark <input type="checkbox"/> Does not Require Review <input type="checkbox"/> Requires Review <input type="checkbox"/> Approved <input type="checkbox"/> Approved w/Conditions <input type="checkbox"/> Denied Date: <i>[Signature]</i>

CERTIFICATION

I hereby certify, or that the proposed work is authorized by the owner of record and that I have been authorized by the owner to agree to conform to all applicable laws of this jurisdiction. In addition, if a permit for work described in this application and representative shall have the authority to enter all areas covered by such permit at any reasonable hour.

ADDRESS

DATE

PHONE

RESPONSIBLE PERSON IN CHARGE OF WORK, TITLE

DATE

PHONE

BUILDING PERMIT INSPECTION PROCEDURES

Please call 874-8703 or 874-8693 (ONLY)

or email: buildinginspections@portlandmaine.gov

With the issuance of this permit, the owner, builder or their designee is required to provide adequate notice to the city of Portland Inspections Services for the following inspections. Appointments must be requested 48 to 72 hours in advance of the required inspection. The inspection date will need to be confirmed by this office.

- **Please read the conditions of approval that is attached to this permit!! Contact this office if you have any questions.**
- **Permits expire in 6 months. If the project is not started or ceases for 6 months.**
- **If the inspection requirements are not followed as stated below additional fees may be incurred due to the issuance of a "Stop Work Order" and subsequent release to continue.**

Final inspection at completion of installation

The project cannot move to the next phase prior to the required inspection and approval to continue, REGARDLESS OF THE NOTICE OF CIRCUMSTANCES.

IF THE PERMIT REQUIRES A CERTIFICATE OF OCCUPANCY, IT MUST BE PAID FOR AND ISSUED TO THE OWNER OR DESIGNEE BEFORE THE SPACE MAY BE OCCUPIED.



PORTLAND MAINE

Strengthening a Remarkable City. Building a Community for Life • www.portlandmaine.gov

Director of Planning and Urban Development
Penny St. Louis

Job ID: 2012-02-3243-HVAC

Located At: 34 TUCKER AVE

CBL: 332- A-041-001

Conditions of Approval:

Building

1. The installation must comply with UL, the Manufacturers' Listing, and State of Maine Gas Regulations.
2. Separate permits are required for any electrical: plumbing, sprinkler, fire alarm, HVAC systems, commercial hood exhaust systems and fuel tanks. Separate plans may need to be submitted for approval as a part of this process.
3. Maintain proper setback(s) from property lines/buildings and proper clearances from vertical openings when direct venting
4. A Carbon Monoxide (CO) alarm shall be installed in each area within or giving access to bedrooms. That detection must be powered by the electrical service (plug-in or hardwired) in the building and battery.
5. M1804.2.5 Direct vent terminations. Vent terminals for direct-vent appliances shall be installed in accordance with the manufacturer's installation instructions.
6. Tanks shall be installed per NFPA 58.



FILL IN AND SIGN WITH INK

APPLICATION FOR PERMIT HEATING OR POWER EQUIPMENT

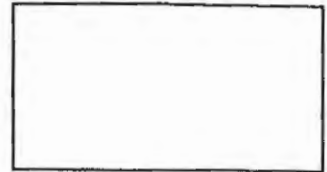

R-2

To the INSPECTOR OF BUILDINGS, PORTLAND, ME.

The undersigned hereby applies for a permit to install the following heating, cooking or power equipment in accordance with the Laws of Maine, the Building Code of the City of Portland, and the following specifications:

Location / CBL 332 A041001 Use of Building Single Family Residential Date 2-8-12
 Name and address of owner of appliance David Sprague 34 Tucker Ave
Portland ME 04103
 Installer's name and address Downeast Energy 177 Main St
South Portland ME 04106 Telephone 799-5585

Location of appliance:

- Basement Floor 2nd
 Attic Roof

Type of Fuel:

- Gas Oil Solid

Appliance Name: Rinnai 556FA

U.L. Approved Yes No

Will appliance be installed in accordance with the manufacture's installation instructions? Yes No

IF NO Explain: _____

The Type of License of Installer:

- Master Plumber # _____
 Solid Fuel # _____
 Oil # _____
 Gas # PWT 1665
 Other _____

Type of Chimney:

- Masonry Lined
 Factory built _____

- Metal
 Factory Built U.L. Listing # _____

Direct Vent
 Type Rinnai UL# _____

Type of Fuel Tank

- Oil
 Gas

Size of Tank 120 gallon

Number of Tanks 1

Distance from Tank to Center of Flame 30' feet.

Cost of Work: \$ 188,000 ^{2,000} ₃₀

Permit Fee: \$ 70

Approved

Approved with Conditions

- See attached letter or requirement

RECEIVED
FEB 08 2012
DEPT. OF PERMITS AND INSPECTION

Fire: _____

Ele.: _____

Bldg.: _____

Inspector's Signature _____

Date Approved _____

Signature of Installer Steve Trudelle / Andrea Farass

White - Inspection Yellow - File Pink - Applicant's Gold - Assessor's Copy

120gallon

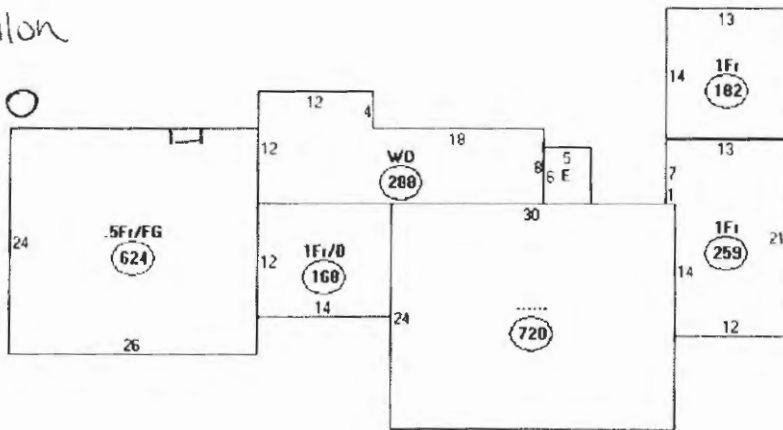

Descriptor/Area

- A:
720 sqft
- B: 1Fr/D
168 sqft
- C: 5Fr/FG
624 sqft
- D: WD
288 sqft
- E: FUB
30 sqft
- F: 1Fr
259 sqft
- G: 1Fr
182 sqft

Assessor's Office | 489 Congress Street | Portland, Maine 04101 | Room 115 | 1-207-474-8106

[Home](#) | [Departments](#) | [City Council](#) | [E-Services](#) | [Calendar](#) | [Jobs](#)

This page contains a detailed description of the Parcel ID you selected. Press the **New Search** button at the bottom of the screen to submit a new query.

Current Owner Information:

Services

[Applications](#)

[Doing Business](#)

[Maps](#)

[Tax Relief](#)

[Tax Roll](#)

[Q & A](#)

[Browse city services 4-7](#)

[Browse facts and links 4-2](#)

CBL 332 A041001
Land Use Type SINGLE FAMILY
Property Location 34 TUCKER AVE
Owner Information BROWN KEVIN K
 34 TUCKER AVE
 PORTLAND ME 04103
Book and Page 18791/197
Legal Description 332-A-41-42-43
 TUCKER AVE 30-34
Acres 7200 SF
 0.165

Current Assessed Valuation:

TAX ACCT NO. 34785 **OWNER OF RECORD AS OF APRIL 2011**
 BROWN KEVIN K
LAND VALUE \$61,700.00 34 TUCKER AVE
BUILDING VALUE \$192,800.00 PORTLAND ME 04103
HOMESTEAD EXEMPTION (\$10,000.00)
NET TAXABLE - REAL ESTATE \$244,500.00
TAX AMOUNT \$4,469.46

Any information concerning tax payments should be directed to the Treasury office at 874-8490 or [e-mailed](mailto:treasury@portmaine.org).



Building Information:

Building 1
Year Built 1940
Style/Structure Type CAPE
Stories 1.5
Bedrooms 3
Full Baths 3
Total Rooms 9
Attic NONE
Basement FULL
Square Feet 2337

[View Sketch](#) [View Map](#) [View Picture](#)



Sales Information:

Sale Date	Type	Price	Book/Page
1/1/2003	LAND	\$0.00	18791/197

[New Search](#)

**HOME OWNER / INSTALLER
FOR YOUR SAFETY
THIS MANUAL MUST BE READ IN ITS
ENTIRETY BEFORE OPERATING HEATER**



**RHFE-556FA III / FTRA III
ENERGYSAVER
GAS DIRECT VENT WALL FURNACE**



Owner's Operation and Installation Manual

WARNING: If the information in these instructions are not followed exactly, a fire or explosion may result causing property damage, personal injury or loss of life.

- Do not store or use gasoline or other flammable vapors and liquids in the vicinity of this or any other appliance.
- **WHAT TO DO IF YOU SMELL GAS**
 - Do not try to light any appliance.
 - Do not touch any electrical switch; do not use any phone in your building.
 - Immediately call your gas supplier from a neighbor's phone. Follow the gas supplier's instructions.
 - If you cannot reach your gas supplier, call the fire department.
- Installation and service must be performed by a qualified installer, service agency or the gas supplier.

This appliance may be installed in an aftermarket, permanently located, manufactured home (USA) or mobile home, where not prohibited by local codes.

This appliance is only for use with the type of gas indicated on the rating plate. This appliance is not convertible for use with other gases, unless a certified kit is used.

INSTALLER: Leave this manual with the appliance.
CONSUMER: Retain this manual for future reference.

Register your product at www.rinnairegistration.com or call 1-866-RINNAI1 (746-6241)

Rinnai[®]

Flue Manifold Installation

- The flue manifold must exhaust to the outside. Do not exhaust into other rooms.
- The flue manifold is not designed to be positioned under floors or below the heater.
- The termination cannot be vertical.
- This appliance can only be used with one of the five types of Rinnai flue kits. The flue kits and their dimensions are listed on the previous page.
- Refer to the Flue Terminal Clearances section.

1. Disassemble the flue manifold

The flue consists of 3 parts:

- sleeve
- inside connection
- outside terminal

Disassemble the flue manifold by first pulling out the inside connection. To remove the outer terminal pull and release the two internal ties and then pull out the outer terminal.

Clearance to combustibles for the sleeve and flanges is zero inches.

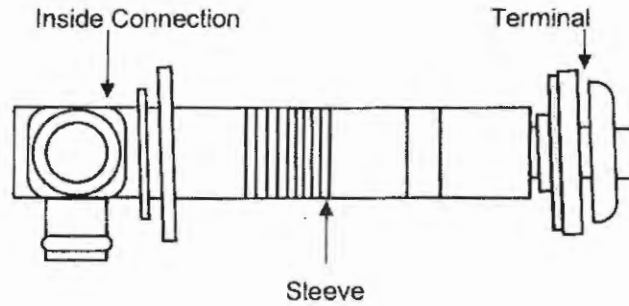

2. Adjust the sleeve length

Measure wall thickness through previously drilled 3 1/8 inch (80 mm) hole.

The end of the sleeve should protrude 3/16 - 3/8 inch (5-10 mm) from the outside wall.

The sleeve is threaded for adjustment. Adjust the sleeve length to wall thickness plus 3/16 - 3/8 inch (5-10 mm).

NOTE: Do not extend beyond the red line.

For other than the "S" type flue manifold, if a shorter length is necessary an extension can be removed. Cut the outer plastic laminate (with a utility knife or similar) and remove the extension. The metal should not be cut.

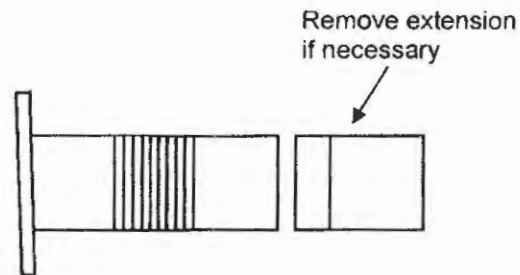

3. Attach the sleeve

Attach to the inside wall using 3 screws arranging the flange so that the marking "TOP" is at the top.

The flange is offset 2° to allow the condensate drain to the outside.

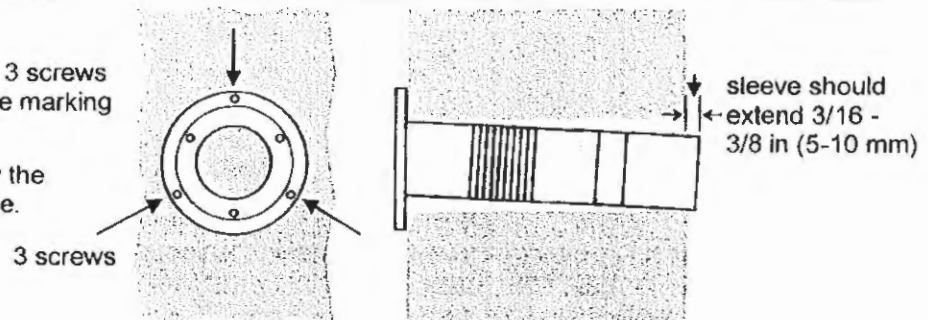

Flue Manifold Installation

4. Install the Terminal

Check that the terminal seal is in place. For weatherboard walls, add the second seal next to the terminal seal to compensate for weather board angle.

From the outside insert the terminal into the sleeve with the marking "TOP" at the top. The left hand side locking tie should be marked "LEFT".

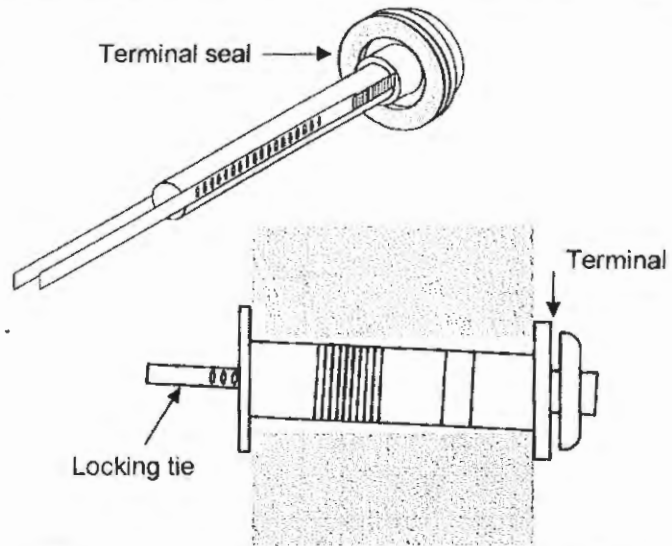

5. Lock the ties

Pulling hard on the left and right hand ties, clip the ties over the notches inside the sleeve. You should be able to pull the ties 2 or 3 notches past the starting point. Cut the ties, leaving about 3/4 inch (20 mm) past the notch. Bend the ties back into the sleeve and parallel to the wall.

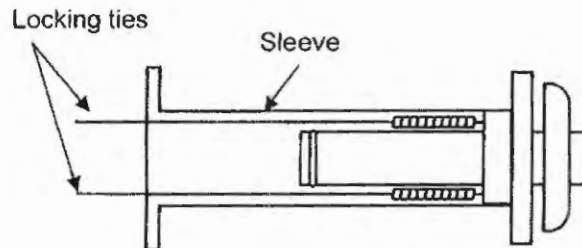

6. Insert Inside Connection Assembly

Push the assembly into the terminal tube, ensuring that the seal is in place on the inner tube.

Attach the inside connection with 3 screws. The inner connection can still be turned to install the screws.

