

GENERAL NOTES

- REFER TO ABBREVIATIONS, SYMBOLS AND GENERAL NOTES ON DRAWING A-001-C FOR ADDITIONAL INFORMATION.

CASEWORK LEGEND

- BASE CABINET (LAB)
- BASE DRAWERS (LAB)
- BASE SINK UNIT (BREAK ROOM) - ADA COMPLIANT
- WALL CABINET (BREAKROOM)
- WALL CABINET (LAB)
- BASE CABINET (BREAKROOM)
- BASE SINK UNIT (LAB) - ADA COMPLIANT
- BASE TABLE (SS)
- BASE TABLE SINK UNIT (SS)

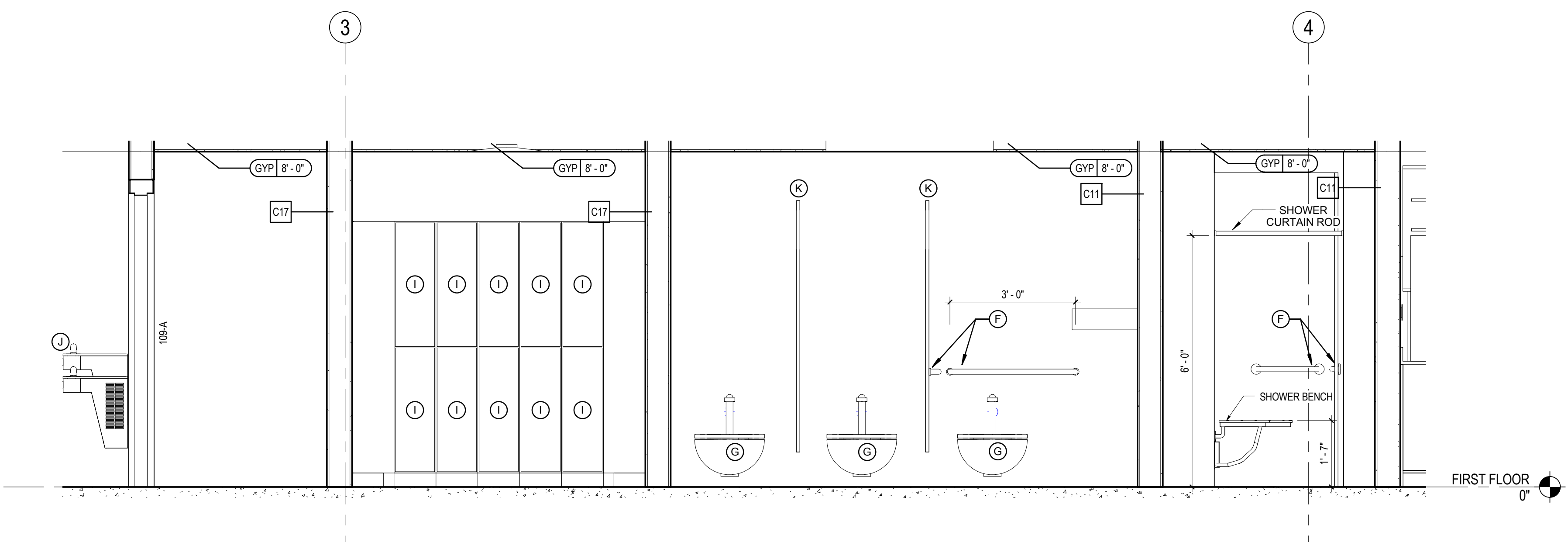

1 LOCKER ROOM INTERIOR ELEVATION
 A-402-C 1/2" = 1'-0"

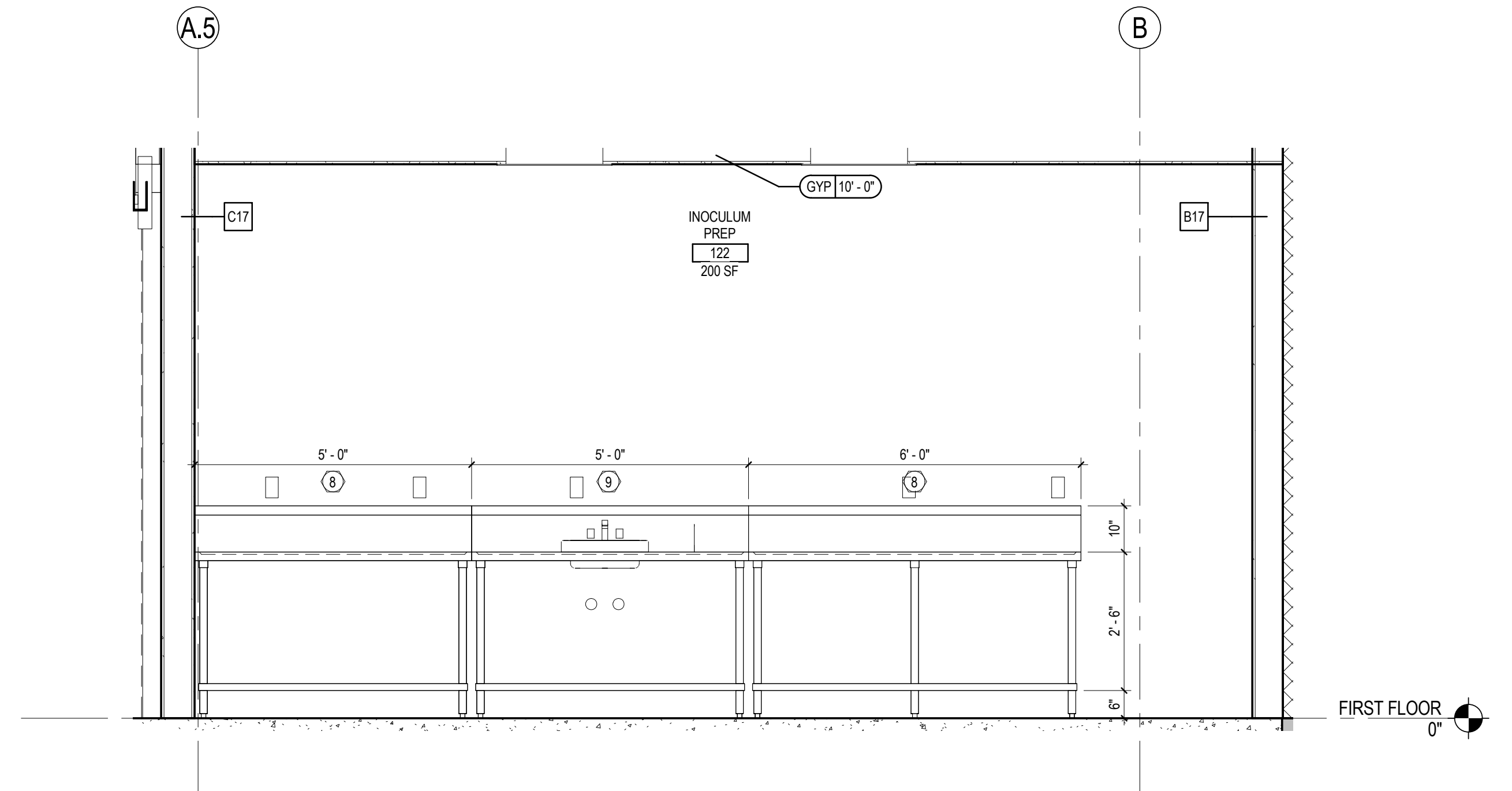

2 INOCULUM PREP INTERIOR ELEVATION
 A-402-C 1/2" = 1'-0"

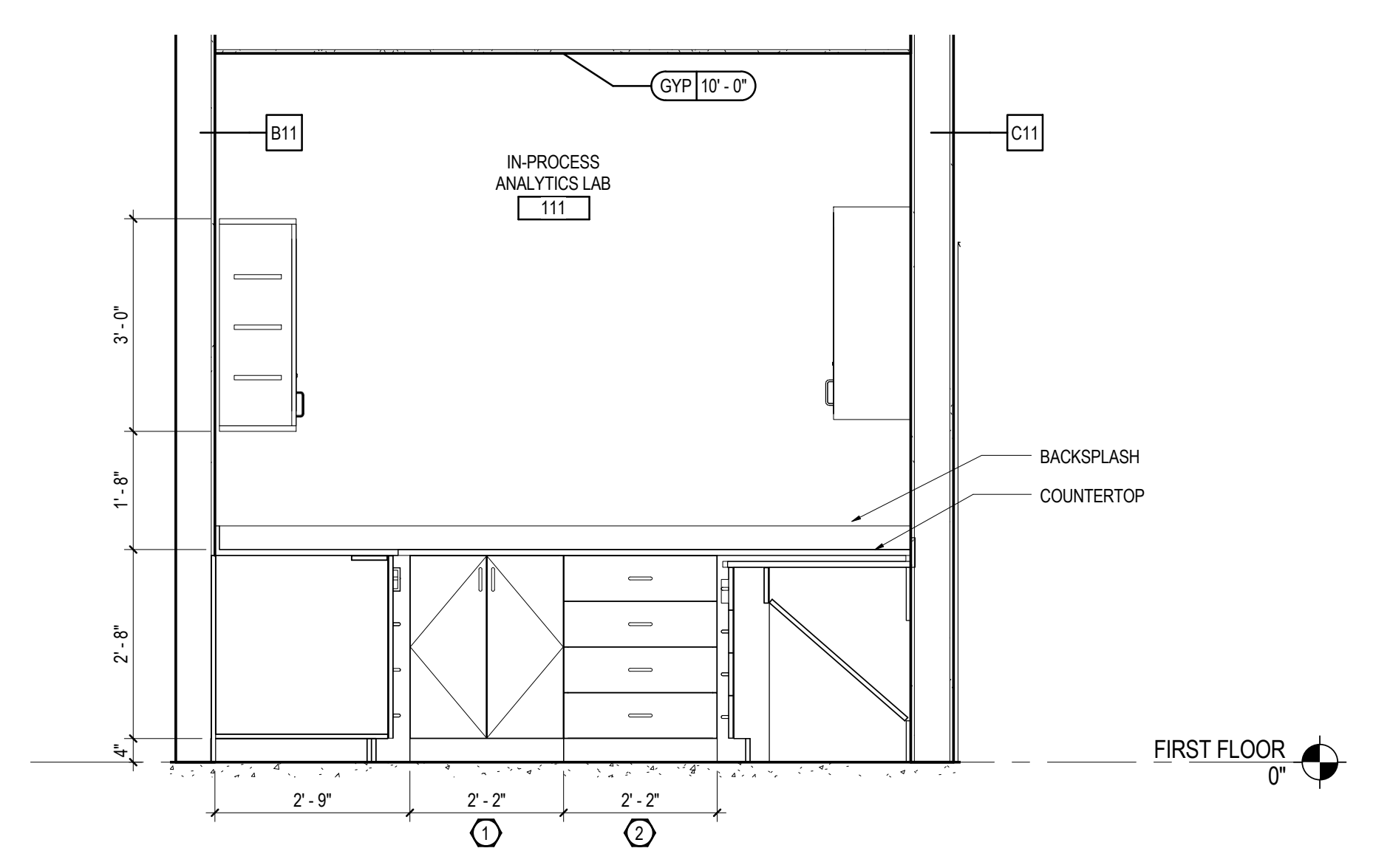

11 IN-PROCESS ANALYTICS LAB NORTH INTERIOR ELEVATION
 A-402-C 1/2" = 1'-0"

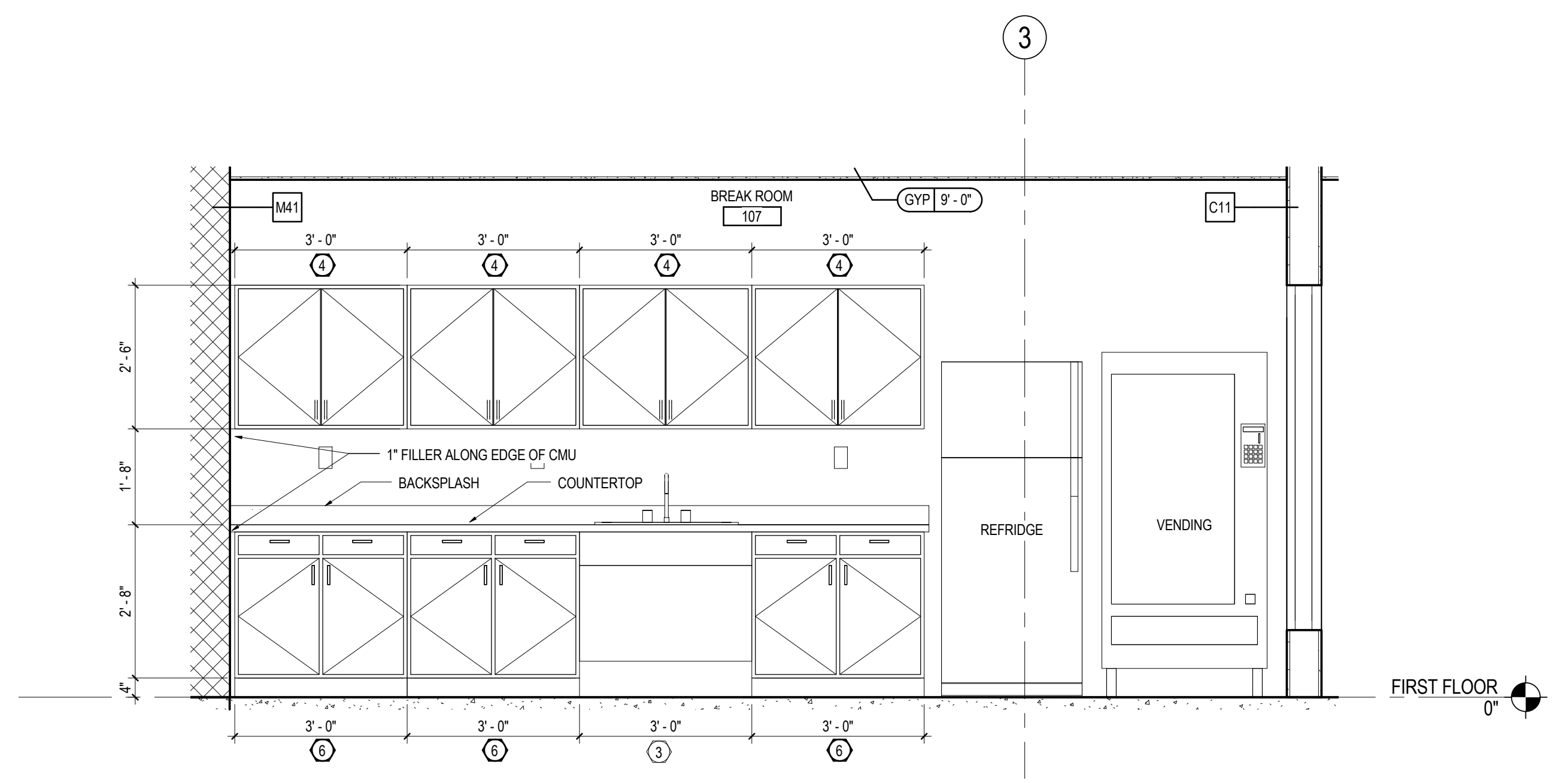

3 BREAK ROOM SOUTH INTERIOR ELEVATION
 A-402-C 1/2" = 1'-0"

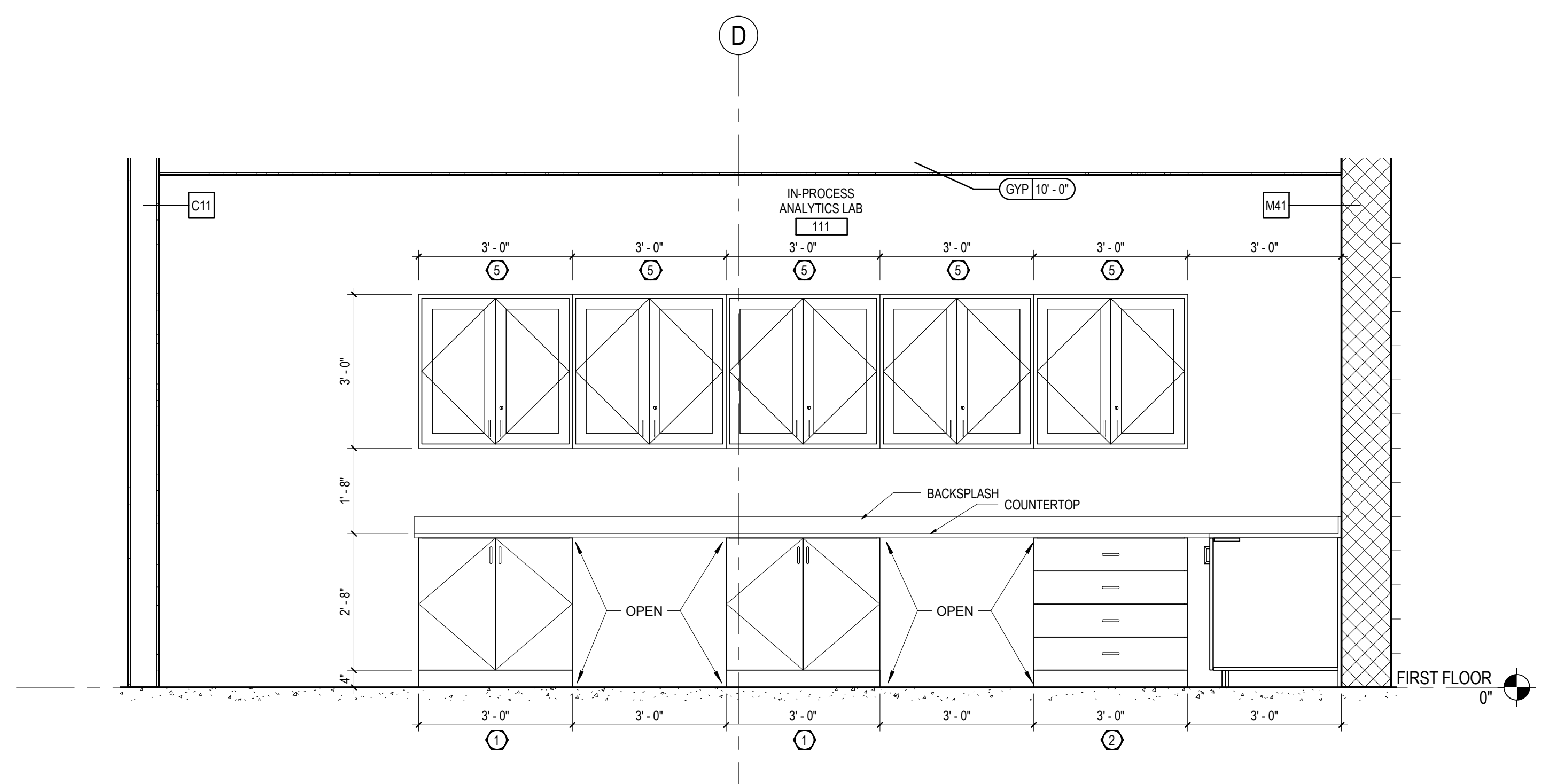

5 IN-PROCESS ANALYTICS LAB WEST INTERIOR ELEVATION
 A-402-C 1/2" = 1'-0"

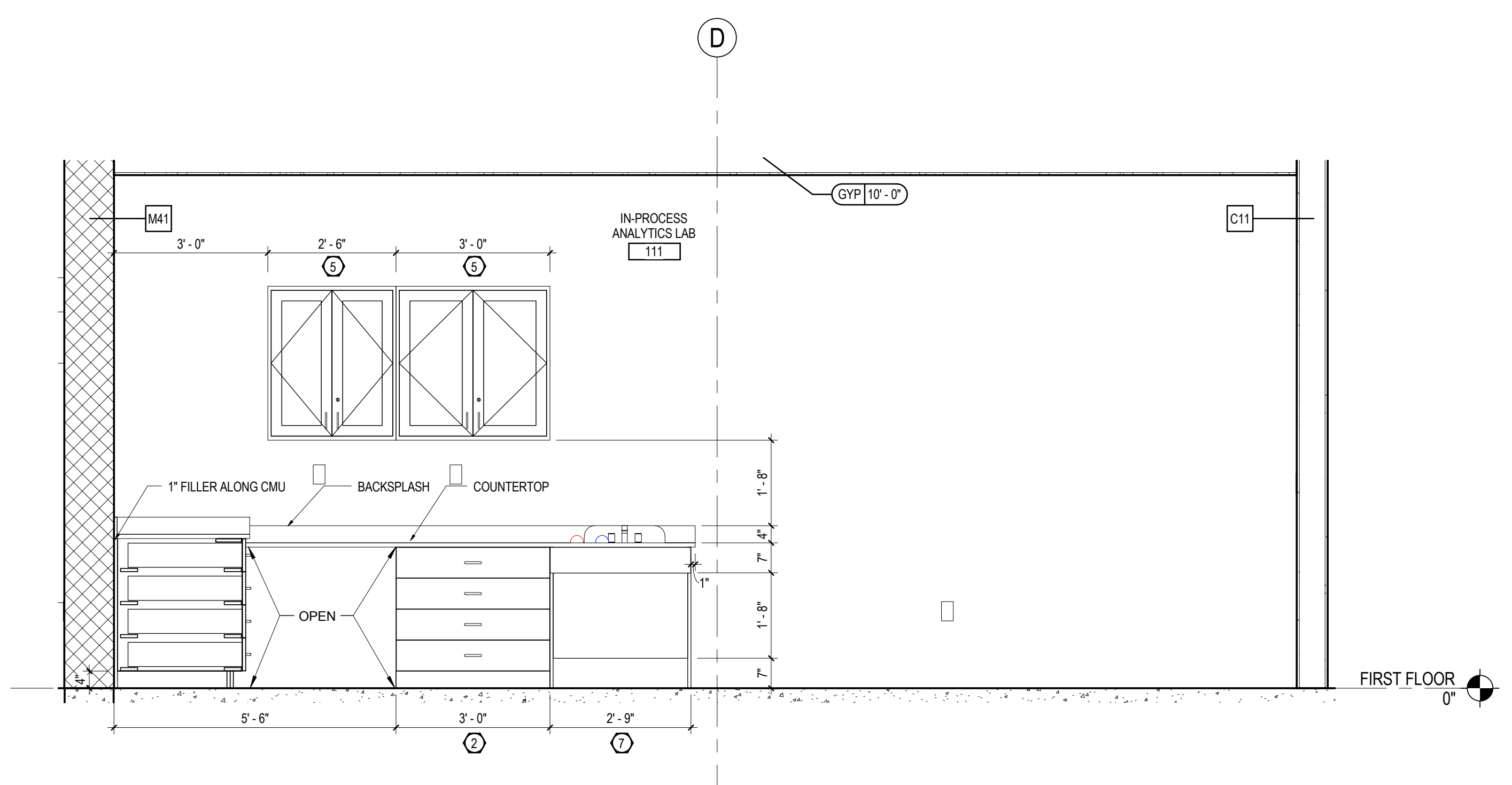

7 IN-PROCESS ANALYTICS LAB EAST INTERIOR ELEVATION
 A-402-C 1/2" = 1'-0"

Revision	By	App'd	MM.DD.YYYY
0	INTERIOR FIT-OUT ISSUED FOR CONSTRUCTION	JLR	KJM 08/19/2016
	Revision		
	PACKAGE C - INTERIOR FIT-OUT		08.19.2016
	PACKAGE B - SUPERSTRUCTURE & SHELL		08.05.2016
	PACKAGE A - FOUNDATIONS & BELOW SLAB		07.22.2016
	Issued	By	App'd MM.DD.YYYY

Permit-Seal

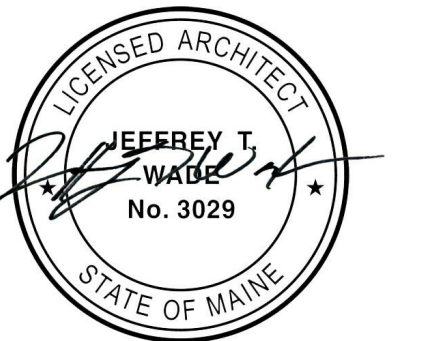

Client/Project
 IMMUCELL

Lot 11 - Second Tee Business Park
 1039 Riverside Street
 Portland, Maine 04103

Title
 ENLARGED PLANS

Project No.
 191504176
 Revision
 0

Scale
 As indicated
 Drawing No.

A-402-C