

GENERAL NOTES

- REFER TO ABBREVIATIONS, SYMBOLS AND GENERAL NOTES ON DRAWING A-301-C FOR ADDITIONAL INFORMATION.

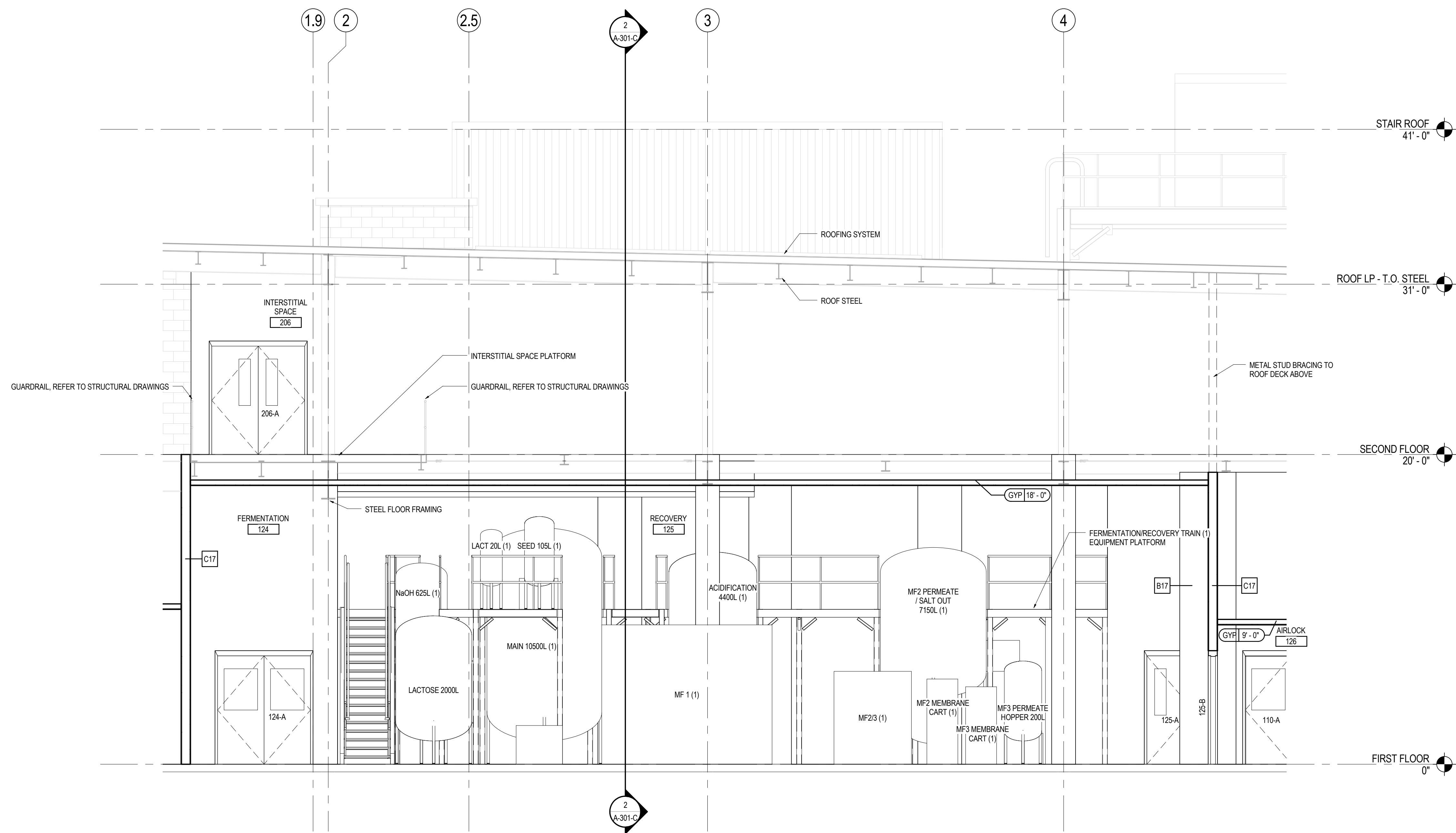

1 BUILDING SECTION C-1
 1/4" = 1'-0"

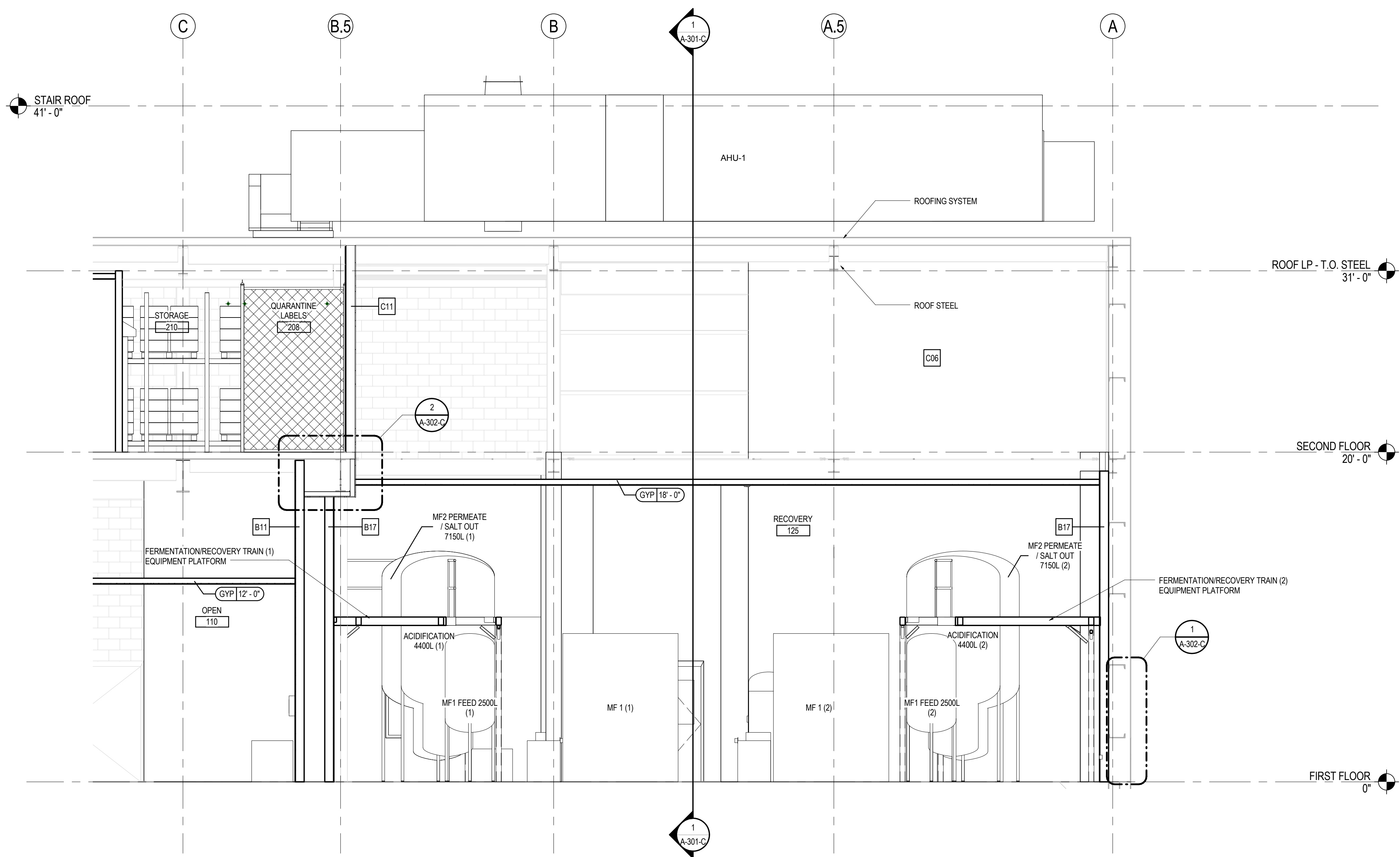

2 BUILDING SECTION C-2
 1/4" = 1'-0"

| REVISION | DATE | BY | APP'D | DESCRIPTION |
|----------|------------|------|--------|--------------------------------------------|
| 0 | 08/19/2016 | J.R. | K.J.M. | INTERIOR FIT-OUT - ISSUED FOR CONSTRUCTION |
| 1 | 08/19/2016 | | | PACKAGE C - INTERIOR FIT-OUT |
| 2 | 08/05/2016 | | | PACKAGE B - SUPERSTRUCTURE & SHELL |
| 3 | 07/22/2016 | | | PACKAGE A - FOUNDATIONS & BELOW SLAB |

Permit-Seal



Client/Project
IMMUCELL

Lot 11 - Second Tee Business Park
 1039 Riverside Street
 Portland, Maine 04103

Title
BUILDING SECTIONS

| Project No. | Scale |
|-------------|--------------|
| 191504176 | 1/4" = 1'-0" |
| Revision | Drawing No. |
| 0 | |



A-301-C