

DOOR SCHEDULE

TAG	DOOR SLAB	SIZE	THICKNESS	SWING	FIRE LABEL	FRAME	WALL THICKNESS	REMARKS
1	ALUM.	3070	1 3/4	RH		ALUM.	4 1/8	FULL GLASS WITH SIDELIGHT
2	HM	3070	1 3/4	LH		HM	4 1/8	24 X 30 INS. GLASS
3	HM	3070	1 3/4	RH		HM	4 1/8	

HARDWARE SCHEDULE	
SET #1	HINGES, CLOSER, LEVER LOCKSET, WEATHERSTRIP, THRESHOLD

NOTE: ALL LOCKS TO BE MASTER KEYED

GENERAL NOTES

BUILDING CODES: MUBEC, IBC 2009, NFPA 1 (2009), NFPA 10, NFPA 13, NFPA 101 (2006), IECC 2009

PERMIT IS FOR THE CONSTRUCTION OF THE SHELL ONLY. SEPARATE PERMITS ARE REQUIRED FOR ANY FUTURE INTERIOR FIT-UP

THIS BUILDING DOES NOT HAVE A SPRINKLER SYSTEM. IF THE FUTURE OCCUPANCY REQUIRES A SPRINKLER SYSTEM, ONE WILL NEED TO BE INSTALLED.

THE BUILDING IS A PRE-ENGINEERED METAL BUILDING BY PACKAGE STEEL SYSTEMS, INC. OF SUTTON, MA.. BUILDING MANUFACTURER TO PROVIDE STRUCTURAL DESIGN, BUILDING ENVELOPE DETAILS, AND LETTER OF CERTIFICATION.

FOUNDATION DESIGN TO BE BY ASSOCIATED DESIGN PROFESSIONALS

ALL DOORS SHALL BE 3'-0" WIDE AND HAVE HANDICAPPED LEVER TYPE HARDWARE

5 LB ABC FIRE EXTINGUISHERS SHALL BE MOUNTED AT EVERY EXIT

HANDICAPPED SIGNAGE SHALL BE MOUNTED AT 5'-0" A.F.F. AT ALL FUTURE BATHROOMS AND EXITS

BATHROOM AND UNDERGROUND PLUMBING WILL BE INSTALLED PER THE CITY ORDINANCES ONCE THE OCCUPANCY HAS BEEN DETERMINED, AND SHALL REQUIRE SEPARATE PERMITS.

THE FUTURE HEATING SYSTEM SHALL MEET CITY ORDINANCES AND SHALL REQUIRE SEPARATE PERMITS

SEPARATE PERMITS ARE REQUIRED FOR THE ELECTRICAL, PLUMBING, AND HVAC WORK

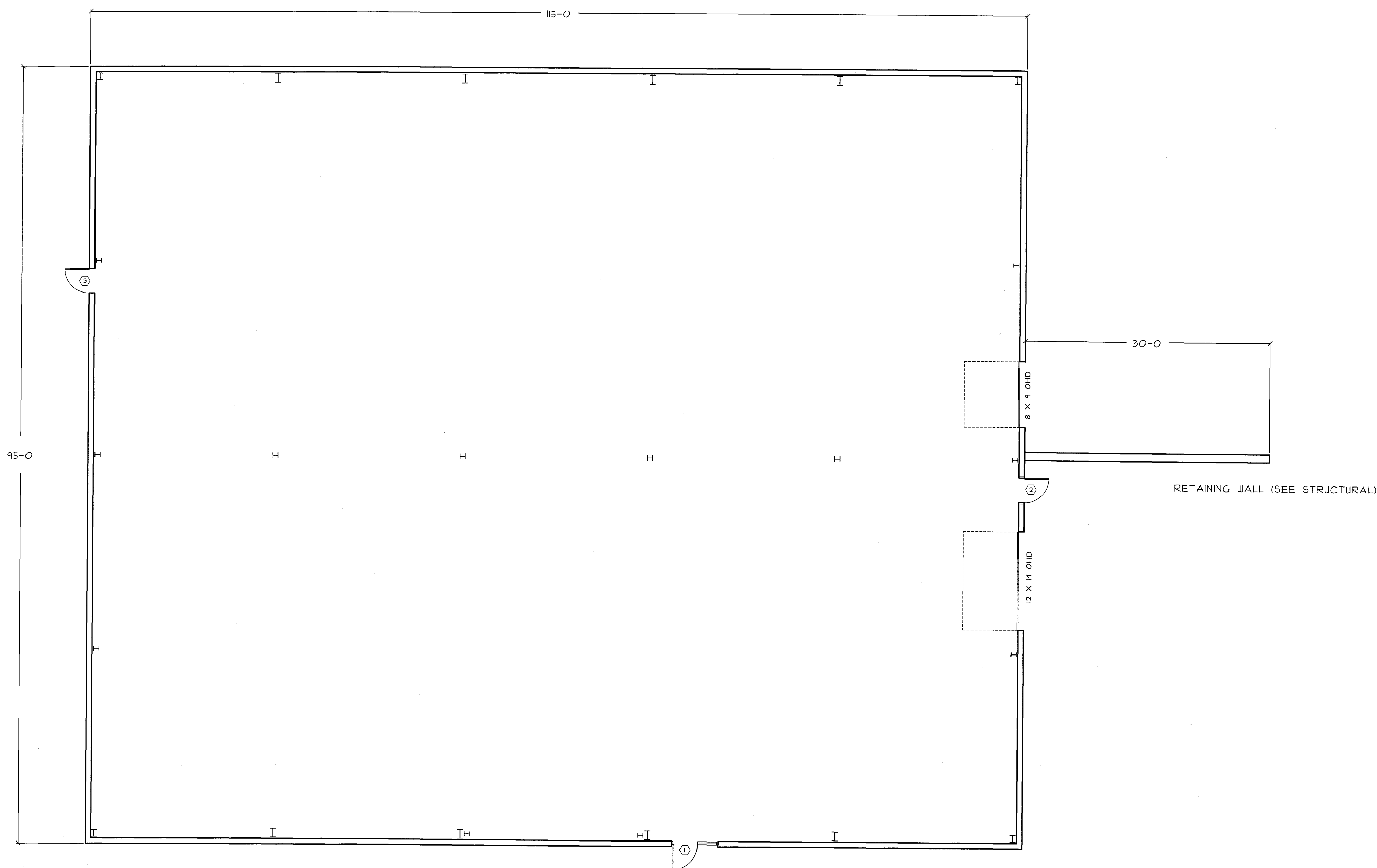

BISKUP CONSTRUCTION, INC.
 16 DANIELLE DRIVE
 WINDHAM, MAINE 04062
 TEL. (207) 892-9800
 FAX. (207) 892-9895
 WWW.BISKUPCONSTRUCTION.COM

STAMP

J. M. STREETER
 ARCHITECTURAL
 ENGINEER

44 CARSOE DRIVE
 PORTLAND, MAINE 04103 (207) 797-3093

PROJECT:

MOONGATE PROPERTIES LLC
 1039 RIVERSIDE STREET
 UNIT #9
 PORTLAND, MAINE

REVISIONS	
DATE	DESCRIPTION

DATE: 11/12/2105
 SCALE: 1/8" = 1'-0"
 DESIGNER: JB
 CHECKED BY: JB

© COPYRIGHT
 BISKUP CONSTRUCTION, INC.

SHEET TITLE

FLOOR PLAN

SHEET NUMBER

A-1

SHEET 1 OF 4