

2003 NFPA: CODE DATA

FIRST FLOOR AREA	25,000 SF
SALES / STORAGE	4,000 SF / 21,000 SF
OCCUPANT LOAD - SALES / STORAGE (1 PERSON/100 SF / (N.A. ASSUME 10 TL)	SALES = 40 PERSONS / STORAGE = 10 PERSONS
USE GROUP CLASSIFICATION	CLASS 'B' MERCHANDISE
TYPE OF CONSTRUCTION	TYPE 3 (III)
ACTUAL BUILDING AREA (1 STORY @ 25,000 SF)	25,000 SF
BUILDING HEIGHT	1 STORY (32 FEET)
FIRE SUPPRESSION	SUPERVISED FIRE SUPPRESSION PROVIDED
FIRE WALL AND PARTY WALLS	1 HOUR
STAIR ENCLOSURES	N/A
SHAFTS	1 HOUR
EXIT ACCESS CORRIDORS	1 HOUR WITH FIRE SUPPRESSION
INTERIOR LOAD BEARING WALLS	1 HOUR RATED
STRUCTURAL MEMBER SUPPORTING WALLS	1 HOUR OR FIRE SUPPRESSION
FLOOR CONSTRUCTION	NA
ROOF CONSTRUCTION	NA
FIRE EXTINGUISHERS	LOCATIONS TO BE VERIFIED IN FIELD BY FIRE CHIEF PRIOR TO INSTALLATION
ARRANGEMENT OF MEANS OF EGRESS:	
DEAD END CORRIDORS	NOT TO EXCEED 50 FT
COMMON PATH OF TRAVEL	NOT TO EXCEED 100 FT
CORRIDOR WIDTH	44 INCHES MIN
FLAME SPREAD RATINGS:	
INTERIOR FINISH REQUIREMENTS	
REQUIRED VERTICAL EXITS	CLASS A OR CLASS B
CORRIDORS PROVIDING EXIT ACCESS	CLASS A OR CLASS B
ROOMS OR ENCLOSED SPACES	CLASS A OR CLASS B
INTERIOR FLOOR FINISH REQUIREMENTS	
REQUIRED VERTICAL EXITS	CLASS 1 OR CLASS 11
CORRIDORS PROVIDING EXIT ACCESS	CLASS 1 OR CLASS 11
ROOMS OR ENCLOSED SPACES	CLASS 1 OR CLASS 11
GENERAL NOTES:	1. ALL PENETRATIONS OF FIRE RATED WALLS AND FLOORS SHALL BE SEALED WITH PROPER APPROVED MATERIALS 2. ALL WORK SHALL CONFORM TO LOCAL REQUIREMENTS, ACCESSIBILITY PER A.D.A.A.C.

IBC: CODE DATA	W - MERCHANDISE
USE GROUP CLASSIFICATION	3B-UNPROTECTED
TYPE OF CONSTRUCTION	25,000 SF
FIRST FLOOR AREA	
TABLE 503 BUILDING AREA LIMITATION-SF	12,500 SF
506.2 STREET FRONTAGE INCREASE - (36.5%)	4,562 SF
506.3 AUTOMATIC SPRINKLER SYSTEM (INCREASE 300 SF-SINCE STORY)	37,500 SF
ALLOWABLE BUILDING AREA-SF	54,562 SF
BUILDING HEIGHT	1 STORY
FIRE SUPPRESSION	FULLY SUPERVISED FIRE SUPPRESSION
FIRE WALL AND PARTY WALLS	1 HOUR
STAIR ENCLOSURES	N/A
SHAFTS	1 HOUR
EXIST ACCESS CORRIDORS	1 HOUR
INTERIOR LOAD BEARING WALLS	1 HOUR OR FIRE SUPPRESSION
STRUCTURAL MEMBER SUPPORTING WALLS	1 HOUR OR FIRE SUPPRESSION
FLOOR CONSTRUCTION	NA
ROOF CONSTRUCTION	NA
FIRE EXTINGUISHERS	LOCATIONS TO BE VERIFIED IN FIELD BY FIRE CHIEF PRIOR TO INSTALLATION
FLAME SPREAD RATINGS:	
REQUIRED VERTICAL EXITS	NA
CORRIDORS PROVIDING EXIT ACCESS	CLASS A OR CLASS B
ROOMS OR ENCLOSED SPACES	CLASS A OR CLASS B
INTERIOR FLOOR FINISH REQUIREMENTS	
REQUIRED VERTICAL EXITS	NA
CORRIDORS PROVIDING EXIT ACCESS	CLASS 1 OR CLASS 11
ROOMS OR ENCLOSED SPACES	CLASS 1 OR CLASS 11
GENERAL NOTES:	1. ALL PENETRATIONS OF FIRE RATED WALLS AND FLOORS SHALL BE SEALED WITH PROPER APPROVED MATERIALS 2. ALL WORK SHALL CONFORM TO LOCAL REQUIREMENTS, ACCESSIBILITY PER A.D.A.A.C.

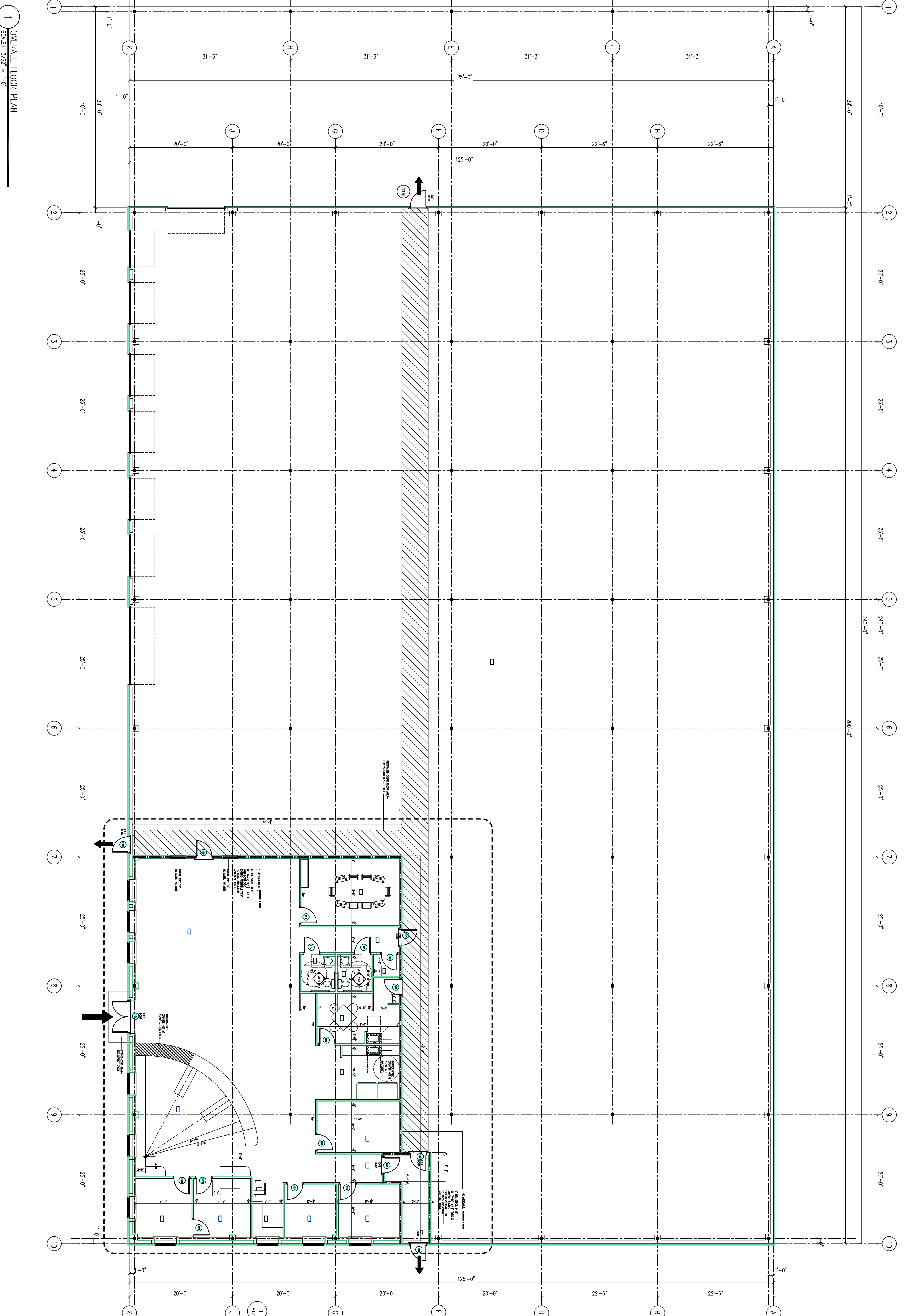

1 OVERALL FLOOR PLAN  
SCALE: 3/32" = 1'-0"

COPYRIGHT 2004  
REUSE OR REPRODUCTION OF THE CONTENTS OF THIS DOCUMENT IS NOT PERMITTED WITHOUT THE PERMISSION OF FORESIDE ARCHITECTS  
**GENERAL NOTES:**

**FORESIDE ARCHITECTS, LLC**  
ARCHITECTURE / PLANNING / INTERIOR DESIGN  
P.O. Box 60736  
Falmouth, Maine 04105  
Phone: 207-781-3844  
Fax: 207-781-4774  
Online: [foresidearchitects.com](http://foresidearchitects.com)

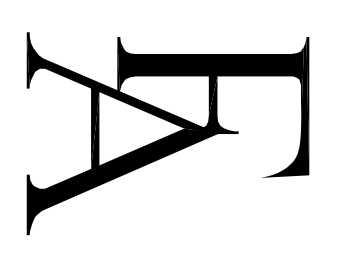

Project Title:  
**Building 7**  
1039 Riverside Street  
Portland, Maine

Drawing Name:  
FIRST FLOOR CODE PLAN

Scale: 3/32" = 1'-0"  
Date: 16 NOVEMBER 2004  
SHEET  
**A0.1**