

Location of Construction: 961 Riverside St		Owner: Micucci Brothers		Phone:		Permit No:	
Owner Address:		Lessee/Buyer's Name: Micucci's		Phone:			Business Name:
Contractor Name: Bailey Sign		Address: 9 Thomas Dr Westbrook, ME 04092		Phone: 774-2843		Permit Issued:	
Past Use: Comm		Proposed Use: Same		COST OF WORK: \$			PERMIT FEE: \$ 44.20
Proposed Project Description: Erect Signage		FIRE DEPT. <input type="checkbox"/> Approved <input type="checkbox"/> Denied		INSPECTION: Use Group: Type:		Zone: CBL: 329-B-007	
		Signature:		Signature:			
		PEDESTRIAN ACTIVITIES DISTRICT (P.A.D.)		Action: <input type="checkbox"/> Approved <input type="checkbox"/> Approved with Conditions <input type="checkbox"/> Denied			Zoning Approval: <b>Special Zone or Reviews:</b> <input type="checkbox"/> Shoreland <input type="checkbox"/> Wetland <input type="checkbox"/> Flood Zone <input type="checkbox"/> Subdivision <input type="checkbox"/> Site Plan maj <input type="checkbox"/> minor <input type="checkbox"/> mm <input type="checkbox"/>
Signature:		Date:					
Permit Taken By: Mary Gresik		Date Applied For: 28 May 1997				<b>Zoning Appeal</b> <input type="checkbox"/> Variance <input type="checkbox"/> Miscellaneous <input type="checkbox"/> Conditional Use <input type="checkbox"/> Interpretation <input type="checkbox"/> Approved <input type="checkbox"/> Denied	

- This permit application does not preclude the Applicant(s) from meeting applicable State and Federal rules.
- Building permits do not include plumbing, septic or electrical work.
- Building permits are void if work is not started within six (6) months of the date of issuance. False information may invalidate a building permit and stop all work..

**CERTIFICATION**

I hereby certify that I am the owner of record of the named property, or that the proposed work is authorized by the owner of record and that I have been authorized by the owner to make this application as his authorized agent and I agree to conform to all applicable laws of this jurisdiction. In addition, if a permit for work described in the application is issued, I certify that the code official's authorized representative shall have the authority to enter all areas covered by such permit at any reasonable hour to enforce the provisions of the code(s) applicable to such permit

SIGNATURE OF APPLICANT: Judy Bailey ADDRESS: \_\_\_\_\_ DATE: 28 May 1997 PHONE: 774-2843

RESPONSIBLE PERSON IN CHARGE OF WORK, TITLE \_\_\_\_\_ PHONE: \_\_\_\_\_

White–Permit Desk Green–Assessor's Canary–D.P.W. Pink–Public File Ivory Card–Inspector

**CEO DISTRICT**

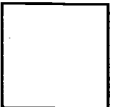

SIGNAGE

PLEASE ANSWER ALL QUESTIONS

Address: 961 Riverside Drive Zone: I-M

Owner: Micucci Foods Assessors #: 329-B-007

Applicant: Barley Sign

Free Standing Sign: 35' max 18' high  
10' max - 6' high  
over 5' for signs

Single Tenant Lot?: Yes  No

Multi Tenant Lot?: Yes  No

Freestanding (Ext pole sign)? Yes  No  Dimensions 3' x 6' - 18 sqft

More than (1) one sign?: Yes  No  Dimensions \_\_\_\_\_

Bldg Wall sign (att to bldg)? Yes  No  Dimensions 2' x 39' 6" = 78 sqft

List all existing signage and their dimensions:

none

156' x 29' = 4368 sqft = 267.08 sq ft MAX

Lot Frontage(feet): 300' Tenant Frontage(feet): 156'

AWNINGS

Awning?: Yes  No  Is Awning Backlit?: Yes  No

Is there any communication, message, trademark or symbol on awning? \_\_\_\_\_

Height of Awning?: \_\_\_\_\_

PLEASE NOTE: Approvals for signs on the Public Sidewalk and temporary signs come under different requirements and regulations.

ALSO: See reverse side for additional information, requirements and materials needed for signage application submittal.

Wall area is

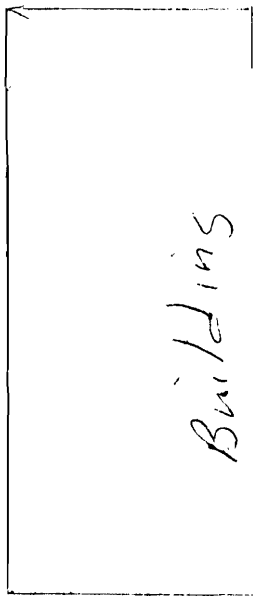
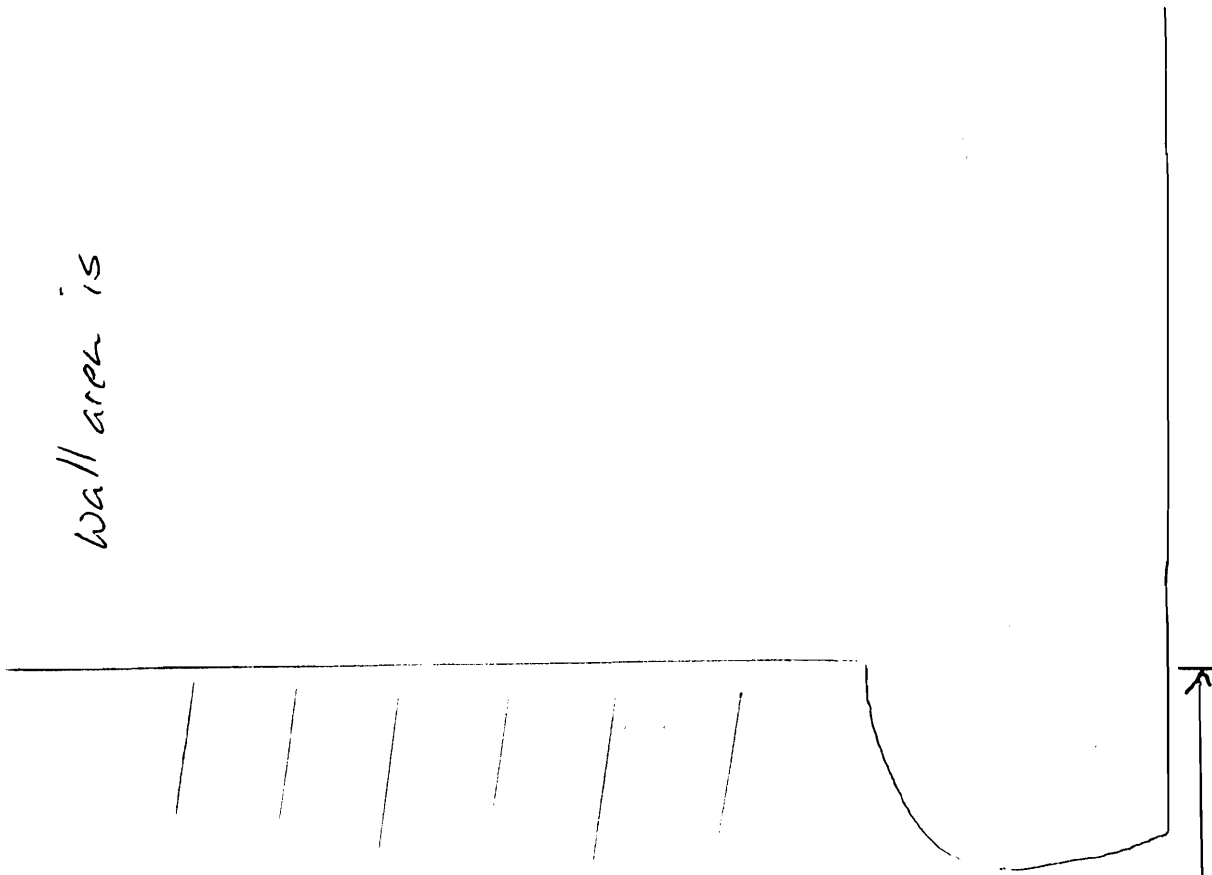

Letters on wall

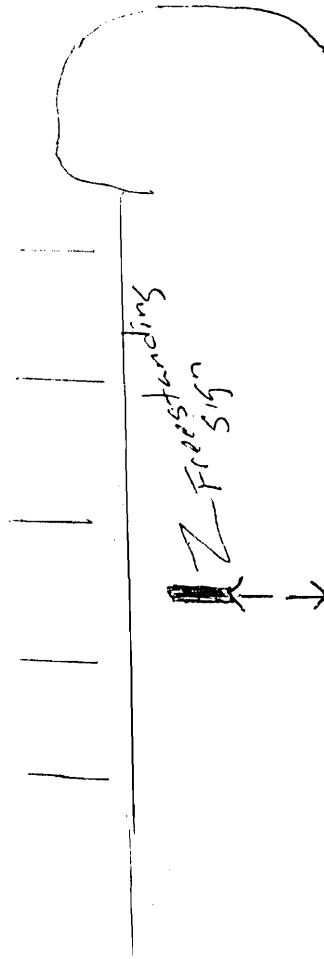

Freestanding sign

Riverside Drive



DEPT. OF BUILDING INSPECTION  
CITY OF PORTLAND, ME  
MAY 28 1997



1" STRIPES  
RED GREEN RED

6'-0"

CAB. + RETAINER: BRONZE  
WHITE BIG  
HEL HED @ 100% SP+100  
COLORS: RED LT / GR SHADOW  
HEL. MED @ 100%  
COLOR: RED

COLORS: G.F. & S.G.S. DUQUE RED  
G.F. & T.O.O. ERIN GREEN

1 - 3F - 3' x 6' INTERN. ILLUM. SIGHTSEE SIGN

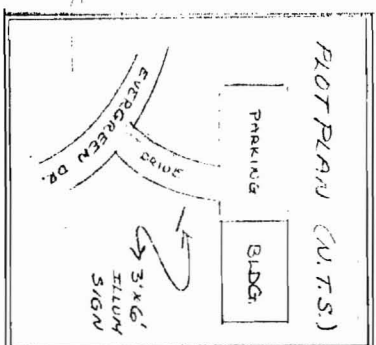

FINAL MFG. PRINT  
DATE 7/1/97

Hendriks  
Permit

SIGN SPECIFICATIONS		ILLUMINATED		LOCATION		DATE	
CABINET TYPE	SF	HEIGHT	LENGTH	WIDTH	RADIUS	MATERIAL	COLOR
CROWN	RET Color	HANGING BAR	DIV DATA Color	LAMPS	BALLAST		
FACE 1	Material	Color	COPY	Color	BIG	Color	SEAMS
FACE 2	Material	Color	COPY	Color	ROWS TRACK	RAB into Brand Gauge	Size Color
BUILDING TYPE	ELEC LOC	MOUNTING		LOAD			
POLE COVER	HGT to BOT.	MATERIAL	Color	SERVICING			
(face)	(side)						

*This design is the exclusive property of Bailey Sign Incorporated and all rights to its use or reproduction are reserved.*



9 Thomas Drive  
Col. Westbrook Executive Park  
Westbrook, ME 04092  
774-2843  
1 800 543-SIGN

39'-6" RUNNING LENGTH

2-0"  
HELVETICA (BOLD)

# MICUCCI WHOLESALE FOODS

(1) SET of FORMED PLASTIC LETTERS for BLDG. FRONT & ALUM. BANDS for FRONT & SIDE

SCALE: 1/4"=1'

LETTERS = FEDERAL GREEN 0259 GEMINI (BEST COMMERCIAL MATCH TO ALLIANCE BY GREEN)  
TYPEFACE = HELVETICA (BOLD)

BANDS ARE 9" IN WIDTH OF \_\_\_\_\_" ALUMINUM (BY GREEN (INSIDE BAND) & HUNTER RED (OUTSIDE BANDS).  
COLORS ARE ALLIANCE STOCK STANDARD COLORS

*wall area  
is 33' x 43'6"*

PERMIT PRINT

FINAL MFG. PRINT  
DATE 5/23/97  
OK PER RLB

PLOT PLAN APPROX. 1/16"=1'

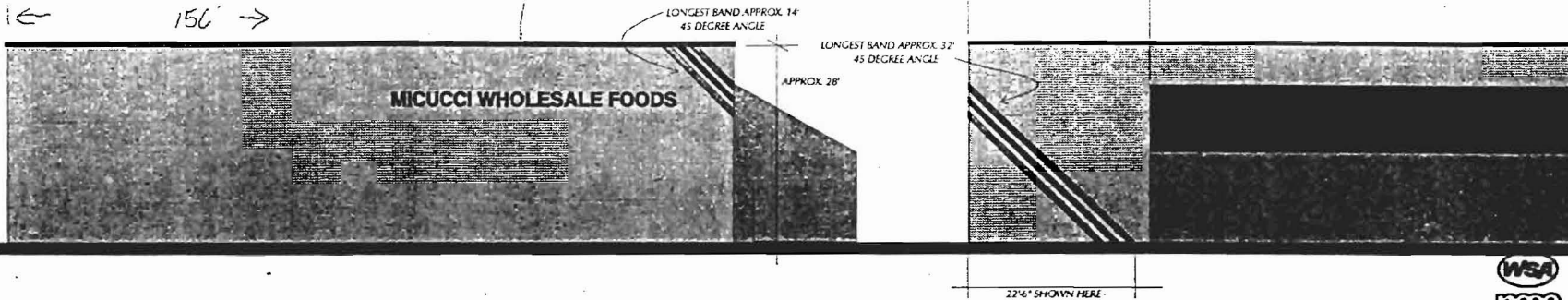

NEED TO SURVEY ACTUAL V.O.

22'-6" SHOWN HERE

### SPECIAL INFORMATION

PLEASE NOTE:  
THIS IS A PROGRESS PRINT. SOME DETAILS MAY BE CHANGED AND MAY BE NECESSARY TO BE RE-PRINTED.  
THIS DESIGN IS THE EXCLUSIVE PROPERTY OF THE DESIGNER. ALL RIGHTS RESERVED. NO REPRODUCTION IS PERMITTED.  
COLORS SHOWN HERE ARE FOR GUIDANCE ONLY. COLOR MATCH NUMBERS WILL BE NECESSARY.  
IF AN ELECTRIC SIGN, THEN INSTALLATION MUST BE ACCOMPLISHED IN TOTAL TO MEET ALL LOCAL, STATE, NATIONAL ELECTRICAL CODES, THE SIGNIFICANCE OF THE SIGNIFIERS LABORATORY, CALIFORNIA SIGNIFICANCE ASSOCIATION, AND APPLICABLE LOCAL CODES.



9 Thomas Drive  
Col. Westbrook Executive Park  
Westbrook, ME 04092  
207-774-2043 / 1-800-539-5118  
© COPYRIGHT 1997

CUSTOMER: MICUCCI FOOD  
LOCATION: RIVERSIDE  
PORTLAND, ME

SALESPERSON: R. BENN  
DRAWN BY: L.W. MERRIFIELD

ACCEPTANCE SIGNATURE \_\_\_\_\_ DATE \_\_\_\_\_  
SALES CLIENT \_\_\_\_\_

P.S.# D-998 W.O.# \_\_\_\_\_  
SCALE AS INDICATED DATE 5/2/97

REVISIONS: 5/15/97 COPY CORRECTION  
5/23/97 COLOR CHANGE



DRAWING NO: 03554 A R2  
SHEET 1