

DOOR SCHEDULE					
NO.	QUANTITY	SIZE	TYPE	FRAME	REMARKS
1	2	EXISTING 3'-0" x 7'-0"	EXISTING FULL GLASS STOREFRONT	METAL	HINGES, PUSH BAR, D-RING PULL HANDLE, CLOSER, ENTRY LOCKSET
2	4	EXISTING 3'-0" x 6'-8"	EXISTING SOLID WOOD	METAL	HINGES, LEVER HARDWARE, ENTRY LOCKSET
3	2	EXISTING 3'-0" x 6'-8"	EXISTING SOLID WOOD	METAL	HINGES, PUSH PLATE, PULL HANDLE, CLOSER
4	1	EXISTING 3'-0" x 6'-8"	EXISTING HOLLOW METAL	METAL	HINGES, LEVER HARDWARE, PRIVACY LOCKSET
5	3	EXISTING 3'-0" x 7'-0"	EXISTING METAL INSULATED	METAL	HINGES, EXTERIOR LEVER HARDWARE, INTERIOR PANIC HARDWARE, ENTRY LOCKSET, CLOSER
6	3	EXISTING VARIES	EXISTING STALL	METAL	HINGES, LEVER HARDWARE, PRIVACY LOCKSET
7	1	EXISTING 3'-0" x 6'-8"	EXISTING HOLLOW METAL	METAL	HINGES, LEVER HARDWARE, ENTRY LOCKSET, CLOSER, INTERIOR PANIC HARDWARE
8	1	EXISTING 3'-0" x 6'-8"	EXISTING HALF GLASS SOLID WOOD	METAL	HINGES, LEVER HARDWARE
9	2	3'-0" x 6'-8"	HOLLOW METAL	METAL	HINGES, LEVER HARDWARE, ENTRY LOCKSET
10	1	3'-0" x 6'-8"	EXISTING HOLLOW METAL	METAL	HINGES, LEVER HARDWARE, CHANGE TO PRIVACY LOCKSET
11	2	3'-0" x 6'-8"	HOLLOW METAL	METAL	HINGES, LEVER HARDWARE

WINDOW SCHEDULE				
NO.	QUANTITY	UNIT DIMENSION	TYPE	FRAME
A	1	5'-0" x 5'-0"	STOREFRONT	METAL

LEGEND	
	EXISTING WALL
	PROPOSED WALL
	EXIT SIGN
	EMERGENCY LIGHTING
	FIRE EXTINGUISHER
	BRAILLE SIGNAGE

- ### PLAN SUBMISSION NOTES & CODE SUMMARY
- THIS PLAN IS FOR CITY OF PORTLAND BUILDING CODE, LIFE SAFETY CODE, ADA, FIRE MARSHAL AND OCCUPANCY APPROVAL ONLY.
 - PLAN BASED ON PLAN PROVIDED BY THE LESSOR.
 - THE PLUMBING, ELECTRICAL, AND MECHANICAL DESIGN OF THE BUILDING IS BY THE OWNER.
 - IBC USE GROUP: ASSEMBLY (A-3)
 - NFPA LIFE SAFETY OCCUPANCY: ASSEMBLY
 - CONSTRUCTION TYPE: TYPE V B (UNPROTECTED) PRE-ENGINEERED METAL BUILDING EXTERIOR WITH INTERIOR FIRE RETARDANT WOOD SHEATHING FOR PLATFORMS WITH METAL STUD FRAMING
 - BUILDING FULLY EQUIPPED WITH NFPA 13 SPRINKLED SYSTEM
 - ALLOWABLE BUILDING HEIGHT = (2) STORIES (SPRINKLED)
 - TABULAR BUILDING AREA PER STORY = 6,000 SF
 - ALLOWABLE BUILDING AREA PER STORY = $\{6,000 + [6,000 \times (311/671) - 25] \times (30/30)\} + (6,000 \times 3) = 25,281$ SF
 - CONCEALED SPACE UNDER FIRE RETARDANT WOOD FRAMED PLATFORMS NOT TO BE SPRINKLED PER NFPA 13 SECTION 8.15.1.2.11
 - TOTAL OCCUPANT LOAD FOR THE BUILDING IS BASED ON THE REQUIREMENTS OF ASTM F2970-13 STANDARD PRACTICE FOR DESIGN, MANUFACTURE, INSTALLATION, OPERATION, MAINTENANCE, INSPECTION AND MAJOR MODIFICATION OF TRAMPOLINE COURTS, WHICH LIMITS THE BUILDING TO 152 PARTICIPANTS. SEE THE ATTACHED LETTER.

STATE OF MAINE
BENJAMIN MURRAY
NO. 10128
LICENSED PROFESSIONAL ENGINEER

E.S. COFFIN
ENGINEERING & SURVEYING
© 2008

E.S. COFFIN ENGINEERING & SURVEYING, INC.
432 Com. Road P.O. Box 4687 Augusta, Maine 04330
Ph. (207) 623-9475 Fax (207) 623-0016 Toll Free 1-800-244-9475

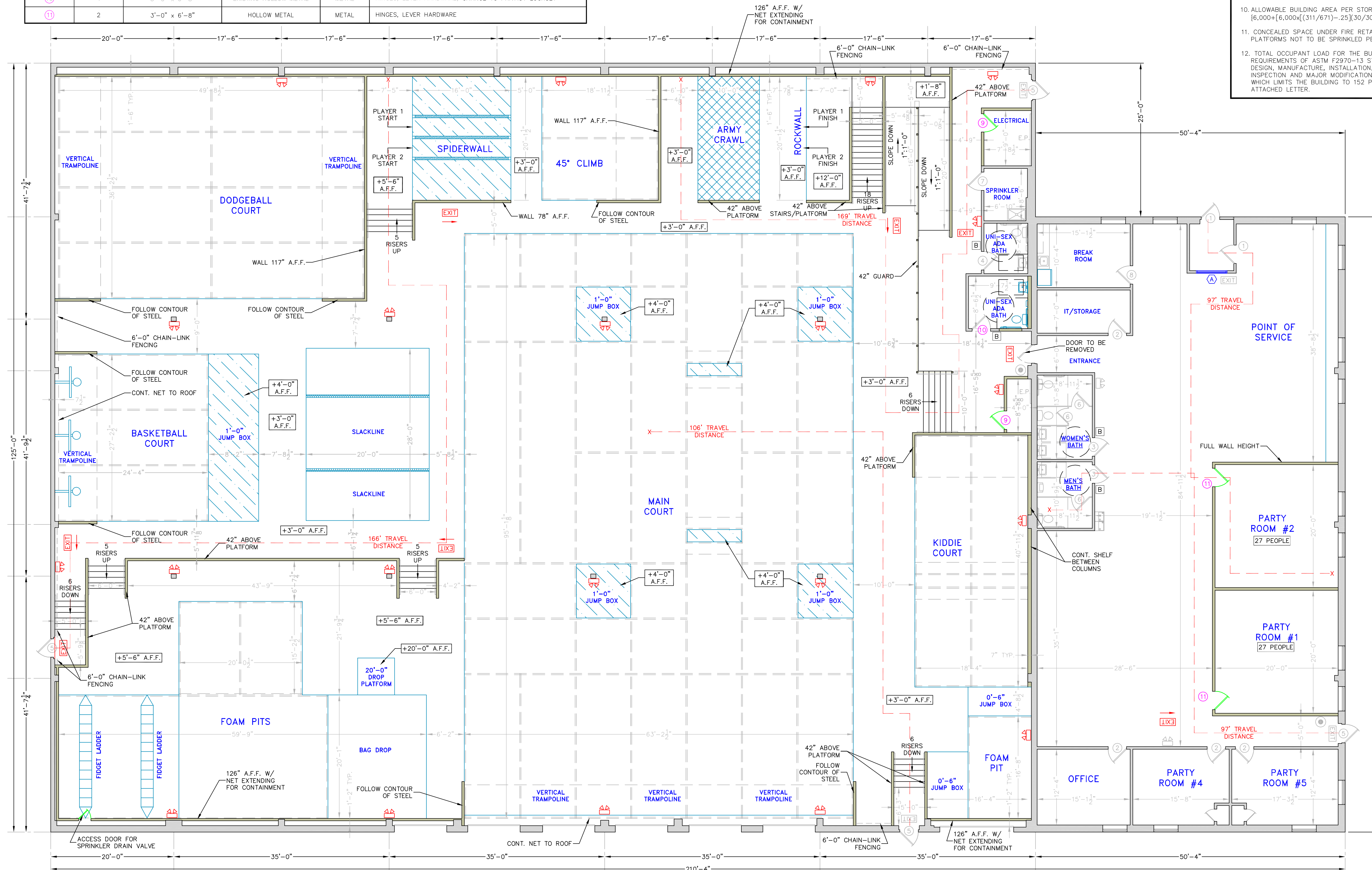

FLOOR PLAN
SCALE 1/4" = 1'-0"

NO.	DATE	REVISIONS
1	07-28-14	ADDED TRAVEL DISTANCE/OCCUPANT LOAD

CLIENT & PROJECT: GET AIR PORTLAND FITUP PLAN
LOCATION: 921 RIVERSIDE STREET
TOWN: PORTLAND COUNTY: CUMBERLAND STATE: MAINE

SCALE: 1/8" = 1'-0"
DATE: JUNE 25, 2014

DRAWN BY: JPK
CHECKED BY: BEM

PROJ. NO. 2014-112