

DOOR SCHEDULE					
NO.	QUANTITY	SIZE	TYPE	FRAME	REMARKS
1	2	EXISTING 3'-0" x 7'-0"	EXISTING FULL GLASS STOREFRONT	METAL	HINGES, PUSH BAR, D-RING PULL HANDLE, CLOSER, ENTRY LOCKSET
2	4	EXISTING 3'-0" x 6'-8"	EXISTING SOLID WOOD	METAL	HINGES, LEVER HARDWARE, ENTRY LOCKSET
3	2	EXISTING 3'-0" x 6'-8"	EXISTING SOLID WOOD	METAL	HINGES, PUSH PLATE, PULL HANDLE, CLOSER
4	1	EXISTING 3'-0" x 6'-8"	EXISTING HOLLOW METAL	METAL	HINGES, LEVER HARDWARE, PRIVACY LOCKSET
5	3	EXISTING 3'-0" x 7'-0"	EXISTING METAL INSULATED	METAL	HINGES, EXTERIOR LEVER HARDWARE, INTERIOR PANIC HARDWARE, ENTRY LOCKSET, CLOSER
6	3	EXISTING VARIES	EXISTING STALL	METAL	HINGES, LEVER HARDWARE, PRIVACY LOCKSET
7	1	EXISTING 3'-0" x 6'-8"	EXISTING HOLLOW METAL	METAL	HINGES, LEVER HARDWARE, ENTRY LOCKSET, CLOSER, INTERIOR PANIC HARDWARE
8	1	EXISTING 3'-0" x 6'-8"	EXISTING HALF GLASS SOLID WOOD	METAL	HINGES, LEVER HARDWARE
9	2	3'-0" x 6'-8"	HOLLOW METAL	METAL	HINGES, LEVER HARDWARE, ENTRY LOCKSET
10	1	3'-0" x 6'-8"	EXISTING HOLLOW METAL	METAL	HINGES, LEVER HARDWARE, CHANGE TO PRIVACY LOCKSET
11	2	3'-0" x 6'-8"	HOLLOW METAL	METAL	HINGES, LEVER HARDWARE

WINDOW SCHEDULE				
NO.	QUANTITY	UNIT DIMENSION	TYPE	FRAME
A	1	5'-0" x 5'-0"	STOREFRONT	METAL

LEGEND	
	EXISTING WALL
	PROPOSED WALL
	EXIT SIGN
	EMERGENCY LIGHTING
	FIRE EXTINGUISHER
	BRAILLE SIGNAGE

- PLAN SUBMISSION NOTES & CODE SUMMARY**
- THIS PLAN IS FOR CITY OF PORTLAND BUILDING CODE, LIFE SAFETY CODE, ADA, FIRE MARSHAL AND OCCUPANCY APPROVAL ONLY.
 - PLAN BASED ON PLAN PROVIDED BY THE LESSOR.
 - THE PLUMBING, ELECTRICAL, AND MECHANICAL DESIGN OF THE BUILDING IS BY THE OWNER.
 - IBC USE GROUP: ASSEMBLY (A-3)
 - NFPA LIFE SAFETY OCCUPANCY: ASSEMBLY
 - CONSTRUCTION TYPE: TYPE V B (UNPROTECTED) PRE-ENGINEERED METAL BUILDING EXTERIOR WITH INTERIOR FIRE RETARDANT WOOD SHEATHING FOR PLATFORMS WITH METAL STUD FRAMING
 - BUILDING FULLY EQUIPPED WITH NFPA 13 SPRINKLED SYSTEM
 - ALLOWABLE BUILDING HEIGHT = (2) STORIES (SPRINKLED)
 - TABULAR BUILDING AREA PER STORY = 6,000 SF
 - ALLOWABLE BUILDING AREA PER STORY = $\{6,000 + [(311/671) - 25] (30/30)\} + (6,000)(3) = 25,281$ SF
 - CONCEALED SPACE UNDER FIRE RETARDANT WOOD FRAMED PLATFORMS NOT TO BE SPRINKLED PER NFPA 13 SECTION 8.15.1.2.11

STATE OF MAINE
 BENJAMIN MURRAY
 NO. 10128
 LICENSED PROFESSIONAL ENGINEER

E.S. COFFIN
 ENGINEERING & SURVEYING
 432 Com. Road P.O. Box 4687 Augusta, Maine 04330
 Ph. (207) 623-9475 Fax (207) 623-0616 Toll Free 1-800-244-9475

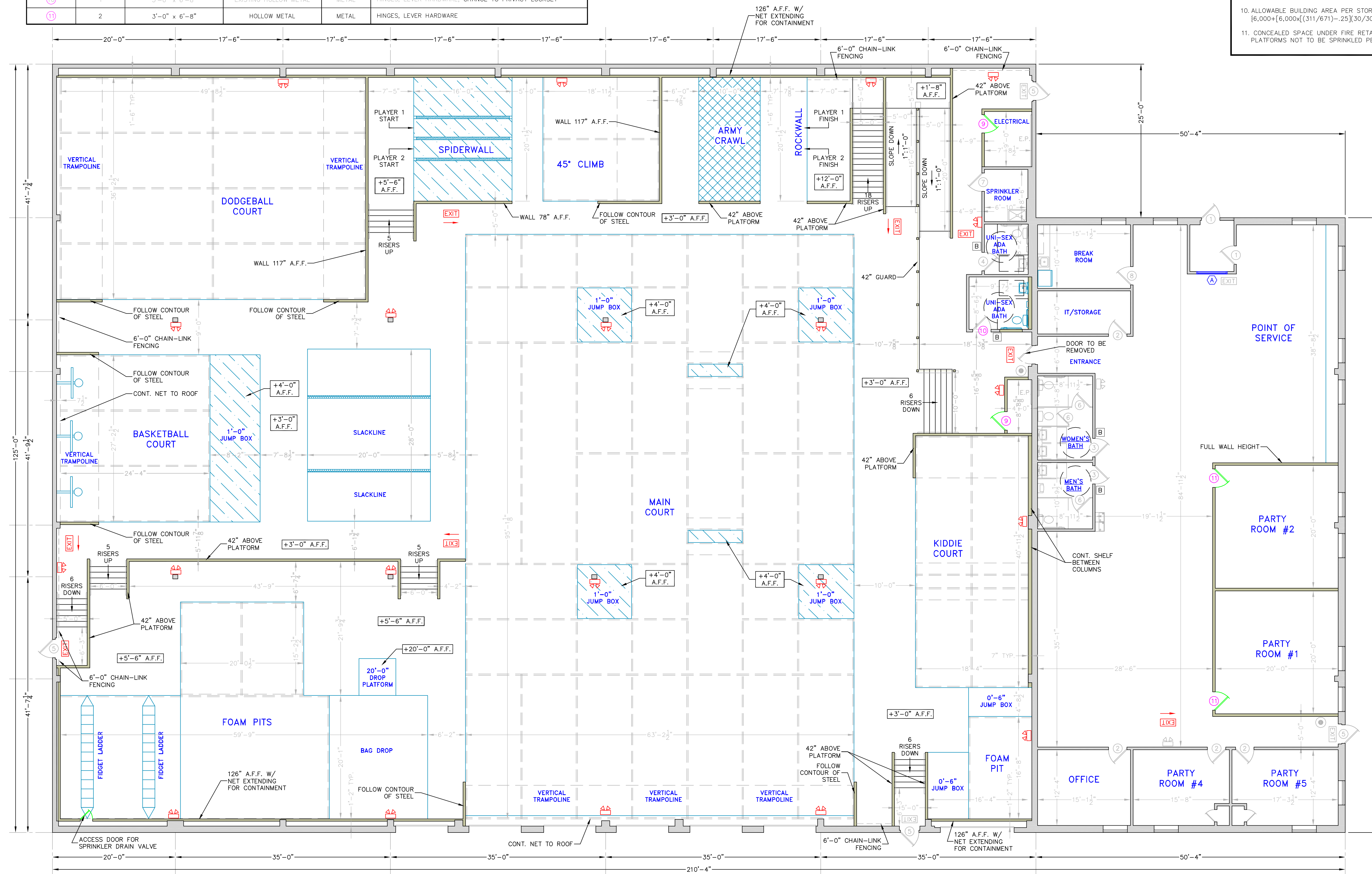

FLOOR PLAN
 SCALE 1/4" = 1'-0"

SHEET TITLE: **FLOOR PLAN**

CLIENT & PROJECT: **GET AIR PORTLAND FITUP PLAN**

LOCATION: **921 RIVERSIDE STREET**

TOWN: **PORTLAND** COUNTY: **CUMBERLAND** STATE: **MAINE**

PROJ. NO. **2014-112**

SCALE: **1/8" = 1'-0"**

DATE: **JUNE 16, 2014**

DRAWN BY: **JPK**
 CHECKED BY: **BEM**

NO. _____ DATE _____

REVISIONS _____