

HARRIMAN

AUBURN PORTLAND MANCHESTER

IMMUCELL CORPORATION ADDITION

PORTLAND, MAINE

Harriman Project No. 14326

Key Plan Proj North

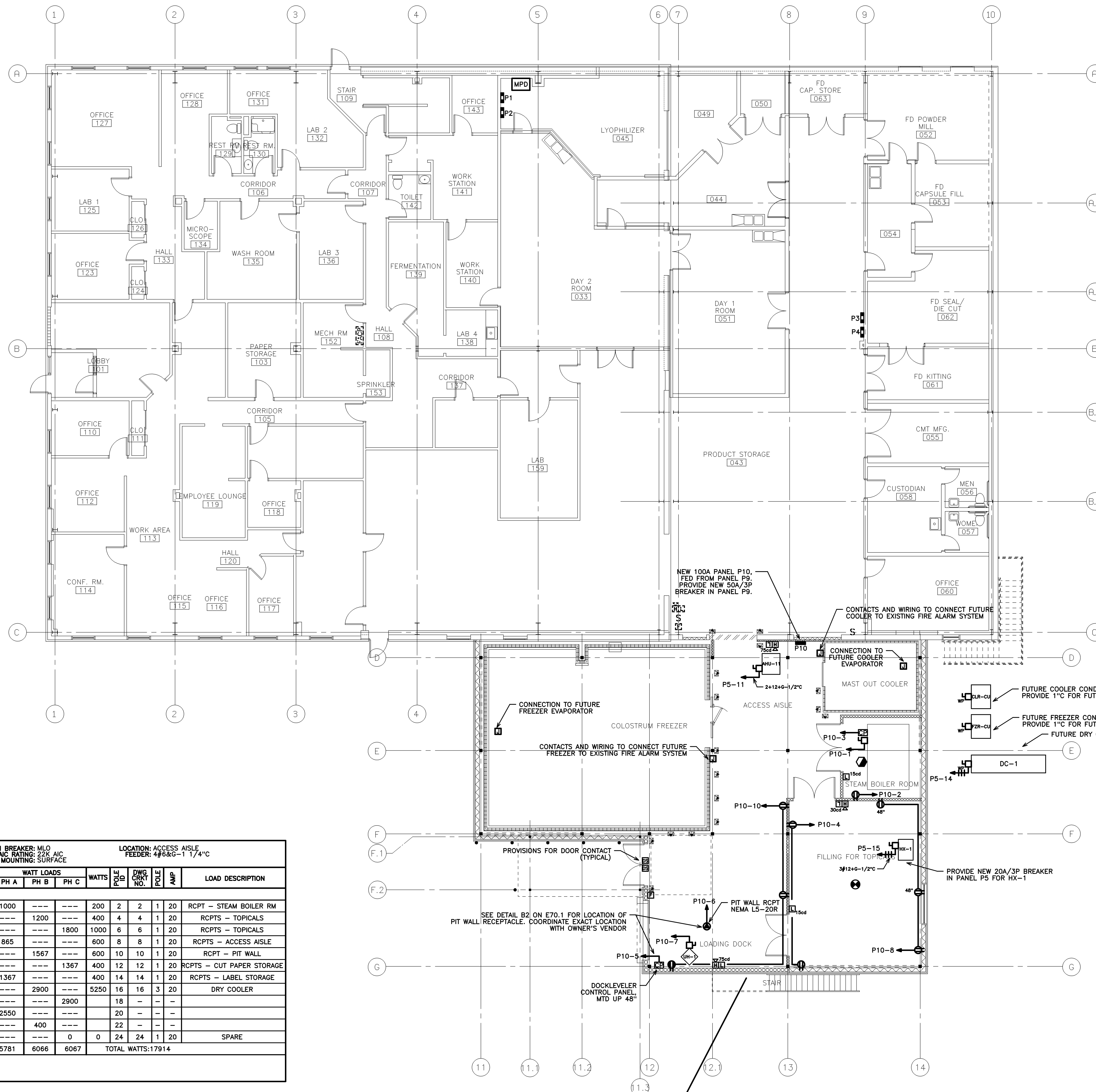

NOTES:
ALL NEW FIRE ALARM DEVICES SHALL BE TIED INTO EXISTING HONEYWELL FIRE ALARM SYSTEM.

P10		VOLTAGE: 120/208 PH & WIRES: 3P 4W BUSES: 100A		MAIN BREAKER: MLO AIC RATING: 22K AIC MOUNTING: SURFACE		LOCATION: ACCESS AISLE FEEDER: #6&G-1 1/4"	
LOAD DESCRIPTION	PH A	PH B	PH C	WATTS	WATT LOADS	WATT LOADS	LOAD DESCRIPTION
TUB 1 OF 1 - REMARKS:	PH A	PH B	PH C	WATTS	PH A	PH B	PH C
STEAM BOILER	20	1	1	800	1000	---	---
STEAM BOILER CTRL PNL	20	1	3	3	800	---	1200
DOCK LVLR CTRL PNL	15	1	5	5	800	---	1800
UNIT HEATER	20	1	7	7	265	865	---
AHU 12	30	3	9	9	2900	---	1567
				11	---	---	1367
				13	---	---	1367
AHU 11	15	2	15	15	2300	---	2900
				17	---	---	2900
CHEM STORAGE	20	1	19	19	800	2550	---
CHEM STORAGE	20	1	21	21	400	---	400
SPARE	20	1	23	23	0	---	0
TOTAL AMPS: 49.7					5781	6066	6067
TOTAL WATTS: 17914							

Issue or Revisions	Mark	Date	Description
	-	07-01-14	PROGRESS
	-	07-25-14	ISSUED FOR CONSTRUCTION

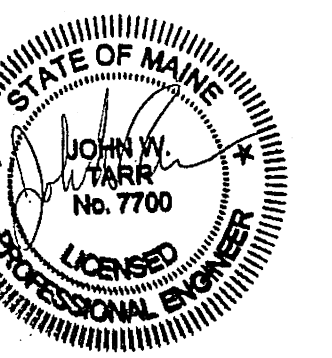

PA / PE: JWS
Drawn By: BSO

ELECTRICAL FIRST FLOOR POWER PLAN

E20.1