



HARRIMAN

AUBURN PORTLAND MANCHESTER

IMMUCELL CORPORATION ADDITION

PORTLAND, MAINE

Harriman Project No. 14326

Key Plan

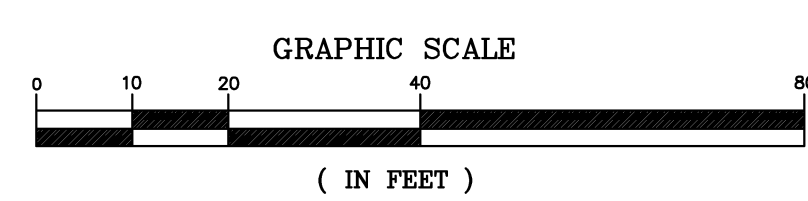
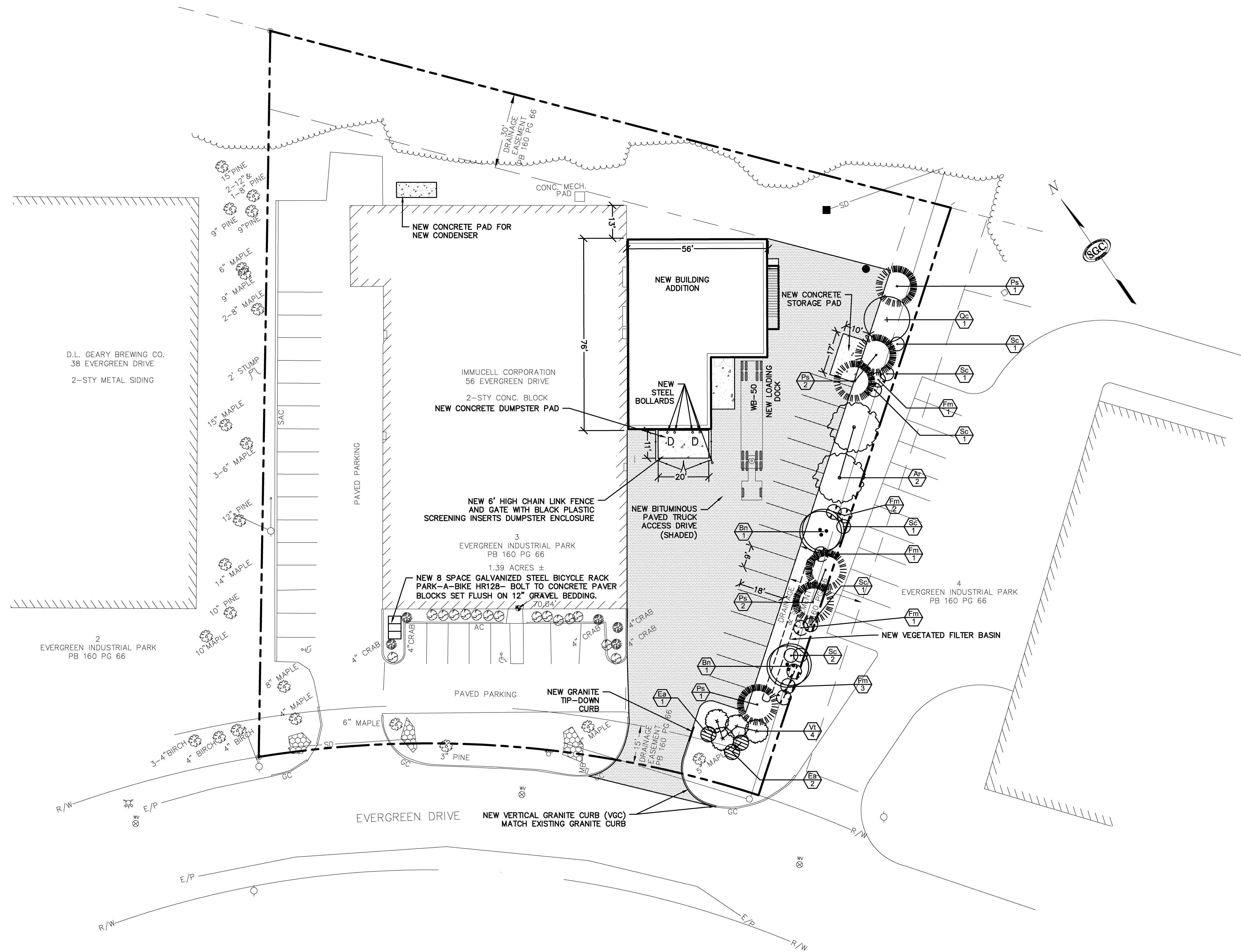

Plant Schedule

Qty	Code	Common Name	Botanical Name	Size	Notes
Deciduous Trees					
2	Ar	Red Maple	Acer rubrum 'Red Sunset'	2 1/2-3" C B&B	as shown
2	Bn	River Birch	Betula nigra	8-10' H	clump
1	Qc	Scarlet Oak	Quercus coccinea	2-2 1/2" C B&B	as shown
Coniferous Trees					
6	Ps	White Pine	Pinus strobus	5-6' H B&B	as shown
Shrubs & Perennials					
4	Vt	Doublefile Viburnum	Viburnum tomentosum	4.5' H	as shown
8	Fm	Meadowlark Forsythia	Forsythia 'Meadowlark'	2-3' H Potted	as shown
7	Sc	Adams Elderberry	Sambucus canadensis 'Adams'	5G	as shown
3	Ea	Dwarf Burning Bush	Euonymus alatus 'Compactus'	3-4' H B&B	as shown

Issues and Revisions

Mark	Date	Description
	05-22-14	PLANNING BOARD REVIEW
	06-24-14	PLANNING BOARD REVISION
	07-10-14	PLANNING AUTHORITY APPROVAL
	07-25-14	ISSUED FOR CONSTRUCTION

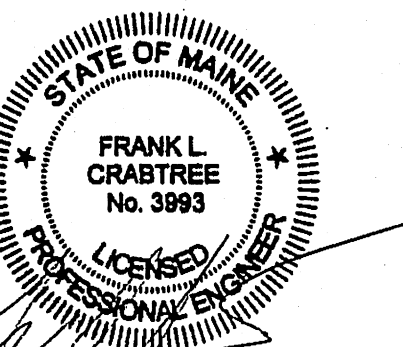

PA / PE: FLC
 Drawn By: PLS
 © 2014
 Harriman Associates

SITE PLAN

C1