

DISPLAY THIS CARD ON PRINCIPAL FRONTAGE OF WORK CITY OF PORTLAND

Please Read Application And Notes, If Any, Attached

BUILDING INSPECTION PERMIT

Permit Number: 070369

This is to certify that NMP LLC /Sign Design Inc

has permission to Install a 8' x 8' freestanding s

AT 75 INDUSTRIAL WAY

327A A009001

PERMIT ISSUED
APR 23 2007
CITY OF PORTLAND

provided that the person or persons who accept this permit shall comply with all of the provisions of the Statutes of the City of Portland and of the Ordinances of the City of Portland relating to the construction, maintenance and use of buildings and structures, and of the application on file in this department.

Apply to Public Works for street line and grade if nature of work requires such information.

Notification of inspection must be given and when permission is procured before this building or part thereof is altered or enclosed-in-4 HOUR NOTICE IS REQUIRED.

A certificate of occupancy must be procured by owner before this building or part thereof is occupied.

OTHER REQUIRED APPROVALS

Fire Dept. _____

Health Dept. _____

Appeal Board _____

Other _____
Department Name

Thomas M. Mackley 4/23/07
Director - Building & Inspection Services

PENALTY FOR REMOVING THIS CARD

City of Portland, Maine - Building or Use Permit Application

389 Congress Street, 04101 Tel: (207) 874-8703, Fax: (207) 874-8716

Permit No: 07-0369	Issue Date:	CBL: 327A A009001
-----------------------	-------------	----------------------

Location of Construction: 75 INDUSTRIAL WAY	Owner Name: NMP LLC	Owner Address: 75 INDUSTRIAL WAY	Phone:
Business Name:	Contractor Name: Sign Design Inc	Contractor Address: PO Box 207 Westbrook	Phone: 2078562600
Lessee/Buyer's Name	Phone:	Permit Type: Signs - Permanent	Zone: I-M

Past Use: Commercial	Proposed Use: Commerical Install a 8' x 8' freestanding sign	Permit Fee: \$158.00	Cost of Work: \$158.00	CEO District: 5
Proposed Project Description: Install a 8' x 8' freestanding sign		FIRE DEPT: <input type="checkbox"/> Approved <input type="checkbox"/> Denied	INSPECTION: Use Group: B Type: SB IBC 2003 Signature: Jm 4/23/07	
		PEDESTRIAN ACTIVITIES DISTRICT (P.A.D.) Action: <input type="checkbox"/> Approved <input type="checkbox"/> Approved w/Conditions <input type="checkbox"/> Denied Signature: _____ Date: _____		

Permit Taken By: dmartin	Date Applied For: 04/06/2007	Zoning Approval	
-----------------------------	---------------------------------	------------------------	--

<ol style="list-style-type: none"> This permit application does not preclude the Applicant(s) from meeting applicable State and Federal Rules. Building permits do not include plumbing, septic or electrical work. Building permits are void if work is not started within six (6) months of the date of issuance. False information may invalidate a building permit and stop all work.. 	Special Zone or Reviews <input type="checkbox"/> Shoreland <input type="checkbox"/> Wetland <input type="checkbox"/> Flood Zone <input type="checkbox"/> Subdivision <input type="checkbox"/> Site Plan Maj <input type="checkbox"/> Minor <input type="checkbox"/> MM <input type="checkbox"/> Date: 4/19/07	Zoning Appeal <input type="checkbox"/> Variance <input type="checkbox"/> Miscellaneous <input type="checkbox"/> Conditional Use <input type="checkbox"/> Interpretation <input type="checkbox"/> Approved <input type="checkbox"/> Denied Date: _____	Historic Preservation <input checked="" type="checkbox"/> Not in District or Landmark <input type="checkbox"/> Does Not Require Review <input type="checkbox"/> Requires Review <input type="checkbox"/> Approved <input type="checkbox"/> Approved w/Conditions <input type="checkbox"/> Denied Date: _____
	4/19/07 use permit # 07-0325 signed by [signature]	OK [signature]	[signature]

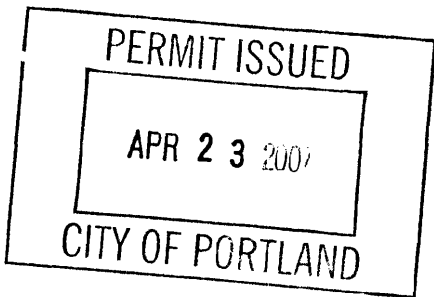

CERTIFICATION

I hereby certify that I am the owner of record of the named property, or that the proposed work is authorized by the owner of record and that I have been authorized by the owner to make this application as his authorized agent and I agree to conform to all applicable laws of this jurisdiction. In addition, if a permit for work described in the application is issued, I certify that the code official's authorized representative shall have the authority to enter all areas covered by such permit at any reasonable hour to enforce the provision of the code(s) applicable to such permit.

SIGNATURE OF APPLICANT	ADDRESS	DATE	PHONE
RESPONSIBLE PERSON IN CHARGE OF WORK, TITLE		DATE	PHONE

City of Portland, Maine - Building or Use Permit

389 Congress Street, 04101 Tel: (207) 874-8703, Fax: (207) 874-8716

Permit No: 07-0369	Date Applied For: 04/06/2007	CBL: 327A A009001
------------------------------	--	-----------------------------

Location of Construction: 75 INDUSTRIAL WAY	Owner Name: NMP LLC	Owner Address: 75 INDUSTRIAL WAY	Phone:
Business Name:	Contractor Name: Sign Design Inc	Contractor Address: PO Box 207 Westbrook	Phone (207) 856-2600
Lessee/Buyer's Name	Phone:	Permit Type: Signs - Permanent	

Proposed Use: Commerical Install a 8' x 8' freestanding sign	Proposed Project Description: Install a 8' x 8' freestanding sign
--	---

Dept: Zoning **Status:** Approved with Conditions **Reviewer:** Marge Schmuckal **Approval Date:** 04/19/2007

Note: **Ok to Issue:**

- 1) This permit is being approved on the basis of additional plans submitted. Any deviations shall require a separate approval before starting that work.

Dept: Building **Status:** Approved with Conditions **Reviewer:** Tom Markley **Approval Date:** 04/23/2007

Note: **Ok to Issue:**

- 1) Application approval based upon information provided by applicant. Any deviation from approved plans requires separate review and approval prior to work.
- 2) Signage Installation to comply with Chapter 31 of the IBC 2003 building code.

Comments:

4/9/2007-mes: I am noticing that the change of use permit has not been issued yet. It is pending the Fire Dept. and Building Codes review. This needs to be issued prior to the accessory sign permit. Also did not show on the submitted plot plan as to where this sign is being placed. It must be a minimum of 5' from the property line.

4/19/2007-mes: Got more info from Doug H. - change of use permit signed off by fire & bldg so I can sign off on the sign permit



Signage/Awning Permit Application

If you or the property owner owes real estate or personal property taxes or user charges on any property within the City, payment arrangements must be made before permits of any kind are accepted.

Location/Address of Construction: <u>75 Industrial way</u>		
Tax Assessor's Chart, Block & Lot Chart# Block# Lot#	Owner: <u>SAME</u>	Telephone:
Lessee/Buyer's Name (If Applicable) <u>Industrial Auto Supply</u> <u>23 Evergreen Dr.</u> <u>Portland ME</u>	Contractor name, address & telephone: <u>Sign Design</u> <u>P.O. Box 207</u> <u>Westbrook</u>	Total s.f. of signage x \$2.00 Per s.f. plus \$30.00/\$65.00 For H.D. signage= Total <u>64 sq.</u> Fee: \$ _____ Awning Fee= cost of work _____ Total Fee: \$ <u>150.</u>
Who should we contact when the permit is ready: <u>Doug</u> phone: <u>856-2600</u>		
Tenant/allocated building space frontage (feet): Length: <u>60' +/-</u> Height: <u>12' +/-</u> Lot Frontage (feet) <u>120' +/-</u> Single Tenant or Multi Tenant Lot <u>Multi</u>		
Current Specific use: _____ If vacant, what was prior use: <u>Vacant New Bldg</u> Proposed Use: <u>Auto market</u>		
Information on proposed sign(s): Freestanding (e.g., pole) sign? Yes <input checked="" type="checkbox"/> No <input checked="" type="checkbox"/> Dimensions proposed: <u>8x8</u> Height from grade: <u>10' "</u> Bldg. wall sign? (attached to bldg) Yes <input type="checkbox"/> No <input checked="" type="checkbox"/> Dimensions proposed: _____		
Proposed awning? Yes <input type="checkbox"/> No <input checked="" type="checkbox"/> Is awning backlit? Yes <input type="checkbox"/> No <input checked="" type="checkbox"/> Height of awning: _____ Length of awning: _____ Depth: _____ Is there any communication, message, trademark or symbol on it? Yes <input type="checkbox"/> No <input checked="" type="checkbox"/> If yes, total s.f. of panels w/communications, message, trademark or symbol: _____ s.f.		
Information on existing and previously permitted sign(s): Freestanding (e.g., pole) sign? Yes <input type="checkbox"/> No <input checked="" type="checkbox"/> Dimensions: _____ Bldg. wall sign? (attached to bldg) Yes <input type="checkbox"/> No <input checked="" type="checkbox"/> Dimensions: _____ Awning? Yes <input type="checkbox"/> No <input checked="" type="checkbox"/> Sq. ft. area of awning w/communication: _____		
A site sketch and building sketch showing exactly where existing and new signage is located must be provided. Sketches and/or pictures of proposed signage and existing building are also required. <u>See ATT</u>		

70' MAX - shiny
15' high - 40'
5' setback - 9' high
 not show

Please submit all of the information outlined in the Sign/Awning Application Checklist. Failure to do so may result in the automatic denial of your permit.

In order to be sure the City fully understands the full scope of the project, the Planning and Development Department may request additional information prior to the issuance of a permit. For further information visit us on-line at www.portlandmaine.gov, stop by the Building Inspections office, room 315 City Hall or call 874-8703.

I hereby certify that I am the Owner of record of the named property, or that the owner of record authorizes the proposed work and that I have been authorized by the owner to make this application as his/her authorized agent. I agree to conform to all applicable laws of this jurisdiction. In addition, if a permit for work described in this application is issued, I certify that the Code Official's authorized representative shall have the authority to enter all areas covered by this permit at any reasonable hour to enforce the provisions of the codes applicable to this permit.

Signature of applicant: _____ Date: 2/8/07

DEPT. OF BUILDING INSPECTIONS
CITY OF PORTLAND, MAINE
This is not a permit; you may not commence ANY work until the permit is issued.

APR - 6 2007

RECEIVED

This Design Is The Property Of

Sign Design Inc.

306 Warren Ave. Portland, ME

Phone: 207-856-2600 Fax: 207-856-7600

75 evergreen dr.

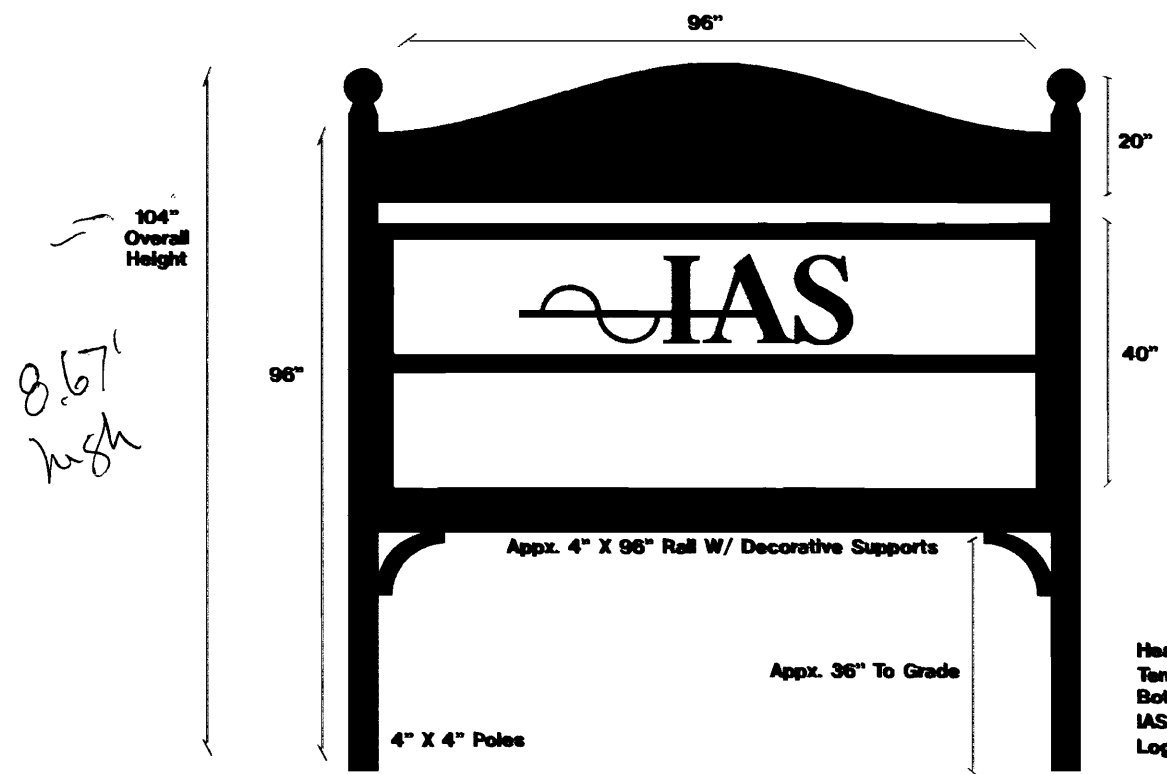

$60'' \times 96'' = 5760 \div 144 = 40 \#$

Header Panel: Appx. Metallic Gold Inset W/ 6" Text
 Tenant Panels: 17" X 92" Each
 Bottom Rail: Metallic Gold Stripe
 IAS Logo: Appx. 13" X 48"
 Logo Colors: PMS 194 Red & PMS 430 Grey

Sales Representative: Roger Flannery

Production Notes:

Note: The black outlines appearing on this proof are for representation only. They are to distinguish sign components such as borders, retainers, faces and reveals. Unless otherwise specified, they are not considered as part of the sign graphics.

Customer: IAS
Job Name: ias comp. 2
Date: 4-4-07

Approval:
Customer approval is a signed confirmation that dimensions, colors, graphics and all other job specifics are correct

ACORD™ CERTIFICATE OF LIABILITY INSURANCE

PRODUCER Cross Insurance -CL/Bnds-P P. O. Box 567 Portland, ME 04112 800 286-6362		THIS CERTIFICATE IS ISSUED AS A MATTER OF INFORMATION ONLY AND CONFERS NO RIGHTS UPON THE CERTIFICATE HOLDER. THIS CERTIFICATE DOES NOT AMEND, EXTEND OR ALTER THE COVERAGE AFFORDED BY THE POLICIES BELOW.	
INSURED Industrial Automation Supply, Inc. 23 Evergreen Drive Portland, ME 04103		INSURERS AFFORDING COVERAGE	NAIC #
		INSURER A: Peerless Ins. Co.	24198
		INSURER B:	
		INSURER C:	
		INSURER D:	
		INSURER E:	

COVERAGES

THE POLICIES OF INSURANCE LISTED BELOW HAVE BEEN ISSUED TO THE INSURED NAMED ABOVE FOR THE POLICY PERIOD INDICATED. NOTWITHSTANDING ANY REQUIREMENT, TERM OR CONDITION OF ANY CONTRACT OR OTHER DOCUMENT WITH RESPECT TO WHICH THIS CERTIFICATE MAY BE ISSUED OR MAY PERTAIN, THE INSURANCE AFFORDED BY THE POLICIES DESCRIBED HEREIN IS SUBJECT TO ALL THE TERMS, EXCLUSIONS AND CONDITIONS OF SUCH POLICIES. AGGREGATE LIMITS SHOWN MAY HAVE BEEN REDUCED BY PAID CLAIMS.

INSR AGO'L LTR INSRD	TYPE OF INSURANCE	POLICY NUMBER	POLICY EFFECTIVE DATE (MM/DD/YY)	POLICY EXPIRATION DATE (MM/DD/YY)	LIMITS
A	GENERAL LIABILITY <input checked="" type="checkbox"/> COMMERCIAL GENERAL LIABILITY <input type="checkbox"/> CLAIMS MADE <input checked="" type="checkbox"/> OCCUR GEN'L AGGREGATE LIMIT APPLIES PER: <input type="checkbox"/> POLICY <input type="checkbox"/> PRO- JECT <input type="checkbox"/> LOC	BOP9703008	01/20/07	01/20/08	EACH OCCURRENCE \$1,000,000
					DAMAGE TO RENTED PREMISES (EA OCCURRENCE) \$50,000
					MED EXP (Any one person) \$5,000
					PERSONAL & ADV INJURY \$1,000,000
					GENERAL AGGREGATE \$2,000,000
					PRODUCTS - COMPROP AGG \$2,000,000
	AUTOMOBILE LIABILITY <input type="checkbox"/> ANY AUTO <input type="checkbox"/> ALL OWNED AUTOS <input type="checkbox"/> SCHEDULED AUTOS <input type="checkbox"/> HIRED AUTOS <input type="checkbox"/> NON-OWNED AUTOS				COMBINED SINGLE LIMIT (EA ACCIDENT) \$ BODILY INJURY (Per person) \$ BODILY INJURY (Per accident) \$ PROPERTY DAMAGE (Per accident) \$
	GARAGE LIABILITY: <input type="checkbox"/> ANY AUTO				AUTO ONLY - EA ACCIDENT \$ OTHER THAN EA ACC \$ AUTO ONLY: AGG \$
	EXCESS/UMBRELLA LIABILITY <input type="checkbox"/> OCCUR <input type="checkbox"/> CLAIMS MADE <input type="checkbox"/> DEDUCTIBLE <input type="checkbox"/> RETENTION \$				EACH OCCURRENCE \$ AGGREGATE \$ \$ \$ \$
	WORKERS COMPENSATION AND EMPLOYERS' LIABILITY ANY PROPRIETOR/PARTNER/EXECUTIVE OFFICER/MEMBER EXCLUDED? If yes, describe under SPECIAL PROVISIONS below				<input type="checkbox"/> WC STATU- <input type="checkbox"/> OTH- TORY LIMITS ER E.L. EACH ACCIDENT \$ E.L. DISEASE - EA EMPLOYEE \$ E.L. DISEASE - POLICY LIMIT \$
	OTHER				

DESCRIPTION OF OPERATIONS / LOCATIONS / VEHICLES / EXCLUSIONS ADDED BY ENDORSEMENT / SPECIAL PROVISIONS

RE: Sign at 75 Industrial Way, Portland, ME.
 Certificate Holder is an Additional insured.

CERTIFICATE HOLDER

CANCELLATION

City of Portland
 385 Congress St
 Portland, ME 04101

SHOULD ANY OF THE ABOVE DESCRIBED POLICIES BE CANCELLED BEFORE THE EXPIRATION DATE THEREOF, THE ISSUING INSURER WILL ENDEAVOR TO MAIL 10 DAYS WRITTEN NOTICE TO THE CERTIFICATE HOLDER NAMED TO THE LEFT, BUT FAILURE TO DO SO SHALL IMPOSE NO OBLIGATION OR LIABILITY OF ANY KIND UPON THE INSURER, ITS AGENTS OR REPRESENTATIVES.

AUTHORIZED REPRESENTATIVE

Robert M. Brown



Sign Contractors

P.O. Box 207
Westbrook, ME 04098
(207) 856-2600 * FAX: (207) 856-7800
1-800-848-8037
signdesi@maine.rr.com
A Full Service Sign Company

RE:

To Whom It May Concern:

As the owner (or owner representative) of the property located at:

75 Industrial Way

I authorize Sign Design Inc. to install signs/sign face replacements as detailed on attached paperwork.

James H. Witham
Signature

4-3-07
Date

James H. Witham
Print Name



From: "Sign Design Inc." <signdesi@maine.rr.com>
To: "Marge Schmuckal" <MES@portlandmaine.gov>
Date: 4/13/2007 5:34:05 PM
Subject: Re: IAS permit

Marge,
Sorry, I left off the physical address of 75 Industrial Way.
I sent the rest of the info prior.

Doug

----- Original Message -----

From: "Marge Schmuckal" <MES@portlandmaine.gov>
To: <signdesi@maine.rr.com>
Sent: Friday, April 13, 2007 1:04 PM
Subject: Re: IAS permit

> Doug,
> This isn't too helpful.
>
> What address are we talking about?
> How far is this sign from the property lines? If we do not have a plot
> plan, we need a plot plan showing the location and distance from the
> property lines.
> Marge
>
>>>> "Sign Design Inc." <signdesi@maine.rr.com> 4/13/2007 1:35:09 PM
>>>>
> Marge,
>
> Attached is the sign location marked with x's.
>
> Thanks,
>
> Doug
>
> Sign Design, Inc.
> PO Box 207
> Westbrook, Maine 04098 (mail only)
> 306 Warren Ave.
> Portland, Maine 04103 (deliveries only)
> Phone: 207-856-2600
> Fax: 207-856-7600
>

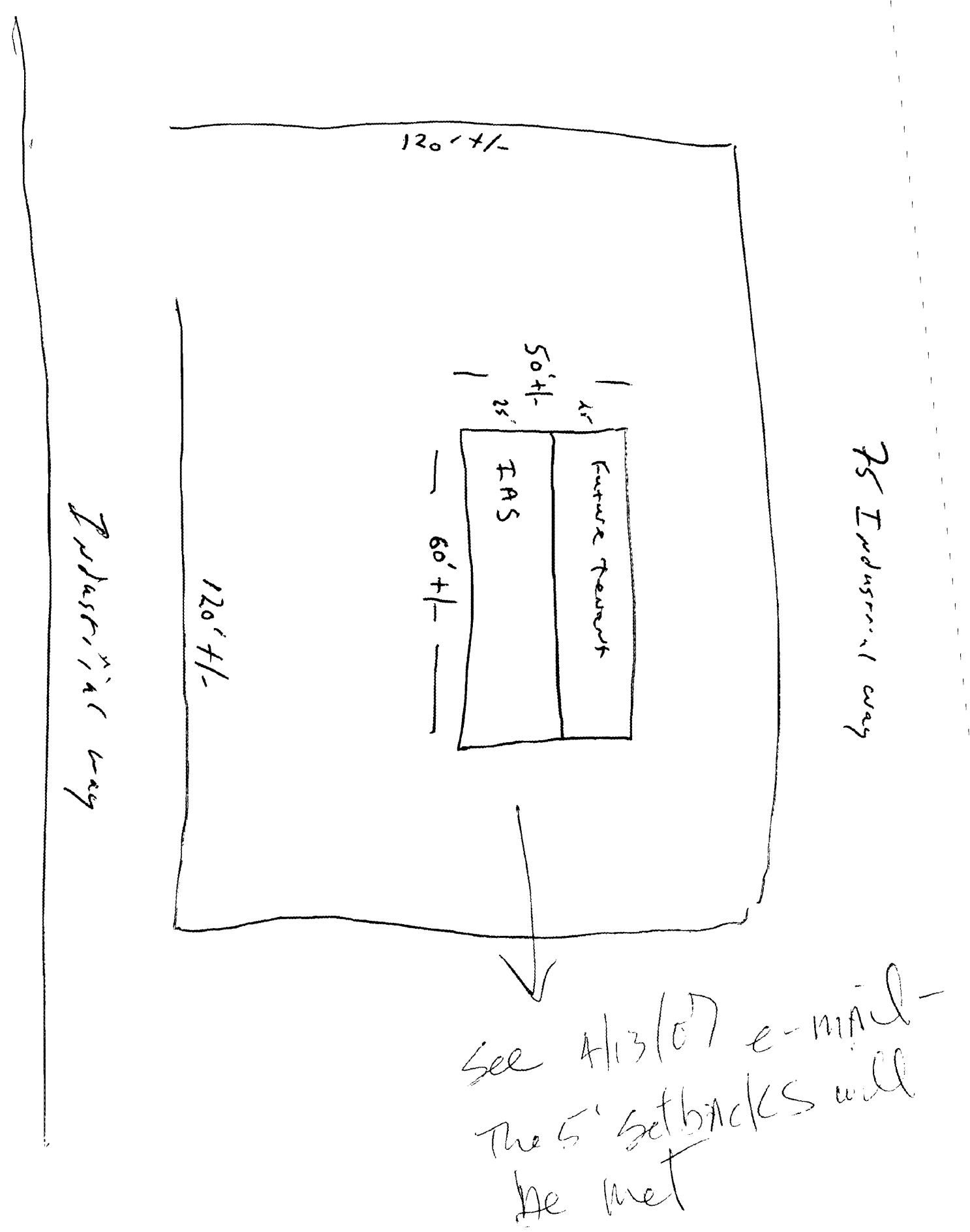

75 Industrial way

Industrial way

see 4/13/07 e-mail -
 The 5' setbacks will
 be met

From: "Sign Design Inc." <signdesi@maine.rr.com>
To: <mes@portlandmaine.gov>
Date: 4/13/2007 4:39:02 PM
Subject: Fw: IAS permit

Also,
(hit enter too soon)!

The sign will be going where the poles are now. There is going to be a 5' setback of the front property line and each side will exceed 5' of setback.

Doug

----- Original Message -----

From: Sign Design Inc.
To: mes@portlandmaine.gov
Sent: Friday, April 13, 2007 12:35 PM
Subject: IAS permit

Marge,

Attached is the sign location marked with x's.

Thanks,

Doug

Sign Design, Inc.
PO Box 207
Westbrook, Maine 04098 (mail only)
306 Warren Ave.
Portland, Maine 04103 (deliveries only)
Phone: 207-856-2600
Fax: 207-856-7600

City of Portland, Maine - Building or Use Permit Application

389 Congress Street, 04101 Tel: (207) 874-8703, Fax: (207) 874-8716

Permit No: 07-0328	Issue Date:	CBL: 327A A009001
------------------------------	--------------------	-----------------------------

Location of Construction: 75 INDUSTRIAL WAY	Owner Name: NMP LLC	Owner Address: 75 INDUSTRIAL WAY	Phone:
Business Name:	Contractor Name: Mainland Structures, Inc.	Contractor Address: 11A Bartlett Rd Gorham	Phone 2078561817
Lessee/Buyer's Name	Phone:	Permit Type: Change of Use - Commercial	Zone:

Past Use: Commerical / warehouse	Proposed Use: Commercial / Warehouse Change of use from warehouse to office space	Permit Fee: \$535.00	Cost of Work: \$43,500.00	CEO District: 5
Proposed Project Description: Change of use from warehouse to office space		FIRE DEPT: <input type="checkbox"/> Approved <input type="checkbox"/> Denied	INSPECTION: Use Group: _____ Type: _____	
		Signature: _____	Signature: _____	
		PEDESTRIAN ACTIVITIES DISTRICT (P.A.D.)		
		Action: <input type="checkbox"/> Approved <input type="checkbox"/> Approved w/Conditions <input type="checkbox"/> Denied		
		Signature: _____ Date: _____		

Permit Taken By: dmartin	Date Applied For: 03/29/2007	Zoning Approval		
------------------------------------	--	------------------------	--	--

<ol style="list-style-type: none"> This permit application does not preclude the Applicant(s) from meeting applicable State and Federal Rules. Building permits do not include plumbing, septic or electrical work. Building permits are void if work is not started within six (6) months of the date of issuance. False information may invalidate a building permit and stop all work.. 	Special Zone or Reviews <input type="checkbox"/> Shoreland <input type="checkbox"/> Wetland <input type="checkbox"/> Flood Zone <input type="checkbox"/> Subdivision <input type="checkbox"/> Site Plan Maj <input type="checkbox"/> Minor <input type="checkbox"/> MM <input type="checkbox"/> Date: _____	Zoning Appeal <input type="checkbox"/> Variance <input type="checkbox"/> Miscellaneous <input type="checkbox"/> Conditional Use <input type="checkbox"/> Interpretation <input type="checkbox"/> Approved <input type="checkbox"/> Denied Date: _____	Historic Preservation <input type="checkbox"/> Not in District or Landmark <input type="checkbox"/> Does Not Require Review <input type="checkbox"/> Requires Review <input type="checkbox"/> Approved <input type="checkbox"/> Approved w/Conditions <input type="checkbox"/> Denied Date: _____
---	---	---	---

CERTIFICATION

I hereby certify that I am the owner of record of the named property, or that the proposed work is authorized by the owner of record and that I have been authorized by the owner to make this application as his authorized agent and I agree to conform to all applicable laws of this jurisdiction. In addition, if a permit for work described in the application is issued, I certify that the code official's authorized representative shall have the authority to enter all areas covered by such permit at any reasonable hour to enforce the provision of the code(s) applicable to such permit.

SIGNATURE OF APPLICANT	ADDRESS	DATE	PHONE
RESPONSIBLE PERSON IN CHARGE OF WORK, TITLE		DATE	PHONE