

City of Portland, Maine – Building or Use Permit Application 389 Congress Street, 04101, Tel: (207) 874-8703, FAX: 874-8716

981234

Location of Construction: 57 Industrial Way		Owner: OMV V	Phone: 773-8499	Permit No:
Owner Address: 17 Westfield St Portland 04102	Lessee/Buyer's Name: Causco Bay Brewing Co	Phone:	BusinessName:	<div style="border: 2px solid black; padding: 5px; text-align: center;"> PERMIT ISSUED Permit Issued: OCT 29 1998 CITY OF PORTLAND </div>
Contractor Name: Lessee	Address:	Phone:		
Past Use: Microbrewery	Proposed Use: Same	COST OF WORK: \$	PERMIT FEE: \$ 44.20	
Proposed Project Description: Erect Additional Directional Sign (3 x 5)		FIRE DEPT. <input type="checkbox"/> Approved <input type="checkbox"/> Denied	INSPECTION: Use Group: Type:	
		Signature:	Signature:	Zone:
		PEDESTRIAN ACTIVITIES DISTRICT (P.A.D.)		CBL: 327A-A-008
		Action: Approved <input type="checkbox"/>		Zoning Approval:
		Approved with Conditions: <input type="checkbox"/>		Special Zone or Reviews:
		Denied <input type="checkbox"/>		<input type="checkbox"/> Shoreland
Permit Taken By: SP		Date Applied For: 22 October 1998		<input type="checkbox"/> Wetland
				<input type="checkbox"/> Flood Zone
				<input type="checkbox"/> Subdivision
				<input type="checkbox"/> Site Plan maj <input type="checkbox"/> minor <input type="checkbox"/> mm <input type="checkbox"/>

- This permit application does not preclude the Applicant(s) from meeting applicable State and Federal rules.
- Building permits do not include plumbing, septic or electrical work.
- Building permits are void if work is not started within six (6) months of the date of issuance. False information may invalidate a building permit and stop all work..

CERTIFICATION

I hereby certify that I am the owner of record of the named property, or that the proposed work is authorized by the owner of record and that I have been authorized by the owner to make this application as his authorized agent and I agree to conform to all applicable laws of this jurisdiction. In addition, if a permit for work described in the application is issued, I certify that the code official's authorized representative shall have the authority to enter all areas covered by such permit at any reasonable hour to enforce the provisions of the code(s) applicable to such permit

SIGNATURE OF APPLICANT _____ ADDRESS: _____ DATE: 23 October 1998 PHONE: _____

RESPONSIBLE PERSON IN CHARGE OF WORK, TITLE _____ PHONE: _____

White-Permit Desk Green-Assessor's Canary-D.P.W. Pink-Public File Ivory Card-Inspector

- Zoning Appeal**
- Variance
 - Miscellaneous
 - Conditional Use
 - Interpretation
 - Approved
 - Denied
- Historic Preservation**
- Not in District or Landmark
 - Does Not Require Review
 - Requires Review
- Action:**
- Approved
 - Approved with Conditions
 - Denied
- Date: _____

CEO DISTRICT 1

7/29/99

Sign OK. A.C.

COMMENTS

Lined area for handwritten notes.

Inspection Record

Type	Date
Foundation: _____	_____
Framing: _____	_____
Plumbing: _____	_____
Final: _____	_____
Other: _____	_____

THIS IS NOT A PERMIT/CONSTRUCTION CANNOT COMMENCE UNTIL THE PERMIT IS ISSUED

Building or Use Permit Pre-Application
Attached Single Family Dwellings/Two-Family Dwelling
Multi-Family or Commercial Structures and Additions Thereto

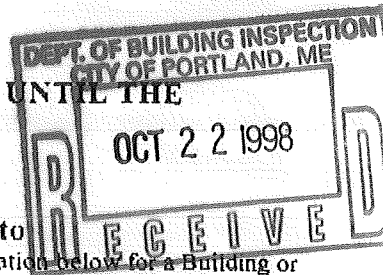

In the interest of processing your application in the quickest possible manner, please complete the Information below for a Building or Use Permit.

NOTE**If you or the property owner owes real estate or personal property taxes or user charges on ANY PROPERTY within the City, payment arrangements must be made before permits of any kind are accepted.

Form with fields for Location/Address of Construction (57 INDUSTRIAL WAY 04103), Total Square Footage, Tax Assessor's Chart, Owner (OMW V), Telephone (773-8499), Owner's Address (17 WESTFIELD STR. PORTLAND, ME 04102), Proposed Project Description (ADDITIONAL DIRECTIONAL SIGN (3x5) 1559. SF), Contractor's Name, Current Use (MICROBREWERY), and Proposed Use (MICROBREWERY).

Separate permits are required for Internal & External Plumbing, HVAC and Electrical installation.

- All construction must be conducted in compliance with the 1996 B.O.C.A. Building Code as amended by Section 6-Art II.
All plumbing must be conducted in compliance with the State of Maine Plumbing Code.
All Electrical Installation must comply with the 1996 National Electrical Code as amended by Section 6-Art III.
HVAC (Heating, Ventillation and Air Conditioning) installation must comply with the 1993 BOCA Mechanical Code.

You must include the following with you application:

- 1) A Copy of Your Deed or Purchase and Sale Agreement
2) A Copy of your Construction Contract, if available
3) A Plot Plan/Site Plan

Minor or Major site plan review will be required for the above proposed projects. The attached checklist outlines the minimum standards for a site plan.

4) Building Plans

Unless exempted by State Law, construction documents must be designed by a registered design professional.

A complete set of construction drawings showing all of the following elements of construction:

- Cross Sections w/Framing details (including porches, decks w/ railings, and accessory structures)
Floor Plans & Elevations
Window and door schedules
Foundation plans with required drainage and dampproofing
Electrical and plumbing layout. Mechanical drawings for any specialized equipment such as furnaces, chimneys, gas equipment, HVAC equipment (air handling) or other types of work that may require special review must be included.

Certification

I hereby certify that I am the Owner of record of the named property, or that the proposed work is authorized by the owner of record and that I have been authorized by the owner to make this application as his/her authorized agent. I agree to conform to all applicable laws of this jurisdiction. In addition, if a permit for work described in this application is issued, I certify that the Code Official's authorized representative shall have the authority to enter all areas covered by this permit at any reasonable hour to enforce the provisions of the codes applicable to this permit.

Signature of applicant: Robert J. Wade, President/Treasurer. Date: 10/20/98

Building Permit Fee: \$25.00 for the 1st \$1000. cost plus \$5.00 per \$1,000.00 construction cost thereafter.
Additional Site review and related fees are attached on a separate addendum

SIGNAGE PRE-APPLICATION

PLEASE ANSWER ALL QUESTIONS

ADDRESS: 57 INDUSTRIAL WAY ZONE: TWO-M
OWNER: OMW V
APPLICANT: CASCO BAY BREWING COMPANY
ASSESSOR NO. C-18080

PLEASE CIRCLE APPROPRIATE ANSWER

SINGLE TENANT LOT? YES NO
FREESTANDING SIGN? (ex. Pole Sign) YES NO
SIGN ATTACHED TO BLDG.? YES NO
AWNING: YES NO IS AWNING BACKLIT? YES NO
HEIGHT OFF SIDEWALK

LIST ALL EXISTING SIGNAGE AND THEIR DIMENSIONS:

TWO SIGNS ATTACHED TO BUILDING - ONE CIRCULAR W/ RADIUS OF 24" (#1)
OTHER SIGN 56" x 96" (#2)

TENANT BLDG. FRONTAGE (IN FEET): 100'
REQUIRED INFORMATION

AREA FOR COMPUTATION

Free Standing Sign
max height 35' - 15' show
min height - 10' - 5'-6' show
min 5' setback 5' & 10' show

696
100 x 15 = 1500 x 6% = 750

YOU SHALL PROVIDE:

A SITE SKETCH AND BUILDING SKETCH SHOWING EXACTLY WHERE EXISTING AND NEW SIGNAGE IS LOCATED MUST BE PROVIDED. SKETCHES AND/OR PICTURES OF PROPOSED ARE ALSO REQUIRED.

SIGNATURE OF APPLICANT: Robert F. Wade PRESIDENT/ TREASURER DATE: 10/20/98

5'

3'



Visitors & Tours



15'

Shipping & Receiving



2' above ground

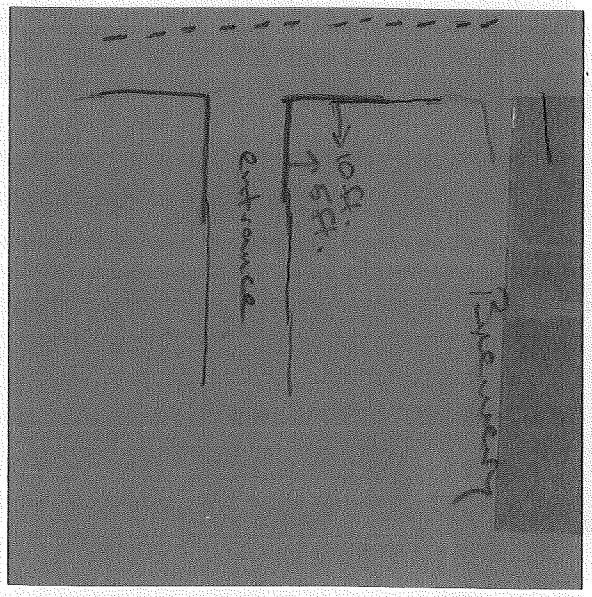



COMMERCIAL UMBRELLA POLICY - DECLARATIONS PAGE

Policy No.
CUA 0040696-10

Issued By:
Acadia Insurance Company

Named Insured and Address

Casco Bay Brewing Company
57 Industrial Way
Portland, ME 04104

Agent Name and Address 1741
(207)729-3321

Riley Insurance Agency
139 Maine Street
P. O. Box 659
Brunswick, ME 04011

Policy Period: From May 9, 1998 to May 9, 1999 12:01 a.m. Standard Time
at your address shown below.

In return for payment of premium and subject to all terms of this policy, we agree with you to provide the insurance as stated in this policy.

Limit of Insurance (Per Occurrence)	\$ 1,000,000
General Aggregate Limit	\$ 1,000,000
Products-Completed Operations Aggregate Limit	\$ 1,000,000
Bodily Injury by Disease Aggregate Limit	\$ 1,000,000

Form of Business: Individual Corporation Partnership
 Joint Venture Other

Business Description: Brewery

Total Premium \$ 500

This policy is: Direct Bill Pay Plan
 Agent Billed

Endorsements Attached To This Policy:

AIAS01 (07-92), AICD03 (06-92), IL0017 (11-85),
AICU01 (06-92), AICU10 (06-92), AICU23 (06-92), AICU27 (06-92), AICU29 (07-92),
AICU35 (06-92), AICU50 (10-96), AICU52 (10-96).

Previous Policy new

Countersigned _____

By

RILEY INSURANCE AGENCY
BRUNSWICK, MAINE
(Authorized Signature)

10/22/98 10:37 FAX 2077972020
OCT-22-1998 09:51

CASCO BAY BREWIN

P. 01/01 001

OMW V, INC.
P.O. Box 1074
Portland, Maine 04104
207-773-8499
FAX 207-773-6619

October 20, 1998

City of Portland
388 Congress Street
Portland, ME 04101

Re: 57 Industrial Way

To Whom It May Concern:

Casco Bay Brewery has been authorized to erect directional signage in accordance with City of Portland's ordinances.

Very truly yours,

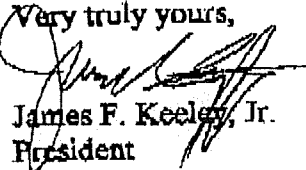
James F. Keeley, Jr.
President