

© 2017 RYAN SENATORE ARCHITECTURE

DEFINITIVE BREWING COMPANY
35 INDUSTRIAL WAY
PORTLAND MAINE



RYAN SENATORE ARCHITECTURE
565 CONGRESS STREET
PORTLAND, MAINE 04101
207-650-6414
senatorearchitecture.com

CONSULTANTS:

REVISIONS:

- △ - REVISED - 01/10/18
- △ - REVISED - 01/12/18
- △ - REVISED - 01/17/18
- △ - REVISED - 02/09/18
- △ - REVISED - 03/9/18
- △ - REVISED - 04/9/18

DATE: MARCH 6, 2018

PROJECT No. 1772

DRAWN BY: JPF

CHECKED BY: RJS

SCALE: AS NOTED

SHEET TITLE:

FIRST FLOOR PLAN

A1-0

WALL LEGEND	
	EXISTING WALL
	NEW WALL

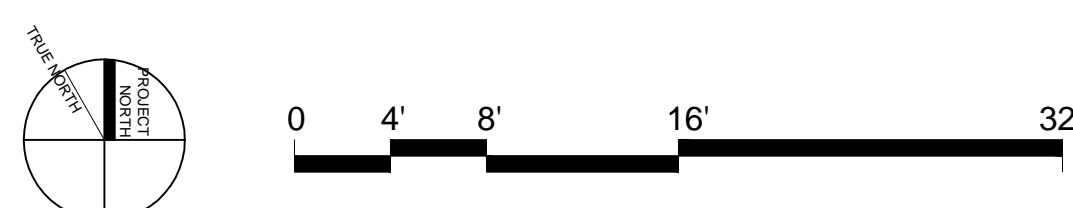
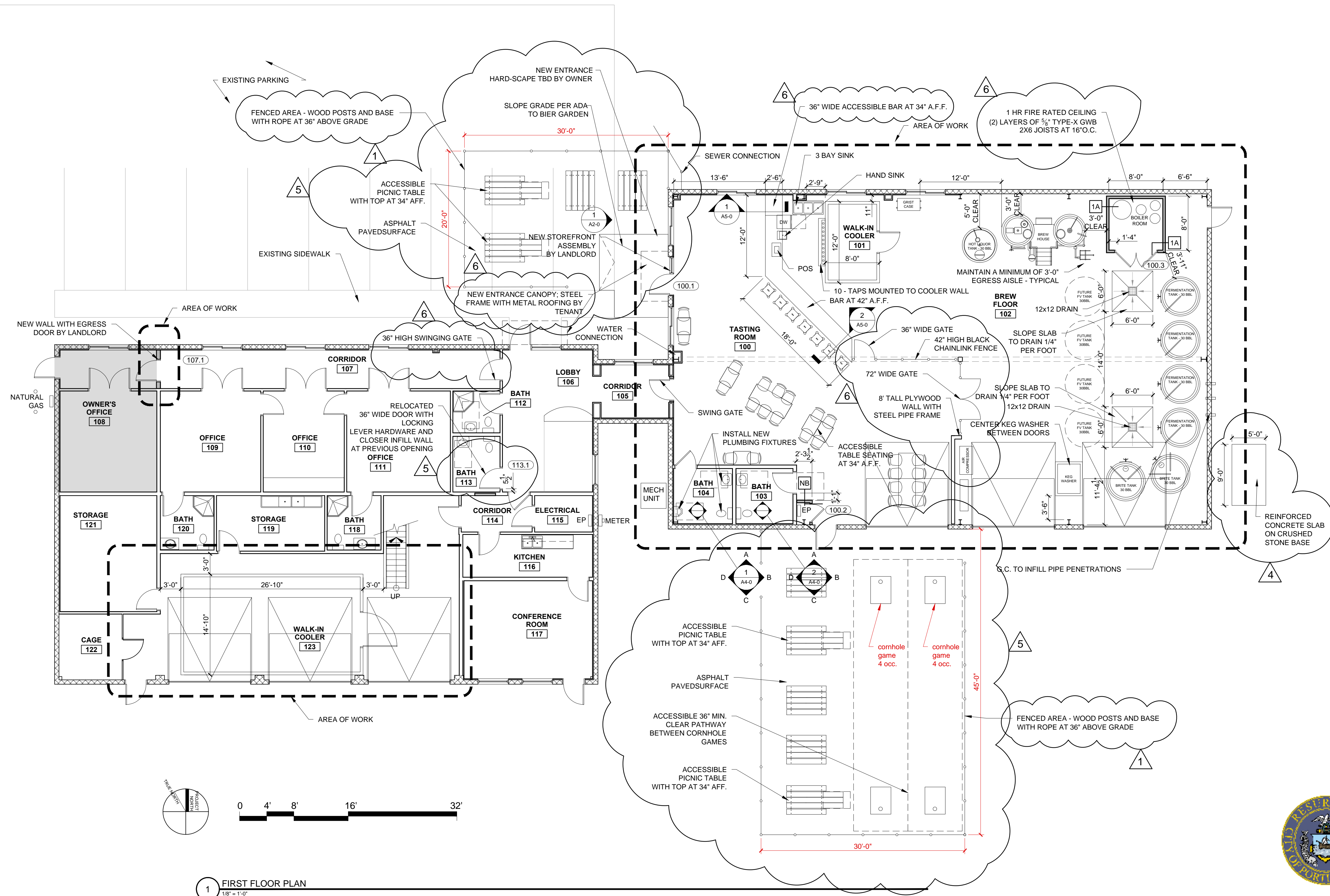

1 FIRST FLOOR PLAN
1/8" = 1'-0"



Reviewed for Code Compliance
Permitting and Inspections Department
Approved with Conditions

05/02/2018

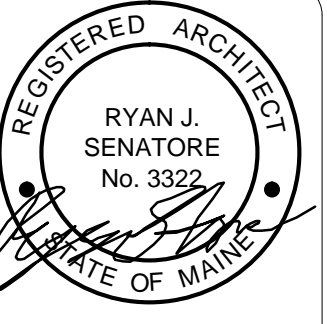

© 2017 RYAN SENATORE ARCHITECTURE

DEFINITIVE BREWING COMPANY
35 INDUSTRIAL WAY
PORTLAND MAINE



RYAN SENATORE
ARCHITECTURE
565 CONGRESS STREET
PORTLAND, MAINE 04101
207-650-6414
senatorearchitecture.com

CONSULTANTS:

REVISIONS:

- △ - REVISED - 02/05/18
- △ - REVISED - 03/09/18

DATE: MARCH 6, 2018

PROJECT No. 1772

DRAWN BY: JPF

CHECKED BY: RJS

SCALE: AS NOTED

SHEET TITLE:

CODE REVIEW PLAN

G1-0

CODE REVIEW LEGEND	
	EXIT SIGN
	FIRE EXTINGUISHER

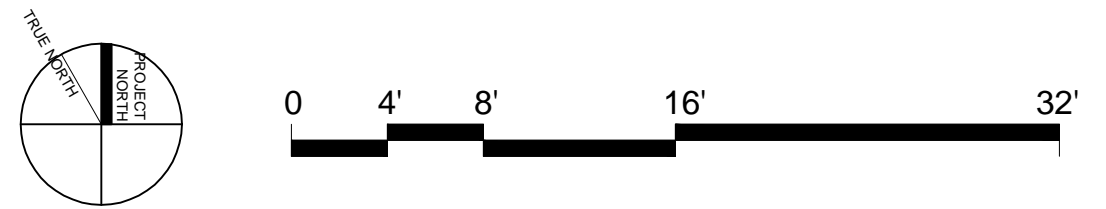
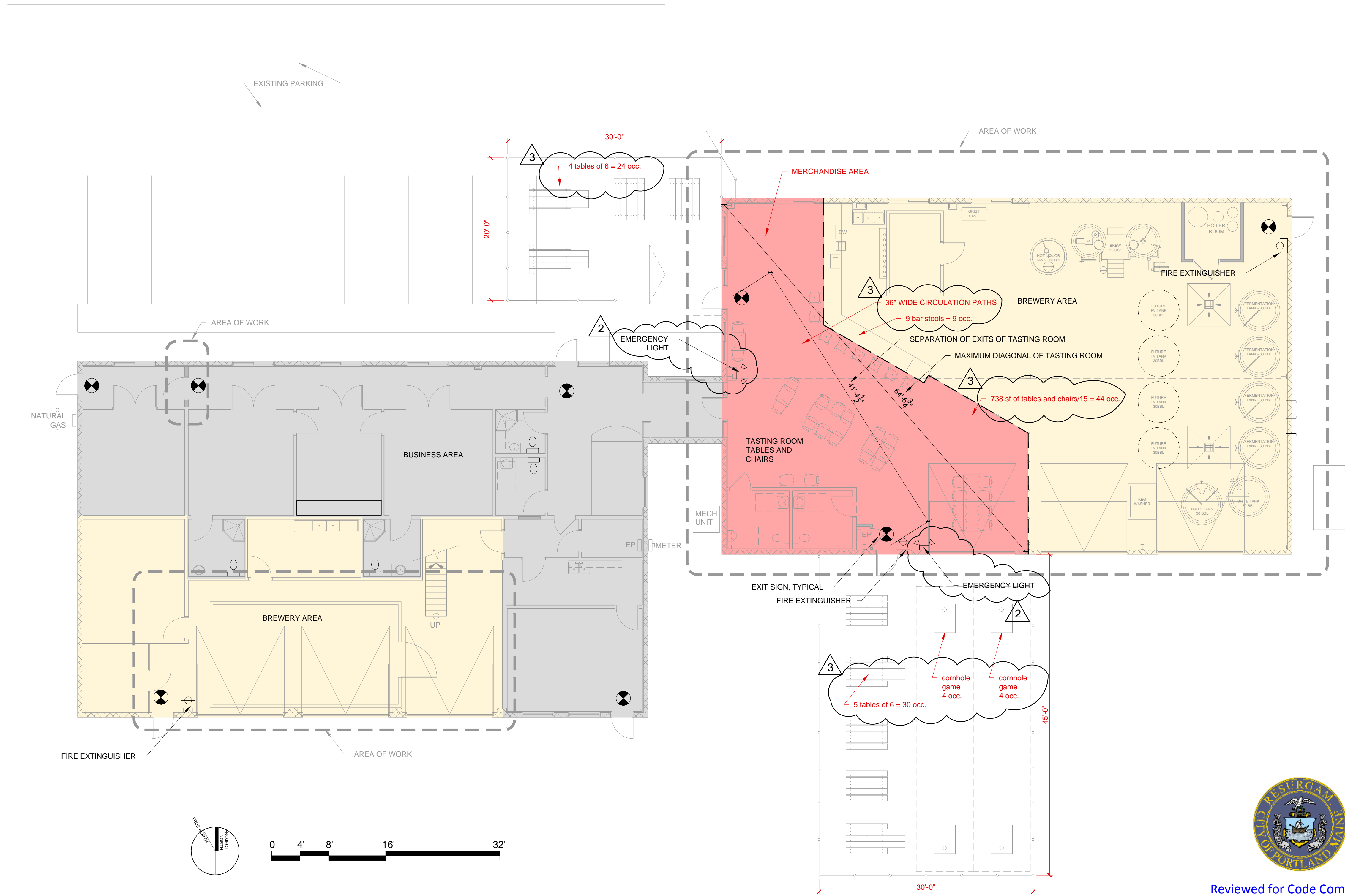

1 CODE REVIEW PLAN
1/8" = 1'-0"

 Reviewed for Code Compliance
 Permitting and Inspections Department
 Approved with Conditions
05/02/2018