

© 2017 RYAN SENATORE ARCHITECTURE

DEFINITIVE BREWING COMPANY
35 INDUSTRIAL WAY
PORTLAND MAINE



RYAN SENATORE ARCHITECTURE
565 CONGRESS STREET
PORTLAND, MAINE 04101
207-650-6414
senatorearchitecture.com

CONSULTANTS:

REVISIONS:

DATE: DECEMBER 14, 2017

PROJECT No. 1772

DRAWN BY: JPF

CHECKED BY: RJS

SCALE: AS NOTED

SHEET TITLE:

CODE REVIEW PLAN

G1-0

CODE REVIEW LEGEND	
	EXIT SIGN
	FIRE EXTINGUISHER

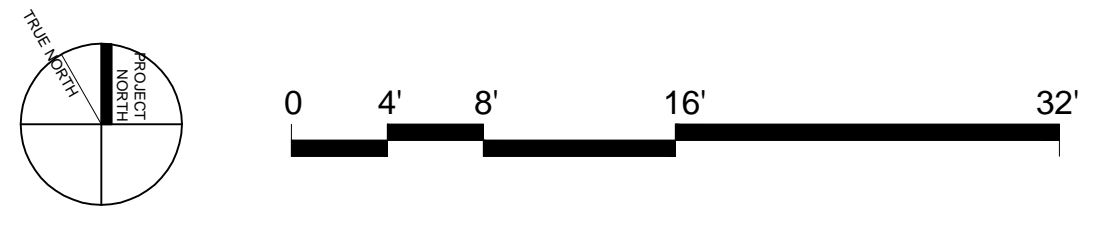
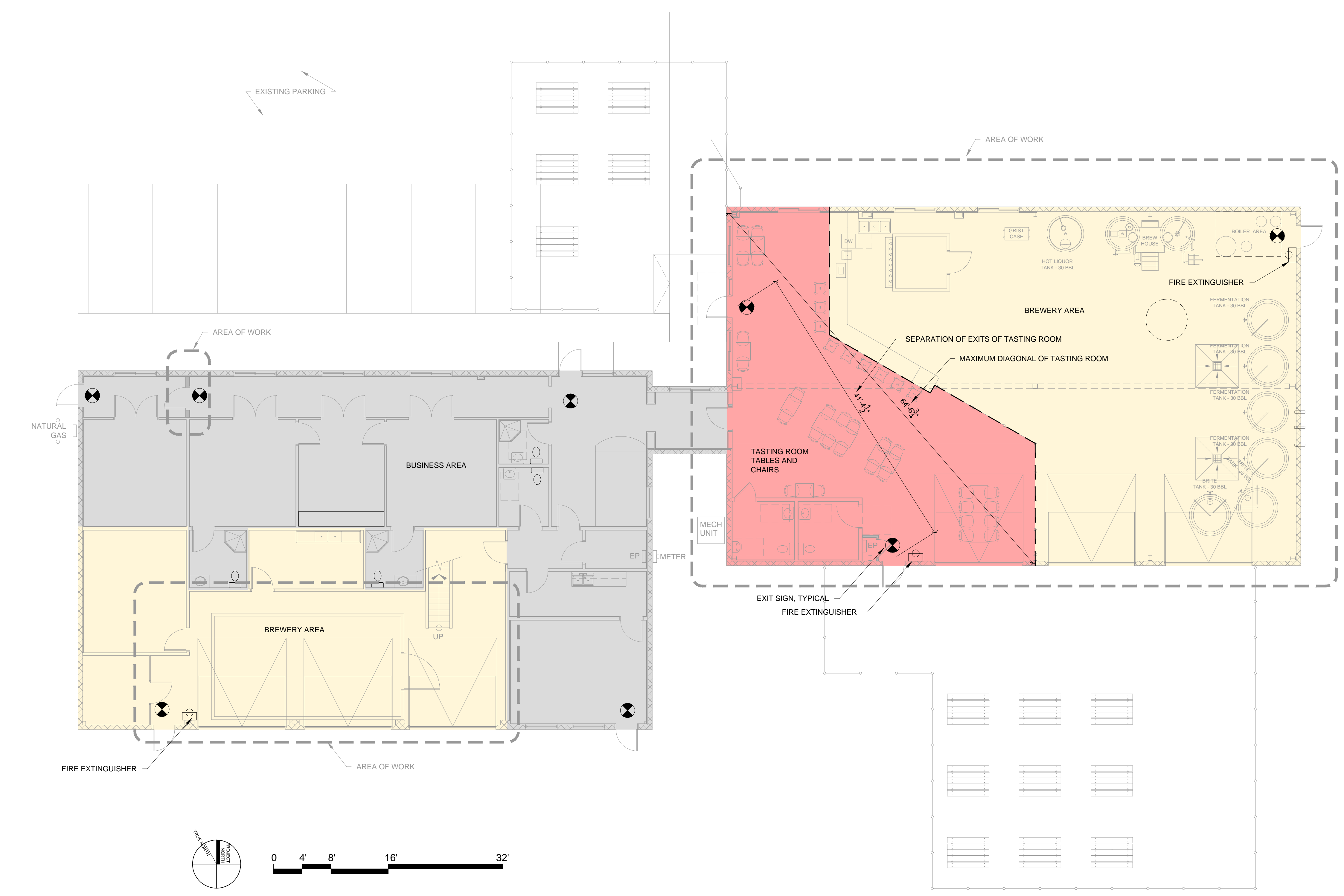

1 CODE REVIEW PLAN
1/8" = 1'-0"