

GENERAL NOTES

- CONTRACTOR TO CUT AND REMOVE CONCRETE AS NECESSARY TO REMOVE ALL EXISTING PIPING. LOCATION OF REMOVAL AT DISPENSER ISLANDS IS APPROXIMATE AND IS BASED ON AVAILABLE INFORMATION.

Rev. #	Date	Description

Proto 2nd Qtr 04-03-15

7-ELEVEN, INC.
 3200 HACKBERRY ROAD, IRVING, TEXAS 75063
 7-11 #32541
 1917 FOREST AVE
 PORTLAND, ME 04103
 FUELING DEMO PLAN

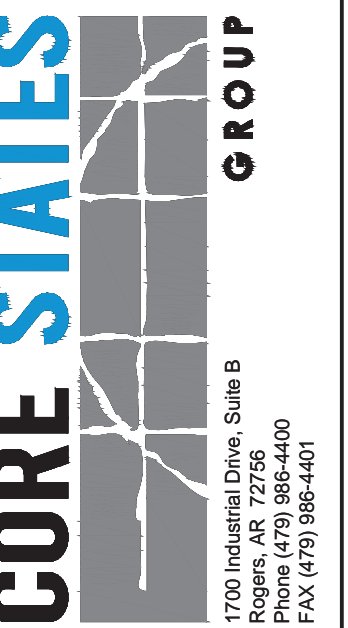

Job#: SEI-16380.0222
 Scale: AS NOTED
 Date: 01/21/16
 Drawn By: KMS
 Checked By: CPS

Documents prepared by Core States Group are to be used for the specific use for which they are intended. Any extension of use to other projects, by owner or otherwise, without the expressed, written consent of Core States Group is prohibited. Core States Group is not responsible for any claims or losses resulting from the use of these documents for any other purpose than that specifically intended. User will hold Core States Group harmless from all claims and losses.

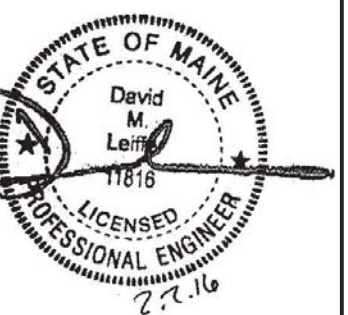

SHEET:
G0.3
 FUELING - USA

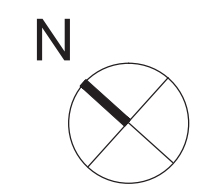
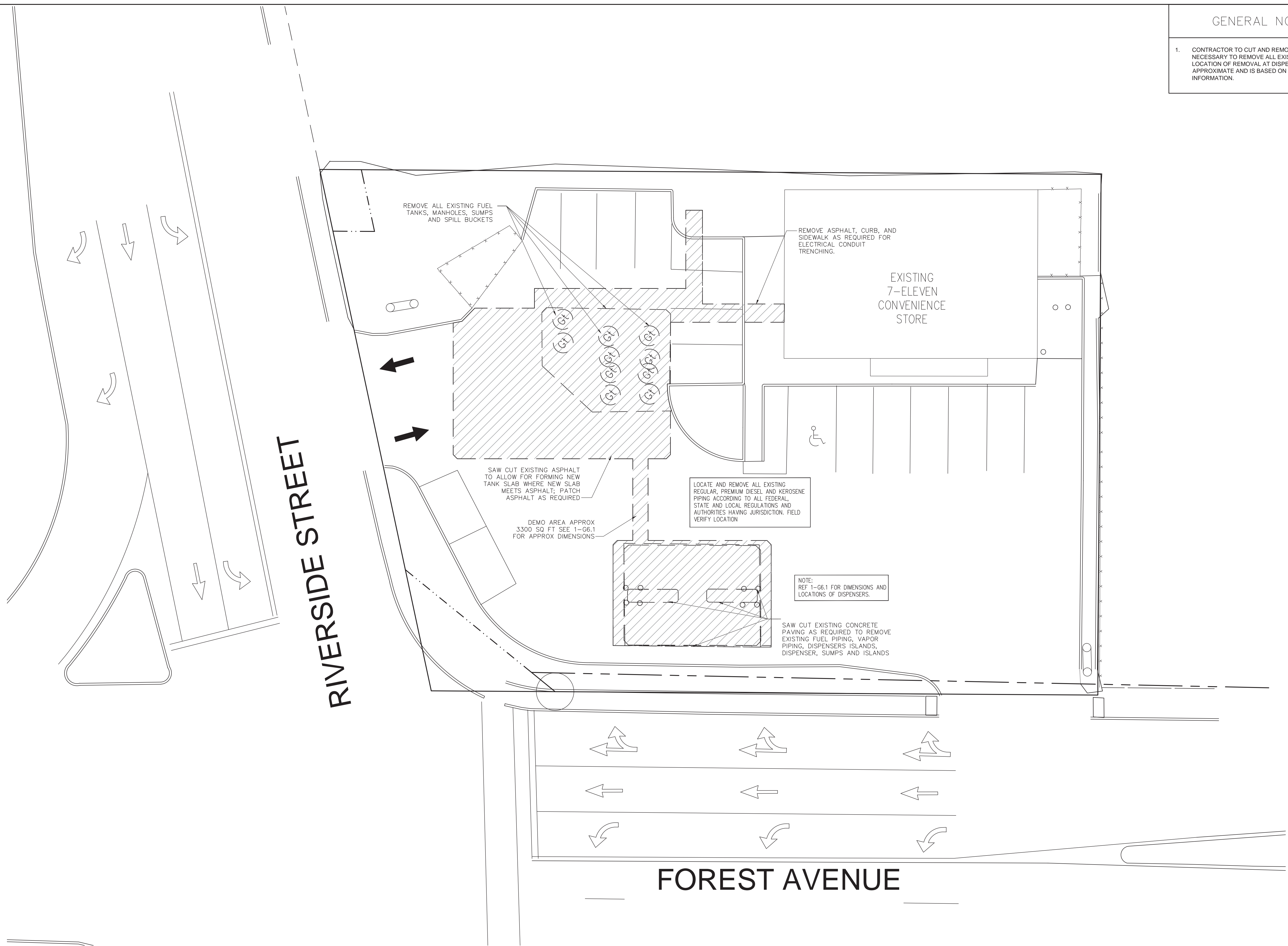

1

DEMO PLAN
 3/32" = 1'-0"