

Cold Shot Chillers®



**RUGGED
DEPENDABILITY**

10, 12.5, 15 and 20-Ton 2 Stage Air Cooled Portable Water Chillers

"This product is Listed by UL and meets applicable safety standards."

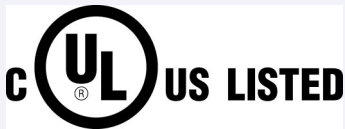

(20 TON UNIT SHOWN)



FEATURES

- Dependable Copeland Welded Hermetic Scroll Compressors
- Stainless Steel Brazed Plate Evaporators Vacuum Brazed with Copper
- Brass Pump Down Service Valves
- Large Copper Condensing Coil with Aluminum Fins
- Powder Coated, Louvered Protective Condenser Panels
- Strong Stainless Steel Centrifugal Pumps
- Oversized Magnetic Contactors
- Powder Coated Steel Frame and Welded Stainless Steel Reservoir

BENEFITS

- Long Life - Maintenance Free
- Compact Efficiency
- Allows for Field Service Without Disassembly
- Easy Maintenance - Improved Efficiency
- Rugged Protection While Allowing for Easy Maintenance and Wash Down
- High Flow - Long Life – Dependable
- Rugged Dependability - Long Life
- Lifetime Warranty



UL TECHNICAL SPECIFICATIONS

CAPACITY ± 5% AT 50° LCWT/95° AMBIENT	10 -TON 120,000 BTU/HR	12.5 -TON 150,000 BTU/HR	15 -TON 180,000 BTU/HR	20 -TON 240,000 BTU/HR
MODEL	ACWC-125-Q	ACWC-150-Q	ACWC-180-Q	ACWC-240-Q
COMPRESSORS	TANDEM HERMETIC SCROLL	TANDEM HERMETIC SCROLL	TANDEM HERMETIC SCROLL	TANDEM HERMETIC SCROLL
EVAPORATOR	STAINLESS STEEL / COPPER BRAZED	STAINLESS STEEL / COPPER BRAZED	STAINLESS STEEL / COPPER BRAZED	STAINLESS STEEL / COPPER BRAZED
FLUID CONNECTION (IN/OUT)	1- 1/4" MNPT	2" MNPT	2" MNPT	2" MNPT
FANS / CFM	2 / 8000	2 / 8000	3 / 12,000	3 / 12,000
CONDENSER COILS	COPPER TUBE / ALUMINUM FIN	COPPER TUBE / ALUMINUM FIN	COPPER TUBE / ALUMINUM FIN	COPPER TUBE / ALUMINUM FIN
VOLTAGE/PHASE/ 60Hz	208/230/3 460/3	208/230/3 460/3	208/230/3 460/3	208/230/3 460/3
MINIMUM CIRCUIT AMPS	50.5 27.3	62 31	87.5 46.3	103 48
DIMENSIONS (APPROX.)	62" L x 40" W x 69" H	74"L x 40" W x 70" H	88" L x 40" W x 70" H	88" L x 40" W x 70" H
WEIGHT	1700 LBS	1400 LBS	1900 LBS	2000 LBS
PUMP	1 -1/2 HP	2 HP	2 HP	3 HP
PUMP OUTPUT	55 GPM @ 30PSI	76 GPM @ 30PSI	76 GPM @ 30PSI	95 GPM @ 30PSI
TANK SIZE	41 GAL	80 GAL	80 GAL	80 GAL
TANK CONSTRUCTION	STAINLESS STEEL	STAINLESS STEEL	STAINLESS STEEL	STAINLESS STEEL

CONTROLS:

Multi Stage PLC temperature controller with constant (set point/process temperature) LED readout and self diagnostics on standard units

REFRIGERATION COMPONENTS:

Efficient scroll compressors, sight glass/moisture indicators, balanced port expansion valves, filter driers, service valves, stainless steel/copper brazed plate evaporators, fan cycling head pressure controls

PROCESS FLUID COMPONENTS:

Rugged stainless steel centrifugal pumps, with manual by-pass bronze "Y" strainer with 20 mesh stainless steel screen, insulated stainless steel reservoir with shoe box lid, tank level sight glass, fill and drain ports.

SAFETY CONTROLS:

High/low pressure safety, freeze, "low water flow safety" with manual resets. Thermal and short circuit protection for pump motors, compressors and fan motors.

OPERATING TEMPERATURES:

Process fluid: 42°F to 70°F for standard units (20°F to 70°F for low leaving fluid temperatures)
Ambient air: 40°F to 115° for standard units (-20°F to 115°F for outdoor units with optional low ambient modifications)

CONSTRUCTION:

All welded powder coated steel frame and cabinet, 5" phenolic casters with ball bearings and grease fittings (on indoor models add 6 1/2" to the height).

WARRANTY:

One Year Parts; Five Year Compressor

OPTIONS

- Flow Capacities (Pump Up-Grade)
- Outdoor Service
- Low Leaving Fluid Temperature
- Spare Parts Kit
- Locking Casters
- Split System
- Reverse-Flow
- Hot Gas By-Pass For Capacity Control
- Labor Warranty
- Manual By-Pass
- Low Ambient Modification
- Line Phase Monitor Protection
- Multiple Pumps
- EZ Clean Filter
- Pro-Tec Coil Coating
- Flow Meters

Note: All specifications subject to change without notice.

Compare our Price and Warranty

2730 Maximilian Dr., Houston, Texas 77032 • 281-227-8400 T• 1-800-473-9178 Toll Free • 281-227-8404 F

www.waterchillers.com

Performance Curve and Data Sheet

PUOD-000-015-0-0

1-1/2Hp/3Ø Motor ODP/ Pump with 4.75" Impeller and 0.220" Vane at 3500rpm

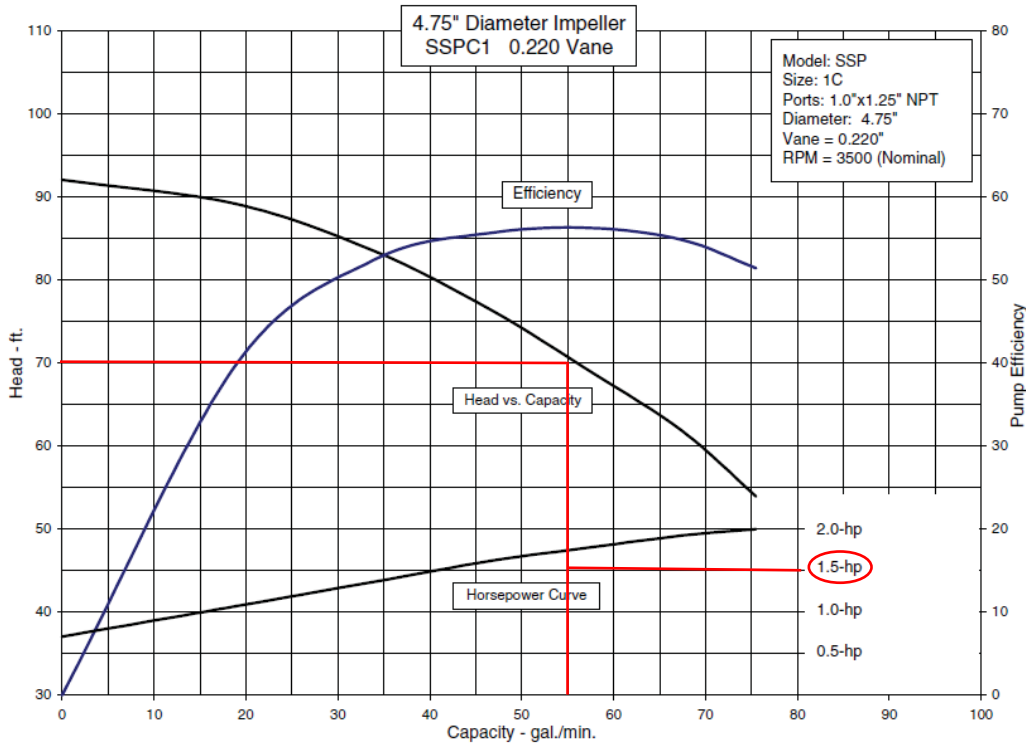

Clean water based performance at 60 deg. F.

3/01/01

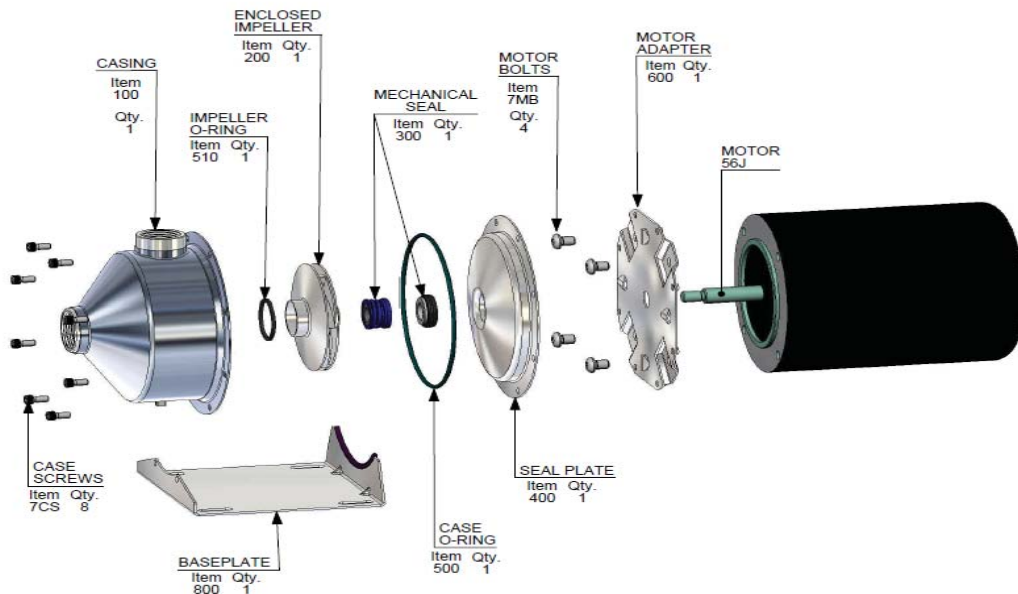

ASP-SSPC Pump/Motor Assembly Exploded View

- If needed, the pump label is located on the pump casing near outlet port under the insulation. Carefully pull insulation up near the unglued section. Pump Base (*not supplied with footed motors*)
- Reference the chiller serial number when ordering parts for specific supplied pump.

COLD SHOT CHILLERS / Marrone & Co., Inc.

2730 Maximilian Drive, Houston, Texas 77032 • Phone (800) 473-9178, (281) 227-8400

Fax (800) 473- 9175, (281) 227-8404 • www.waterchillers.com

LEFT

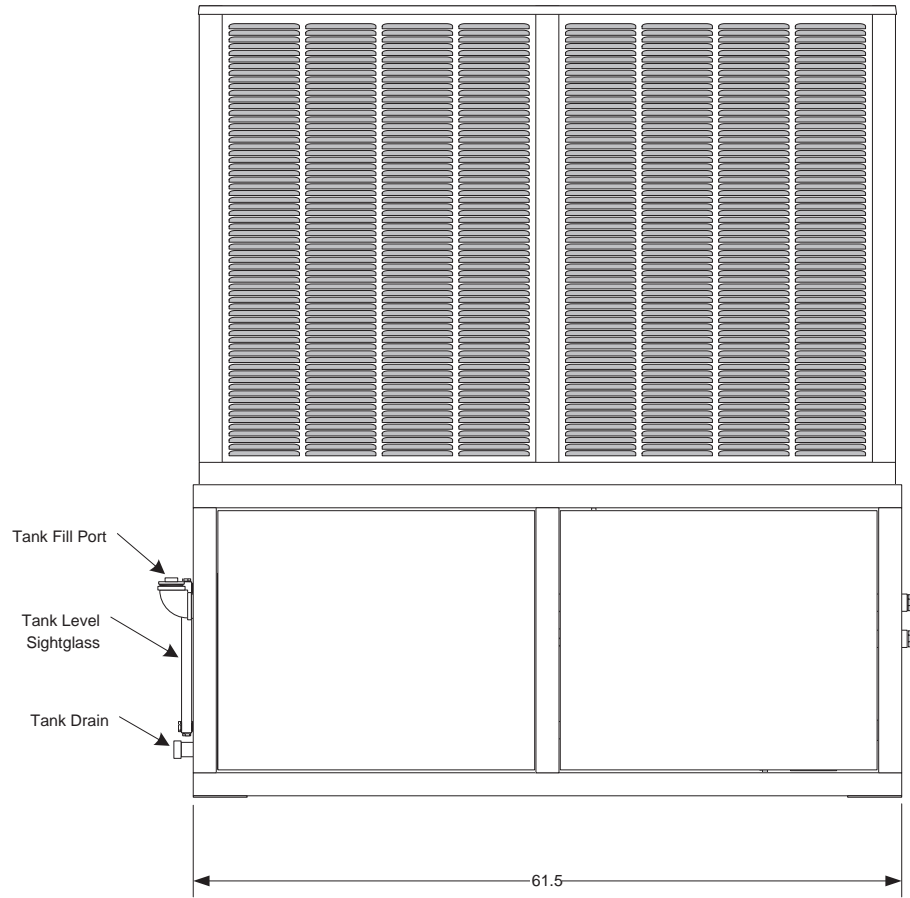

FRONT

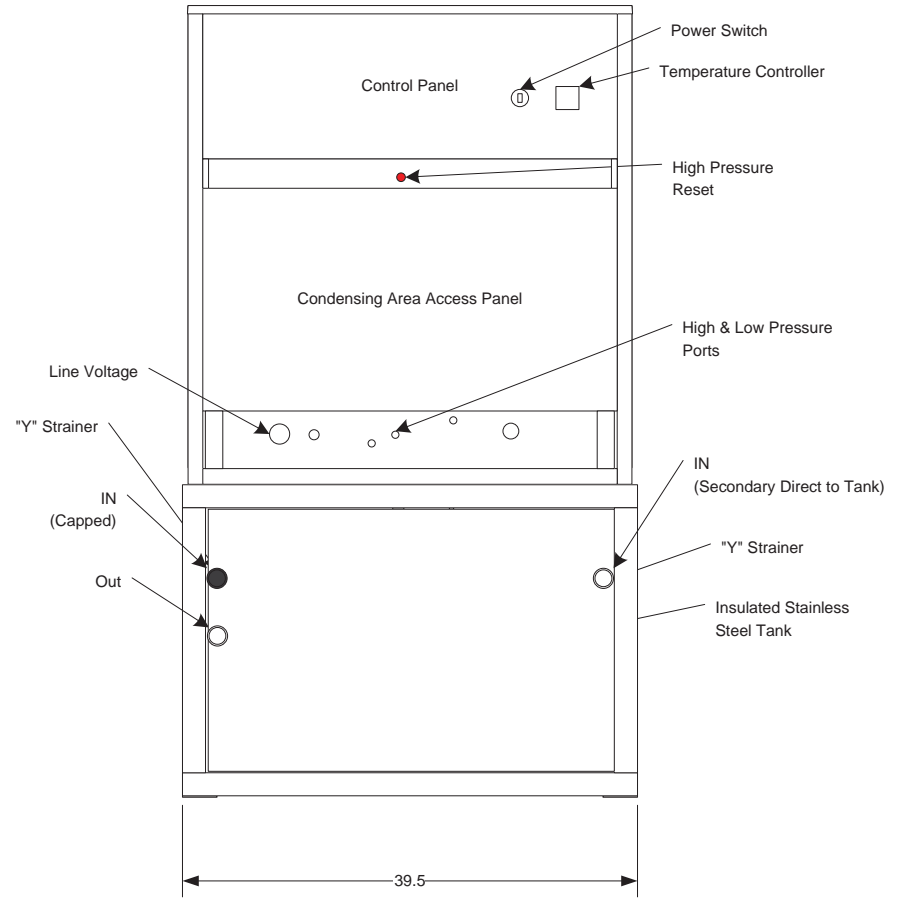

Notes

- Unit should be installed with at least 4' clearance on all sides and a minimum of 8' clear air space above the unit
- Dimensions are approximate. (inches)
- Casters, optional.
- All specifications subject to change without notice.

COLD SHOT CHILLERS

DRAWN		ENGINEERING	SIZE	VIEW	DWG NO	REV
ISSUED		9/26/2014	A	Left/Front	INSTALLATION DRAWING ACWC-120-E-DR (FullCabinet, Dual Return) - Typical	2
SCALE		1 : 16.67	DWG-INST_ACWC-120-E-DR(FMC)_(0113).vsd			SHEET

RIGHT

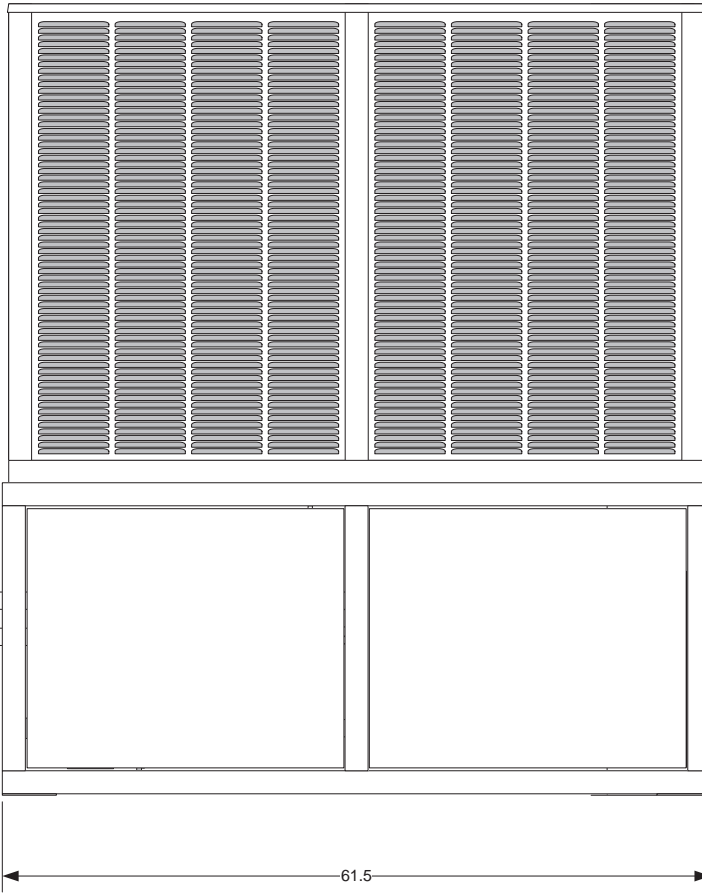

BACK

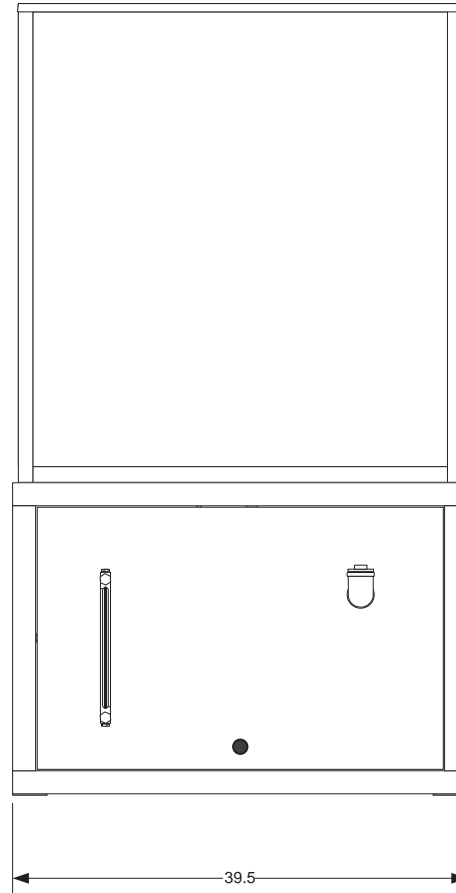

BACK

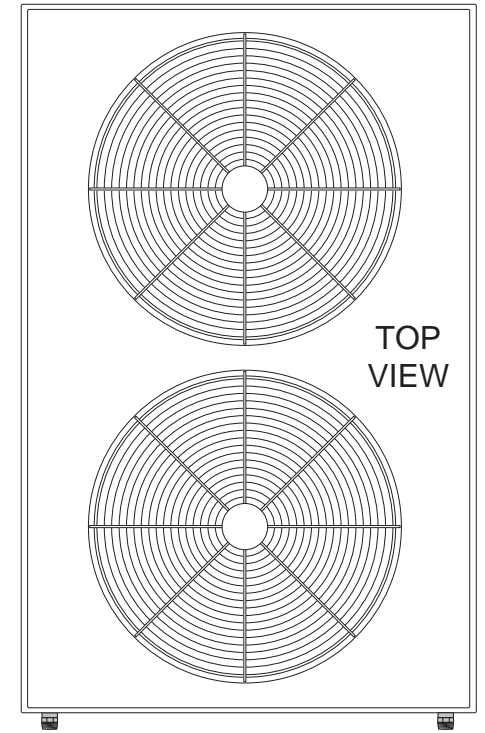

Notes

- Unit should be installed with at least 4' clearance on all sides and a minimum of 8' clear air space above the unit
- Dimensions are approximate. (inches)
- Casters, optional.
- All specifications subject to change without notice.

COLD SHOT CHILLERS

DRAWN ENGINEERING

ISSUED 9/26/2014

SIZE	VIEW	DWG NO	REV
A	Right/Back/Top	INSTALLATION DRAWING ACWC-120-E-DR (FullCabinet, Dual Return) - Typical	2
SCALE	1 : 16.67		DWG-INST_ACWC-120-E-DR(FMC)_(0113).vsd

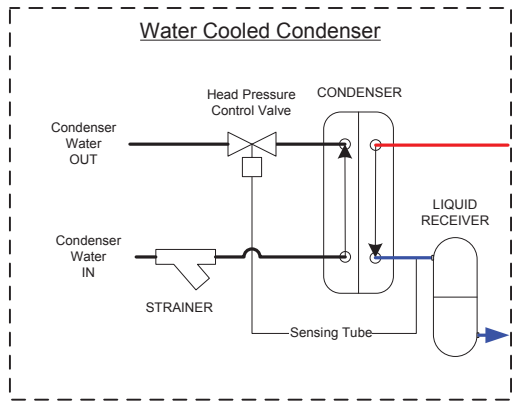
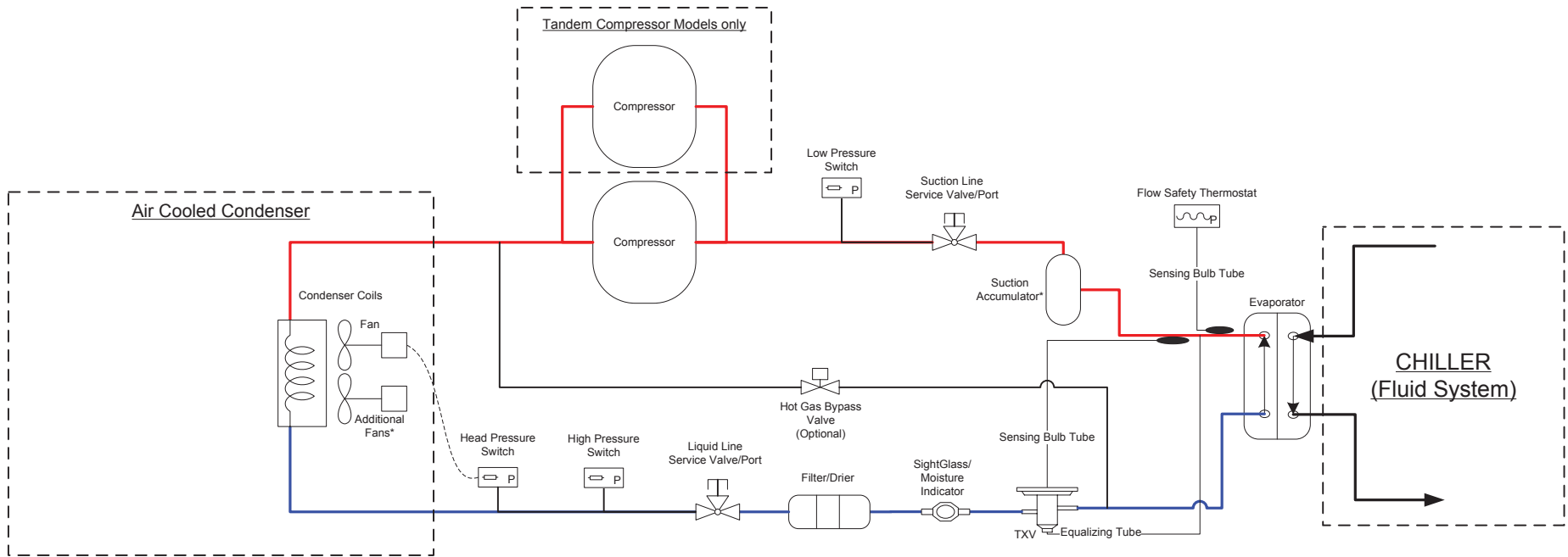

- NOTES
- All specifications and designs are subject to change without notice.
 - Hot Gas Bypass optional. For capacity and/or ambient condition use.
 - Temperature Controller typically monitors the tank temperature on portable models, the entering temperature (from the process) on stationary and reverse flow models.
 - Flow Safety thermostat typical on indoor units or outdoors to 40F ambient, typically.
 - * Dependent on system design.

COLD SHOT CHILLERS

DRAWN ENGINEERING

ISSUED 11/12/2013

SIZE	DETAIL
A	ref.circuit

REFRIGERATION & CHILLED FLUID CIRCUIT Typical Air/Water-Cooled Water Chiller (ACWC and WCWC) Single Refrigerant Circuit System

REV
2

SCALE NTS

Typical ref.circuit .vsd

SHEET 1

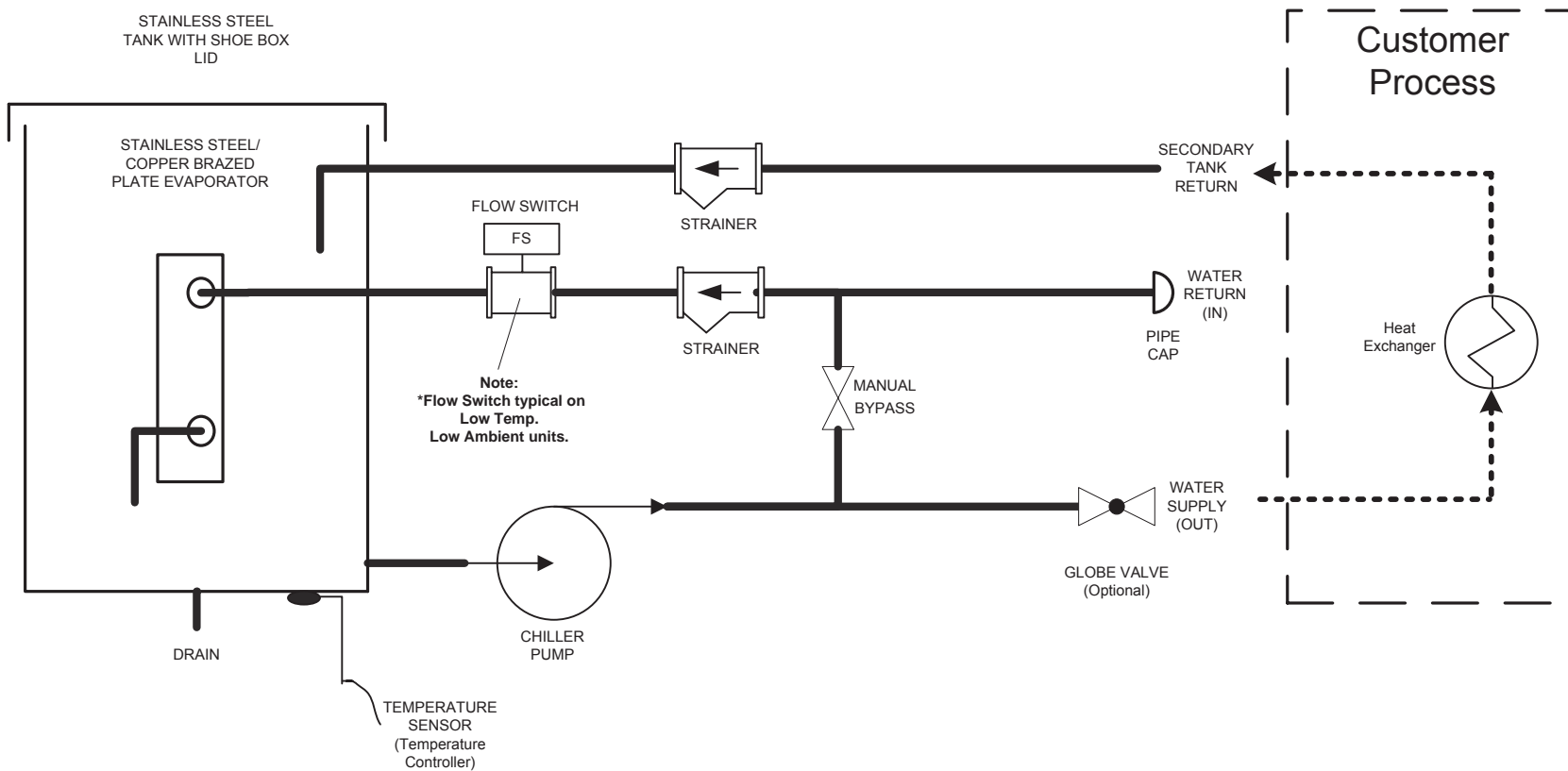

COLD SHOT CHILLERS

DRAWN ENGINEERING		SIZE	FSCM NO	DWG NO	REV
		A		CHILL WATER CIRCUIT – TYPICAL E - "Portable - Dual Return with Globe Valve and Flow Switch"	1
ISSUED	05/2011	SCALE	NA	SHEET	2