

# ONE INDUSTRIAL WAY PORTLAND, MAINE 04103

LOT DIMENSIONS - 230 FT X 150 FEET  
BUILDING DIMENSIONS - 200 FEET X 90 FEET

SITE OF PROPOSED OUTDOOR  
SEATING AREA  
DIMENSIONS - 16 FT X 27 FT

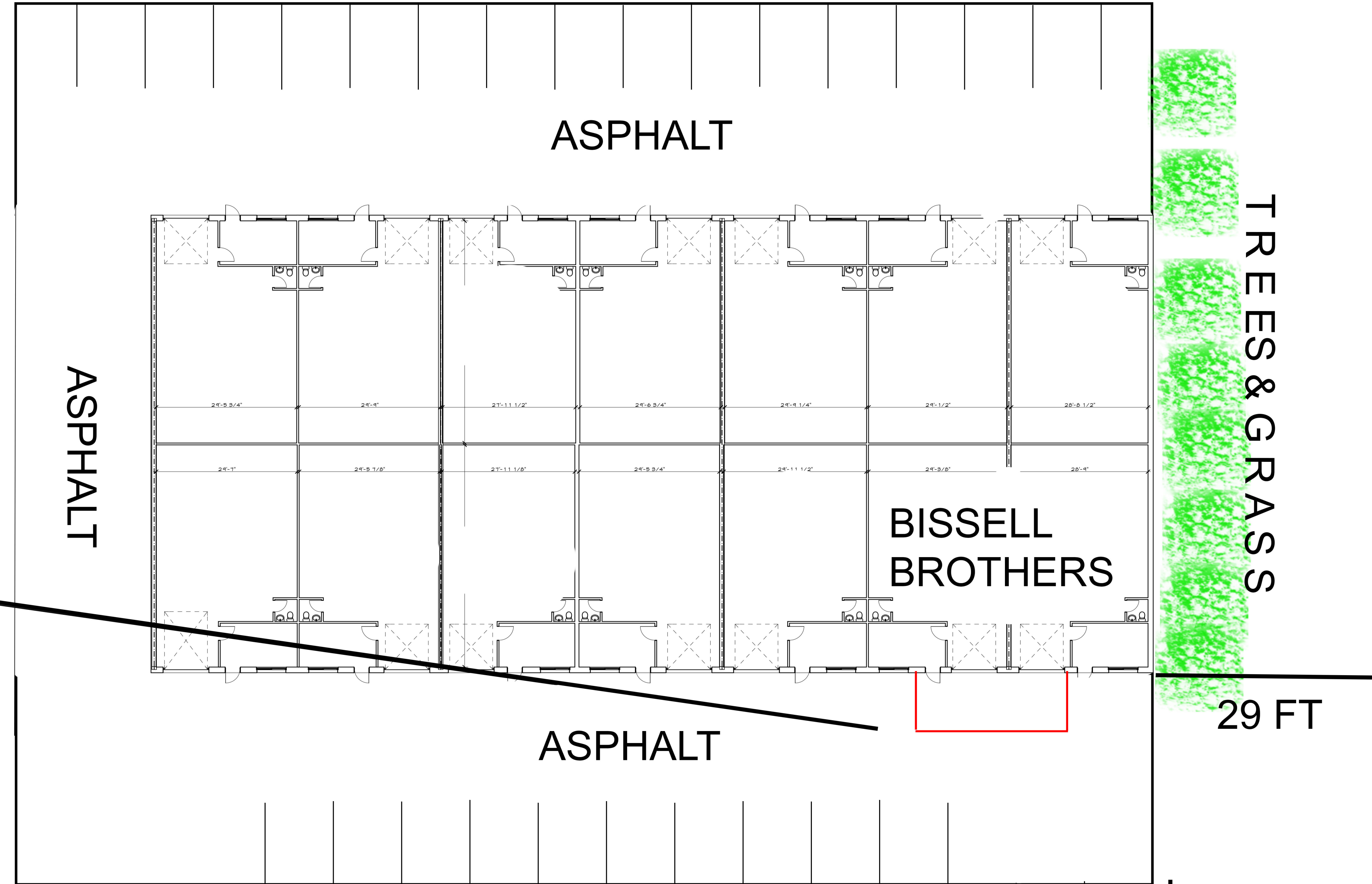

RIVERSIDE STREET

SIDEWALK

INDUSTRIAL WAY