

GRANT HAYS  
ASSOCIATES

ARCHITECTURE & INTERIOR DESIGN  
P.O. BOX 6179 FALMOUTH MAINE 04105  
207.871.5900 www.granthays.com

JTAL

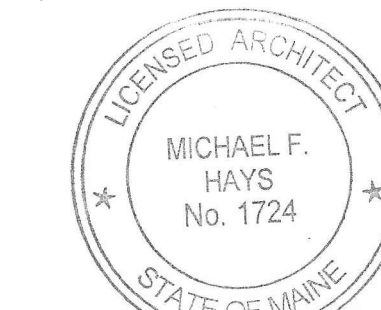

Michael F. Hays

REVISION

- ▲ 10 MAY '16
- ▲ 27 MAY '16

PROJECT NAME

**foundation**  
BREWING COMPANY  
EXPANSION

ONE INDUSTRIAL WAY  
PORTLAND, MAINE 04105

JHELT

**BOILER ROOM  
& EQUIPMENT  
PLATFORM  
SECTIONS**

DATE

15 MAR '16

JSCALE

A/ NOTED

JDRAWN

MFH/mgk

JJOB NO.

160201

JHELT

**A7**

COPYRIGHT  
REPRODUCTION OR REVISE OF THIS  
DOCUMENT WITHOUT WRITTEN  
PERMISSION FROM GRANT HAYS  
ASSOCIATES IS PROHIBITED.

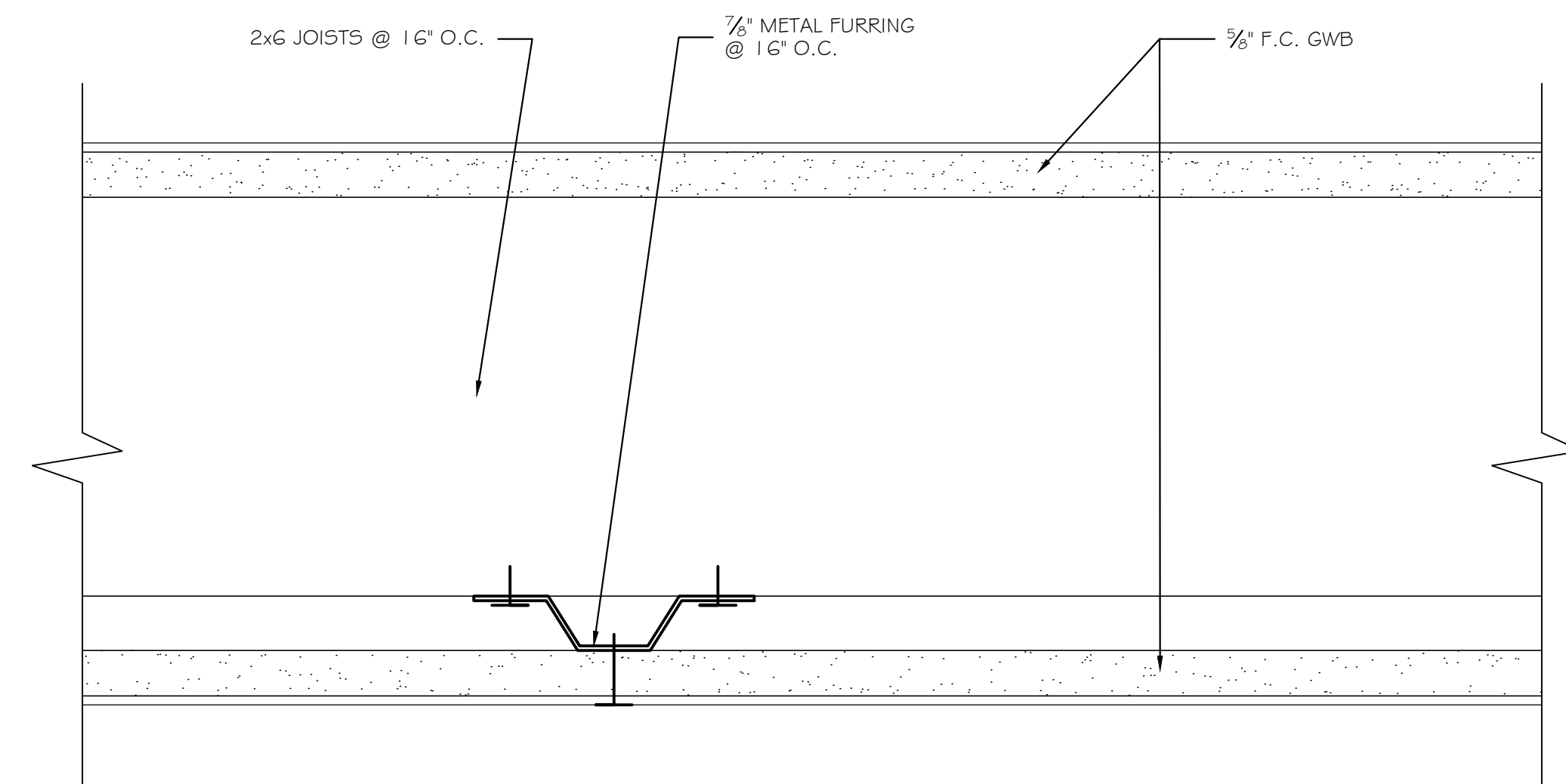

③ 1 HR RATED BOILER ROOM CEILING  
HALF SIZE

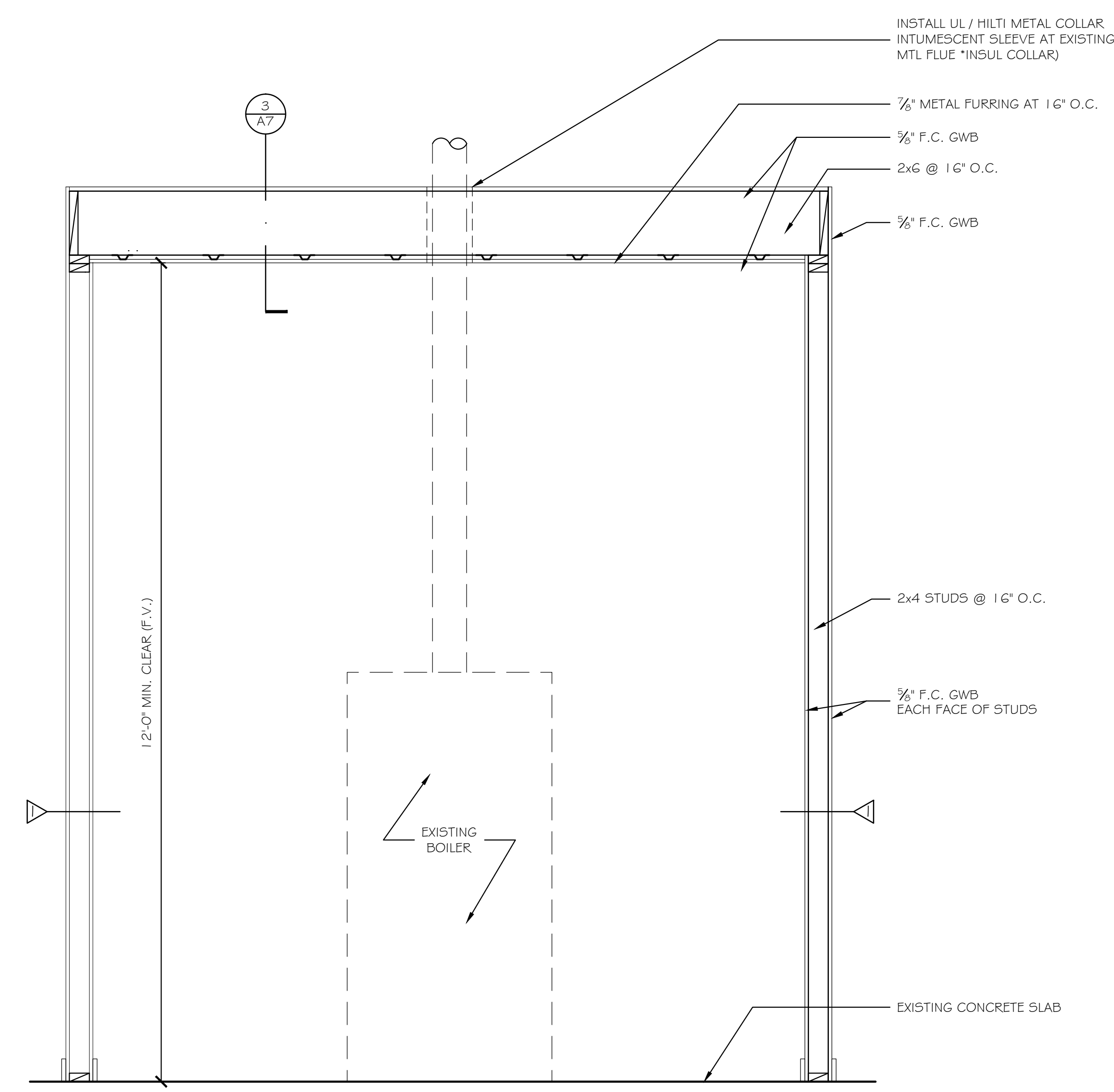

② TYPICAL BOILER ROOM SECTION  
SCALE: 3/4" = 1'-0"

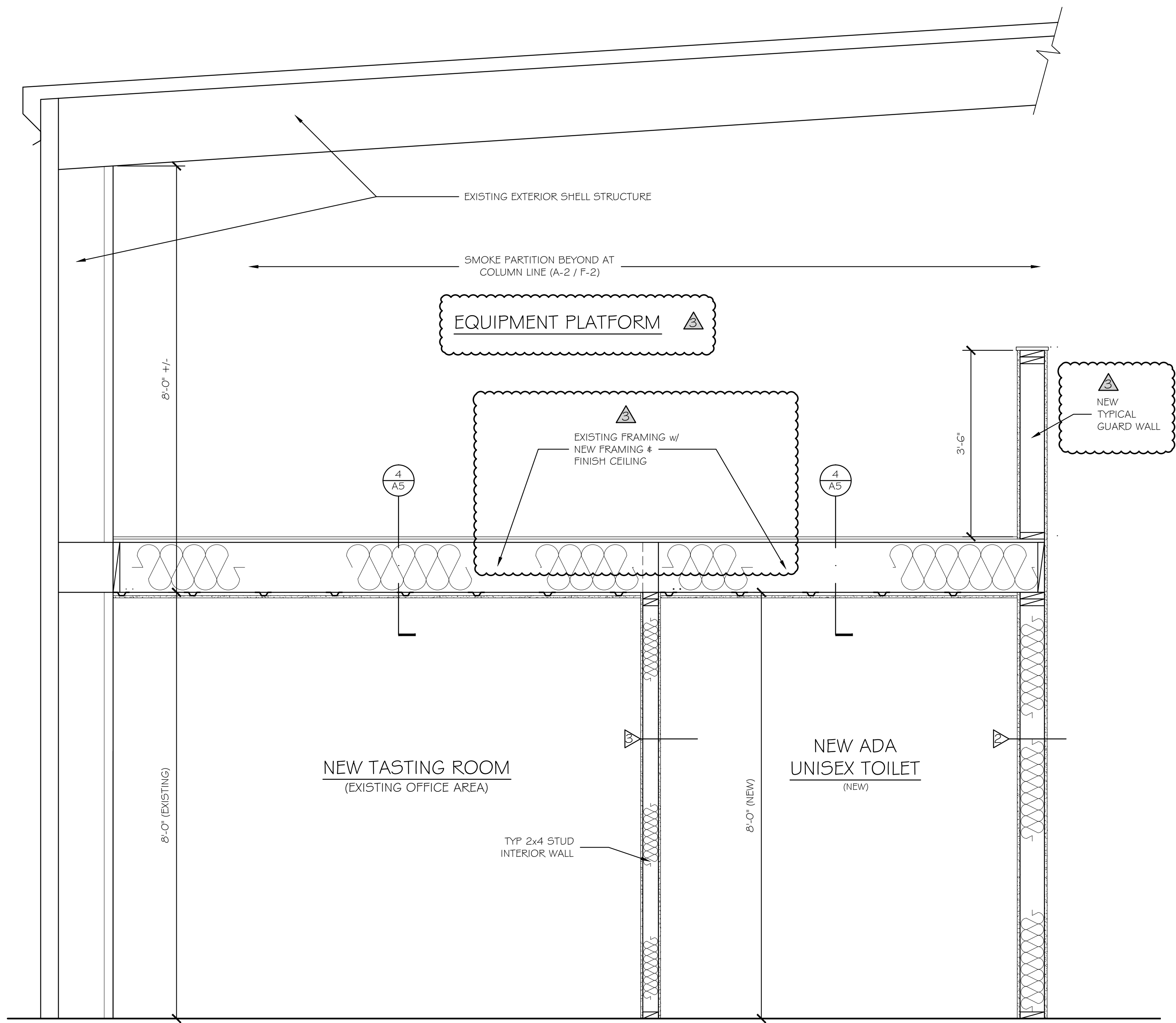

① TYPICAL EQUIPMENT PLATFORM SECTION AT SMOKE SEPARATION  
SCALE: 3/4" = 1'-0"

1. INSTALL FIRESTOP SYSTEMS AT ALL WALL & CEILING (MEZZANINE) PENETRATIONS PER DETAIL 4 / A4; IBC 713 & NFPA FOR SMOKE SEPARATION OF A-2 / F-2 OCCUPANCIES.

1. INSTALL FIRESTOP SYSTEMS AT ALL RATED ASSEMBLY PENETRATIONS PER DETAIL 4 / A4; IBC 713; NFPA; ASHRAE AND UL. VERIFY LOCAL REQUIREMENTS WITH AHJ.
2. MECHANICAL SUBCONTRACTOR SHALL COORDINATE FRESH AIR SUPPLY LOCATION WITH OWNER.