

1 Industrial Way
Building with present occupancy

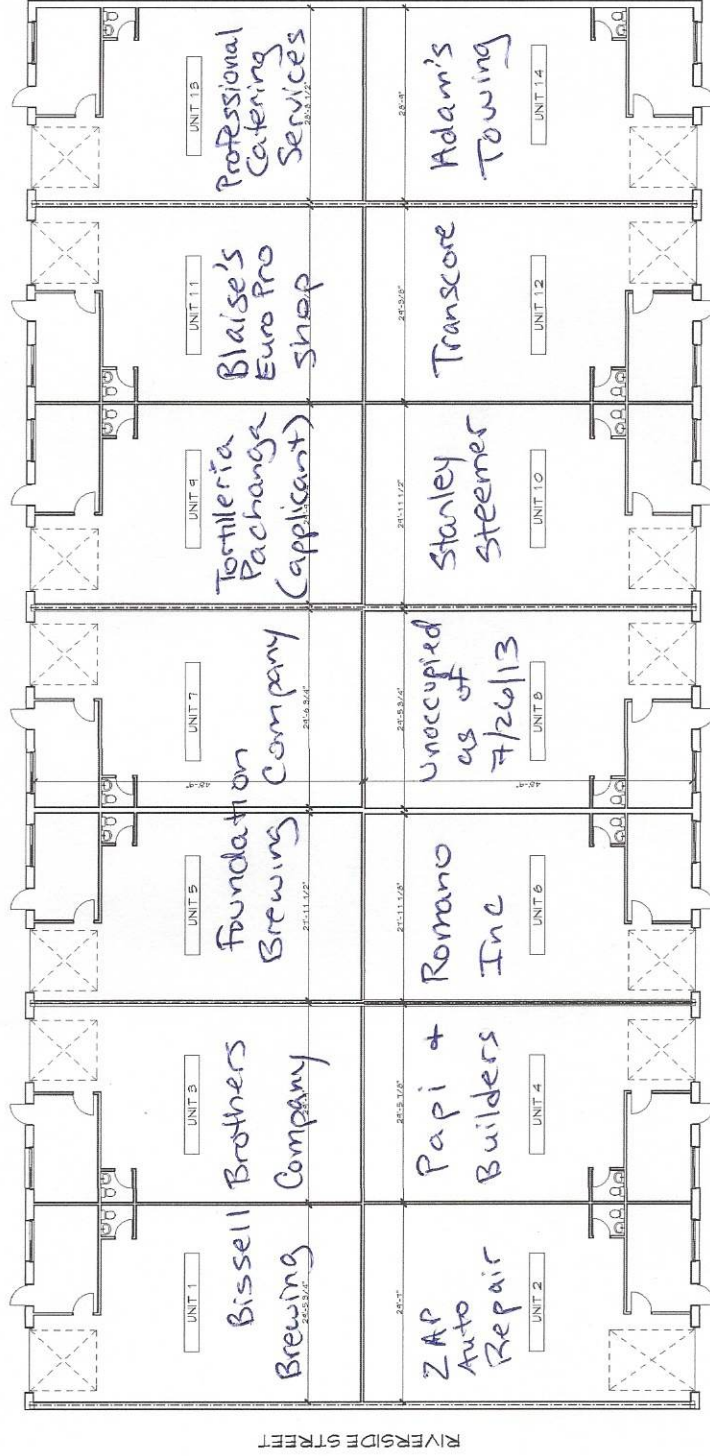

RIVERSIDE STREET

1 FIRST FLOOR
SCALE 1/8" = 1'-0"

PROGRESS PLAN FOR REVIEW
11-28-2012

ONE INDUSTRIAL WAY
PORTLAND, MAINE

CANOPY DESIGN

WHIPPLE - CALLENDER ARCHITECTS

155 PLEASANT AVE
PORTLAND, ME 04103
TEL: 603.733.1111
WWW.WHIPPLECALLENDER.COM

DATE: 11/28/12
DRAWN BY: AEC
CHECKED BY: AEC
JOB: 11K-12
SHEET: CONDO LAYOUT PLAN

THIS DOCUMENT PREPARED BY WHIPPLE - CALLENDER ARCHITECTS FOR THE CLIENT'S USE ONLY. IT IS THE CLIENT'S RESPONSIBILITY TO OBTAIN ALL NECESSARY PERMITS AND APPROVALS FROM THE APPROPRIATE AGENCIES. THE ARCHITECTS ASSUME NO LIABILITY FOR ANY ERRORS OR OMISSIONS IN THIS DOCUMENT. THE ARCHITECTS SHALL NOT BE RESPONSIBLE FOR ANY CONSTRUCTION DEFECTS OR DAMAGES RESULTING FROM THE USE OF THIS DOCUMENT.