

LOCATION MAP

N.T.S.

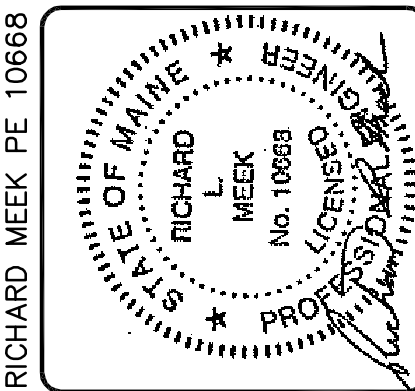

DESIGNED	CHECKED
RLM	RLM
B RLM 6-29-15 SUBMIT FINAL SITE PLAN APPLICATION TO CITY A RLM 5-21-15 SUBMIT PRELIMINARY SITE PLAN APPLICATION TO CITY REV. BY: DATE: STATUS: THIS PLAN SHALL NOT BE MODIFIED WITHOUT WRITTEN PERMISSION FROM SEBAGO TECHNICS, INC. ANY ALTERATIONS AUTHORIZED OR OTHERWISE, SHALL BE AT THE USER'S SOLE RISK AND WITHOUT LIABILITY TO SEBAGO TECHNICS, INC.	

**SEBAGO**  
TECHNICS

WWW.SEBAGOTECHNICS.COM  
250 Goddard Rd.  
Suite B  
LeWistown, ME 04106  
Tel. 207-200-2100 Tel. 207-783-5656

**SITE PLAN**  
OF:  
**LOT 5 INDUSTRIAL WAY**  
81 INDUSTRIAL WAY  
PORTLAND, ME 04103

FOR:  
**DEERFIELD 91 INDUSTRIAL, LLC.**  
1 CANAL PLAZA  
PORTLAND, ME 04101

PROJECT NO. **04479** SCALE **1" = 30'**

**SHEET 3 OF 7**

**NOTES:**

ALL WORK WITHIN THE ROAD RIGHT-OF-WAY SHALL MEET CITY OF PORTLAND TECHNICAL MANUAL STANDARDS

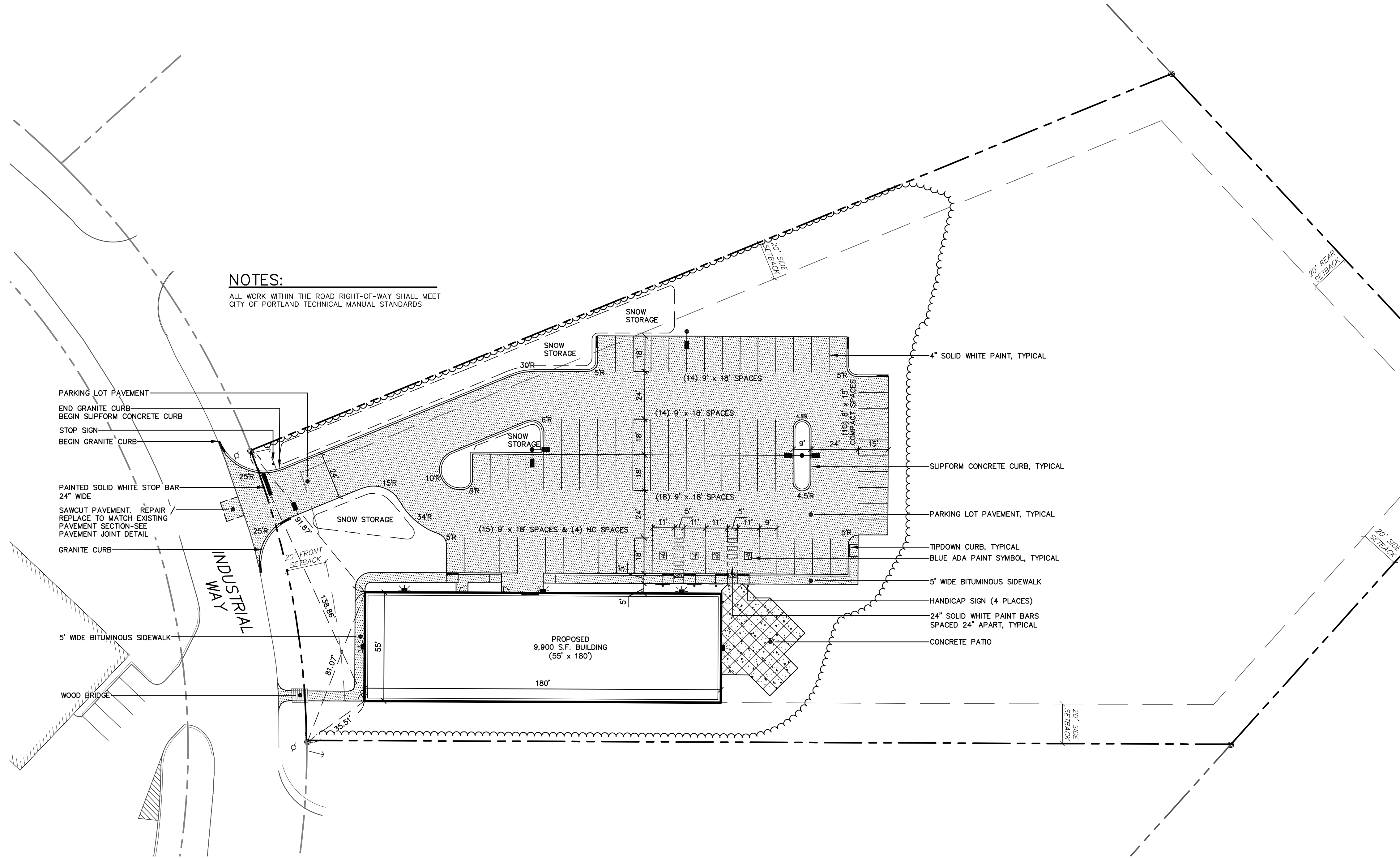

- PARKING LOT PAVEMENT
- END GRANITE CURB
- BEGIN SLIPFORM CONCRETE CURB
- STOP SIGN
- BEGIN GRANITE CURB
- PAINTED SOLID WHITE STOP BAR  
24" WIDE
- SAWCUT PAVEMENT. REPAIR  
REPLACE TO MATCH EXISTING  
PAVEMENT SECTION-SEE  
PAVEMENT JOINT DETAIL
- GRANITE CURB
- 5' WIDE BITUMINOUS SIDEWALK
- WOOD BRIDGE

- SNOW STORAGE
- SNOW STORAGE
- SNOW STORAGE
- SNOW STORAGE
- 4" SOLID WHITE PAINT, TYPICAL
- SLIPFORM CONCRETE CURB, TYPICAL
- PARKING LOT PAVEMENT, TYPICAL
- TIPDOWN CURB, TYPICAL
- BLUE ADA PAINT SYMBOL, TYPICAL
- 5' WIDE BITUMINOUS SIDEWALK
- HANDICAP SIGN (4 PLACES)
- 24" SOLID WHITE PAINT BARS  
SPACED 24" APART, TYPICAL
- CONCRETE PATIO

**LEGEND**

EXISTING	PROPOSED
---	---
---	---
○	○
---	---
---	---
---	---
---	---
---	---
---	---
---	---

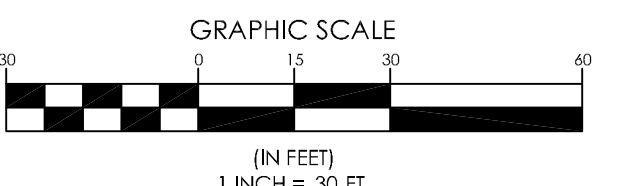

**GENERAL NOTES:**

- THE RECORD OWNER OF THE PARCEL IS ANDREW SIGFRIDSON AND APRIL WERNIG BY QUITCLAIM DEED WITH COVENANT DATED DECEMBER 13, 2013 AND RECORDED AT THE CUMBERLAND COUNTY REGISTRY OF DEEDS ON DECEMBER 23, 2013 IN BOOK 31248, PLAN 49.
- THE PROPERTY IS SHOWN AS LOT 5 IN BLOCK C ON THE CITY OF PORTLAND'S TAX MAP AND IS LOCATED IN THE INDUSTRIAL MODERN IMPACT (IM) DISTRICT.
- TOTAL AREA OF PARCEL IS APPROXIMATELY ±3.24 ACRES.
- BOUNDARY AND TOPOGRAPHIC INFORMATION SHOWN HEREON IS BASED UPON A FIELD SURVEY PERFORMED BY SEBAGO TECHNICS, INC. IN APRIL OF 2015 AS WELL AS GROUND PROOFED LIDAR DATA.
- MOST EASTERLY FOUND REBAR AND MOST SOUTHWESTERLY FOUND REBAR HELD WHEN ESTABLISHING THE SIDELINES OF LOT 5 DUE TO THEM BEING ORIGINAL CORNERS OF SUBDIVISION REFERENCED IN PLAN (SEE PLAN REFERENCE 6A)
- PLAN REFERENCES:
  - A. TURNPIKE INDUSTRIAL PARK RECORDING PLAT, RIVERSIDE STREET, BY LAND USE CONSULTANTS DATED MARCH 25, 1986, LAST REVISED SEPTEMBER 9, 1986, PLAN BOOK 157/PAGE 61
  - B. RIVERSIDE SOUTH GOLF COURSE EXISTING CONDITIONS STANDARD BOUNDARY SURVEY #986-1040 RIVERSIDE STREET BY THE CITY OF PORTLAND, MAINE PUBLIC WORKS DEPARTMENT ENGINEERING DIVISION DATE MAY 2011 AND LAST REVISED APRIL 24, 2012, PLAN NUMBER 881/18
- PLAN ORIENTATION IS GRID NORTH, MAINE STATE PLANE COORDINATE SYSTEM, WEST ZONE 1802-NAD83 BASED ON DUAL FREQUENCY GPS OBSERVATIONS. ELEVATIONS DEPICTED HEREON ARE BASED ON THE CITY OF PORTLAND'S TEMPORARY SITE BENCHMARK #8 (SEE PLAN REFERENCE 5B)
- UTILITY INFORMATION DEPICTED HEREON IS COMPILED USING PHYSICAL EVIDENCE LOCATED IN THE FIELD. UTILITIES DEPICTED HEREON MAY NOT NECESSARILY REPRESENT ALL EXISTING UTILITIES. CONTRACTORS AND/OR DESIGNERS NEED TO CONTACT DIG-SAFE SYSTEMS, INC. (1-888-DIG-SAFE) AND FIELD VERIFY EXISTING UTILITIES PRIOR TO CONSTRUCTION AND/OR EXCAVATION.
- THE PROPOSED DEVELOPMENT WILL BE SERVED BY PUBLIC WATER, PUBLIC SEWER AND UNDERGROUND ELECTRIC AND TELEPHONE.
- THE LOCUS PROPERTY AS DEPICTED HEREON DOES NOT FALL WITHIN A SPECIAL FLOOD HAZARD AREA AS DELINEATED ON THE FLOOD INSURANCE RATE MAP FOR PORTLAND, MAINE, CUMBERLAND COUNTY, COMMUNITY-PANEL NUMBER 230051 0001 B, HAVING AN EFFECTIVE DATE OF JULY 17, 1986. THE LOCUS FALLS WITHIN AN AREA IDENTIFIED AS ZONE C, AREAS OF MINIMAL FLOODING.
- A WETLAND DELINEATION WAS PERFORMED ON THIS PROJECT SITE IN OCTOBER 2013 BY GARY M. FULLERTON, CERTIFIED SOIL SCIENTIST OF SEBAGO TECHNICS, INC. AND LOCATED BY GROUND SURVEY. THIS DELINEATION CONFORMS TO THE STANDARDS AND METHODS OUTLINED IN THE 1987 WETLANDS DELINEATION MANUAL AND REGIONAL SUPPLEMENT AUTHORED AND PUBLISHED BY THE U.S. ARMY CORPS OF ENGINEERS.
- PARKING SUMMARY:
 

PARKING SPACES REQUIRED	1 SPACE/400 S.F.=9,900/400 = 25 SPACES
PARKING SPACES PROVIDED	61 (9'x18' STANDARD SPACES) 10 (8'x15' COMPACT SPACES) 4 (11'x18' HANDICAP SPACES) 75 TOTAL SPACES

044793.dwg 146:5