

JFH/L

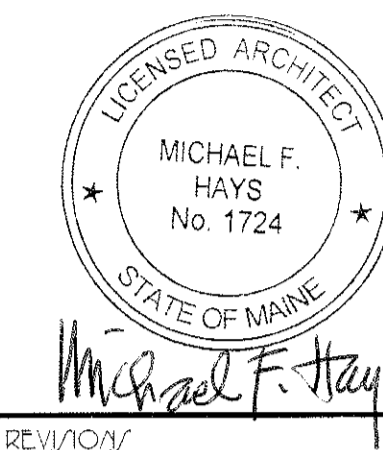

REV 1/10/15

DRAWING NAME

TEENANT IMPROVEMENTS
DEERFIELD 91 INDUSTRIAL LLC
81 INDUSTRIAL WAY
PORTLAND, MAINE

JFH/ET

CODE COMPLIANCE PLAN

DATE 27 JUL '15

JSCALE 1/8"=1'-0"

DRAWN MFH/mgk

JOB NO. 150791

JFH/ET

A1

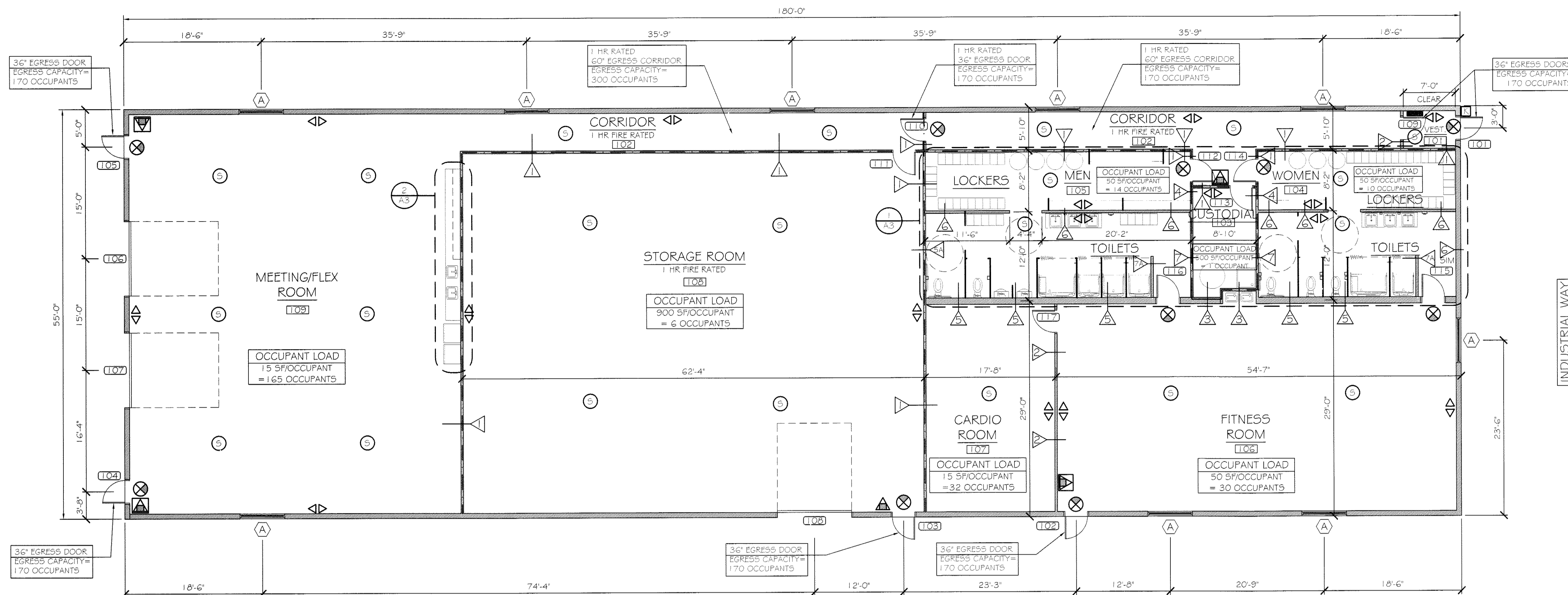

NFPA LEGEND

- EXIT LIGHT
- FIRE EXTINGUISHER, w/ BRACKET
- FIRE EXTINGUISHER, w/ SEMI-RECESSED CABINET
- EMERGENCY LIGHT
- SMOKE DETECTOR w/ AUDIBLE BASE
- KNOX BOX
- ANNUNCIATOR PANEL

OCCUPANT LOADS

NFPA 101 LIFE SAFETY (2012 ED.)	250 (BULK AREA)
IBC (2012 ED.)	250 (OCC. TABLE) 100A.1.1

CODE COMPLIANCE PLAN

SCALE: 1/8" = 1'-0"

NOTES:

1. KNOX BOX LOCATION SHALL BE VERIFIED BY THE AHJ.
2. ANNUNCIATION PANEL LOCATION SHALL BE VERIFIED w/ THE AHJ.
3. ALARM SYSTEM SHALL BE INTERCONNECTED THROUGHOUT BUILDING.
4. REFER TO SHEET A4 FOR ACCESSIBILITY DETAILS & NOTES.

NFPA 101 LIFE SAFETY CODE - 2012 Edition

Building Classification: 9,900 sf Total - Assembly (6,900 sf) + Storage (3,000 sf)
 Construction Type: III/000
 Hazard Classification: Ordinary Hazard
 Occupant Loads:
 Meeting/Flex @ 15 sf/occupant = 165
 Exercise Room (cardio) @ 15 sf/occupant = 32
 Exercise Room (equipment) @ 50 sf/occupant = 30
 Lockers @ 50 sf/occupant = 24
 Storage/Custodial @ 500 sf/occupant = 6
 Total Occupant Load = 255

Separation of Use Rating: 1 hour
 Janitor, Mech, Stor Rating: 1 hour if over 100 sf
 Minimum Headroom: 7'-6" at occupied areas

Buildings Uses Assembly/Storage

Max. Allowable Travel Distance: 200'
 Max. Allowable Common Path: 75'
 Max. Dead End Corridor Length: 20'
 Minimum Egress Corridor Width: 44"
 Minimum Number of Required Exits: 2
 Minimum Exit Access Corridor Rating: 1 hr
 Separation of exits: 0.5 diagonal distance = 94'
 Minimum Egress Door Width: 36"
 Exit Lighting: Required
 Emergency Lighting: Required
 Fire Alarm System: Not Required
 Fire Sprinkler System: Not Required
 Portable Fire Extinguishers: Required

2009 INTERNATIONAL BUILDING CODE

Use Group Classification: 9,900 sf Total - A-3 @ 6,900 sf / S-2 @ 3,000 sf
 Occupant Loads:
 Meeting/Flex @ 15 sf/occupant = 165
 Exercise Room (cardio) @ 15 sf/occupant = 32
 Exercise Room (equipment) @ 50 sf/occupant = 30
 Lockers @ 50 sf/occupant = 24
 Storage/Custodial @ 500 sf/occupant = 6
 Total Occupant Load = 255

Area Use Separation Ratings:
 Janitor, Mech & Storage Rooms: 1 hour if over 50 sf but under 100 sf

Building Limitations

Construction Type: 2B
 Maximum Height: 2 story @ A-3 / 3 story @ S-2
 Maximum Area / Floor: 9,500 sf @ A-3 / 26,000 sf @ S-2

Fire Resistance Ratings

Structural Frame: None
 Load Bearing Exterior Walls: None
 Load Bearing Interior Walls: None
 Roof/Floor Structure: None
 Exit Corridors: 1 hour

Minimum Number of Exits: 2
 Maximum Exit Travel Distance: 200' @ A-3 / 300' @ S-2
 Maximum Dead End Corridor Length: 20'
 Maximum Common Travel Path: 75'
 Minimum Corridor Width: 44"

Fire Alarm/Detection System: Not Required
 Fire Sprinkler System: Not Required
 Portable Fire Extinguishers: Required
 Exit Lights: Required
 Emergency Lighting: Required

Building Live Loads
 Assembly: 100 psf
 Corridors: 80 psf
 Light Storage: 125 psf

MUBEC (Maine Uniform Building Energy Code) MINIMUM INSULATION VALUES

Per 2009 IBCC: Table 502.7.2, 502.2(1) and 502.3

ZONE GA	R-VALUE	U-FACTOR	SHGC
Exterior wall	20.5	0.049	NA
Roof (above deck)	20.0	0.048	NA
Slab (24" band)	15.0	0.052	NA
Frost Wall	7.5	0.133	NA
Doors - Opaque	2.0	0.50	NA
Doors - Glazed	1.25	0.50	HR
Windows	2.9	0.35	HR
Storefront	2.2	0.45	HR