



Reviewed for Code Compliance
Inspection Division
Approved with Conditions
Date: 09/15/14

- NOTES:
1. TOP INDICATES TOP OF FOOTING
 2. TOC INDICATES TOP OF CONCRETE
 3. TOP OF CONCRETE AND TOP OF FOOTING ELEVATIONS ARE REFERENCED FROM FINISHED FLOOR ELEVATION = (+83.5) = 0'-0"
 4. UD INDICATES 4" SCHED. 40 PERFORATED PVC UNDERDRAIN (SHOWN SCHEMATICALLY) COORDINATE WITH SITE PLAN.
 5. F.F. INDICATES FINISHED FLOOR
 6. ADP, INC. RECOMMENDS CLEANOUTS AT EVERY OTHER CORNER OF FOUNDATION UNDERDRAIN.
 7. SEE S2 FOR GENERAL NOTES & SPECIFICATIONS
 8. FOOTINGS ARE CENTERED ON COLUMN GRIDS, UNO.
 9. SEE DETAIL SHEETS FOR PIER REINFORCING.
 10. G.C. VERIFY REQUIRED WIDTH OF ALL FOUNDATION WALL BOND-OUTS FOR DOOR OPENINGS PRIOR TO CONSTRUCTION.
 11. PROVIDE (2) $\frac{1}{2}$ " A307 ANCHOR BOLTS EA. SIDE OF FRAMED OPENINGS THROUGH EXTERIOR BUILDING WALLS. SEE DETAIL B2/S5 AND B4/S3.
 12. REMOVE EXG. SIDEWALK AND SEGMENTAL BLOCK RETAINING WALL WITHIN NEW BUILDING FOOTPRINT.
 13. CONTRACTOR VERIFY ALL DIMENSIONS NOTED (+/-).
 14. INSTALL KAGETECH FLOORING THROUGHOUT NEW BREWERY PRODUCTION AREA (COL LINES 1 TO 7.8). SLAB FLATNESS (VERTICAL DISTANCE BETWEEN HIGH/LOW POINTS) TOLERANCE NO MORE THAN $\frac{1}{8}$ " IN 10 LINEAL FEET. COORDINATE WITH TILE MANUFACTURER (KAGETECH) REQUIREMENTS.
 15. SLOPE SLAB AT FUTURE BATHROOMS $\frac{1}{4}$ " / FT TOWARDS DRAINS, COORDINATED FLOOR DRAIN LOCATIONS WITH ARCH AND MEP.
 16. SLAB SLOPES INDICATED ARE MINIMUM SLOPES.

PIER SCHEDULE		
MARK	SIZE	REINFORCING
P1	12"x20"	SEE A3/S4
P2	12"x22"	SEE A3/S4 SIM
P3	12"x12"	SEE C3/S4
P4	12"x26"	SEE B3/S4
P5	12"x28"	SEE B3/S4 SIM

FOOTING SCHEDULE		
MARK	SIZE	BOTTOM REINFORCING
F3	3'-0"x3'-0"x12"	(4) #5'S E.W.
F48	4'-0"x8'-0"x12"	#6'S AT 1'0" O.C. E.W.
F4	4'-0"x4'-0"x12"	(5) #5'S E.W.
F5	5'-0"x5'-0"x12"	(6) #5'S E.W.
F6	6'-0"x6'-0"x14"	(6) #6'S E.W.
F7	7'-0"x7'-0"x14"	(10) #5'S E.W.
F78	7'-0"x8'-0"x14"	(10) #5'S S.W. (12) #5'S L.W.
F8	8'-0"x8'-0"x14"	(12) #6'S E.W. TOP AND BOT
F9	9'-0"x9'-0"x14"	(14) #5'S E.W.
F13-8	13'-0"x8'-0"x14"	#6'S AT 8" O.C. E.W. TOP AND BOT
F9-15	9'-0"x15'-0"x14"	#6'S AT 8" O.C. E.W. TOP AND BOT

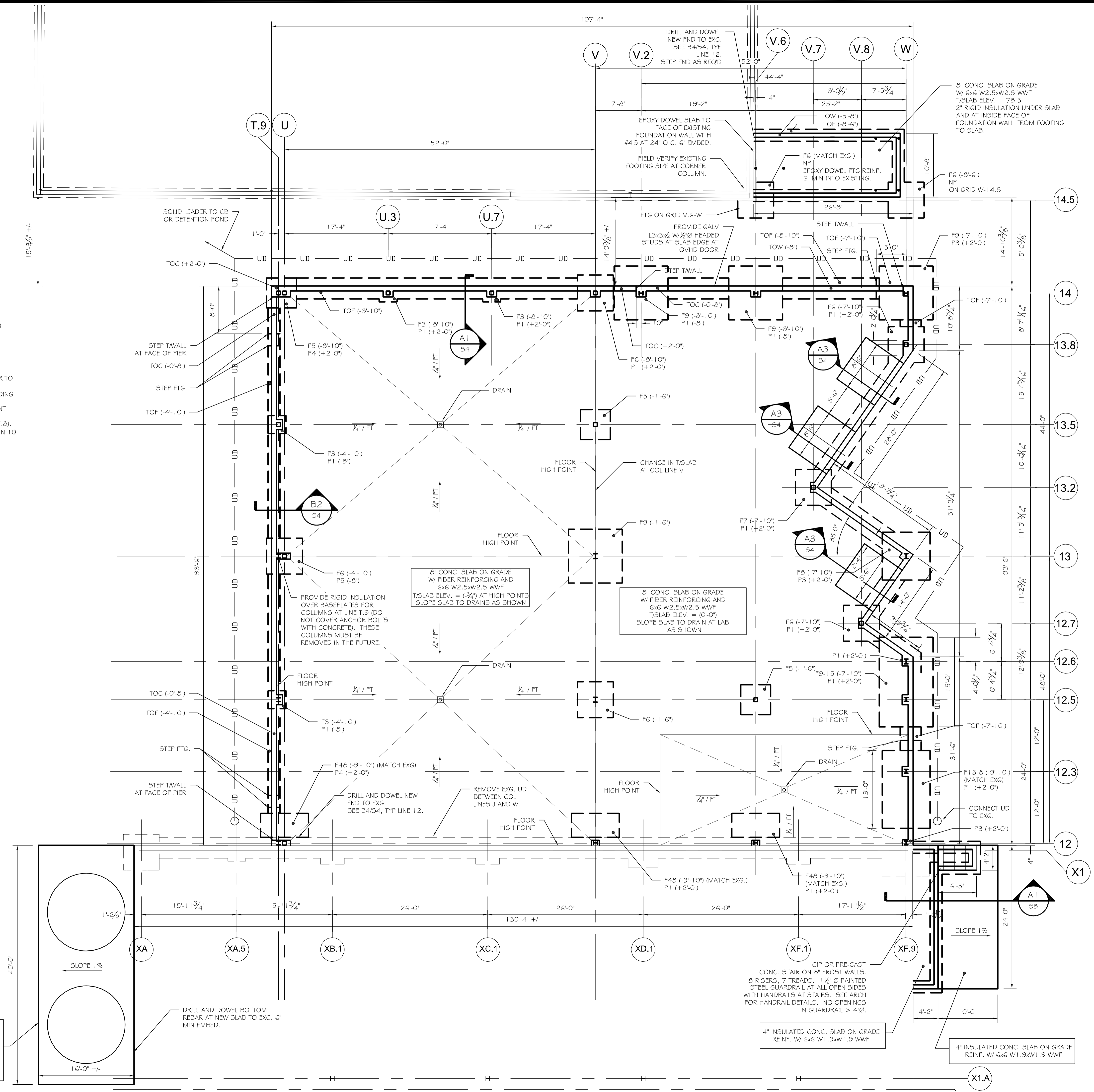

ALTERNATE S-2, TANK PAD:
18" CONC. SLAB ON GRADE
#5'S AT 8" O.C. E.W. TOP AND BOT.
F.F. ELEV. = (-0'-0")
PROVIDE 2" DOW HI-LOAD 40 RIGID INSULATION UNDER SLAB, EXTEND 48" BEYOND SLAB EDGES.

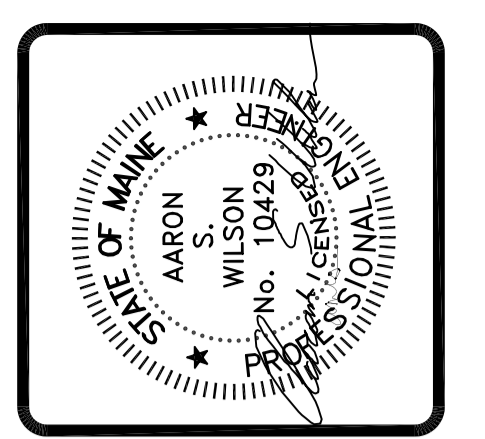

ASSOCIATED DESIGN PARTNERS INC.
Office: (207) 878-1751
80 Leighton Road
Falmouth, Maine 04105
Fax: (207) 878-1788
E-Mail: adp@adengineering.com

THIS DRAWING, DESIGN AND ELECTRONIC FILE ARE THE PROPERTY OF ASSOCIATED DESIGN PARTNERS, INC. THE REPRODUCTION, COPYING OR ANY OTHER USE OF THIS DOCUMENT WITHOUT WRITTEN CONSENT IS PROHIBITED.

PROJECT: **ALLAGASH 2015 EXPANSION**
50 INDUSTRIAL WAY, PORTLAND, MAINE
FOR: ALLAGASH BREWING CO.
SHEET TITLE: **FOUNDATION PLAN**
ISSUED FOR PERMITTING

REVISIONS	DATE	DESCRIPTION
No.	BY	ASW

DATE : 7/25/14
SCALE : 1/8"=1'-0"
DESIGN BY: ASW
DRAWN BY: RSC
FILE #: 14064-S1
PROJECT NUMBER:
14064
SHEET NO:
S1