

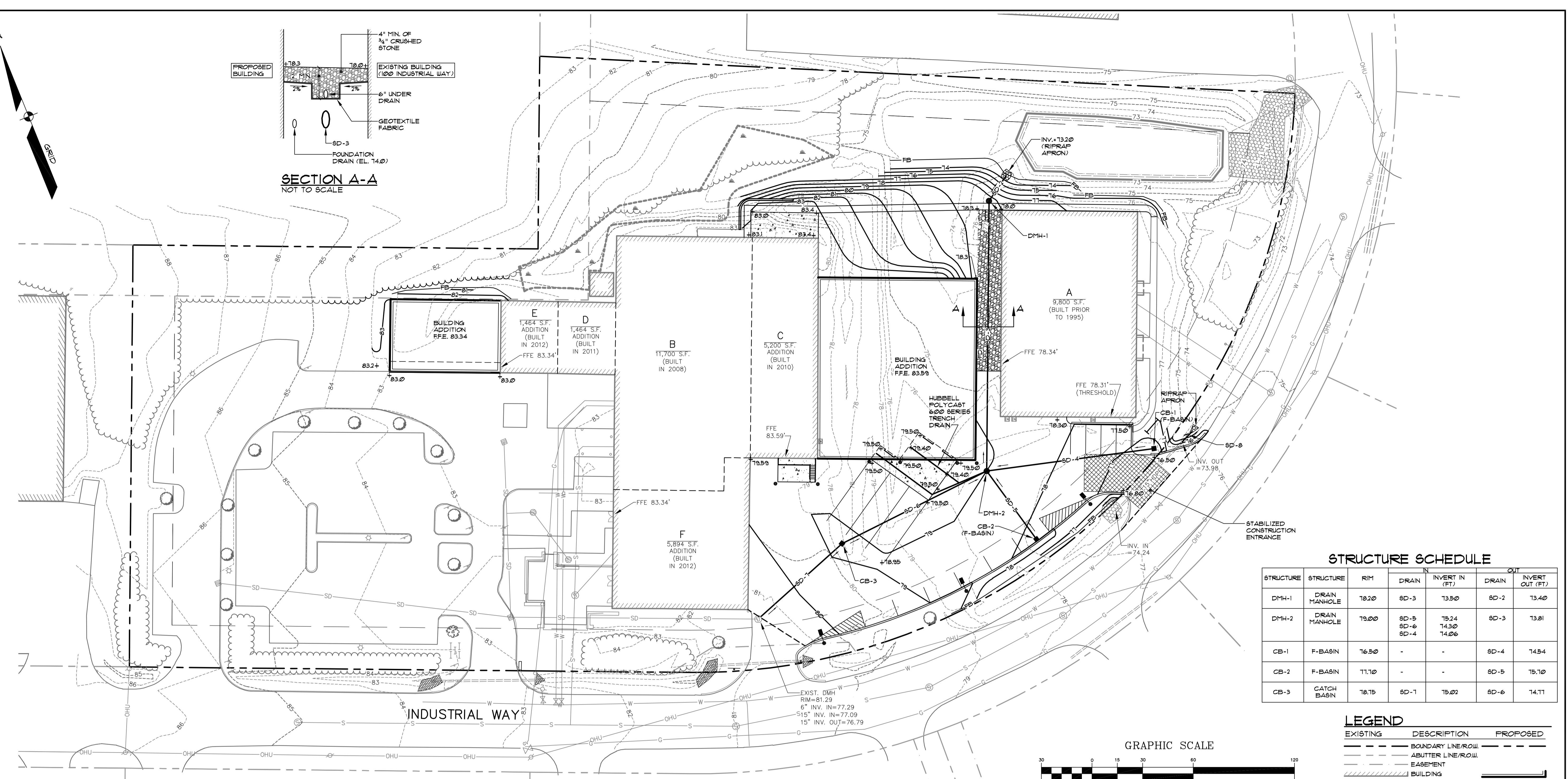

Date: 09/15/14

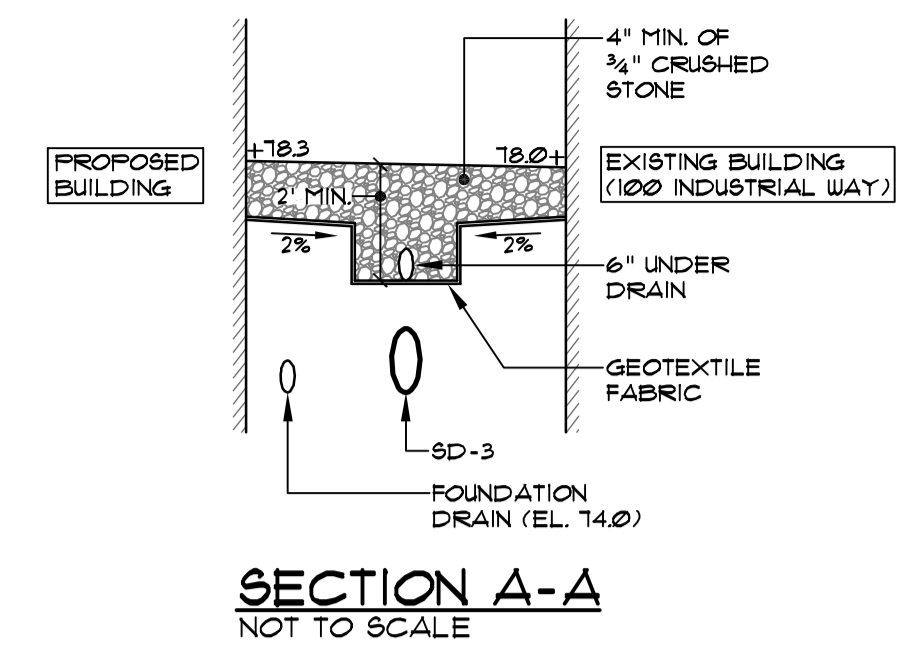
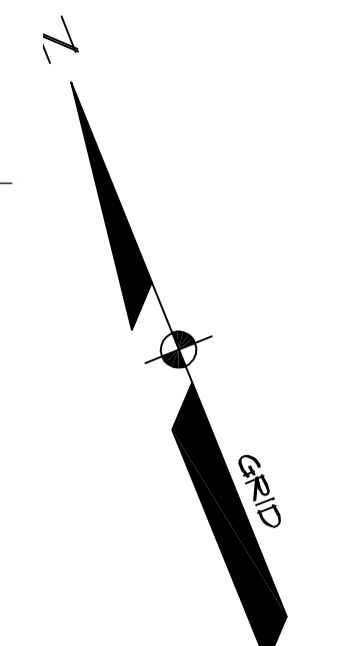

STRUCTURE SCHEDULE

STRUCTURE	STRUCTURE	RIM	DRAIN	INVERT IN (FT)	DRAIN	INVERT OUT (FT)
DMH-1	DRAIN MANHOLE	18.20	8D-3	13.50	8D-2	13.40
DMH-2	DRAIN MANHOLE	19.20	8D-5 8D-6	15.24 14.06	8D-3	13.81
CB-1	F-BASIN	16.50	-	-	8D-4	14.54
CB-2	F-BASIN	11.10	-	-	8D-5	15.10
CB-3	CATCH BASIN	18.15	8D-1	15.02	8D-6	14.11

LEGEND

EXISTING	DESCRIPTION	PROPOSED
---	BOUNDARY LINE/ROW	---
---	ABUTTER LINE/ROW	---
---	EASEMENT	---
---	BUILDING	---
---	WETLANDS	---
---	UPLAND	---
---	EDGE WETLAND SIGN	---
---	EDGE PAVEMENT	---
---	EDGE CONCRETE	---
---	PAVEMENT PAINT	---
---	GRAVEL ROAD	---
---	CURBLINE	---
---	TREELINE	---
---	CONTOURS	---
---	CHAIN LINK FENCE	---
---	DECIDUOUS TREE	---
---	CONIFEROUS TREE	---
---	BOLLARD	---
---	GAS	---
---	GAS GATE VALVE	---
---	GAS METER	---
---	WATER	---
---	WATER GATE VALVE	---
---	WATER SHUT OFF	---
---	HYDRANT	---
---	WATER MANHOLE	---
---	SEWER	---
---	SEWER MH	---
---	STORM DRAIN	---
---	UNDERDRAIN	---
---	CATCH BASIN	---
---	DRAINAGE MH	---
---	CULVERT	---
---	OVERHEAD UTILITY	---
---	UNDERGROUND UTILITY	---
---	TRANSFORMER PAD	---
---	LIGHT POLE/WALL	---
---	UTILITY POLE	---
---	GUY	---
---	RIPRAP	---
---	FILTER BARRIER	---

GRAPHIC SCALE

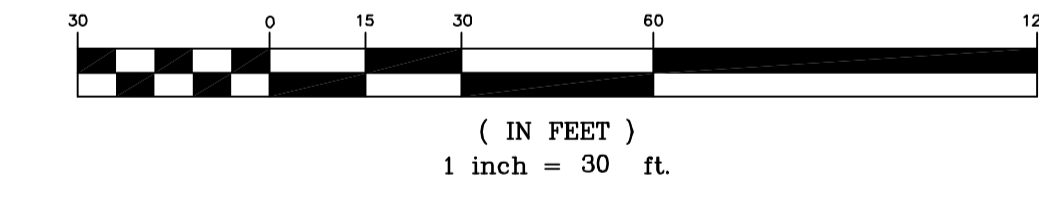

CONSTRUCTION NOTES:

- ALL WORK SHALL CONFORM TO THE APPLICABLE CODES AND ORDINANCES.
- CONTRACTOR SHALL VISIT THE SITE AND FAMILIARIZE HIM OR HERSELF WITH ALL CONDITIONS AFFECTING THE PROPOSED WORK AND SHALL MAKE PROVISIONS AS TO THE COST THEREOF. CONTRACTOR SHALL BE RESPONSIBLE FOR FAMILIARIZING HIM OR HERSELF WITH ALL CONTRACT DOCUMENTS, FIELD CONDITIONS AND DIMENSIONS AND CONFIRMING THAT THE WORK MAY BE ACCOMPLISHED AS SHOWN PRIOR TO PROCEEDING WITH CONSTRUCTION. ANY DISCREPANCIES SHALL BE BROUGHT TO THE ATTENTION OF THE ENGINEER PRIOR TO THE COMMENCEMENT OF WORK.
- CONTRACTOR SHALL NOTIFY ENGINEER OF ALL PRODUCTS OR ITEMS NOTED AS "EXISTING" WHICH ARE NOT FOUND IN THE FIELD.
- INSTALL ALL EQUIPMENT AND MATERIALS IN ACCORDANCE WITH MANUFACTURER'S RECOMMENDATIONS AND OWNER'S REQUIREMENTS UNLESS SPECIFICALLY OTHERWISE INDICATED OR WHERE LOCAL CODES OR REGULATIONS TAKE PRECEDENCE.
- CONTRACTOR SHALL VERIFY ALL DIMENSIONS AND CONDITIONS IN THE FIELD PRIOR TO FABRICATION AND ERECTION OF ANY MATERIAL. ANY UNUSUAL CONDITIONS SHALL BE REPORTED TO THE ATTENTION OF THE ENGINEER.
- CONTRACTOR SHALL CLEAN AND REMOVE DEBRIS AND SEDIMENT DEPOSITED ON PUBLIC STREETS, SIDEWALKS, ADJACENT AREAS, OR OTHER PUBLIC WAYS DUE TO CONSTRUCTION.
- CONTRACTOR SHALL INCORPORATE PROVISIONS AS NECESSARY IN CONSTRUCTION TO PROTECT EXISTING STRUCTURES, PHYSICAL FEATURES, AND MAINTAIN SITE STABILITY DURING CONSTRUCTION. CONTRACTOR SHALL RESTORE ALL AREAS TO ORIGINAL CONDITION AND AS DIRECTED BY DESIGN DRAWINGS.
- SITE CONTRACTOR SHALL OBTAIN ALL REQUIRED PERMITS PRIOR TO CONSTRUCTION.
- ALL EROSION AND SEDIMENT CONTROL MEASURES SHALL BE INSTALLED IN ACCORDANCE WITH "MAINE EROSION AND SEDIMENTATION CONTROL HANDBOOK FOR CONSTRUCTION: BEST MANAGEMENT PRACTICES" PUBLISHED BY THE CUMBERLAND COUNTY SOIL AND WATER CONSERVATION DISTRICT AND MAINE DEPARTMENT OF ENVIRONMENTAL PROTECTION, MARCH 1991 OR LATEST EDITION. IT SHALL BE THE RESPONSIBILITY OF THE CONTRACTOR TO POSSESS A COPY OF THE EROSION CONTROL PLAN AT ALL TIMES.
- THE CONTRACTOR IS HEREBY CAUTIONED THAT ALL SITE FEATURES SHOWN HEREON ARE BASED ON FIELD OBSERVATIONS BY THE SURVEYOR AND BY INFORMATION PROVIDED BY UTILITY COMPANIES. THE INFORMATION IS NOT TO BE RELIED ON AS BEING EXACT OR COMPLETE. THE CONTRACTOR SHALL CONTACT DIG SAFE (1-888-DIGSAFE) AT LEAST THREE (3) BUT NOT MORE THAN THIRTY (30) DAYS PRIOR TO COMMENCEMENT OF EXCAVATION OR DEMOLITION TO VERIFY HORIZONTAL AND VERTICAL LOCATION OF ALL UTILITIES.
- CONTRACTOR SHALL BE AWARE THAT DIG SAFE ONLY NOTIFIES ITS "MEMBER" UTILITIES ABOUT THE DIG. WHEN NOTIFIED, DIG SAFE WILL ADVISE CONTRACTOR OF MEMBER UTILITIES IN THE AREA. CONTRACTOR IS RESPONSIBLE FOR IDENTIFYING AND CONTACTING NON-MEMBER UTILITIES DIRECTLY. NON-MEMBER UTILITIES MAY INCLUDE TOWN OR CITY WATER AND SEWER DISTRICTS AND SHALL LOCAL UTILITIES, AS WELL AS U&G PUBLIC WORKS SYSTEMS.
- CONTRACTORS SHALL BE RESPONSIBLE FOR COMPLIANCE WITH THE REQUIREMENTS OF 23 MRSA 336(0)-A. IT SHALL BE THE RESPONSIBILITY OF THE CONTRACTOR TO COORDINATE WITH THE APPROPRIATE UTILITIES TO OBTAIN AUTHORIZATION PRIOR TO RELOCATION OF ANY EXISTING UTILITIES WHICH CONFLICT WITH THE PROPOSED IMPROVEMENTS SHOWN ON THESE PLANS. IF A UTILITY CONFLICT ARISES, THE CONTRACTOR SHALL IMMEDIATELY NOTIFY THE OWNER, THE MUNICIPALITY AND APPROPRIATE UTILITY COMPANY PRIOR TO PROCEEDING WITH ANY RELOCATION.
- ALL PAVEMENT MARKINGS AND DIRECTIONAL SIGNAGE SHOWN ON THE PLAN SHALL CONFORM TO THE MANUAL OF UNIFORM TRAFFIC CONTROL DEVICES (MUTCD) STANDARDS.
- ALL PAVEMENT JOINTS SHALL BE SAWCUT PRIOR TO PAVING TO PROVIDE A DURABLE AND UNIFORM JOINT.
- NO HOLES, TRENCHES OR STRUCTURES SHALL BE LEFT OPEN OVERNIGHT IN ANY EXCAVATION ACCESSIBLE TO THE PUBLIC OR IN PUBLIC RIGHTS-OF-WAY.
- ALL WORK WITHIN THE PUBLIC RIGHT-OF-WAY SHALL REQUIRE A M.D.O.T. PERMIT AS WELL AS PERMITS FROM THE TOWN AS APPLICABLE.
- IMMEDIATELY UPON COMPLETION OF CUTS/FILLS, THE CONTRACTOR SHALL STABILIZE DISTURBED AREAS IN ACCORDANCE WITH EROSION CONTROL NOTES AND AS SPECIFIED ON PLANS.
- THE CONTRACTOR SHALL BE FULLY AND SOLELY RESPONSIBLE FOR THE REMOVAL, REPLACEMENT AND RECTIFICATION OF ALL DAMAGED AND DEFECTIVE MATERIAL AND WORKMANSHIP IN CONNECTION WITH THE CONTRACT WORK. THE CONTRACTOR SHALL REPLACE OR REPAIR AS DIRECTED BY THE OWNER ALL SUCH DAMAGED OR DEFECTIVE MATERIALS WHICH APPEAR WITHIN A PERIOD OF ONE YEAR FROM THE DATE OF SUBSTANTIAL COMPLETION.
- ALL WORK PERFORMED BY THE GENERAL CONTRACTOR AND/OR TRADE SUBCONTRACTOR SHALL CONFORM TO THE REQUIREMENTS OF LOCAL, STATE OR FEDERAL LAWS, AS WELL AS ANY OTHER GOVERNING REQUIREMENTS, WHETHER OR NOT SPECIFIED ON THE DRAWINGS.
- WHERE THE TERMS "APPROVED EQUAL", "OTHER APPROVED", "EQUAL TO", "ACCEPTABLE" OR OTHER GENERAL QUALIFYING TERMS ARE USED IN THESE NOTES, IT SHALL BE UNDERSTOOD THAT REFERENCE IS MADE TO THE RULING AND JUDGMENT OF SEBAGO TECHNICS, INC.
- THE GENERAL CONTRACTOR SHALL PROVIDE ALL NECESSARY PROTECTION FOR THE WORK UNTIL TURNED OVER TO THE OWNER.
- THE GENERAL CONTRACTOR SHALL MAINTAIN A CURRENT AND COMPLETE SET OF CONSTRUCTION DRAWINGS ON SITE DURING ALL PHASES OF CONSTRUCTION FOR USE OF ALL TRADES.
- THE CONTRACTOR SHALL TAKE FULL RESPONSIBILITY FOR ANY CHANGES AND DEVIATION OF APPROVED PLANS NOT AUTHORIZED BY THE ARCHITECT/ENGINEER AND/OR CLIENT/OWNER.
- DETAILS ARE INTENDED TO SHOW END RESULT OF DESIGN. ANY MODIFICATION TO SUIT FIELD DIMENSION AND CONDITION SHALL BE SUBMITTED TO THE ENGINEER AND THE CITY OF PORTLAND FOR REVIEW AND APPROVAL PRIOR TO ANY WORK.
- BEFORE THE FINAL ACCEPTANCE OF THE PROJECT, THE CONTRACTOR SHALL REMOVE ALL EQUIPMENT AND MATERIALS, REPAIR OR REPLACE PRIVATE OR PUBLIC PROPERTY WHICH MAY HAVE BEEN DAMAGED OR DESTROYED DURING CONSTRUCTION, CLEAN THE AREAS WITHIN AND ADJACENT TO THE PROJECT WHICH HAVE BEEN OBSTRUCTED BY HIS/HER OPERATIONS, AND LEAVE THE PROJECT AREA NEAT AND PRESENTABLE.
- ALL SUBSURFACE UTILITY LINES SHOWN HEREON ARE BASED SOLELY ON THE FIELD LOCATION OF VISIBLE STRUCTURES, SMH'S, CB'S, HYDRANTS, ETC. IN CONJUNCTION WITH DESIGN AND/OR AS-BUILT PLANS SUPPLIED TO SEBAGO TECHNICS INC. BY OTHERS. PRIOR TO ANY CONSTRUCTION, EXCAVATION, TEST BORINGS, DRILLING, ETC. DIG SAFE MUST BE NOTIFIED AND A SITE IDENTIFICATION NUMBER ALONG WITH A SAFE TO DIG DATE OBTAINED. THE SITE CONTRACTOR SHALL BE RESPONSIBLE FOR FIELD VERIFYING THE LOCATION, DEPTH AND MATERIAL OF ALL SUBSURFACE UTILITY LINES SHOWN HEREON AND ANY AND ALL OTHERS LOCATED ON SITE WITHIN THE CONSTRUCTION AREA.
- AN APPROVED SPRINKLER SYSTEM SHALL BE INSTALLED PER NFPA 13 AND MONITORED BY AN APPROVED CENTRAL MONITORING STATION.
- ALL STORM DRAIN PIPES SHALL BE SMOOTH BORE HDPE UNLESS OTHERWISE NOTED.
- ALL TREE SAVE AREAS MUST BE IDENTIFIED IN THE FIELD PRIOR TO SITE WORK.
- PROTECTIVE MEASURES WILL BE REQUIRED IN TREE SAVE AREAS IN ORDER TO PREVENT THE STORAGE OF MATERIALS AND EQUIPMENT.
- IN THE CASE THAT TREE SAVE AREAS ARE AFFECTED DURING CONSTRUCTION, ADDITIONAL TREES/SHRUBS MAY BE NEEDED.

STORM DRAIN SCHEDULE

PIPE ID	LENGTH (FT)	DIAMETER (IN)	SLOPE (FT/FT)	INVERT IN (FT)	INVERT OUT (FT)
8D-2	16	24	0.015	13.40	13.20
8D-3	156	24	0.002	13.81	13.50
8D-4	96	12	0.005	14.54	14.06
8D-5	46	12	0.010	15.10	15.24
8D-6	92	18	0.005	14.11	14.31
8D-1	63	15	0.028	11.10	15.02
8D-8	8	15	0.005	13.98	13.94

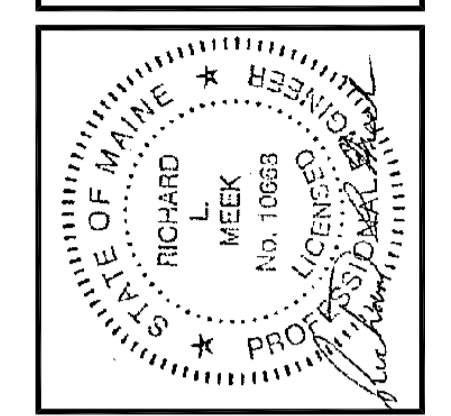

REV.	DATE	BY	STATUS
07-28-14		RLM	REVISED TO ADDRESS CONDITIONS OF APPROVAL
07-11-14		RLM	FINAL SITE PLAN SUBMISSION TO CITY
06-03-14		RLM	SITE PLAN SUBMISSION TO CITY

THIS PLAN SHALL NOT BE MODIFIED WITHOUT WRITTEN PERMISSION FROM SEBAGO TECHNICS, INC. ANY ALTERATIONS, AUTHORIZED OR OTHERWISE, SHALL BE AT THE USER'S SOLE RISK AND WITHOUT LIABILITY TO SEBAGO TECHNICS, INC.

SEBAGO TECHNICS
 WWW.SEBAGOTECHNICS.COM
 75 John Roberts Rd., Suite 1A
 South Portland, ME 04106
 Tel: 207-252-2100

PROJECT NO. 02249
 FIELD BOOK 847
 DESIGN CHDK RLM
 DRAWN MAL

GRADING AND UTILITY PLAN - PHASE 1
 OF:
ALLAGASH BREWING COMPANY
 INDUSTRIAL WAY
 PORTLAND, MAINE
 FOR:
50 INDUSTRIAL WAY, LLC
 50 INDUSTRIAL WAY
 PORTLAND, MAINE 04103

DATE: 05-20-14
 SCALE: 1" = 30'

SHEET C6.1

0224900-1-PHASE1.dwg, TAB: GU-1-PH1