

REPRODUCTION OR MISUSE OF THIS DOCUMENT WITHOUT WRITTEN PERMISSION FROM GRANT HAYS ASSOCIATES IS PROHIBITED.

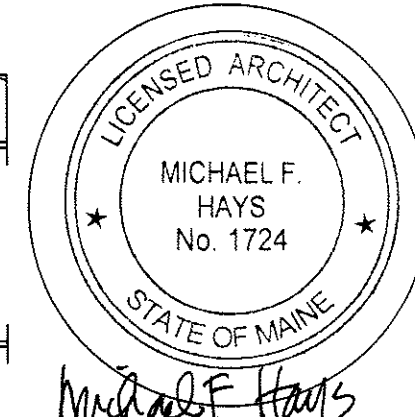

REVISIONS

NEW ADDITION FOR
ALLAGASH BREWING CO.
50 INDUSTRIAL WAY PORTLAND, MAINE

ARCHITECTURE
INTERIOR DESIGN
P.O. BOX 6179 FALMOUTH, MAINE 04105
TEL: (207) 871-5900 FAX: (207) 871-9308

SECOND FLOOR
FACILITY CODE
COMPLIANCE PLAN

SCALE 1/16" = 1'-0"
DATE 7/25/2014
DRAWN BY SAM/MPH
JOB NO. 140560
DRAWING NO. AC-2

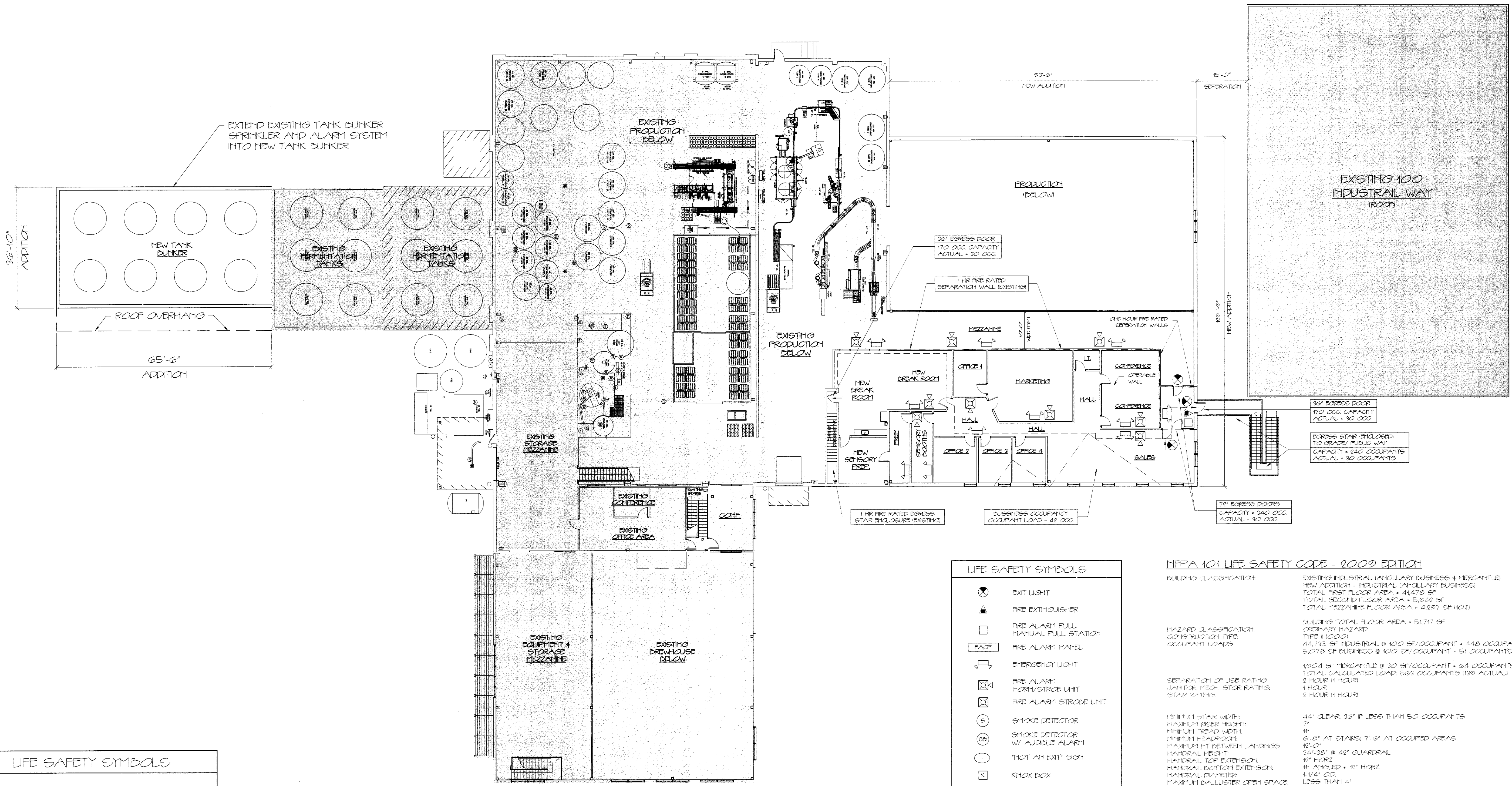

SECOND FLOOR FACILITY CODE COMPLIANCE PLAN
SCALE: 1/16" = 1'-0"

LIFE SAFETY SYMBOLS

	EXIT LIGHT
	FIRE EXTINGUISHER
	FIRE ALARM PULL MANUAL FULL STATION
	FIRE ALARM PANEL
	EMERGENCY LIGHT
	FIRE ALARM HORN/STROBE UNIT
	FIRE ALARM STROBE UNIT
	SMOKE DETECTOR
	ATRIUM PANEL
	"HOT AN EXIT" SIGN
	KNOX BOX
	1 HR. RATED PARTITION
	2 HR. RATED PARTITION

- LIFE SAFETY NOTES**
1. THE NEW BUILDING ADDITION SHALL HAVE AN NFPA 13 FIRE SUPPRESSION SPRINKLER SYSTEM INSTALLED. SPRINKLER SYSTEM SHALL BE INSTALLED BY A CERTIFIED SPRINKLER CONTRACTOR AND SHALL BE REVIEWED AND APPROVED BY THE STATE OF MAINE FIRE MARSHAL AS WELL AS THE LOCAL AUTHORITY HAVING JURISDICTION. THE CONTRACTOR SHALL BEAR SOLE RESPONSIBILITY FOR THE DESIGN AND INSTALLATION OF THE SYSTEM FOR OCCUPANCY.
 2. THE SPRINKLER CONTRACTOR SHALL VERIFY THE EXISTING BUILDING SPRINKLER/FIRE ALARM SYSTEM HAS SUFFICIENT CAPACITY FOR EXTENDING INTO THE NEW BUILDING ADDITION.
 3. THE CLOSEST FIRE HYDRANT TO THE BUILDING HAS A STATIC PRESSURE OF 80 PSI AND A FLOW OF 2,348 GPM.
 4. EXTEND THE EXISTING FIRE ALARM SYSTEM INTO THE NEW ADDITION AS REQUIRED FOR COMPLIANCE WITH NFPA 101 LIFE SAFETY CODE. COORDINATE WITH SPRINKLER SYSTEM MODIFICATION VERIFY LOCATION OF ALARM AND NOTIFICATION PANELS WITH THE AUTHORITY HAVING JURISDICTION.
 5. SEE SHEET A-15 - ACCESSIBILITY DETAILS FOR MOUNTING HEIGHTS OF LIFE SAFETY DEVICES.

LIFE SAFETY SYMBOLS

	EXIT LIGHT
	FIRE EXTINGUISHER
	FIRE ALARM PULL MANUAL FULL STATION
	FIRE ALARM PANEL
	EMERGENCY LIGHT
	FIRE ALARM HORN/STROBE UNIT
	FIRE ALARM STROBE UNIT
	SMOKE DETECTOR
	SMOKE DETECTOR W/ AUDIBLE ALARM
	"HOT AN EXIT" SIGN
	KNOX BOX
	1 HR. RATED PARTITION
	2 HR. RATED PARTITION

NFPA 101 LIFE SAFETY CODE - 2009 EDITION

BUILDING CLASSIFICATION: EXISTING INDUSTRIAL (UNCLASSIFIED BUSINESS & MERCHANTILE)
NEW ADDITION - INDUSTRIAL (UNCLASSIFIED BUSINESS)
TOTAL FIRST FLOOR AREA = 4,478 SF
TOTAL SECOND FLOOR AREA = 5,942 SF
TOTAL MEZZANINE FLOOR AREA = 4,297 SF (10.1)

HAZARD CLASSIFICATION: BUILDING TOTAL FLOOR AREA = 5,177 SF
ORDINARY HAZARD

CONSTRUCTION TYPE: TYPE II (20.0)

OCCUPANT LOADS: 44,735 SF INDUSTRIAL @ 100 SF/OCCUPANT = 448 OCCUPANTS (40 ACTUAL)
5,078 SF BUSINESS @ 100 SF/OCCUPANT = 51 OCCUPANTS (35 ACTUAL)
18,04 SF MERCHANTILE @ 30 SF/OCCUPANT = 64 OCCUPANTS
TOTAL CALCULATED LOAD: 563 OCCUPANTS (539 ACTUAL)

SEPARATION OF USE RATINGS: JANITOR, MECH. STOR. RATINGS: 1 HOUR
STAIR RATINGS: 2 HOUR (1 HOUR)

MINIMUM STAIR WIDTH: 44" CLEAR, 36" IF LESS THAN 50 OCCUPANTS
7"

MINIMUM RISE HEIGHT: 7"

MINIMUM TREAD WIDTH: 11"

MINIMUM HEADROOM: 6'-8" AT STAIRS, 7'-6" AT OCCUPIED AREAS

MAXIMUM HT BETWEEN LANDINGS: 12'-0"

HANDRAIL HEIGHT: 34"-38" @ 42" GUARDRAIL

HANDRAIL TOP EXTENSION: 12" HORIZ

HANDRAIL BOTTOM EXTENSION: 1" ANGLED @ 12" HORIZ

HANDRAIL DIAMETER: 1 1/4" OD

MAXIMUM BALLUSTER OPEN SPACE: LESS THAN 4"

BUILDING USES: INDUSTRIAL BUSINESS

"X" DENOTES IF BUILDING IS FULLY SPRINKLED

	INDUSTRIAL	BUSINESS
MAX. ALLOWABLE TRAVEL DISTANCE	200' (250')	200' (300') / 150' (250')
MAX. ALLOWABLE COMMON PATH	50' (100')	75' (100')
MAX. DEAD END CORRIDOR WIDTH	50'	60' (50')
MINIMUM CORRIDOR WIDTH	44"/36" IF 50 OCC	44"/36" IF 50 OCC
MINIMUM NUMBER OF REQUIRED EXITS	2	2 (1 IF LESS THAN 100 OCCUPANTS AND LESS THAN 100' TRAVEL DISTANCE TO BUSINESS FLOOR LEVEL EXIT)
MINIMUM HORIZ. ENCLOSURE RATING	1 HR. INCH	1 HR. INCH
MINIMUM SEPARATION OF EXITS	0.5 DIAGONAL (0.33) ALLOWED (1A)	SAME ALLOWED (1A)
FIRE ESCAPES AS MEANS OF EGRESS	36"	36"
MINIMUM EGRESS DOOR WIDTH		
EXIT LIGHTING	REQUIRED	REQUIRED
EMERGENCY LIGHTING	REQUIRED	REQUIRED
FIRE ALARM SYSTEM	REQUIRED	REQUIRED
FIRE SPRINKLER SYSTEM	NOT REQUIRED	NOT REQUIRED
PORTABLE FIRE EXTINGUISHERS	REQUIRED	REQUIRED
EXIT DEVICE/PANIC HARDWARE	REQUIRED	REQUIRED

QTY. OF PORTLAND COMPLIANCE: NFPA 14 IFD TECHNICAL STANDARDS

MUDEC (MAINE UNIFORM BUILDING ENERGY CODE) MINIMUM INSULATION VALUES
PER 2009 REG. TABLE 502.12, 502.2(1) AND 502.3

ZONE 6A	R-VALUE	U-FACTOR	SHGC
EXTERIOR WALL	10.5	0.054	NA
ROOF (ABOVE DECK)	20.0	0.048	NA
SLAB (24" BAND)	15.0	0.052	NA
FRONT WALL	7.5	0.133	NA
DOORS - OPAQUE	2.0	0.50	NA
DOORS - GLAZED	1.05	0.80	NR
WINDOWS	2.0	0.35	NR
STOREFRONT	2.2	0.45	NR