

REPRODUCTION OR TRANSMISSION OF THIS DOCUMENT WITHOUT THE WRITTEN PERMISSION OF GRANT HAYS ASSOCIATES IS PROHIBITED.

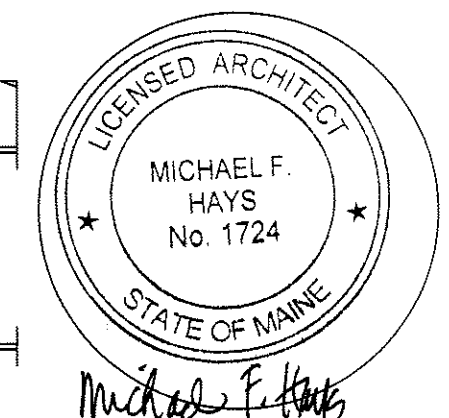

REVISIONS

--	--

NEW ADDITION FOR
ALLAGASH BREWING CO.
 50 INDUSTRIAL WAY PORTLAND, MAINE

GRANT HAYS ASSOCIATES
 ARCHITECTURE
 INTERIOR DESIGN
 P.O. BOX 6179 FALMOUTH, MAINE 04105
 (207) 871-5900
 (207) 871-9308

SECOND FLOOR/
 MEZZANINE PLAN
 DRAWING TITLE

SCALE 1/8" = 1'-0"
 DATE 7/25/2014
 DRAWN BY SAM/MPH
 JOB NO. 140560
 DRAWING NO. **A-2**

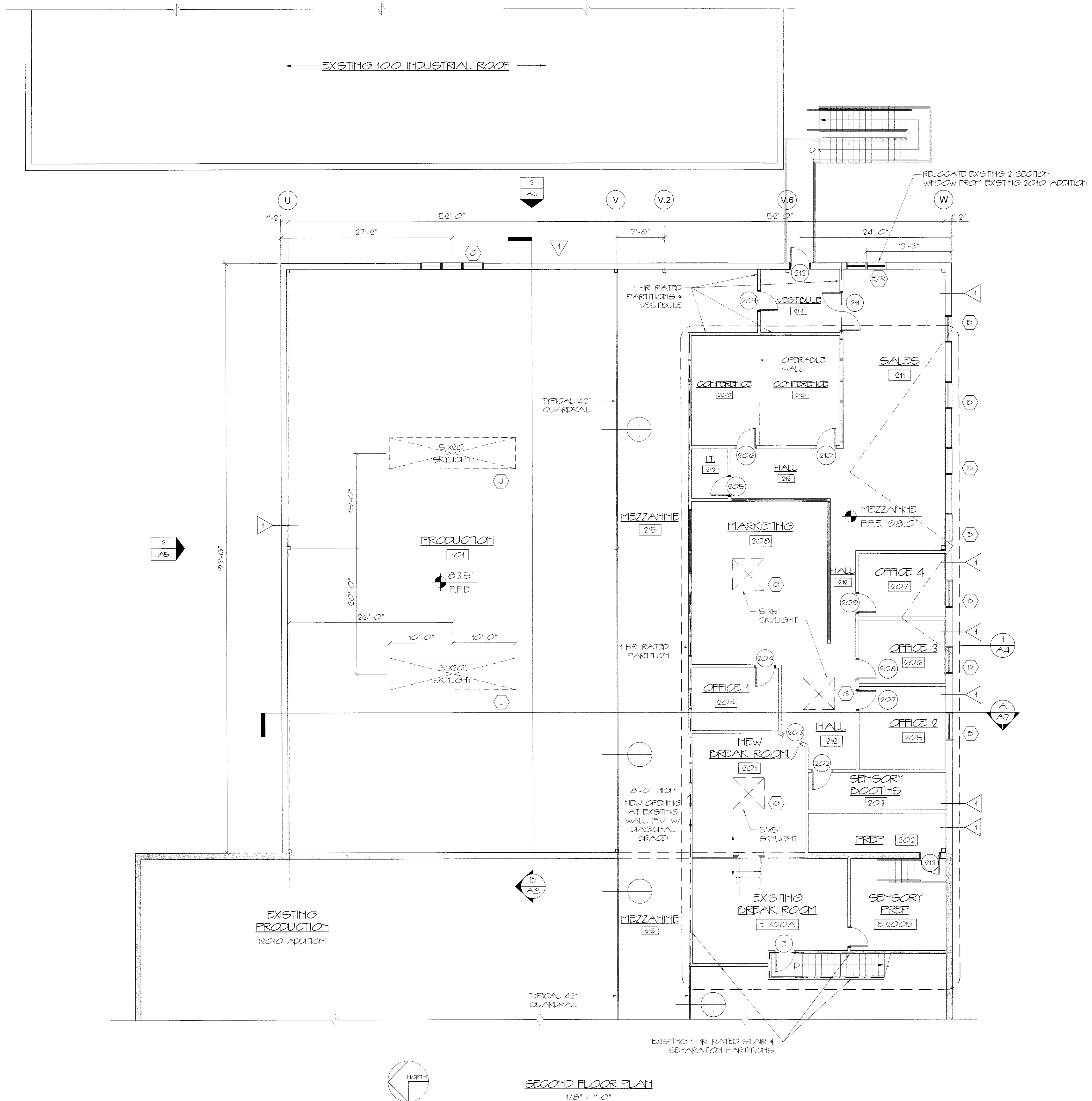

PARTITION LEGEND

KEY	DETAIL
	EXISTING
	1 A-10
	2 A-10
	3 A-10
	4 A-10
	5 A-10
	6 A-10
	7 A-10
	8 A-10

	EXISTING PARTITIONS
	NEW PARTITIONS
	DEMOLITION WALLS

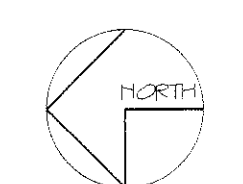

SECOND FLOOR PLAN
 1/8" = 1'-0"