

Michael F. Hays
REVISIONS

NEW ADDITION FOR
ALLAGASH BREWING CO.
50 INDUSTRIAL WAY PORTLAND, MAINE

GRANT HAYS ASSOCIATES
ARCHITECTURE
INTERIOR DESIGN
P.O. BOX 6179 FALMOUTH, MAINE 04105
(207) 871-5900
(207) 871-9308

FIRST FLOOR PLAN
DRAWING TITLE

SCALE 1/8"=1'-0"
DATE 7/25/2014
DRAWN BY SAM/MFH
JOB NO. 140560
DRAWING NO. **A-1**

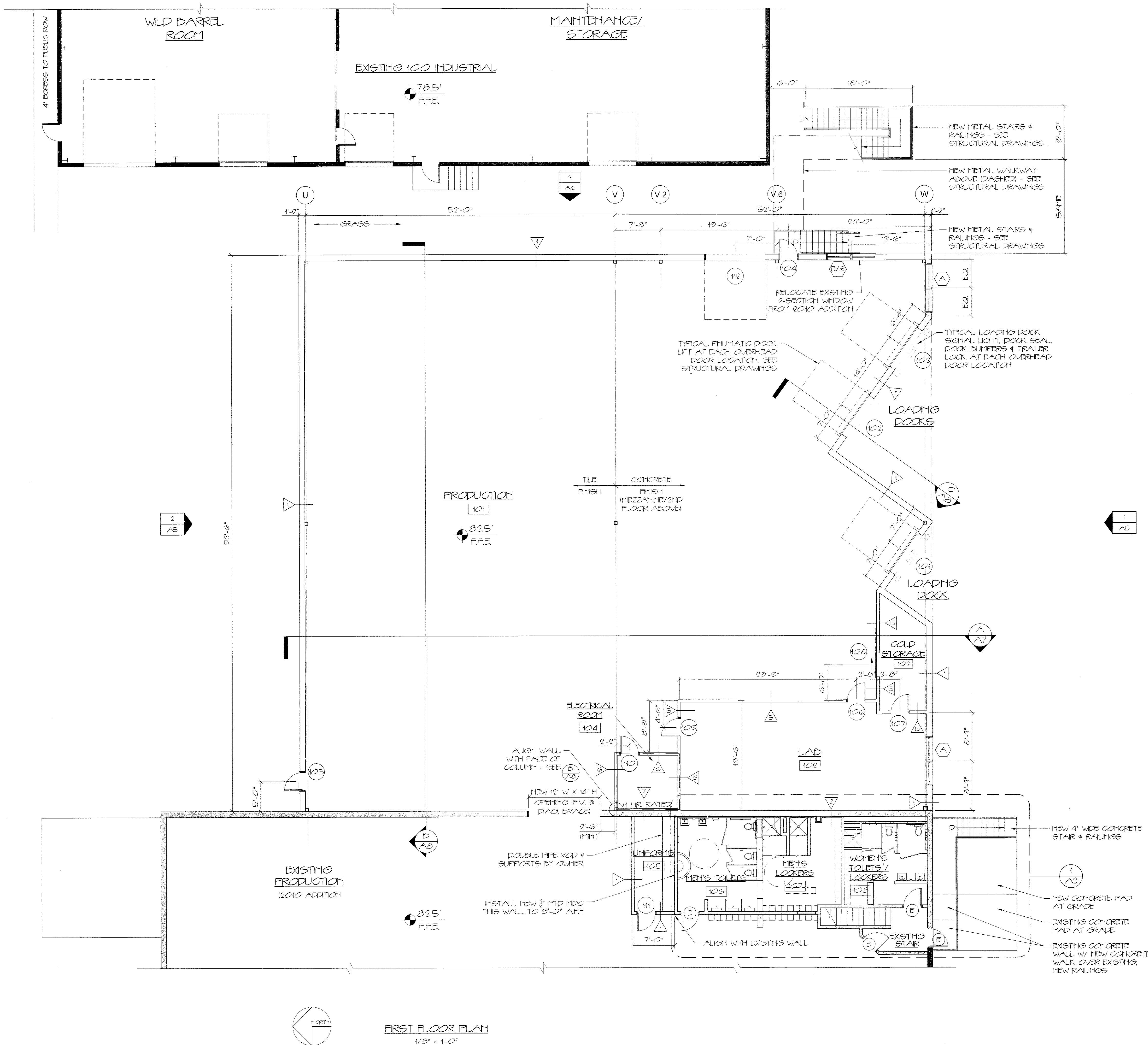

PARTITION LEGEND

KEY	DETAIL
	EXISTING
	1 A-10
	2 A-10
	3 A-10
	4 A-10
	5 A-10
	6 A-10
	7 A-10
	8 A-10

	EXISTING PARTITIONS
	NEW PARTITIONS
	DEMOLITION WALLS

FIRST FLOOR PLAN
1/8" = 1'-0"