

ASSOCIATED DESIGN PARTNERS INC.
 80 Leighton Road Ste A
 Falmouth, Maine 04105
 Office: (207) 878-1751
 Fax: (207) 878-1788
 E-Mail: adp@adpengineering.com

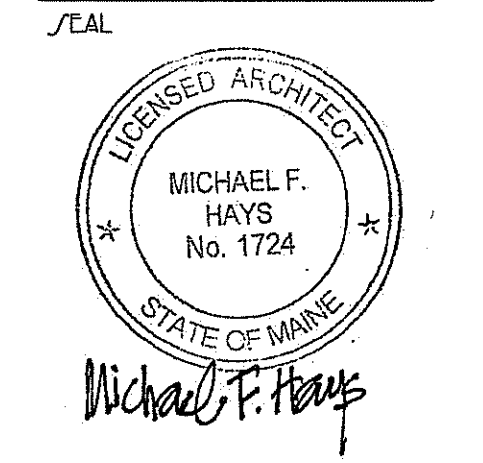

GRANT HAYS ASSOCIATES
 ARCHITECTURE & INTERIOR DESIGN
 P.O. BOX 6179 FALMOUTH MAINE, 04105
 207.871.9900 www.granthays.com

THIS P.E. REVIEW COVERS STRUCTURAL FRAMING MEMBERS SIZES FOR NEW FRAMING ELEMENTS (BEAMS, JOISTS, CONCRETE PIERS, LIMITED CONNECTIONS) DEPICTED ON THIS PLAN ONLY. UNLESS OTHERWISE NOTED, DESIGN AND DETAIL FOR COMPONENTS AND CLADDING, FINISHES, FLOOR PLAN LAYOUT, AND LIFE SAFETY CODE REQUIREMENTS HAVE NOT BEEN REVIEWED AND ARE BEYOND THE PURVIEW OF THIS P.E. SEAL. USE OF THESE DRAWINGS INDICATES OWNER/CONTRACTOR AGREEMENT TO THESE TERMS. THE BUILDING CONTRACTOR IS RESPONSIBLE TO ENSURE ALL ASPECTS OF THE BUILDING ARE CONSTRUCTED IN ACCORDANCE WITH THE IBC 2009 BUILDING CODE.



REVISIONS
 DRAWING NAME

NEW EXTERIOR DECK AT
ALLAGASH BREWING COMPANY
 50 INDUSTRIAL WAY PORTLAND, MAINE 04103
 CBL: 326 B 008001

DATE: 7 MAR 2017
 SCALE: 1/4" = 1'-0"
 DRAWN: MFH/mgk
 JOB NO.: 170301

AS-1
 COPYRIGHT REPRODUCTION OR REVUE OF THIS DOCUMENT WITHOUT WRITTEN PERMISSION FROM GRANT HAYS ASSOCIATES IS PROHIBITED.

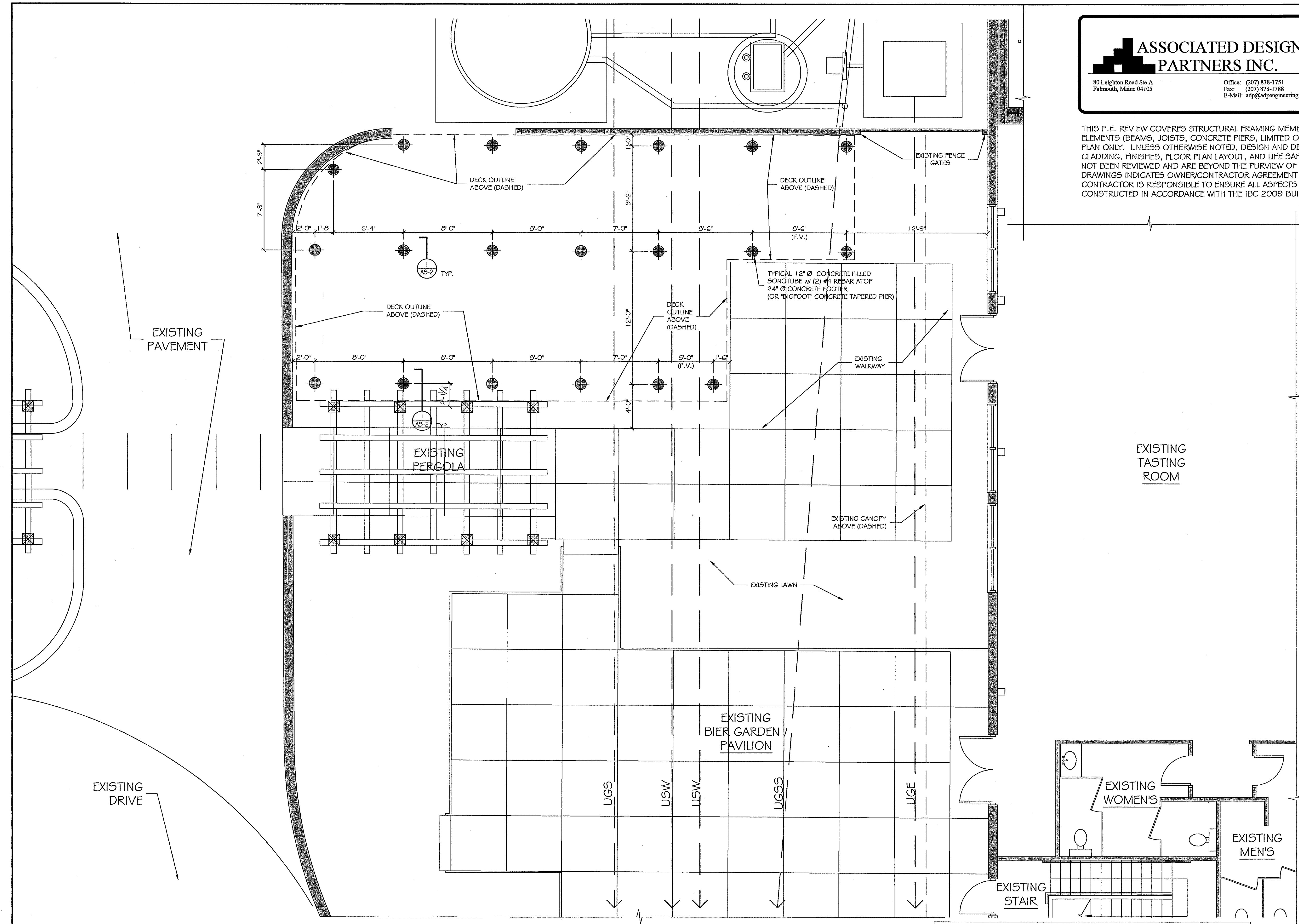

NEW DECK FOOTING PLAN
 SCALE: 1/4" = 1'-0"

EXISTING UTILITY LEGEND

UGE	— — — —	UNDERGROUND ELECTRICAL
UGS5	— — — —	UNDERGROUND SANITARY SEWER
USW	— — — —	UNDERGROUND WATER (DOMESTIC & SPRINKLER)
UGS	— — — —	UNDERGROUND STEAM