

GRANT HAYS
ASSOCIATES

ARCHITECTURE & INTERIOR DESIGN
P.O. BOX 6179 FALMOUTH MAINE 04105
207.871.5900 www.granthays.com



REVISIONS

NEW EXTERIOR DECK AT ALLAGASH BREWING COMPANY

50 INDUSTRIAL WAY



PORTLAND, MAINE 04103

DRAWING NAME

NEW EXTERIOR DECK AT
ALLAGASH
BREWING COMPANY
50 INDUSTRIAL WAY
PORTLAND, MAINE 04103
CBL: 326 B 006001

SITE PLAN

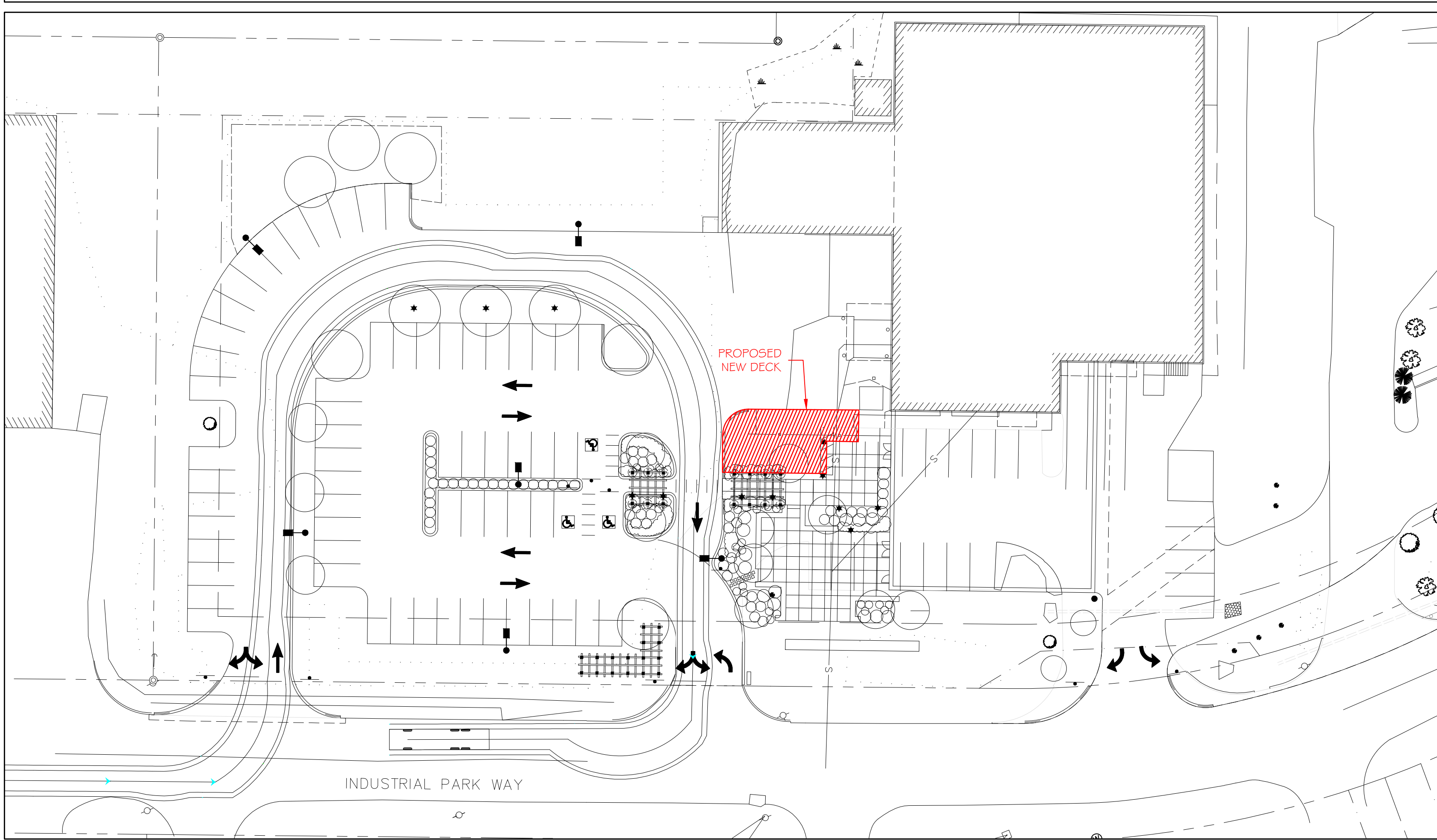

MATERIALS

- CONCRETE
- CONCRETE MASONRY UNIT
- BRICK
- GRAVEL
- SOIL
- STUD PARTITION (EXISTING)
- STEEL
- WOOD FRAMING
- WOOD BLOCKING
- PLYWOOD
- GYPSUM BOARD
- SUSPENDED ACOUSTICAL TILE
- BATT INSULATION
- RIGID INSULATION
- FINISH WOOD
- ONE HOUR RATED PARTITION
- TWO HOUR RATED PARTITION
- EXISTING PARTITION (SCREENED)
- NEW PARTITION

SYMBOLS

- ROOM NUMBER
- DOOR NUMBER
- WINDOW NUMBER
- BUILDING SECTION
- WALL SECTION
- DETAIL SECTION
- CASEWORK ELEVATION
- INTERIOR ELEVATION
- VERTICAL ELEVATION
- PARTITION TYPE
- STRUCTURAL CENTERLINE

DRAWING INDEX

- A-0 COVER SHEET
- AS-1 NEW DECK FOOTING PLAN
- AS-2 NEW DECK FRAMING PLAN & DETAILS

PROJECT TEAM

STRUCTURAL ENGINEER
ASSOCIATED DESIGN PARTNERS, INC.
80 LEIGHTON ROAD #A
FALMOUTH, MAINE 04105
207.878.1751

ALLAGASH PROJECT #17010

CONSTRUCTION
PERMIT SET

SHEET

COVER
SHEET

DATE: 6 MAR 2017
SCALE: NO SCALE
DRAWN: MFH/mgk
JOB NO.: 170301

A-0

COPYRIGHT
REPRODUCTION OR REVISE OF THIS
DOCUMENT WITHOUT WRITTEN
PERMISSION FROM GRANT HAYS
ASSOCIATES IS PROHIBITED.