

**ASSOCIATED DESIGN PARTNERS INC.**  
 Office: (207) 878-1751  
 80 Leighton Road, Falmouth, Maine 04105  
 Fax: (207) 878-1788  
 E-Mail: cdp@adpengineering.com

THIS DRAWING, DESIGN AND ELECTRONIC FILE ARE THE PROPERTY OF ASSOCIATED DESIGN PARTNERS, INC. THE REPRODUCTION, COPYING OR ANY OTHER USE OF THIS DOCUMENT WITHOUT WRITTEN CONSENT IS PROHIBITED.

PROJECT: **ALLAGASH BREWERY, MSE 50 INDUSTRIAL WAY, PORTLAND, MAINE**  
 SHEET TITLE: **KEYSTONE WALL ELEVATION & PARTIAL SITE PLAN**

NO.	BY	DESCRIPTION	DATE

DATE : 8-13-15  
 SCALE : AS NOTED  
 DESIGN BY: ASW  
 DRAWN BY: RSC  
 FILE #: 15256-RT.DWG  
 PROJECT NUMBER:  
**15256**  
 SHEET NO:  
**RT2**

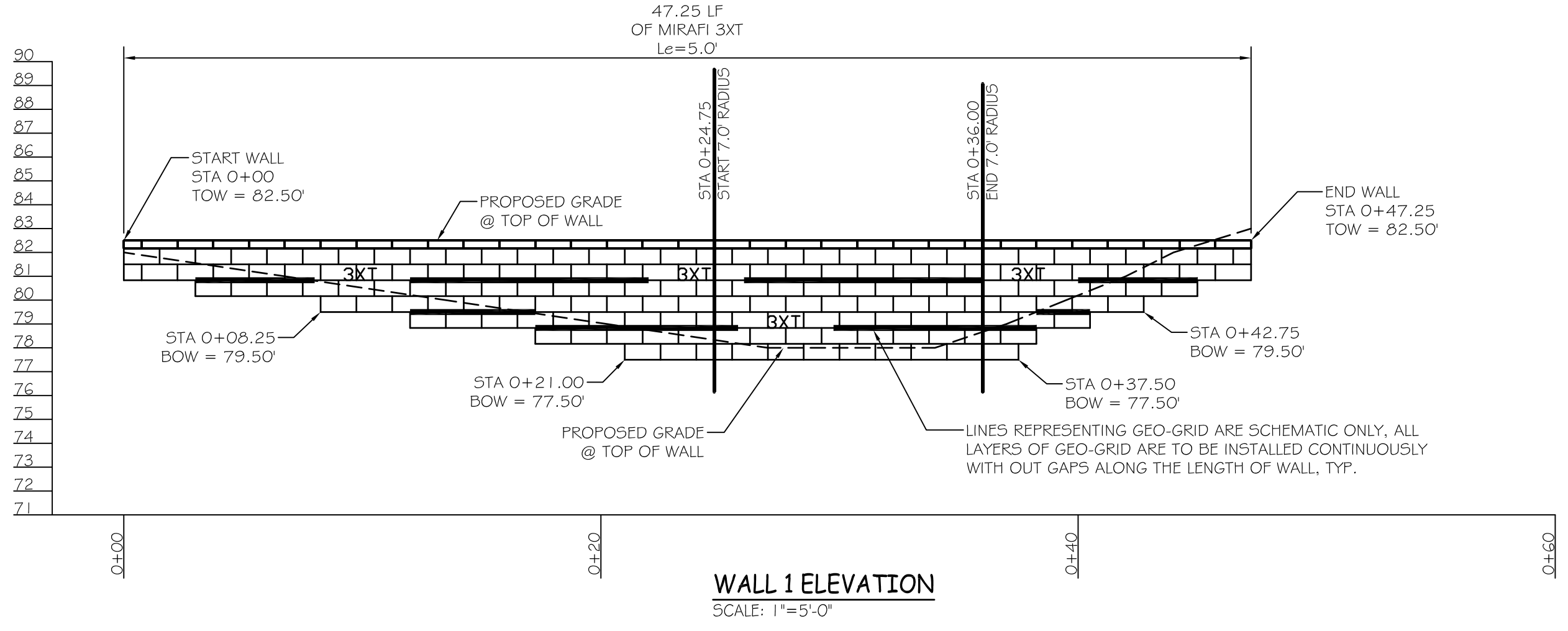

**WALL TOTALS**

32 - 4" CAPS
158 - COMPAC UNITS
40 - SY OF MIRAFI 3XT

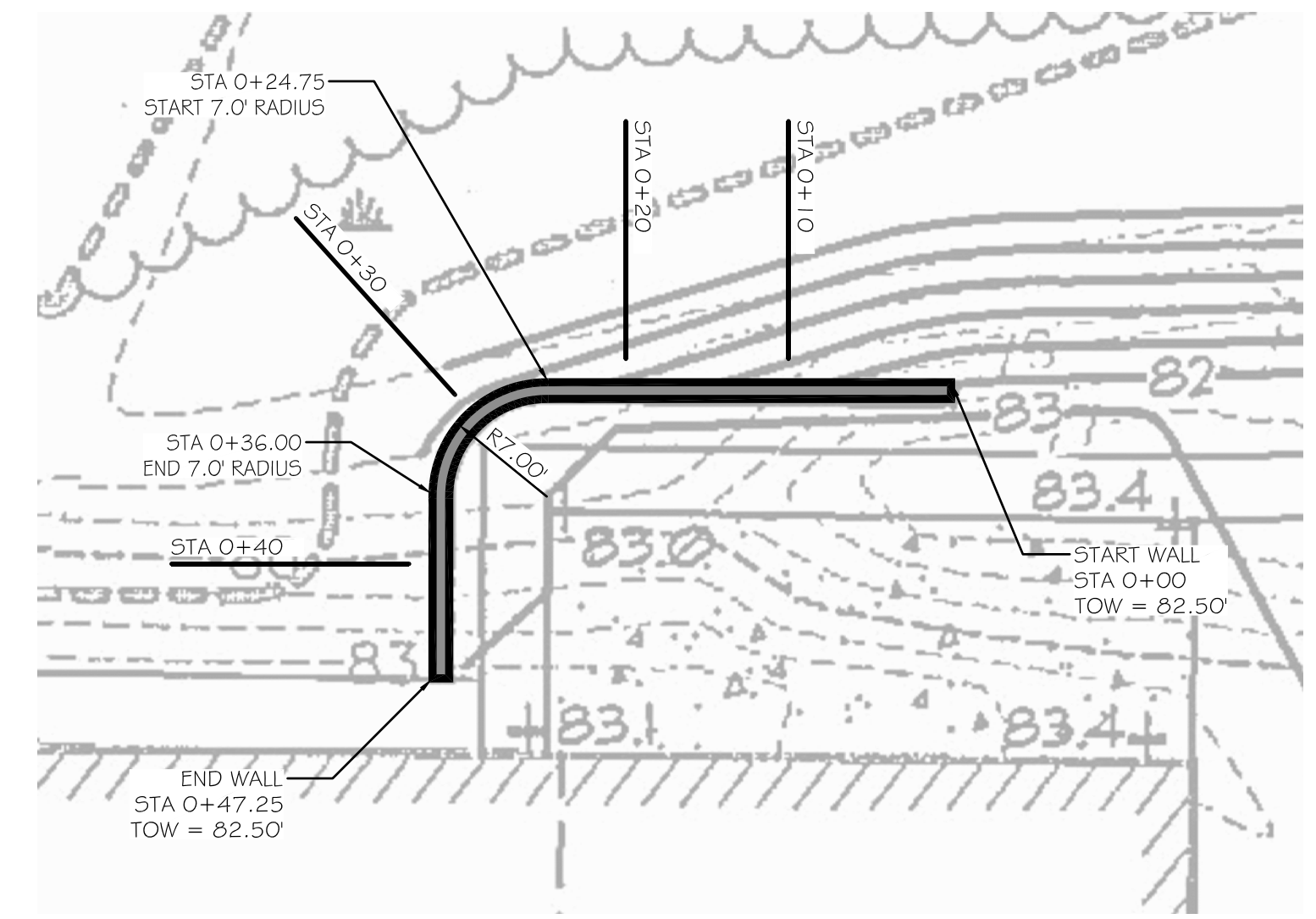

SITE PLAN GENERATED FROM DIGITAL FILE. SCALE IS APPROXIMATE AND USER IS CAUTIONED AGAINST SCALING ITEMS FROM PLAN.

PARTIAL SITE PLAN EXTRACTED FROM SEBAGO TECHNICS, GRADING AND UTILITY PLAN - PHASE I, SHEET C6.1, DATED 7-11-14. PLAN ASSUMED TO BE MOST CURRENT. ADP DOES NOT WARRANT, GUARANTEE, OR REPRESENT IN ANY WAY THAT THIS SITE PLAN, PREPARED AND PROVIDED BY OTHERS, IS CORRECT OR ACCURATE. CONTRACTOR SHALL FIELD VERIFY EXISTING GRADES AND CONDITIONS SHOWN ON THIS PLAN PRIOR TO START OF CONSTRUCTION. CONTACT ASSOCIATED DESIGN PARTNERS, INC. IF DISCREPANCIES ARE ENCOUNTERED.