

Demolition Notes

- 1 Remove existing door, frame and blocking. Prep opening for infill wall.
- 2 Remove existing door or window.
- 3 Remove existing wall.
- 4 Remove existing flooring, backing and accessories.
- 5 Remove existing plumbing fixture.
- 7 Remove existing lighting fixtures from ceiling.
- 8 Remove existing closet rods and shelving.
- 9 Remove existing lavatory and toilet cap all water lines, waste lines and floor drain at floor level.
- 10 Remove countertops, cupboards and cabinets.

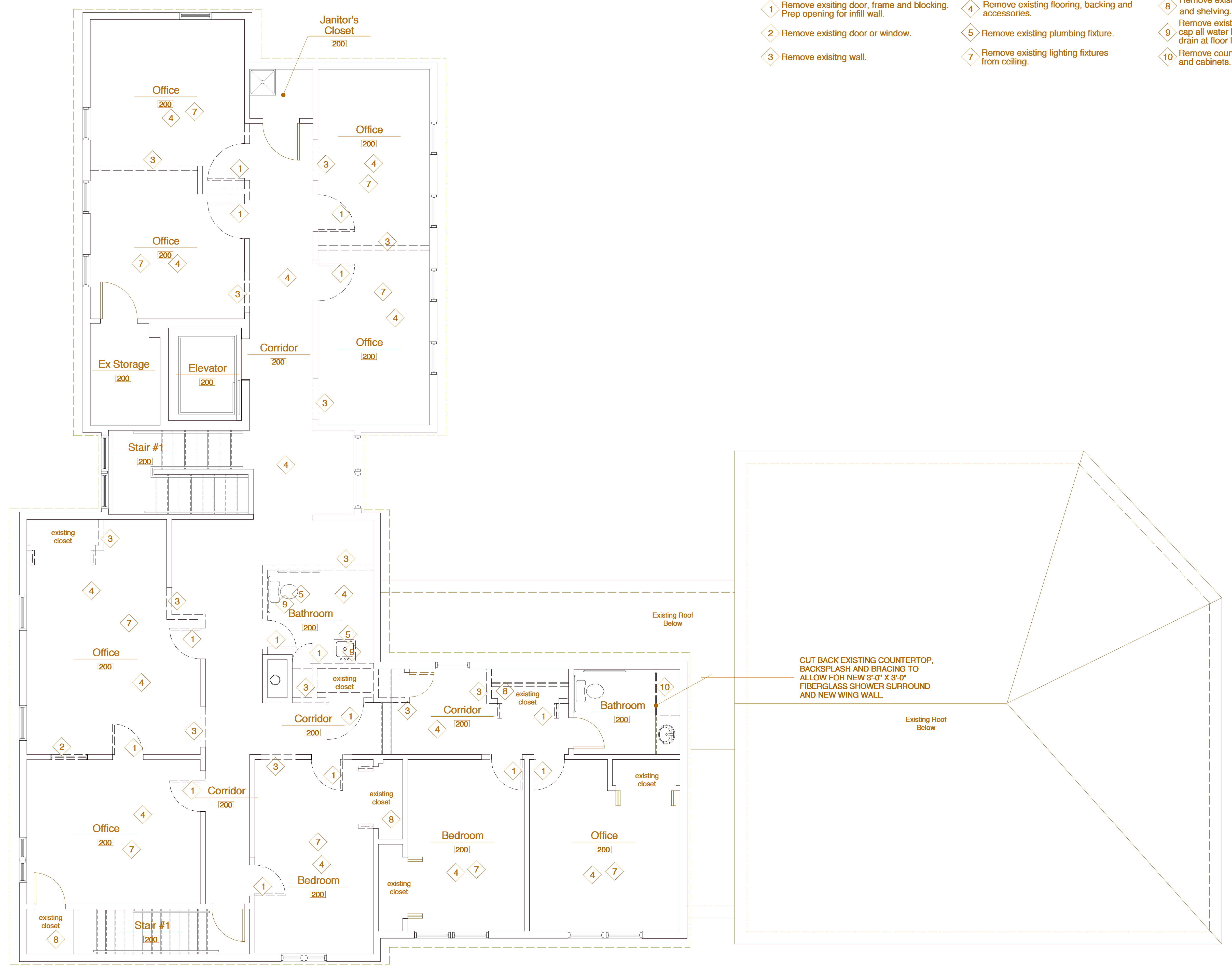

10 Second Floor Demolition Plan
0 4 12 24

| date | revision |
|------|----------|
| none | NONE |

project name
Spurwink Services Kaufman House Renovation

project location
899 Riverside Street
Portland, Maine

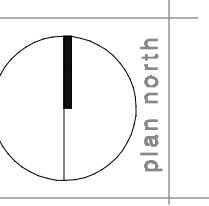

| | |
|------------------------------|----------------|
| March 2, 2015 | date |
| 1/4" = 1'-0" | scale |
| 2014-011 | project # |
| Second Floor Demolition Plan | drawing title |
| D102 | drawing number |