

date	Revision
08/15/2016	Issued for Building Permit

project name **Spurwink Services**
project location **Smith House Renovation**
899 Riverside St
Portland, Maine
45°17'58.77N 70°12'03.40"

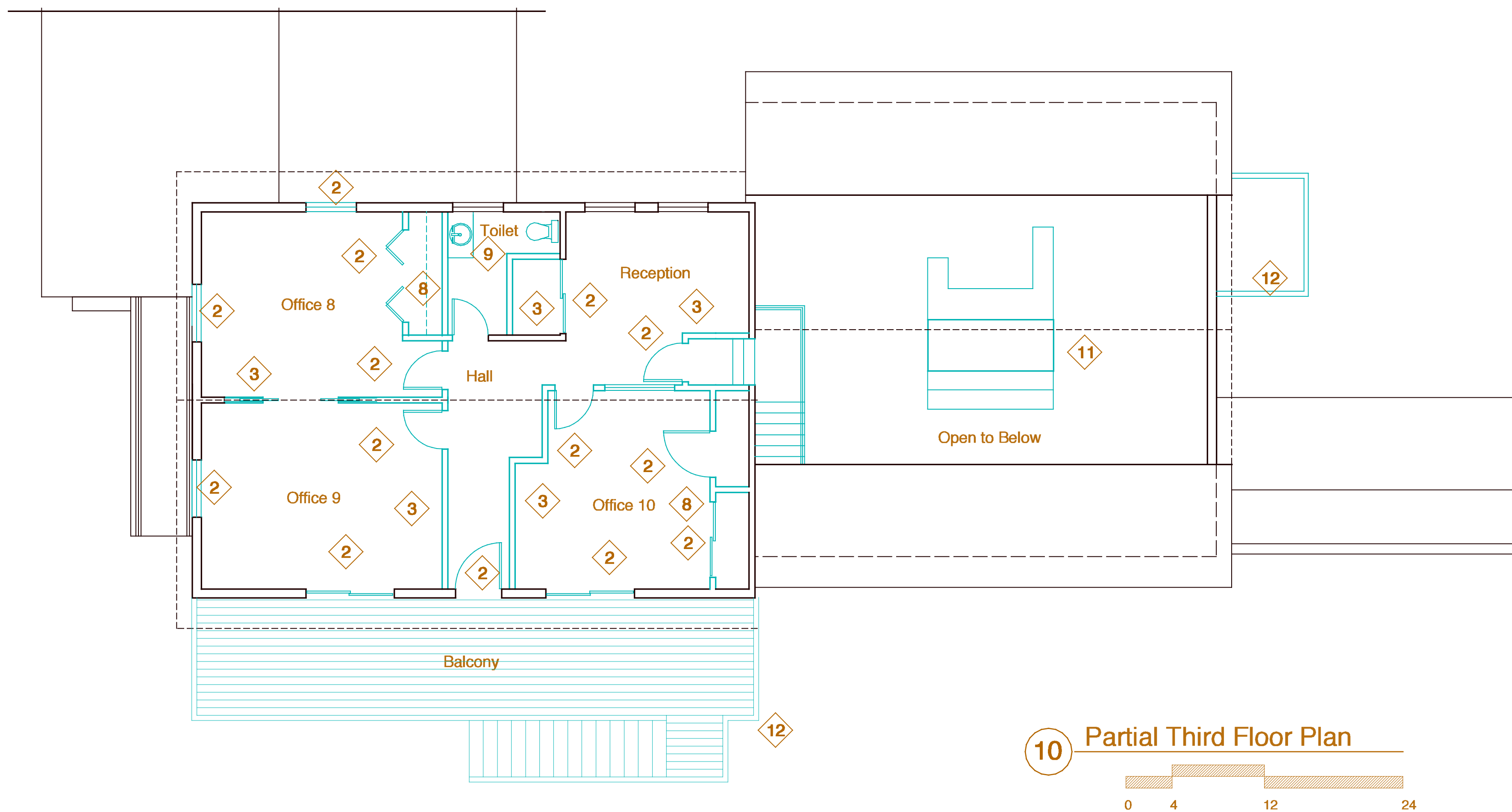

date August 15, 2016
scale 1/8" = 1'-0"
project # 2016-006
drawing title **Exist. Third Floor and Demo Plan**
drawing number **D101**

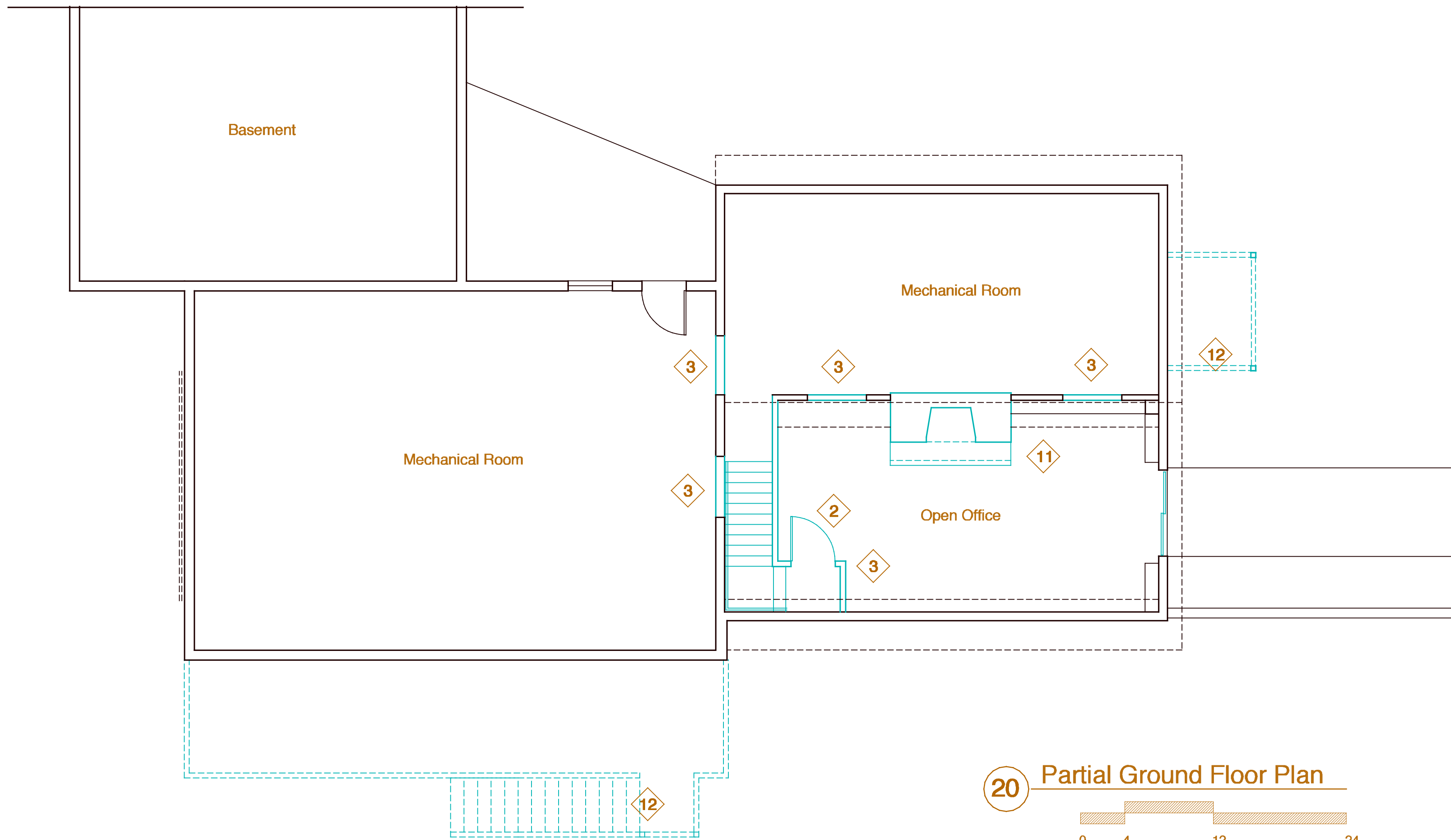

Demolition Notes

- 1 Remove existing door, frame and blocking. Prep opening for infill wall.
- 2 Remove existing door or window.
- 3 Remove existing wall.
- 4 Remove existing flooring, backing and accessories.
- 5 Remove existing plumbing fixture.
- 6 Remove existing retractable room partition.
- 7 Remove existing lighting fixtures from ceiling.
- 8 Remove existing closet rods and shelving.
- 9 Remove existing lavatory and toilet cap all water lines, waste lines and floor drain at floor level.
- 10 Remove countertops, cupboards and cabinets.
- 11 Remove existing masonry chimney, fireplace, hearth.
- 12 Remove existing deck framing, columns and all supporting structural steel

Partition Legend

- Existing Partitions to Remain
- Existing Partitions and components to be demolished