

- GENERAL NOTES:
1. All work shall be in conformance with City of Portland and other utility companies standards.
  2. Contractor shall verify locations of existing utilities with appropriate utility companies prior to start of construction.
  3. Contractor shall secure all necessary permits for work shown on these plans.
  4. All work shall comply with all local, State and Federal safety regulations.
  5. Contractor shall coordinate work with respective utility companies in a timely fashion.
  6. Service leads shall be installed for each lot as shown on plan or directed by owner in the field. Locations shall be well marked for future reference.
  7. The contractor shall be solely responsible for all means, methods and techniques employed to perform the work shown on these plans.
  8. No blasting will be allowed within the utility company easement without the notification and approval of the appropriate utility.

SEE SHEET 8 OF 10 FOR NOTE ON NOTICE, SAFETY AND TRAFFIC CONTROL  
SEE SHEET 6 OF 10 FOR RIVERSIDE STREET ROADWAY IMPROVEMENTS

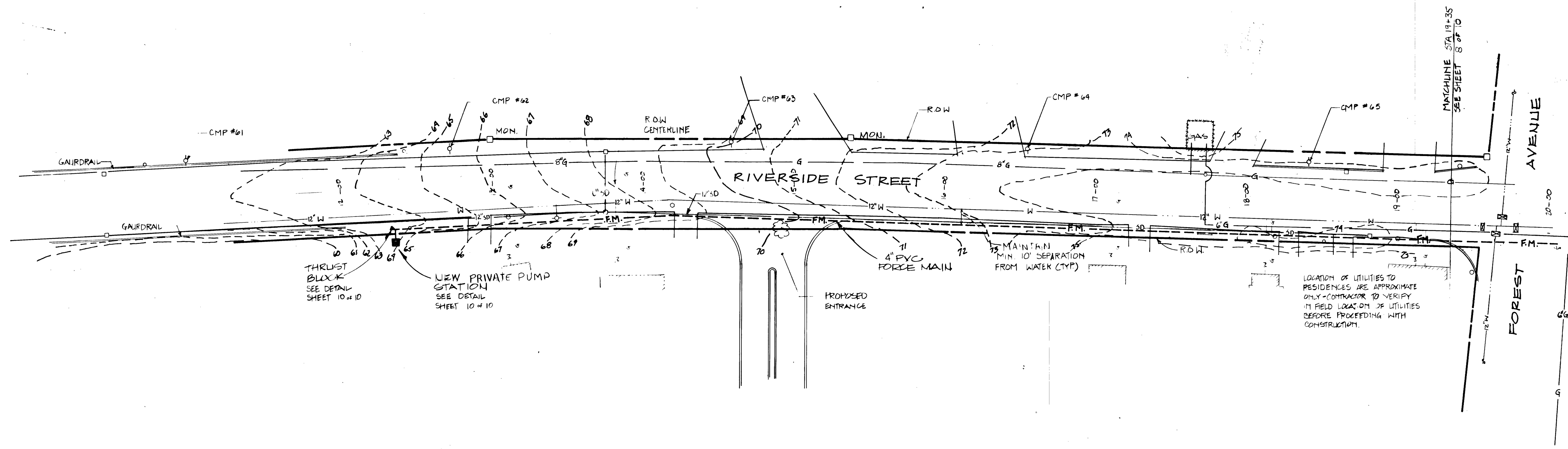

PLAN  
SCALE 1"=40'

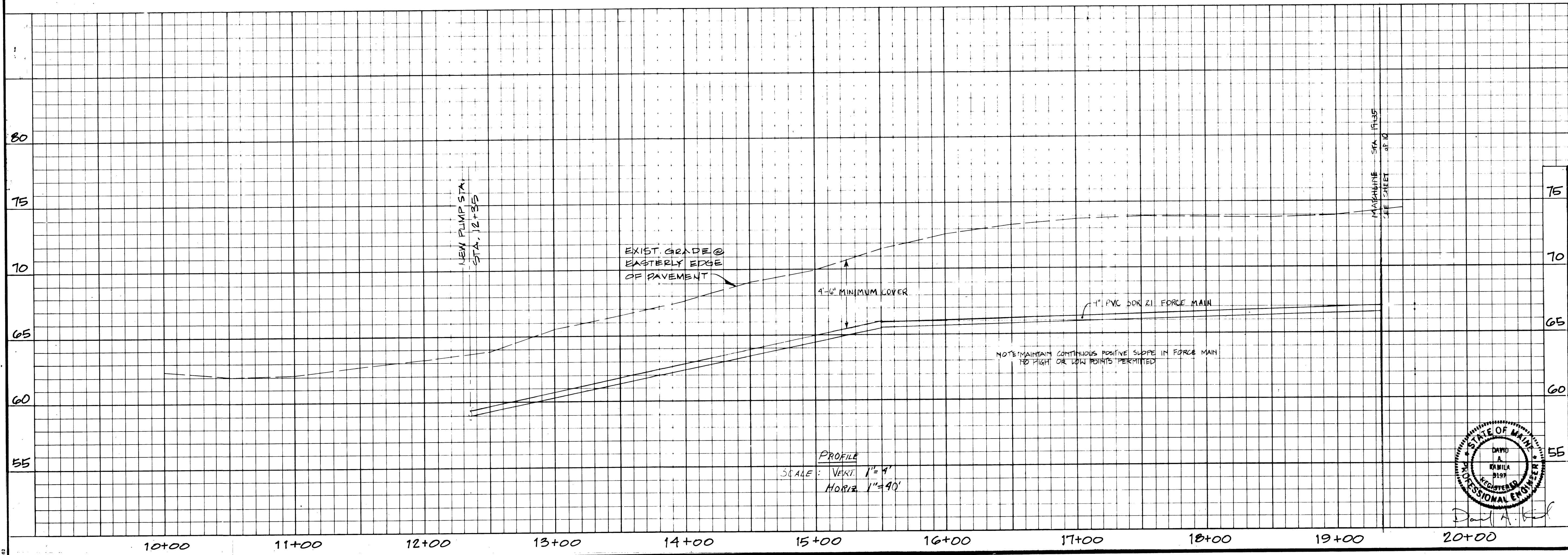

PROFILE  
SCALE: VERT 1"=4'  
HORIZ 1"=40'

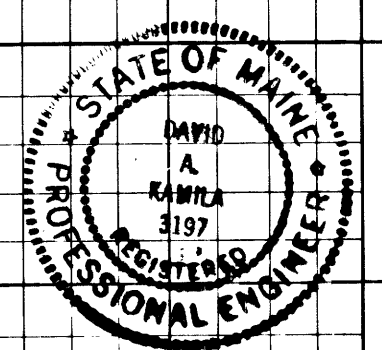

1408	ADDED FORCE MAIN, WATER MAIN AND ROW
DATE: 11-30-87	REVISIONS CHANGED SHEET NO.
TERRACE POND 723 RIVERSIDE STREET PORTLAND, MAINE 04101	
<b>Sanitary Force Main Profile - Riverside Street</b>	
WILLIAM J. DOWD ASSOCIATES 17 COMMERCIAL STREET PORTLAND, MAINE 04101	
DATE: OCT. 23, 1987	JOB NO: 1891
DRN. DESH. CHK:	FIELD BK:
SCALE: 1"=40'	SHEET 7 OF 10

