

KEY	QTY.	BOTANICAL NAME / COMMON NAME	SIZE	ROOT	COMMENTS
MP	30	MAHONIA BACULATA / SIBERIAN CRAB	2 1/2" CAL	DBP	SINGLE ITEM
AR	17	ALER. RUBRUM / RED MAPLE	7 1/2" CAL	DBP	FULL CROWN
BP	21	DETULA PAPERIFERA / PAPER BIRCH	4 1/2" CAL	DBP	MULTIPLE ITEM
PS	54	PINUS STROBUS / WHITE PINE	2 1/2" CAL	DBP	MILL ITEM
TM	82	TAXUS MEDIA HICUS / HICKS UPRIGHT YEW	2 1/2" CAL	DBP	
LD	74	QUERUS BOREALIS / EASTERN RED OAK	2 1/2" CAL	DBP	HEAVY QUALITY
TC	65	TILIA CANADENSIS / CANADIAN HEMLOCK	2 1/2" CAL	DBP	
RF	30	PIERIS FLORIBUNDA / MOUNTAIN ANDROMEDA	1 1/2" CAL	DBP	
RD	78	RHODOCODON DOUGLASSII / DOUGLASS DOGWOOD	1 1/2" CAL	DBP	
SL	72	SPIREA UPPONICA 'GOLDEN FLAME' / GOLDEN FLAME SPIREA	1 1/2" CAL	DBP	
VC	3	VIBURNUM CALLEDI / MAYFLOWER VIBURNUM	2 1/2" CAL	DBP	
V	2	VIBURNUM TOMENTOSUM / DOUBLE FILE VIBURNUM	2 1/2" CAL	DBP	

**GENERAL NOTES:**

1. ALL SITES AND PLANTING PROCEDURES TO CONFORM TO AMERICAN STANDARDS FOR NURSERY STOCK.
2. WITHIN SPECIFIED HEIGHT RANGES GIVEN FOR PLANT MATERIALS, 50% MIN. MUST BE OF THE GREATER HEIGHT.
3. IF DISCREPANCY EXISTS BETWEEN THE QUANTITIES SHOWN AND THOSE GIVEN IN THE LIST THE LIST GOVERNS.
4. ALL PLANTING SHALL BE TO BE 1/2" SHREDDED BLUE DARK MULCH.
5. ALL PLANT LOCATIONS ARE APPROXIMATE AND ARE SUBJECT TO CHANGE BASED ON EXISTING SITE CONDITIONS AND DESIGN CONSIDERATIONS.
6. EXISTING TREES TO REMAIN (WITHIN CONTRACT LIMIT LINE) SHALL BE IDENTIFIED WITH THE NOTATION AS OF THE PRESERVATION PLAN, SHEET 1 OF 5.
7. PLANT LOCATIONS AND/OR PLANTINGS SHALL BE FIELD LOCATED BY THE LANDSCAPE ARCHITECT AND NOT SCALE FROM DRAWINGS.

RIVERTON HOUSING

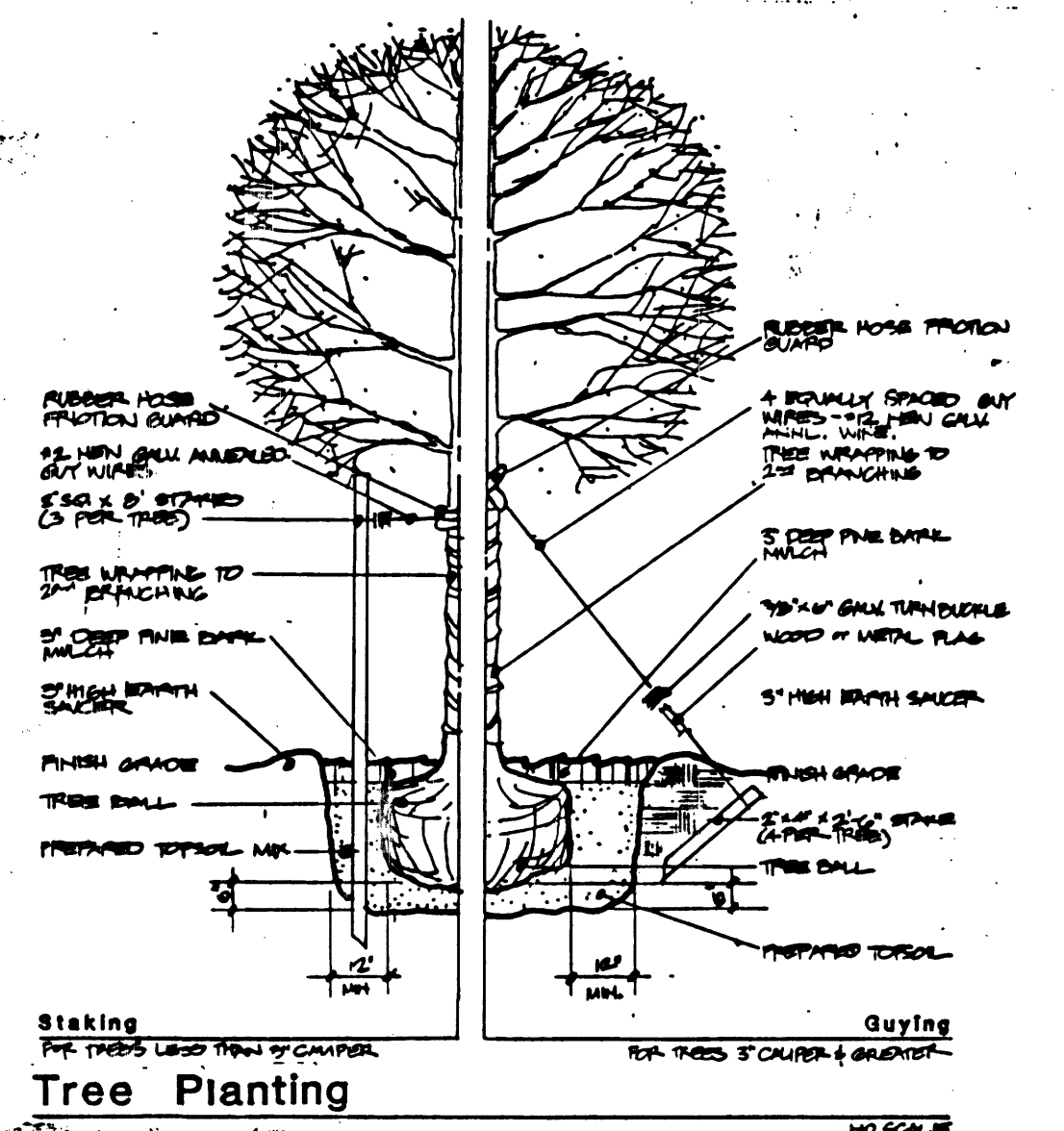
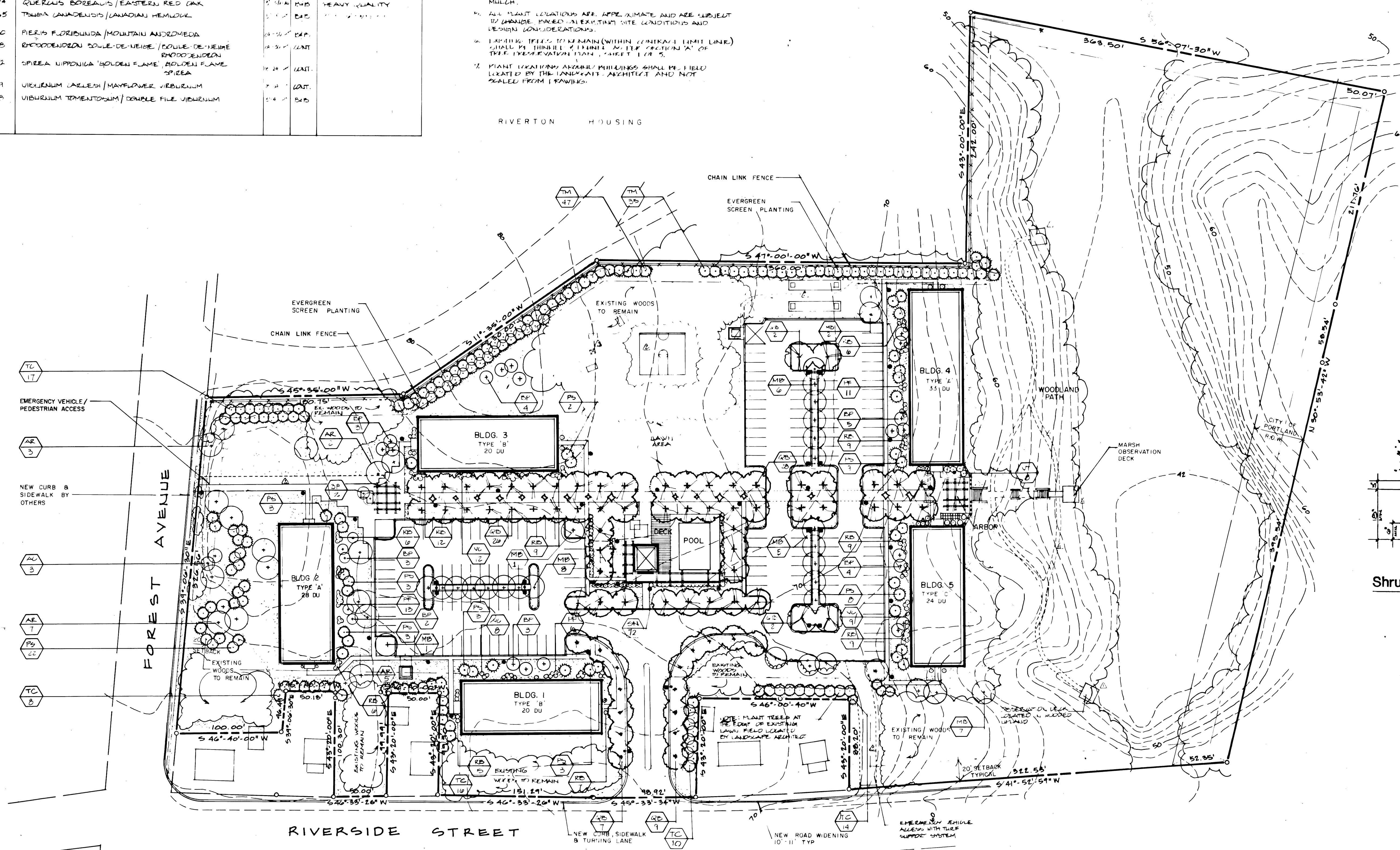

Tree Planting  
NO SCALE

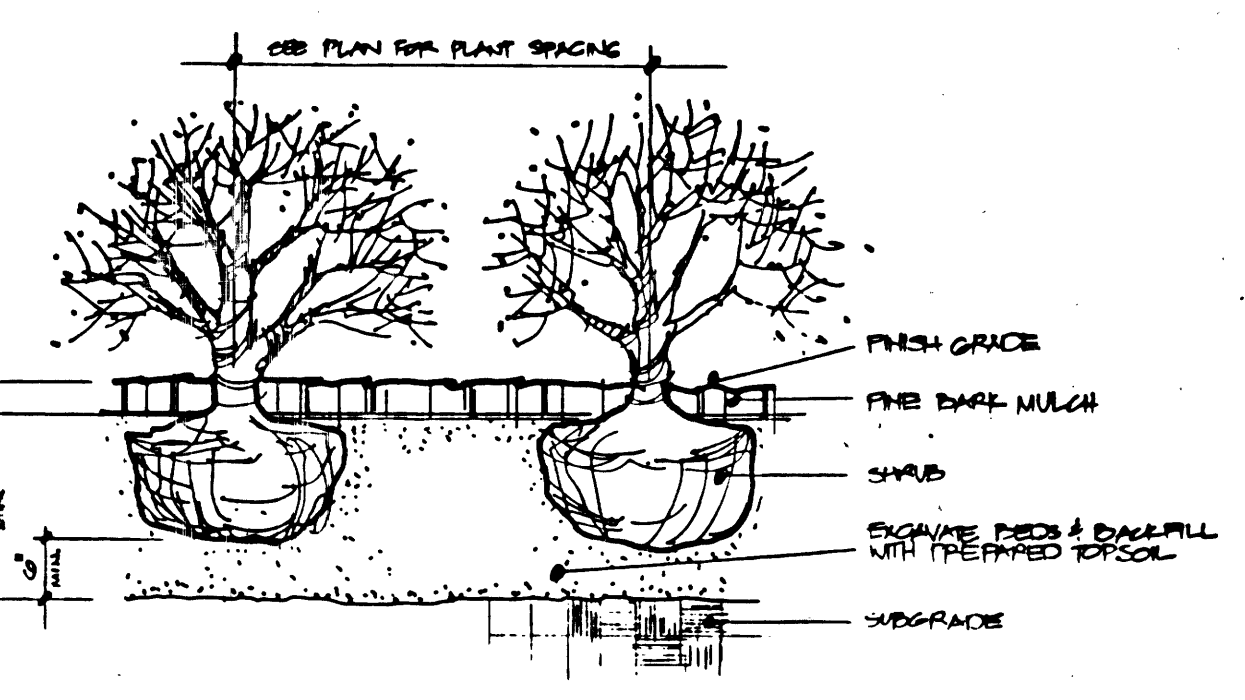

Shrub Planting  
NO SCALE

DATE: 2-3-88	REVISE PERMIT WITH ADD HOOD-SHED FOR MULTI-FLOORING PLAZA AREA AND EMERGENCY ACCESS LANE.
DATE: 11-24-88	REVISION: PATH WIDTH AND LOCATION OF OBSERVATIONAL DECKS.
DATE: 1-4-89	REVISIONS: PLANT QUANTITIES & SHEET NUMBERS FROM SYSTEM.

**TERRACE POND**  
723 RIVERSIDE STREET  
PORTLAND, MAINE

**Planting Plan**

WILLIAM J. DOWD ASSOCIATES  
17 COMMERCIAL STREET  
PORTLAND, MAINE

DATE: OCT. 23, 1987	JOB NO: 1891	
DRN: PEB	CHK: SBM	FIELD BK:
SCALE: 1" = 50'	SHEET 5 OF 10	

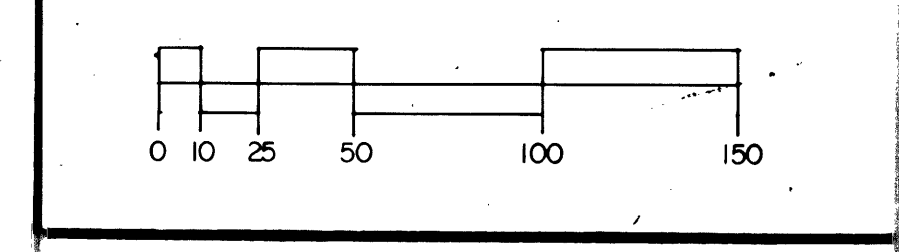

**LLC LAND USE CONSULTANTS**  
Land Planners - Engineers - Surveyors  
17 Commercial Street, Portland, Maine 04101  
207-772-9192

