

at&t
mobility corp.

**SR# ME5372
LUCAS TREE**

636 RIVERSIDE STREET
PORTLAND, ME 04103
CITY OF PORTLAND



Know what's below.
Call before you dig.

SITE INFORMATION

SITE ADDRESS: 636 RIVERSIDE STREET
PORTLAND, ME 04103

LATITUDE (NAD 83): 43.697124°
LONGITUDE (NAD 83): -70.327875°

GROUND ELEVATION: 63.0' (AMSL)

JURISDICTION: CITY OF PORTLAND

TAX MAP NUMBER: 322-A-8/323-A-8

PARCEL AREA: 4.0 ACRES

PARCEL OWNER: ADDISON CAPITAL LLC
2 SHADY LANE
FALMOUTH, ME 04105

STRUCTURE TYPE: MONOPOLE

STRUCTURE HEIGHT: 120.0' (AGL)

PROJECT TEAM

APPLICANT: AT&T MOBILITY CORPORATION
550 COCHITUATE ROAD
FRAMINGHAM, MA 01701

PROJECT MANAGEMENT FIRM: NETWORK BUILDING & CONSULTING, LLC.
1777 SENTRY PARKWAY WEST
DUBLIN HALL, SUITE 210
BLUE BELL, PA 19422
(267) 460-0122

ENGINEERING FIRM: NB&C ENGINEERING SERVICES, LLC.
1777 SENTRY PARKWAY WEST
DUBLIN HALL, SUITE 210
BLUE BELL, PA 19422
(267) 460-0122

VICINITY MAP

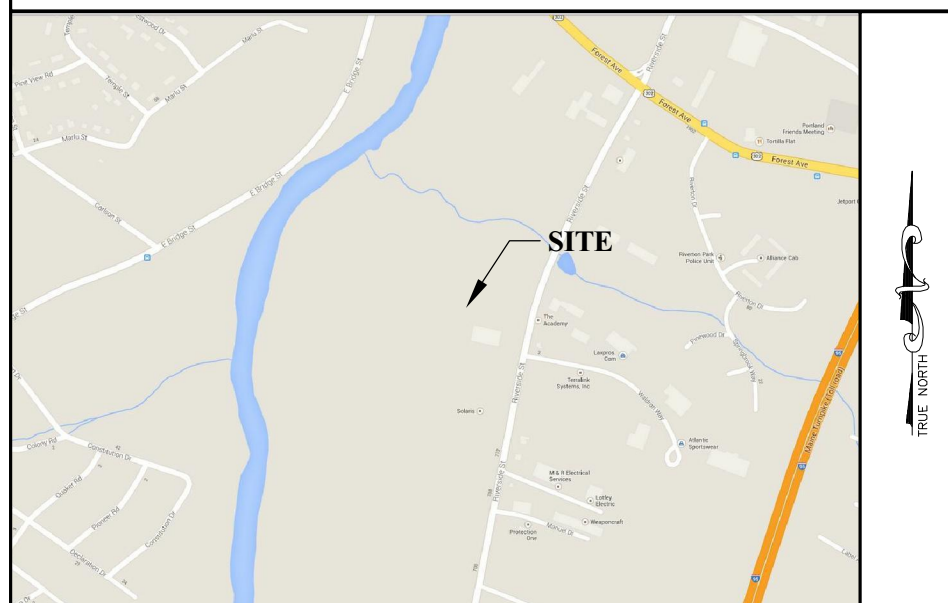

DIRECTIONS

FROM FRAMINGHAM, MA: TAKE I-90 E/MASSPIKE W/SPRINGFIELD/BOSTON. KEEP RIGHT AT THE FORK. FOLLOW SIGNS FOR INTERSTATE 90 E/INTERSTATE 95/MASSACHUSETTS TURNPIKE/BOSTON AND MERGE ONTO I-90 E/MASSACHUSETTS TURNPIKE. TAKE EXIT 14 FOR I-95 N TOWARD N.H - MAINE. FOLLOW SIGNS FOR I-95 N/WALTHAM/PORTSMOUTH NH AND MERGE ONTO I-95 N. KEEP RIGHT TO STAY ON I-95 N, FOLLOW SIGNS FOR PORTSMOUTH NH. KEEP LEFT TO CONTINUE ON I-95. MERGE ONTO I-95 N. TAKE EXIT 48 TO MERGE ONTO LARRABEE RD TOWARD ME-25/US-302/RIVERSIDE ST. TURN RIGHT ONTO RIVERSIDE ST. DESTINATION WILL BE ON THE LEFT

CODE COMPLIANCE

- ALL WORK AND MATERIALS SHALL BE PERFORMED AND INSTALLED IN ACCORDANCE WITH THE CURRENT EDITIONS OF THE FOLLOWING CODES AS ADOPTED BY THE LOCAL GOVERNING AUTHORITIES. NOTHING IN THESE PLANS IS TO BE CONSTRUED TO PERMIT WORK NOT CONFORMING TO THE LATEST EDITIONS OF THE FOLLOWING CODES.
- MAINE UNIFORM BUILDING CODE (MUBC)
 - 2008 NATIONAL ELECTRICAL CODE
 - 2009 NFPA 101, LIFE SAFETY CODE
 - 2009 IFC
 - AMERICAN CONCRETE INSTITUTE
 - AMERICAN INSTITUTE OF STEEL CONSTRUCTION
 - MANUAL OF STEEL CONSTRUCTION 13TH EDITION
 - TIA/EIA-222-G
 - TIA 607
 - INSTITUTE FOR ELECTRICAL & ELECTRONICS ENGINEER 81
 - IEEE C2 NATIONAL ELECTRIC SAFETY CODE LATEST EDITION
 - TELECORDIA GR-1275
 - ANSI/T 311
 - 2006 101, LIFE SAFETY CODE

DRAWING INDEX

T-1	TITLE SHEET
Z-1	SITE PLAN
C-1	COMPOUND & ELEVATION PLAN
C-2	CONSTRUCTION DETAILS & NOTES
C-3	SHELTER & FOUNDATION DETAILS
A-1	ANTENNA MOUNTING PLAN & DETAILS
A-2	DETAILS
A-3	RF PLUMBING DIAGRAM
E-1	ELECTRICAL PLAN & DETAILS
E-2	ELECTRICAL PANEL SCHEDULE DIAGRAM & NOTES
G-1	GROUNDING DIAGRAM & DETAILS

DO NOT SCALE DRAWINGS

THESE DRAWINGS ARE FORMATTED TO BE FULL-SIZE AT 24"X36". CONTRACTOR SHALL VERIFY ALL PLANS AND EXISTING DIMENSIONS AND CONDITIONS ON THE JOB SITE AND SHALL IMMEDIATELY NOTIFY THE DESIGNER / ENGINEER IN WRITING OF ANY DISCREPANCIES BEFORE PROCEEDING WITH THE WORK OR MATERIAL ORDERS OR BE RESPONSIBLE FOR THE SAME. CONTRACTOR SHALL USE BEST MANAGEMENT PRACTICE TO PREVENT STORM WATER POLLUTION DURING CONSTRUCTION.



NB+C ENGINEER
1777 SENTRY PARKWAY WEST
DUBLIN HALL, PA 19422
BLUE BELL, PA 19422



Reviewed for Code Compliance
Inspections Division
Approved with Conditions

Date: 07/08/14

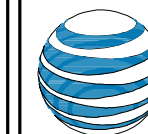

at&t
mobility corp.
550 COCHITUATE ROAD
FRAMINGHAM, MA 01701

ENGINEER

APPLICANT

SITE INFORMATION

ME5372
LUCAS TREE
636 RIVERSIDE STREET
PORTLAND, ME 04103
CITY OF PORTLAND

DESIGN RECORD

REVISIONS

REV	DATE	DESCRIPTION	BY
3	06/06/14	REVISED PER COMMENTS	DAK
2	05/22/14	PRELIMINARY CDs	DAK
1	03/20/14	REVISED PER COMMENTS	DAK
0	10/10/13	PRELIMINARY ZDs	DAK

PROFESSIONAL STAMP

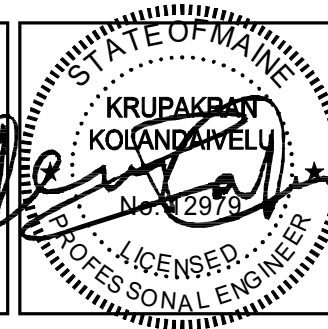

ENGINEER

KRUPAKARAN KOLANDAIVELU P.E.
ME PROFESSIONAL ENGINEER LIC. #12979

SHEET TITLE

TITLE SHEET

SHEET NUMBER

T-1