

Grown Right New Grow Facility 470 Riverside

NO	DATE	REMARKS	BY
A	05-03-16	issued for permitting	JJO
B	06-23-16	Response to comments	JJO
C	07-17-16	Added maps per comments	JJO

CODE: IRC 2009
 TOWN: Portland
 DATE: 05-01-16
 SCALE: As Noted
 DRAWN: JJO
 TITLE: Life Safety Plan
 FILE:
 SHEET: A1.03



VICINITY MAP
 SCALE: NTS



BUILDING MAP
 SCALE: NTS

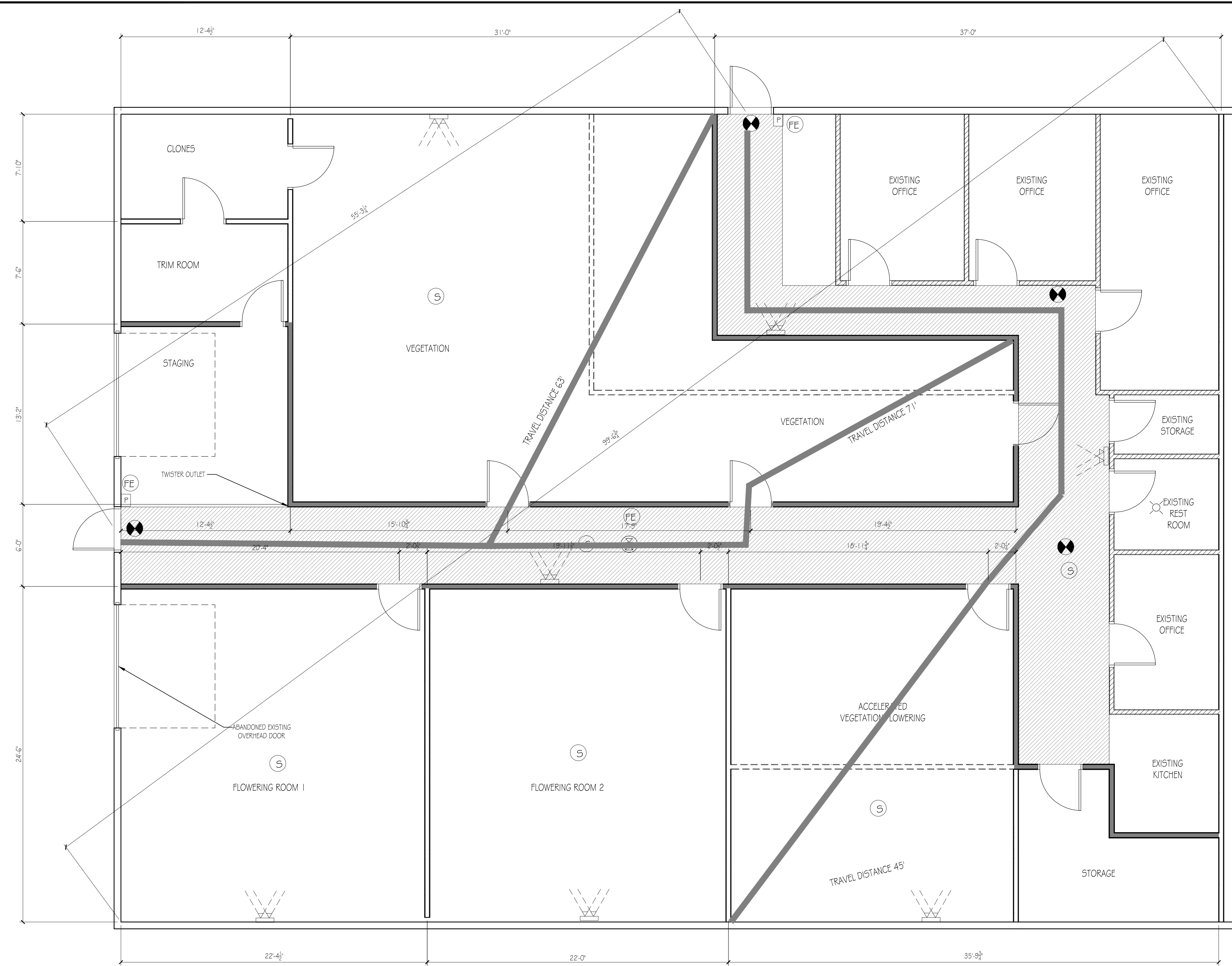

LIFE SAFETY PLAN

SCALE: 1/4" = 1'-0"

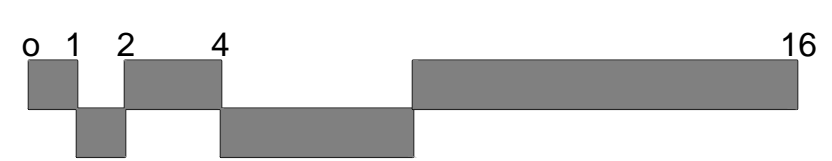

- LEGEND**
- EGRESS PATH TO BE KEPT CLEAR
 - FIRE EXTINGUISHER (CLASS 'ABC')
 - EXIT SIGN
 - EMERGENCY LIGHT PACK
 - PULL STATION
 - DIRECTION OF EGRESS
 - WALL HORN STROBE
 - WALL STROBE
 - CEILING STROBE
 - CEILING HORN STROBE
 - EXIT DOOR TAG
 - SMOKE DETECTOR
 - HEAT DETECTOR
 - EXISTING WALL TO REMAIN
 - NEW WALL
 - EXISTING WALL TO BE REMOVED
 - ONE HOUR RATED WALL

NOTE:
 THE CONTRACTOR/OWNER ASSUMES ALL RESPONSIBILITY FOR LOCAL CODE COMPLIANCE. ALL DRAWINGS, PLANS, SKETCHES ETC. ARE PROVIDED TO OUR CLIENTS BASED UPON INFORMATION PROVIDED BY THE CLIENT AND DRAWN IN ACCORDANCE WITH COMMON BUILDING PRACTICES AND LOCAL CODES. NONE OF THE EMPLOYEES OF CDT ARE REGISTERED ARCHITECTS, ENGINEERS OR LAND SURVEYORS. ALL DIMENSIONS AND SPECIFICATIONS SHOULD BE VERIFIED BY CLIENT AND/OR CONTRACTOR BEFORE ACTUAL CONSTRUCTION BEGINS. IF DIMENSIONS AND SPECIFICATIONS ARE NOT VERIFIED BY CLIENT AND/OR CONTRACTOR BEFORE ACTUAL CONSTRUCTION BEGINS CDT WILL BE HELD HARMLESS. CDT ASSUMES NO LIABILITY FOR CHANGES AND/OR REVISIONS MADE TO PLANS BY CLIENT AND/OR CONTRACTOR.

- Contractor/owner responsible for securing all necessary permits.
- Contractor/owner will Comply with all applicable codes and ordinances.
- Contractor/owner to verify all site grades and dimensions.