

2015-02576  
320-A004001

15216

# SUBSURFACE WASTEWATER DISPOSAL SYSTEM APPLICATION

Maine Dept. of Health & Human Services  
Division of Environmental Health, 11 SHS  
(207) 287-5672 Fax: (207) 287-4172

**PROPERTY LOCATION**

City, Town, or Plantation: Portland

Street or Road: 400 Riverside Street

Subdivision, Lot #

**>> CAUTION: LPI APPROVAL REQUIRED <<**

Town/City: Portland Permit # 2015-02576

Date Permit Issued: 10/2/15 Fee: \$250.00 Double Fee Charged [ ]

**OWNER/APPLICANT INFORMATION**

Name (last, first, MI): Delta Realty, LLC  Owner  Applicant

Mailing Address of Owner/Applicant: 380 Warren Avenue  
Portland, ME 04101

Daytime Tel. #: (207) 828-4650

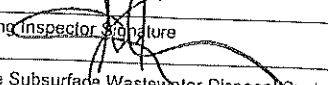
Local Plumbing Inspector Signature: 

L.P.I. # \_\_\_\_\_

Owner  Town  State

The Subsurface Wastewater Disposal System shall not be installed until a Permit is issued by the Local Plumbing Inspector. The Permit shall authorize the owner or installer to install the disposal system in accordance with this application and the Maine Subsurface Wastewater Disposal Rules.

**OWNER OR APPLICANT STATEMENT**

I state and acknowledge that the information submitted is correct to the best of my knowledge and understand that any falsification is reason for the Department and/or Local Plumbing Inspector to deny a Permit.

Signature of Owner or Applicant \_\_\_\_\_ Date \_\_\_\_\_

Municipal Tax Map # \_\_\_\_\_ Lot # \_\_\_\_\_

**CAUTION: INSPECTION REQUIRED**

I have inspected the installation authorized above and found it to be in compliance with the Subsurface Wastewater Disposal Rules Application.

Local Plumbing Inspector Signature \_\_\_\_\_ (2nd) date approved \_\_\_\_\_

**TYPE OF APPLICATION**

1. First Time System

2. Replacement System  
Type replaced: \_\_\_\_\_  
Year installed: \_\_\_\_\_

3. Expanded System  
 a. <25% Expansion  
 b. >25% Expansion

4. Experimental System

5. Seasonal Conversion

**PERMIT INFORMATION**

**THIS APPLICATION REQUIRES**

1. No Rule Variance

2. First Time System Variance  
 a. Local Plumbing Inspector Approval  
 b. State & Local Plumbing Inspector Approval

3. Replacement System Variance  
 a. Local Plumbing Inspector Approval  
 b. State & Local Plumbing Inspector Approval

4. Minimum Lot Size Variance

5. Seasonal Conversion Permit

**DISPOSAL SYSTEM COMPONENTS**

1. Complete Non-engineered System

2. Primitive System (graywater & alt. toilet)

3. Alternative Toilet, specify: \_\_\_\_\_

4. Non-engineered Treatment Tank (only)

5. Holding Tank, \_\_\_\_\_ gallons

6. Non-engineered Disposal Field (only)

7. Separated Laundry System

8. Complete Engineered System (2000 gpd or more)

9. Engineered Treatment Tank (only)

10. Engineered Disposal Field (only)

11. Pre-treatment, specify: \_\_\_\_\_

12. Miscellaneous Components

**SIZE OF PROPERTY**

118,030  SQ. FT.  ACRES

**SHORELAND ZONING**

Yes  No

**DISPOSAL SYSTEM TO SERVE**

1. Single Family Dwelling Unit, No. of Bedrooms: \_\_\_\_\_

2. Multiple Family Dwelling, No. of Units: \_\_\_\_\_

3. Other: Garage office  
(specify)

Current Use  Seasonal  Year Round  Undeveloped

**TYPE OF WATER SUPPLY**

1. Drilled Well  2. Dug Well  3. Private

4. Public  5. Other

**TREATMENT TANK**

1. Concrete  
 a. Regular  
 b. Low Profile

2. Plastic

3. Other: \_\_\_\_\_

CAPACITY: 1000 GAL.

**DISPOSAL FIELD TYPE & SIZE**

1. Stone Bed  2. Stone Trench

3. Proprietary Device  
 a. Cluster array  c. Linear  
 b. Regular load  d. H-20 load

4. Other: \_\_\_\_\_

SIZE: 540  sq. ft.  lin. ft.

**GARBAGE DISPOSAL UNIT**

1. No  2. Yes  3. Maybe

If Yes or Maybe, specify one below:

a. multi-compartment tank

b. \_\_\_\_\_ tanks in series

c. increase in tank capacity

d. Filter on Tank Outlet

**DESIGN FLOW**

156 gallons per day

BASED ON:

1. Table 4A (dwelling unit(s))

2. Table 4C (other facilities)

SHOW CALCULATIONS for other facilities

13 employees @ 12 gpd = 156 gpd

3. Section 4G (meter readings)

ATTACH WATER METER DATA

**SOIL DATA & DESIGN CLASS**

PROFILE: 1 CONDITION: C

at Observation Hole # TF-1

Depth 40"

of Most Limiting Soil Factor

**DISPOSAL FIELD SIZING**

1. Medium—2.6 sq. ft. / gpd

2. Medium—Large 3.3 sq. ft. / gpd

3. Large—4.1 sq. ft. / gpd

4. Extra Large—5.0 sq. ft. / gpd

**EFFLUENT/EJECTOR PUMP**

1. Not Required

2. May Be Required

3. Required

Specify only for engineered systems:

DOSE: \_\_\_\_\_ gallons

**LATITUDE AND LONGITUDE**

at center of disposal area

Lat. 43 d 41 m 22.4 s

Lon. -70 d 19 m 38.8 s

## SITE EVALUATOR STATEMENT

I certify that on 9/8/15 (date) I completed a site evaluation on this property and state that the data reported are accurate and that the proposed system is in compliance with the State of Maine Subsurface Wastewater Disposal Rules (10-144A CMR 241).

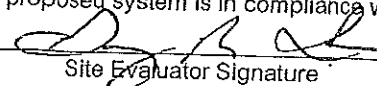
  
Site Evaluator Signature

Gary M. Fullerton  
Site Evaluator Name Printed

355  
SE #

(207) 200-2063  
Telephone Number

9-11-15  
Date

gfullerton@sebagotech.com  
E-mail Address



# SUBSURFACE WASTEWATER DISPOSAL SYSTEM APPLICATION

Maine Dept. of Health & Human Services  
 Division of Environmental Health, 11 SHS  
 (207) 287-5672 Fax: (207) 287-4172

Town, City, Plantation  
**Portland**

Street, Road, Subdivision  
**400 Riverside Street**

Owner or Applicant Name  
**Delta Realty, LLC**

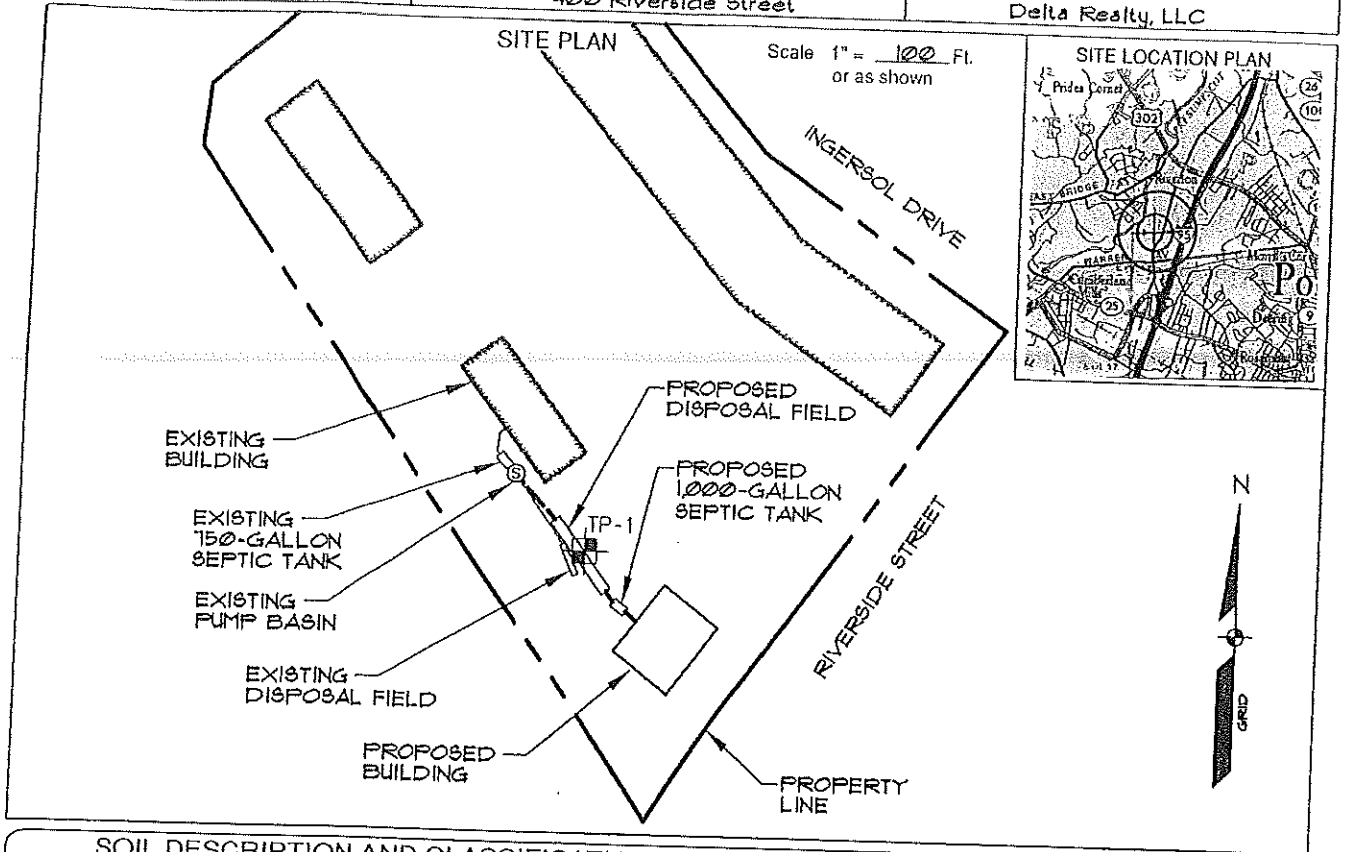

## SOIL DESCRIPTION AND CLASSIFICATION

Observation Hole TP-1  Test pit  Boring  
 \_\_\_\_\_ " Depth of Organic Horizon Above Mineral Soil

DEPTH BELOW MINERAL SOIL SURFACE (inches)	Texture	Consistency	Color	Mottling
0				
10	LOAMY FILL	FRIABLE	BROWN	
20				
30	SANDY LOAM	FRIABLE	DARK BROWN	
40	SILTY CLAY	FIRM	OLIVE GRAY	COMMON, MEDIUM, DISTINCT
50				

Soil Classification: 1 Profile, C Condition  
 Slope: 0-3 %  
 Limiting Factor: 40 "  
 Ground Water  
 Restrictive Layer  
 Bedrock  
 Pit Depth

## (Location of Observation Holes Shown Above)

Observation Hole \_\_\_\_\_  Test pit  Boring  
 \_\_\_\_\_ " Depth of Organic Horizon Above Mineral Soil

DEPTH BELOW MINERAL SOIL SURFACE (inches)	Texture	Consistency	Color	Mottling
0				
10				
20				
30				
40				
50				

Soil Classification: \_\_\_\_\_ Profile, \_\_\_\_\_ Condition  
 Slope: \_\_\_\_\_ %  
 Limiting Factor: \_\_\_\_\_ "  
 Ground Water  
 Restrictive Layer  
 Bedrock  
 Pit Depth

*[Signature]*  
 Site Evaluator Signature

355  
 SE #

9-11-15  
 Date

# SUBSURFACE WASTEWATER DISPOSAL SYSTEM APPLICATION

Maine Dept. of Health & Human Services  
 Division of Environmental Health, 11 SHS  
 (207) 287-5672 Fax: (207) 287-4172

Town, City, Plantation  
**Portland**

Street, Road, Subdivision  
**400 Riverside Street**

Owner or Applicant Name  
**Delta Realty, L.L.C**

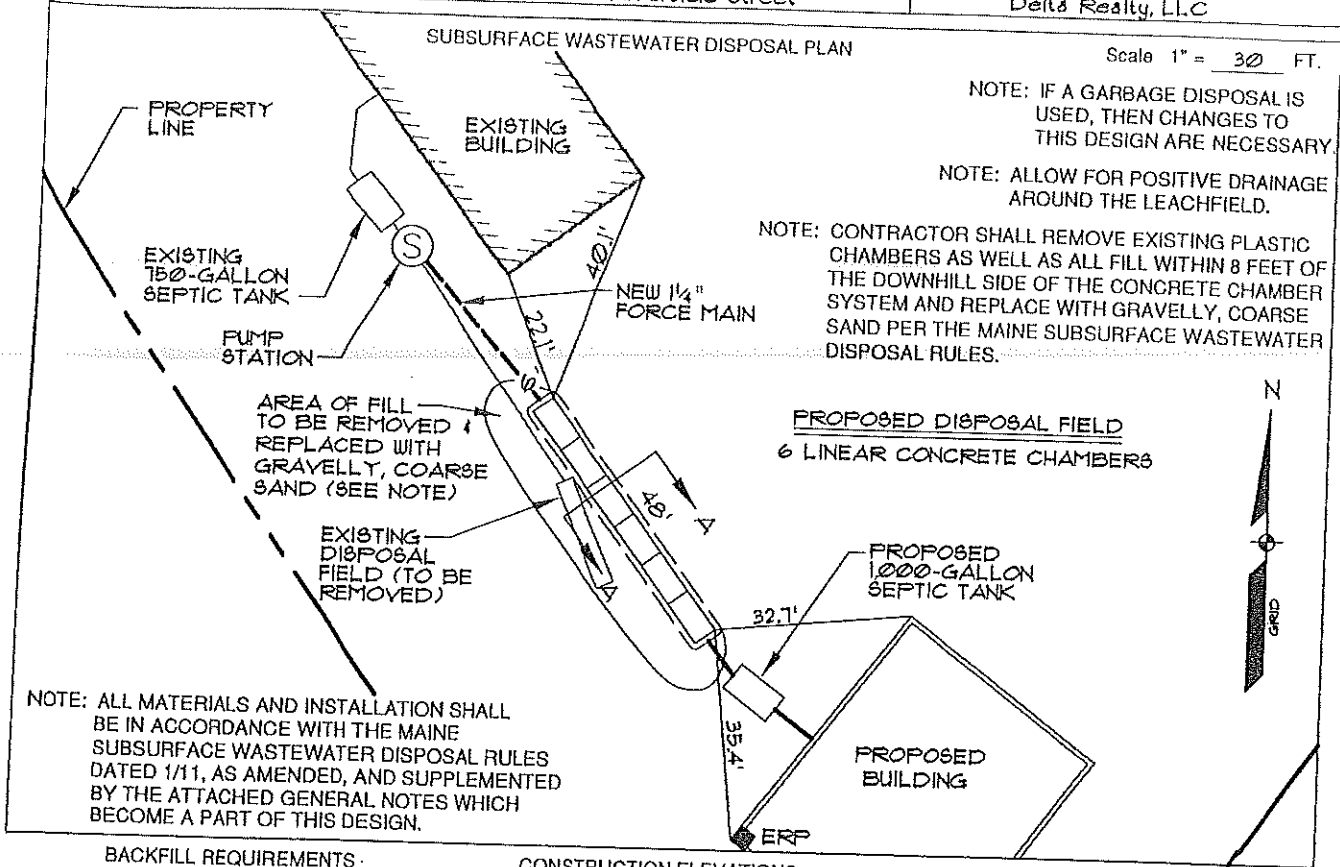

NOTE: ALL MATERIALS AND INSTALLATION SHALL BE IN ACCORDANCE WITH THE MAINE SUBSURFACE WASTEWATER DISPOSAL RULES DATED 1/11, AS AMENDED, AND SUPPLEMENTED BY THE ATTACHED GENERAL NOTES WHICH BECOME A PART OF THIS DESIGN.

**BACKFILL REQUIREMENTS:**

Depth of Fill (Upslope)	0"
Depth of Fill (Downslope)	0"

**CONSTRUCTION ELEVATIONS**

Finished Grade Elevation	-24"
Top of Distribution Pipe or Proprietary Device	-34"
Bottom of Disposal Area (Bottom of Chamber)	-46"

**ELEVATION REFERENCE POINT**

Location & Description: Top of foundation, West Corner  
 Reference Elevation 0"

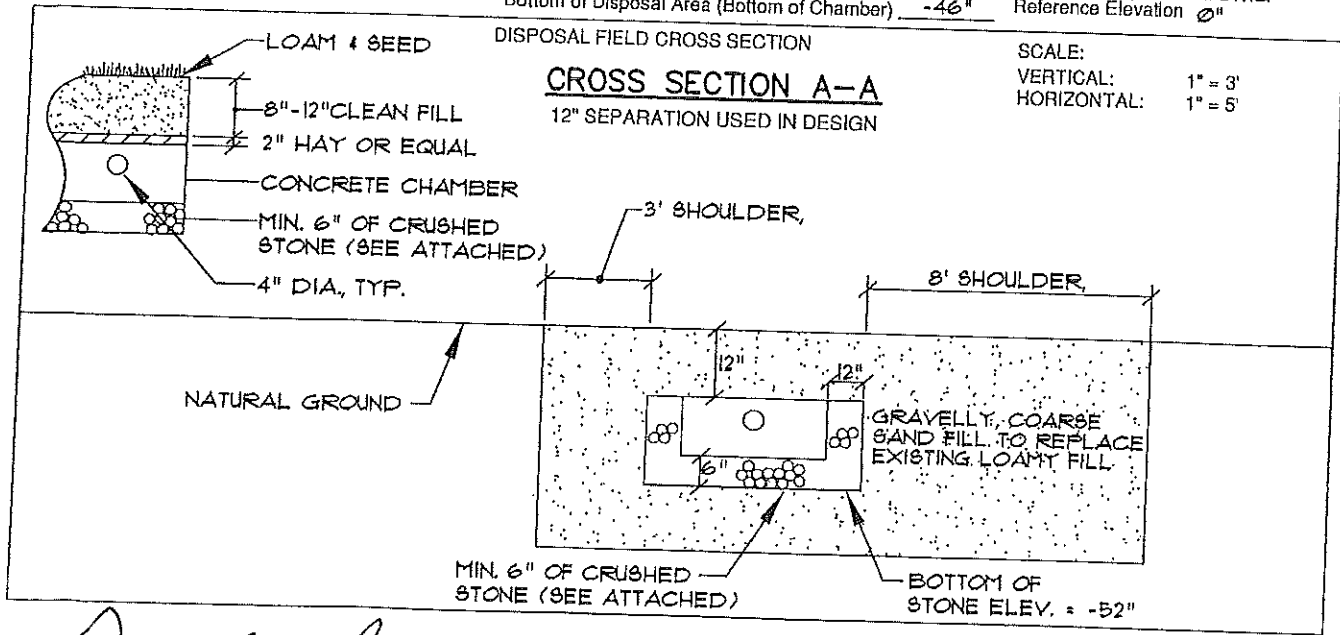

*[Signature]*  
 Site Evaluator Signature

355  
 SE #

9-11-15  
 Date

Page 3 of 3  
 HHE-200 Rev. 02/11

General Notes  
(attachment to form HHE-200)  
<1,000 gpd Septic System

1. The nature of the site evaluation profession is one of interpretation of soil and site conditions. We, in the field, attempt to both provide a satisfactory service to the client, and comply by the rules by which we are bound - The Maine Subsurface Wastewater Disposal Rules. If at any time you, the client, are not satisfied with the service provided or the results found, it is your right to hire another site evaluator for a second opinion.
2. Property information is supplied by the owner, applicant or representative. Such information presented herein shall be verified as correct by the owner or applicant prior to signing this application.
3. All work shall be in accordance with the Maine Subsurface Wastewater Disposal Rules dated 1/18/11, as amended.
4. All work on the disposal field should be performed under dry conditions.
5. No vehicular or equipment traffic to be allowed on disposal area unless H-20 load is specified. Disposal field shall be constructed from outside the corner stakes located in the field. The downslope area is also to be protected in the same manner.
6. Backfill, if required, is to be gravelly coarse sand texture and to be free of foreign debris (per Table 11A of the Maine Subsurface Wastewater Disposal Rules). If backfill is coarser than original soil, then mix a minimum of 4" of backfill material into original soil.
7. No neighboring wells are apparent (unless so indicated) within 100' of disposal area. Owner or applicant shall verify this prior to signing the application.
8. The disposal field stone shall be clean, uniform in size and free of fines, dust, ashes, or clay. It shall have a nominal size of  $\frac{3}{4}$ " or  $1\frac{1}{2}$ " (per Table 11B of the Maine Subsurface Wastewater Disposal Rules).
9. Minimum separation distances required (unless reduced by variance or special circumstance).
  - a) wells with water usage of 2000 or more gpd or public water supply wells:

Disposal Fields:	300'
Treatment Tanks:	150'
  - b) potable water supply to disposal field: 100'
  - c) potable water supply to treatment tank: 50'
  - d) treatment tank or disposal field to lake, river, stream or brook: 100' for major watercourse,  
50' for minor watercourse
  - e) house to treatment tank: 8'
  - f) house to disposal field: 20'
  - For all other separation distances, use separations for less than 1,000 gpd per Maine Subsurface Wastewater Disposal Rules Table 7B for first-time systems and Table 8A for replacement systems.
10. Location of septic system near a wetland may require a separate permit. As such, the owner, prior to construction of the septic system, shall hire a professional to evaluate proximity of adjacent wetlands and prepare necessary permit applications.
11. Garbage disposals are not recommended and, if installed, are done so at the owner's risk. The additional waste load requires increased maintenance frequency and may cause premature failure of disposal field.
12. Pump stations, when required, shall be installed watertight to prevent infiltration of ground and/or surface water.
13. Force mains and pressure lines shall be flushed of any foreign material and pumps shall be checked for proper on/off cycle before being put into service.
14. Force mains, pump stations, and/or gravity piping subject to freezing shall be installed below frost line or adequately insulated.