

2013-00439

11226

MAR 06 2013

320 A002

Dept. of Building Inspection

| SUBSURFACE WASTEWATER DISPOSAL SYSTEM APPLICATION | | Maine Department of Human Services Division of Health Engineering 10-31-3 (207) 287-5672 Fax (207) 287-3185 | |
|---|---|--|--|
| PROPERTY LOCATION | | >> CAUTION: LPI APPROVAL REQUIRED << | |
| City, Town, or Plantation | Portland | Town/City | Portland |
| Street or Road | 410 Riverside Street | Date Permit Issued | 3/12/13 |
| Subdivision, Lot # | 70 and 51-57 Ingersol Drive | Fee | \$ 150.00 |
| OWNER/APPLICANT INFORMATION | | Permit # 20320439 | |
| Name (last, first, MI) | 410 Riverside St., LLC | LPI # 360 | |
| Mailing Address of Owner/Applicant | 1099 Royals Bowright RD Michael Corp | <input type="checkbox"/> Owner <input type="checkbox"/> Town <input type="checkbox"/> State The Subsurface Wastewater Disposal System shall not be installed until a Permit is issued by the Local Plumbing Inspector. This Permit shall authorize the owner or installer to install the disposal system in accordance with this application and the Maine Subsurface Wastewater Disposal Rules. | |
| Daytime Tel # | 596-0652 | Municipal Tax Map # 320 Lot # A002 | |
| OWNER OR APPLICANT STATEMENT | | CAUTION: INSPECTION REQUIRED | |
| I state and acknowledge that the information submitted is correct to the best of my knowledge and understand that any falsification is reason for the Department and/or Local Plumbing Inspector to deny a Permit. | | I have inspected the installation authorized above and found it to be in compliance with the Subsurface Wastewater Disposal Rules Application. | |
| Signature of Owner or Applicant _____ Date _____ | | Local Plumbing Inspector Signature _____ (1st) date approved _____ _____ (2nd) date approved _____ | |
| PERMIT INFORMATION | | | |
| TYPE OF APPLICATION | | DISPOSAL SYSTEM COMPONENTS | |
| <input type="checkbox"/> 1. First Time System <input checked="" type="checkbox"/> 2. Replacement System Type replaced: <u>Conc Chamb</u> Year installed: <u>1980s</u> <input type="checkbox"/> 3. Expanded System <input type="checkbox"/> a. <25% Expansion <input type="checkbox"/> b. >= 25% Expansion <input type="checkbox"/> 4. Experimental System <input type="checkbox"/> 5. Seasonal Conversion | | <input type="checkbox"/> 1. Complete Non-engineered System <input type="checkbox"/> 2. Primitive System (graywater & all toilet) <input type="checkbox"/> 3. Alternative Toilet, specify: _____ <input type="checkbox"/> 4. Non-engineered Treatment Tank (only) <input type="checkbox"/> 5. Holding Tank, _____ gallons <input checked="" type="checkbox"/> 6. Non-engineered Disposal Field (only) <input type="checkbox"/> 7. Separated Laundry System <input type="checkbox"/> 8. Complete Engineered System (2000 gpd or more) <input type="checkbox"/> 9. Engineered Treatment Tank (only) <input type="checkbox"/> 10. Engineered Disposal Field (only) <input type="checkbox"/> 11. Pre-treatment, specify: _____ <input type="checkbox"/> 12. Miscellaneous Components | |
| SIZE OF PROPERTY | | DISPOSAL SYSTEM TO SERVE | |
| 13 +/- <input type="checkbox"/> SQ. FT. <input checked="" type="checkbox"/> ACRES | | <input type="checkbox"/> 1. Single Family Dwelling Unit, No. of Bedrooms: _____ <input type="checkbox"/> 2. Multiple Family Dwelling, No. of Units: _____ <input checked="" type="checkbox"/> 3. Other: <u>Commercial Buildings</u> (specify) _____ Current Use <input type="checkbox"/> Seasonal <input checked="" type="checkbox"/> Year Round <input type="checkbox"/> Undeveloped | |
| SHORELAND ZONING | | TYPE OF WATER SUPPLY | |
| <input type="checkbox"/> Yes <input checked="" type="checkbox"/> No | | <input type="checkbox"/> 1. Drilled Well <input type="checkbox"/> 2. Dug Well <input type="checkbox"/> 3. Private <input checked="" type="checkbox"/> 4. Public <input type="checkbox"/> 5. Other | |
| DESIGN DETAILS (SYSTEM LAYOUT SHOWN ON PAGE 3) | | | |
| TREATMENT TANK | | DISPOSAL FIELD TYPE & SIZE | |
| <input checked="" type="checkbox"/> 1. Concrete <u>2 Existing Septic Tanks</u> <input type="checkbox"/> a. Regular <u>With Lift Stations</u> <input type="checkbox"/> b. Low Profile <input type="checkbox"/> 2. Plastic <input type="checkbox"/> 3. Other: _____ CAPACITY: <u>Add 1,000 GAL</u> | | <input type="checkbox"/> 1. Stone Bed <input type="checkbox"/> 2. Stone Trench <input checked="" type="checkbox"/> 3. Proprietary Device <input type="checkbox"/> a. cluster array <input type="checkbox"/> c. Linear <input checked="" type="checkbox"/> b. regular load <input type="checkbox"/> d. H-20 load <input type="checkbox"/> 4. Other: _____ SIZE: <u>See P. 3</u> <input type="checkbox"/> sq. ft. <input type="checkbox"/> lin. ft. | |
| SOIL DATA | | DISPOSAL FIELD SIZING | |
| PROFILE <u>7</u> CONDITION <u>C</u> at Observation Hole # <u>TB-2</u> Depth <u>26"</u> of Most Limiting Soil Factor <u>Groundwater</u> | | <input type="checkbox"/> 1. Medium—2.6 sq. ft. / gpd <input checked="" type="checkbox"/> 2. Medium—Large 3.3 sq. ft. / gpd <input type="checkbox"/> 3. Large—4.1 sq. ft. / gpd <input type="checkbox"/> 4. Extra Large—5.0 sq. ft. / gpd | |
| | | GARBAGE DISPOSAL UNIT | |
| | | <input checked="" type="checkbox"/> 1. No <input type="checkbox"/> 2. Yes <input type="checkbox"/> 3. Maybe If Yes or Maybe, specify one below: <input type="checkbox"/> a. multi-compartment tank <input type="checkbox"/> b. _____ tanks in series <input type="checkbox"/> c. increase in tank capacity <input type="checkbox"/> d. Filter on Tank Outlet | |
| | | EFFLUENT/EJECTOR PUMP | |
| | | <input type="checkbox"/> 1. Not Required <input type="checkbox"/> 2. May Be Required <input checked="" type="checkbox"/> 3. Required Specify only for engineered systems: DOSE: _____ gallons | |
| | | DESIGN FLOW | |
| | | <u>1,094</u> gallons per day BASED ON: <input type="checkbox"/> 1. Table 4A (dwelling unit(s)) <input checked="" type="checkbox"/> 2. Table 4C (other facilities) SHOW CALCULATIONS for other facilities: Bldg 51-57: 20 employees at 12 gpd/each Bldg 70: 40 employees at 20 gpd/each with showers <input type="checkbox"/> 3. Section 4G (meter readings) (With Shower) ATTACH WATER METER DATA LATITUDE AND LONGITUDE at center of disposal area: Lat. <u>N43</u> d. <u>41</u> m. <u>29.77</u> ° Lon. <u>W70</u> d. <u>19</u> m. <u>46.78</u> ° If g.p.s. state margin of error: <u>20'</u> | |
| SITE EVALUATOR STATEMENT | | | |
| I certify that on <u>5-15-12</u> (date) I completed a site evaluation on this property and state that the data reported are accurate and that the proposed system is in compliance with the State of Maine Subsurface Wastewater Disposal Rules (10-144A CMR 241) | | | |
| <u>Richard A. Sweet</u> Site Evaluator Signature | | <u>034</u> SE # | <u>07-08-12</u> Date |
| <u>Richard A. Sweet</u> Site Evaluator Name Printed | | <u>797-2110</u> Telephone Number | <u>dick@sweetassociates.com</u> Email Address |
| Designed with SeptiCAD v3 | | Page 1 of 3 | |
| Note: Changes to or deviations from the design should be confirmed with the Site Evaluator. | | HME-200 Rev. 2/11 | |

Dept. of Building Inspection
City of Portland, ME

| SUBSURFACE WASTEWATER DISPOSAL SYSTEM APPLICATION | | Maine Department of Health Services Division of Health Engineering, Design & Construction (207) 287-5872 Fax: (207) 287-0160 | | | | | | | | | | | | | | | | | | | | | | | | | | | | | | | | | | | | | | | | | | | | | | | | | | | | | | | | | | | | | | | | | | | | | | | | | | | | | | | | | | | | | | | | | | | | | | |
|---|---|--|-----------------|-------------------|----------|-------|------|---------|------------|--|--------|-----------|-------|-------------|--|---------|----------------------|--|------------|--|---------|--|------|--|-------------------|---------|----------------------------------|--|--|--|---------|--|--|--|--|--------------|----------------|-------|-----------------|-------------|---|---|----|-----------|-------------------|--|---|---------|-------------|-------|----------|-------|------------|---------|------------|--|--------|--|--|--|--|---------|------------|--|-----------|--|---------|--|--|-------------|-------------------|---------|------------------|------|------|--|---------|--|--|--|--|---------|--|--|--|--|--------------|----------------|-------|-----------------|-------------|---|---|----|-----------|-------------------|
| Town, City, Plantation Portland | Street, Road, Subdivision 410 Riverside Street | Owner or Applicant Name 410 Riverside St. LLC | | | | | | | | | | | | | | | | | | | | | | | | | | | | | | | | | | | | | | | | | | | | | | | | | | | | | | | | | | | | | | | | | | | | | | | | | | | | | | | | | | | | | | | | | | | | | | |
| <p style="text-align: center;">SITE PLAN Scale 1" = 50' ft.</p> | | <p style="text-align: center;">SITE LOCATION PLAN</p> | | | | | | | | | | | | | | | | | | | | | | | | | | | | | | | | | | | | | | | | | | | | | | | | | | | | | | | | | | | | | | | | | | | | | | | | | | | | | | | | | | | | | | | | | | | | | | |
| <p>NOTES:</p> <ol style="list-style-type: none"> This is not a survey. All property lines, building locations and site features have been approximately located, unless otherwise shown. Scarify all ground to be filled. Insulate the Distribution Box (D-Box). Remove all silt, clay, or fill below existing loam to 32" below ground surface. Set toe of fill 2' back from curb. Review the Eljen Geotextile Sand Filter (GSF) Design and Installation Manual before installing this system. Confirm that all septic tanks and pump tanks are free of groundwater leaks. | | | | | | | | | | | | | | | | | | | | | | | | | | | | | | | | | | | | | | | | | | | | | | | | | | | | | | | | | | | | | | | | | | | | | | | | | | | | | | | | | | | | | | | | | | | | | | | | |
| SOIL PROFILE DESCRIPTION AND CLASSIFICATION (Location of Observation Holes Shown Above) | | | | | | | | | | | | | | | | | | | | | | | | | | | | | | | | | | | | | | | | | | | | | | | | | | | | | | | | | | | | | | | | | | | | | | | | | | | | | | | | | | | | | | | | | | | | | | | | |
| <p>Observation Hole # <u>TP-1</u> ■ Test Pit □ Boring</p> <p style="text-align: center;">" Depth of organic horizon above mineral soil</p> <table border="1" style="width:100%; border-collapse: collapse;"> <thead> <tr> <th>Depth below mineral soil surface (inches)</th> <th>Texture</th> <th>Consistency</th> <th>Color</th> <th>Mottling</th> </tr> </thead> <tbody> <tr> <td>0 - 6</td> <td>Loam</td> <td>Friable</td> <td>Dark Brown</td> <td></td> </tr> <tr> <td>6 - 12</td> <td>Fine Sand</td> <td>Loose</td> <td>Light Brown</td> <td></td> </tr> <tr> <td>12 - 24</td> <td>Stratified Sand/Silt</td> <td></td> <td>Gray/Brown</td> <td></td> </tr> <tr> <td>24 - 36</td> <td></td> <td>Firm</td> <td></td> <td>Common & Distinct</td> </tr> <tr> <td>36 - 42</td> <td colspan="4" style="text-align: center;">Limit of Excavation at 36 inches</td> </tr> <tr> <td>42 - 48</td> <td></td> <td></td> <td></td> <td></td> </tr> </tbody> </table> <table border="1" style="width:100%; border-collapse: collapse; margin-top: 5px;"> <tr> <td>Soil Profile</td> <td>Classification</td> <td>Slope</td> <td>Limiting Factor</td> <td>Groundwater</td> </tr> <tr> <td>7</td> <td>C</td> <td>10</td> <td>28" Depth</td> <td>Restrictive Layer</td> </tr> </table> | Depth below mineral soil surface (inches) | Texture | Consistency | Color | Mottling | 0 - 6 | Loam | Friable | Dark Brown | | 6 - 12 | Fine Sand | Loose | Light Brown | | 12 - 24 | Stratified Sand/Silt | | Gray/Brown | | 24 - 36 | | Firm | | Common & Distinct | 36 - 42 | Limit of Excavation at 36 inches | | | | 42 - 48 | | | | | Soil Profile | Classification | Slope | Limiting Factor | Groundwater | 7 | C | 10 | 28" Depth | Restrictive Layer | <p>Observation Hole # <u>TB-2</u> □ Test Pit ■ Boring</p> <p style="text-align: center;">" Depth of organic horizon above mineral soil</p> <table border="1" style="width:100%; border-collapse: collapse;"> <thead> <tr> <th>Depth below mineral soil surface (inches)</th> <th>Texture</th> <th>Consistency</th> <th>Color</th> <th>Mottling</th> </tr> </thead> <tbody> <tr> <td>0 - 6</td> <td>Sandy Loam</td> <td>Friable</td> <td>Dark Brown</td> <td></td> </tr> <tr> <td>6 - 12</td> <td></td> <td></td> <td></td> <td></td> </tr> <tr> <td>12 - 24</td> <td>Sandy Loam</td> <td></td> <td>Red/Brown</td> <td></td> </tr> <tr> <td>24 - 30</td> <td></td> <td></td> <td>Light Brown</td> <td>Common & Distinct</td> </tr> <tr> <td>30 - 36</td> <td>Silly Sandy Loam</td> <td>Firm</td> <td>Gray</td> <td></td> </tr> <tr> <td>36 - 42</td> <td></td> <td></td> <td></td> <td></td> </tr> <tr> <td>42 - 48</td> <td></td> <td></td> <td></td> <td></td> </tr> </tbody> </table> <table border="1" style="width:100%; border-collapse: collapse; margin-top: 5px;"> <tr> <td>Soil Profile</td> <td>Classification</td> <td>Slope</td> <td>Limiting Factor</td> <td>Groundwater</td> </tr> <tr> <td>7</td> <td>C</td> <td>10</td> <td>26" Depth</td> <td>Restrictive Layer</td> </tr> </table> | Depth below mineral soil surface (inches) | Texture | Consistency | Color | Mottling | 0 - 6 | Sandy Loam | Friable | Dark Brown | | 6 - 12 | | | | | 12 - 24 | Sandy Loam | | Red/Brown | | 24 - 30 | | | Light Brown | Common & Distinct | 30 - 36 | Silly Sandy Loam | Firm | Gray | | 36 - 42 | | | | | 42 - 48 | | | | | Soil Profile | Classification | Slope | Limiting Factor | Groundwater | 7 | C | 10 | 26" Depth | Restrictive Layer |
| Depth below mineral soil surface (inches) | Texture | Consistency | Color | Mottling | | | | | | | | | | | | | | | | | | | | | | | | | | | | | | | | | | | | | | | | | | | | | | | | | | | | | | | | | | | | | | | | | | | | | | | | | | | | | | | | | | | | | | | | | | | | |
| 0 - 6 | Loam | Friable | Dark Brown | | | | | | | | | | | | | | | | | | | | | | | | | | | | | | | | | | | | | | | | | | | | | | | | | | | | | | | | | | | | | | | | | | | | | | | | | | | | | | | | | | | | | | | | | | | | | |
| 6 - 12 | Fine Sand | Loose | Light Brown | | | | | | | | | | | | | | | | | | | | | | | | | | | | | | | | | | | | | | | | | | | | | | | | | | | | | | | | | | | | | | | | | | | | | | | | | | | | | | | | | | | | | | | | | | | | | |
| 12 - 24 | Stratified Sand/Silt | | Gray/Brown | | | | | | | | | | | | | | | | | | | | | | | | | | | | | | | | | | | | | | | | | | | | | | | | | | | | | | | | | | | | | | | | | | | | | | | | | | | | | | | | | | | | | | | | | | | | | |
| 24 - 36 | | Firm | | Common & Distinct | | | | | | | | | | | | | | | | | | | | | | | | | | | | | | | | | | | | | | | | | | | | | | | | | | | | | | | | | | | | | | | | | | | | | | | | | | | | | | | | | | | | | | | | | | | | |
| 36 - 42 | Limit of Excavation at 36 inches | | | | | | | | | | | | | | | | | | | | | | | | | | | | | | | | | | | | | | | | | | | | | | | | | | | | | | | | | | | | | | | | | | | | | | | | | | | | | | | | | | | | | | | | | | | | | | | |
| 42 - 48 | | | | | | | | | | | | | | | | | | | | | | | | | | | | | | | | | | | | | | | | | | | | | | | | | | | | | | | | | | | | | | | | | | | | | | | | | | | | | | | | | | | | | | | | | | | | | | | | |
| Soil Profile | Classification | Slope | Limiting Factor | Groundwater | | | | | | | | | | | | | | | | | | | | | | | | | | | | | | | | | | | | | | | | | | | | | | | | | | | | | | | | | | | | | | | | | | | | | | | | | | | | | | | | | | | | | | | | | | | | |
| 7 | C | 10 | 28" Depth | Restrictive Layer | | | | | | | | | | | | | | | | | | | | | | | | | | | | | | | | | | | | | | | | | | | | | | | | | | | | | | | | | | | | | | | | | | | | | | | | | | | | | | | | | | | | | | | | | | | | |
| Depth below mineral soil surface (inches) | Texture | Consistency | Color | Mottling | | | | | | | | | | | | | | | | | | | | | | | | | | | | | | | | | | | | | | | | | | | | | | | | | | | | | | | | | | | | | | | | | | | | | | | | | | | | | | | | | | | | | | | | | | | | |
| 0 - 6 | Sandy Loam | Friable | Dark Brown | | | | | | | | | | | | | | | | | | | | | | | | | | | | | | | | | | | | | | | | | | | | | | | | | | | | | | | | | | | | | | | | | | | | | | | | | | | | | | | | | | | | | | | | | | | | | |
| 6 - 12 | | | | | | | | | | | | | | | | | | | | | | | | | | | | | | | | | | | | | | | | | | | | | | | | | | | | | | | | | | | | | | | | | | | | | | | | | | | | | | | | | | | | | | | | | | | | | | | | |
| 12 - 24 | Sandy Loam | | Red/Brown | | | | | | | | | | | | | | | | | | | | | | | | | | | | | | | | | | | | | | | | | | | | | | | | | | | | | | | | | | | | | | | | | | | | | | | | | | | | | | | | | | | | | | | | | | | | | |
| 24 - 30 | | | Light Brown | Common & Distinct | | | | | | | | | | | | | | | | | | | | | | | | | | | | | | | | | | | | | | | | | | | | | | | | | | | | | | | | | | | | | | | | | | | | | | | | | | | | | | | | | | | | | | | | | | | | |
| 30 - 36 | Silly Sandy Loam | Firm | Gray | | | | | | | | | | | | | | | | | | | | | | | | | | | | | | | | | | | | | | | | | | | | | | | | | | | | | | | | | | | | | | | | | | | | | | | | | | | | | | | | | | | | | | | | | | | | | |
| 36 - 42 | | | | | | | | | | | | | | | | | | | | | | | | | | | | | | | | | | | | | | | | | | | | | | | | | | | | | | | | | | | | | | | | | | | | | | | | | | | | | | | | | | | | | | | | | | | | | | | | |
| 42 - 48 | | | | | | | | | | | | | | | | | | | | | | | | | | | | | | | | | | | | | | | | | | | | | | | | | | | | | | | | | | | | | | | | | | | | | | | | | | | | | | | | | | | | | | | | | | | | | | | | |
| Soil Profile | Classification | Slope | Limiting Factor | Groundwater | | | | | | | | | | | | | | | | | | | | | | | | | | | | | | | | | | | | | | | | | | | | | | | | | | | | | | | | | | | | | | | | | | | | | | | | | | | | | | | | | | | | | | | | | | | | |
| 7 | C | 10 | 26" Depth | Restrictive Layer | | | | | | | | | | | | | | | | | | | | | | | | | | | | | | | | | | | | | | | | | | | | | | | | | | | | | | | | | | | | | | | | | | | | | | | | | | | | | | | | | | | | | | | | | | | | |
| <p><i>Richard Bennett</i> Site Evaluator Signature</p> | | <p>034 SE #</p> | | | | | | | | | | | | | | | | | | | | | | | | | | | | | | | | | | | | | | | | | | | | | | | | | | | | | | | | | | | | | | | | | | | | | | | | | | | | | | | | | | | | | | | | | | | | | | |
| <p>07-08-12 Date</p> | | <p>Page 2 of 3 HHE-200 Rev. 2/11</p> | | | | | | | | | | | | | | | | | | | | | | | | | | | | | | | | | | | | | | | | | | | | | | | | | | | | | | | | | | | | | | | | | | | | | | | | | | | | | | | | | | | | | | | | | | | | | | |

06 2013

Dept. of Building Inspection

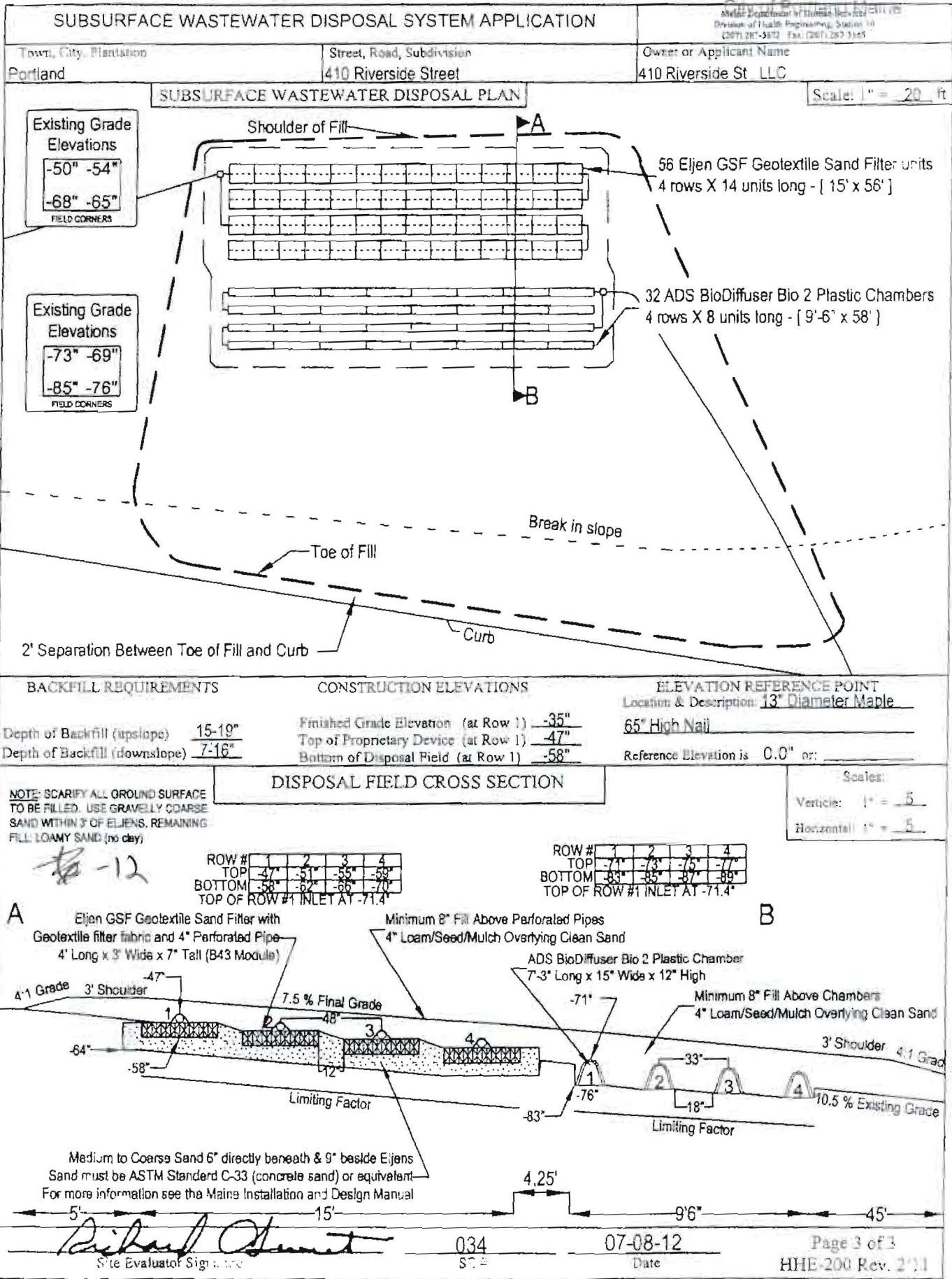

Donald McPherson - Septic Design 410 Riverside

From: "Richard Sweet" <sweet@maine.rr.com>
To: <dmcpherson@portlandmaine.gov>
Date: 4/1/2013 11:07 AM
Subject: Septic Design 410 Riverside
Attachments: 410RiversideStreet3 HHE-200.pdf

Don,
Attached is a revised plan showing the change in the distribution pipe over the Eljen pads. See note on page 3

Dick

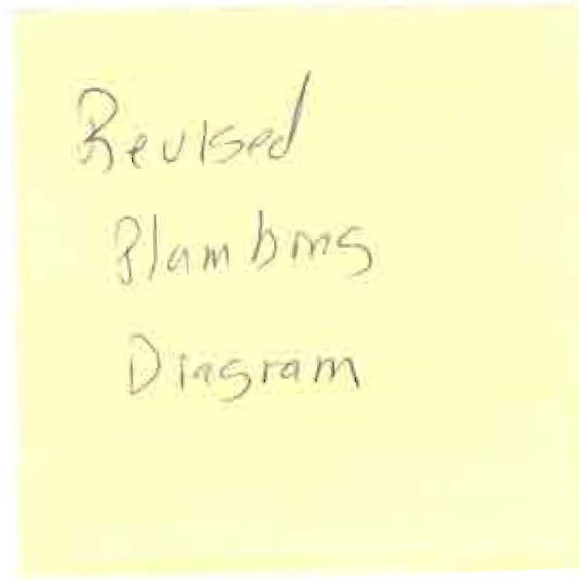

320 - A002

| SUBSURFACE WASTEWATER DISPOSAL SYSTEM APPLICATION | | Maine Department of Human Services Division of Health Engineering, 10 SHB (207) 267-5672 Fax: (207) 267-3165 | |
|---|---|--|---|
| PROPERTY LOCATION | | >> CAUTION: LPI APPROVAL REQUIRED << | |
| City, Town, or Plantation | Portland | Town/City | Permit # |
| Street or Road | 410 Riverside Street | Date Permit Issued | Fee: \$ Double Fee Charged: <input type="checkbox"/> |
| Subdivision, Lot # | 70 and 51-57 Ingersol Drive | Local Plumbing Inspector Signature | LPI # |
| OWNER/APPLICANT INFORMATION | | <input type="checkbox"/> Owner <input type="checkbox"/> Town <input type="checkbox"/> State | |
| Name (last, first, MI) | 410 Riverside St., LLC <input checked="" type="checkbox"/> Owner <input type="checkbox"/> Applicant | The Subsurface Wastewater Disposal System shall not be installed until a Permit is issued by the Local Plumbing Inspector. This Permit shall authorize the owner or installer to install the disposal system in accordance with this application and the Maine Subsurface Wastewater Disposal Rules. | |
| Mailing Address of Owner/Applicant | | Municipal Tax Map # Lot # | |
| Daytime Tel. # | | OWNER OR APPLICANT STATEMENT I state and acknowledge that the information submitted is correct to the best of my knowledge and understand that any falsification is reason for the Department and/or Local Plumbing Inspector to deny a Permit. Signature of Owner or Applicant _____ Date _____ | |
| | | CAUTION: INSPECTION REQUIRED I have inspected the installation authorized above and found it to be in compliance with the Subsurface Wastewater Disposal Rules Application. Local Plumbing Inspector Signature _____ (1st) date approved _____ _____ (2nd) date approved _____ | |
| PERMIT INFORMATION | | | |
| TYPE OF APPLICATION <input type="checkbox"/> 1. First Time System <input checked="" type="checkbox"/> 2. Replacement System Type replaced: <u>Conc. Chamb.</u> Year installed: <u>1980s</u> <input type="checkbox"/> 3. Expanded System <input type="checkbox"/> a. <25% Expansion <input type="checkbox"/> b. >= 25% Expansion <input type="checkbox"/> 4. Experimental System <input type="checkbox"/> 5. Seasonal Conversion | THIS APPLICATION REQUIRES <input checked="" type="checkbox"/> 1. No Rule Variance <input type="checkbox"/> 2. First Time System Variance <input type="checkbox"/> a. Local Plumbing Inspector Approval <input type="checkbox"/> b. State & Local Plumbing Inspector <input type="checkbox"/> 3. Replacement System Variance <input type="checkbox"/> a. Local Plumbing Inspector Approval <input type="checkbox"/> b. State & Local Plumbing Inspector <input type="checkbox"/> 4. Minimum Lot Size Variance <input type="checkbox"/> 5. Seasonal Conversion Permit | DISPOSAL SYSTEM COMPONENTS <input type="checkbox"/> 1. Complete Non-engineered System <input type="checkbox"/> 2. Primitive System (graywater & aft. toilet) <input type="checkbox"/> 3. Alternative Toilet, specify _____ <input type="checkbox"/> 4. Non-engineered Treatment Tank (only) <input type="checkbox"/> 5. Holding Tank, _____ gallons <input checked="" type="checkbox"/> 6. Non-engineered Disposal Field (only) <input type="checkbox"/> 7. Separated Laundry System <input type="checkbox"/> 8. Complete Engineered System (2000 gpd or more) <input type="checkbox"/> 9. Engineered Treatment Tank (only) <input type="checkbox"/> 10. Engineered Disposal Field (only) <input type="checkbox"/> 11. Pre-treatment, specify _____ <input type="checkbox"/> 12. Miscellaneous Components | |
| SIZE OF PROPERTY 13 +/- <input type="checkbox"/> SQ. FT. <input checked="" type="checkbox"/> ACRES | DISPOSAL SYSTEM TO SERVE <input type="checkbox"/> 1. Single Family Dwelling Unit, No. of Bedrooms: _____ <input type="checkbox"/> 2. Multiple Family Dwelling, No. of Units: _____ <input checked="" type="checkbox"/> 3. Other: <u>2 Commercial Buildings</u> (specify) _____ Current Use: <input type="checkbox"/> Seasonal <input checked="" type="checkbox"/> Year Round <input type="checkbox"/> Undeveloped | TYPE OF WATER SUPPLY <input type="checkbox"/> 1. Drilled Well <input type="checkbox"/> 2. Dug Well <input type="checkbox"/> 3. Private <input checked="" type="checkbox"/> 4. Public <input type="checkbox"/> 5. Other | |
| SHORELAND ZONING <input type="checkbox"/> Yes <input checked="" type="checkbox"/> No | DESIGN DETAILS (SYSTEM LAYOUT SHOWN ON PAGE 3) | | |
| TREATMENT TANK <input checked="" type="checkbox"/> 1. Concrete <input type="checkbox"/> 2. Existing Septic Tanks <input checked="" type="checkbox"/> a. Regular <input type="checkbox"/> b. Low Profile <input type="checkbox"/> c. With Lift Stations <input type="checkbox"/> 2. Plastic <input type="checkbox"/> 3. Other CAPACITY: <u>Add 1,000 GAL</u> | DISPOSAL FIELD TYPE & SIZE <input type="checkbox"/> 1. Stone Bed <input type="checkbox"/> 2. Stone Trench <input checked="" type="checkbox"/> 3. Proprietary Device <input type="checkbox"/> a. cluster array <input type="checkbox"/> c. Linear <input checked="" type="checkbox"/> b. regular load <input type="checkbox"/> d. H-20 load <input type="checkbox"/> 4. Other: _____ SIZE: <u>See P 3</u> <input type="checkbox"/> sq. ft. <input type="checkbox"/> lin. ft. | GARBAGE DISPOSAL UNIT <input checked="" type="checkbox"/> 1. No <input type="checkbox"/> 2. Yes <input type="checkbox"/> 3. Maybe If Yes or Maybe, specify one below: <input type="checkbox"/> a. multi-compartment tank <input type="checkbox"/> b. _____ tanks in series <input type="checkbox"/> c. increase in tank capacity <input type="checkbox"/> d. Filter on Tank Outlet | DESIGN FLOW <u>1,094</u> gallons per day BASED ON: <input type="checkbox"/> 1. Table 4A (dwelling unit(s)) <input checked="" type="checkbox"/> 2. Table 4C (other facilities) SHOW CALCULATIONS — for other facilities — Big 51-57: 20 employees at 12 gpd/each Big 70: 40 employees at 20 gpd/each with showers <input type="checkbox"/> 3. Section 4G (meter readings) (With Shower) ATTACH WATER METER DATA |
| SOIL DATA PROFILE: <u>7</u> CONDITION: <u>C</u> at Observation Hole # <u>TB-2</u> Depth: <u>26"</u> of Most Limiting Soil Factor: <u>Groundwater</u> | DISPOSAL FIELD SIZING <input type="checkbox"/> 1. Medium—2.8 sq. ft. / gpd <input checked="" type="checkbox"/> 2. Medium—Large 3.3 sq. ft. / gpd <input type="checkbox"/> 3. Large—4.1 sq. ft. / gpd <input type="checkbox"/> 4. Extra Large—5.0 sq. ft. / gpd | EFFLUENT/EJECTOR PUMP <input type="checkbox"/> 1. Not Required <input type="checkbox"/> 2. May Be Required <input checked="" type="checkbox"/> 3. Required Specify only for engineered systems GPOE: _____ gallons | LATITUDE AND LONGITUDE at center of disposal area Lat. <u>N43</u> d. <u>41</u> m. <u>29.77</u> s Lon. <u>W70</u> d. <u>19</u> m. <u>44.26</u> s if g.p.s. state margin of error: <u>20'</u> |
| SITE EVALUATOR STATEMENT | | | |
| I certify that on <u>5-15-12</u> (date) I completed a site evaluation on this property and state that the data reported are accurate and that the proposed system is in compliance with the State of Maine Subsurface Wastewater Disposal Rules (10-144A CMR 241). | | | |
| <u>Richard A. Sweet</u> Site Evaluator Signature | | <u>034</u> SE # | <u>04-1-13</u> Date |
| Richard A. Sweet Site Evaluator Name Printed | | <u>797-2110</u> Telephone Number | <u>dick@sweetassociates.com</u> Email Address |
| Designed with SeptiCAD v3 | | Page 1 of 3 | |
| Note: Changes to or deviations from the design should be confirmed with the Site Evaluator. | | HHE-200 Rev. 2/11 | |

SUBSURFACE WASTEWATER DISPOSAL SYSTEM APPLICATION

Massachusetts Department of Health Services
Division of Health Engineering, Regulation 110
(801)383-5672 Fax: (508)383-5162

Town, City, Plantation: **Portland** Street, Road, Subdivision: **410 Riverside Street** Owner or Applicant Name: **410 Riverside St. LLC**

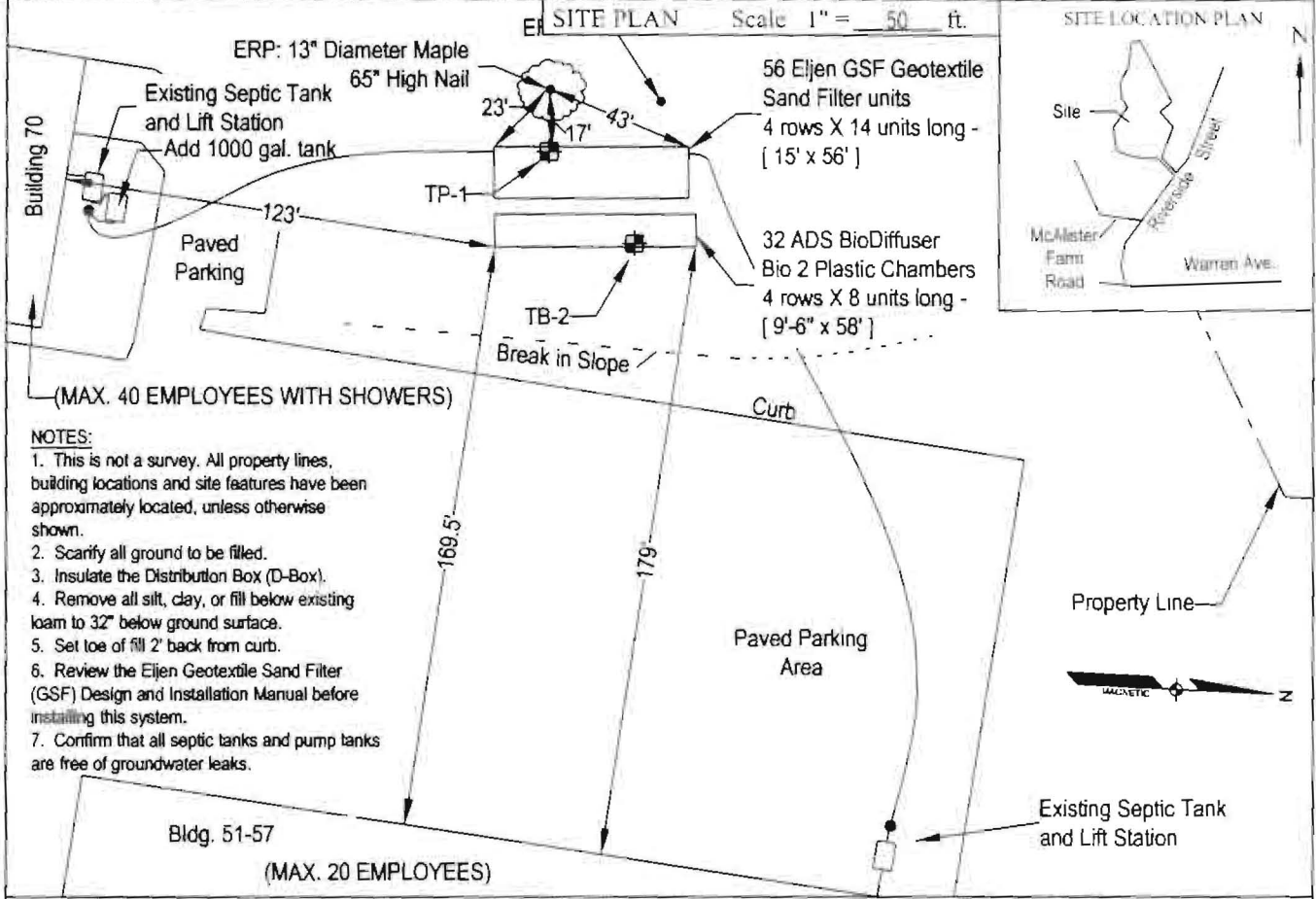

SOIL PROFILE DESCRIPTION AND CLASSIFICATION (Location of Observation Holes Shown Above)

| Observation Hole # | TP-1 | Test Pit | Boring | Observation Hole # | TB-2 | Test Pit | Boring |
|---|----------------------|----------|-------------------|---|------------------|----------|-----------------|
| Depth of organic horizon above mineral soil | | | | Depth of organic horizon above mineral soil | | | |
| Texture | Consistency | Color | Mottling | Texture | Consistency | Color | Mottling |
| 0 | | | | 0 | | | |
| 6 | Loam | Frable | Dark Brown | 6 | Sandy Loam | Frable | Dark Brown |
| 12 | Fine Sand | Loose | Light Brown | 12 | | | |
| 18 | | | | 18 | Sandy Loam | | Red/Brown |
| 24 | Stratified Sand/Silt | | Gray/Brown | 24 | | | Light Brown |
| 30 | | Firm | | 30 | Silty Sandy Loam | Firm | Gray |
| 36 | | | Common & Distinct | 36 | | | |
| 42 | | | | 42 | | | |
| 48 | | | | 48 | | | |
| Limit of Excavation at 36 inches | | | | | | | |
| Soil Profile | Classification | Slope | Limiting Factor | Soil Profile | Classification | Slope | Limiting Factor |
| 7 | C | 10 | 28" | 7 | C | 10 | 26" |
| Percent | Consistency | Percent | Depth | Percent | Consistency | Percent | Depth |

Richard O'Connell 034 04-1-13 Page 2 of 3
 Site Evaluator Signature SE # Date HHE-200 Rev. 2/11

SUBSURFACE WASTEWATER DISPOSAL SYSTEM APPLICATION

Maine Department of Human Services
Division of Health Engineering, Section 10
(207) 885-5673 Fax: (207) 885-6165

Town, City, Plantation
Portland

Street, Road, Subdivision
410 Riverside Street

Owner or Applicant Name
410 Riverside St., LLC

SUBSURFACE WASTEWATER DISPOSAL PLAN

Scale: 1" = 20' ft

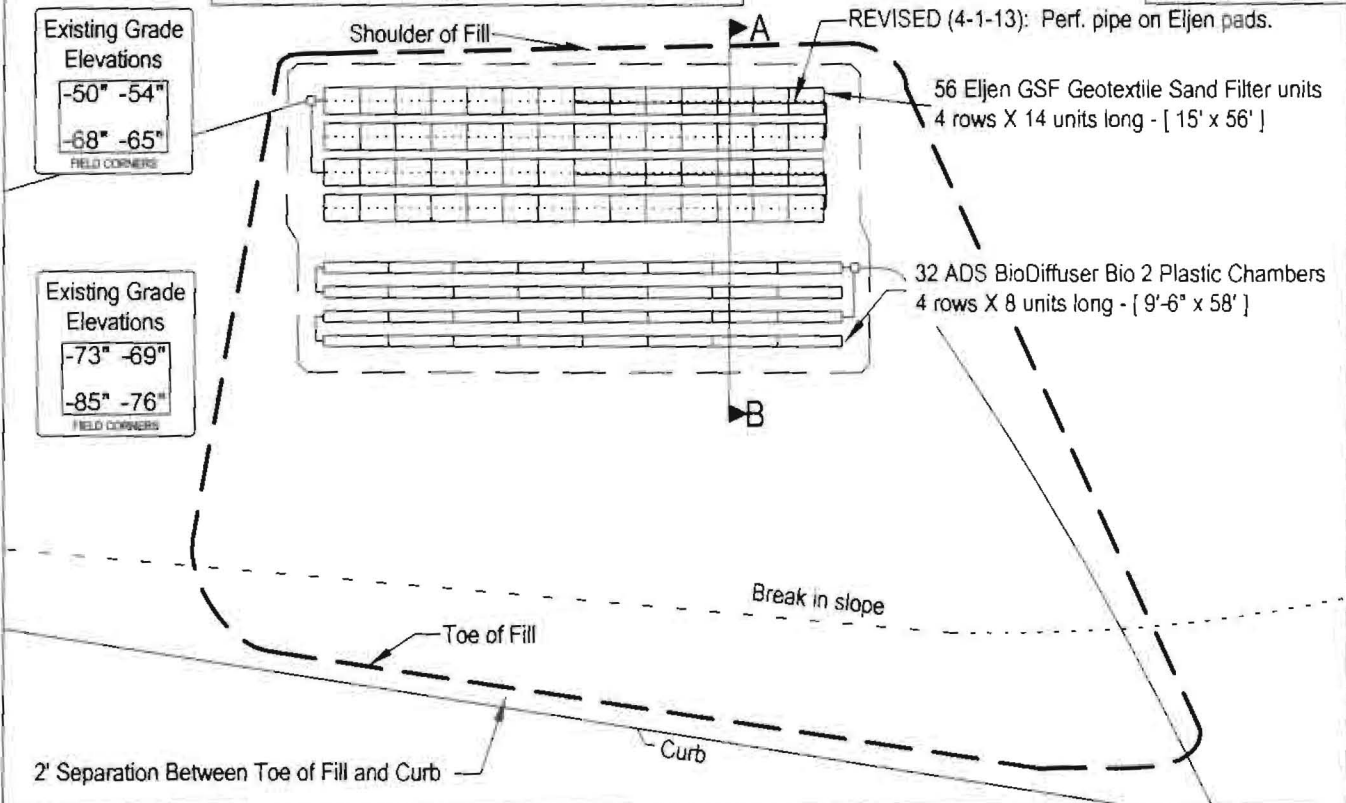

BACKFILL REQUIREMENTS

Depth of Backfill (upslope) 15-19"
Depth of Backfill (downslope) 7-16"

CONSTRUCTION ELEVATIONS

Finished Grade Elevation: (at Row 1) -35"
Top of Proprietary Device (at Row 1) -47"
Bottom of Disposal Field (at Row 1) -58"

ELEVATION REFERENCE POINT

Location & Description: 13" Diameter Maple
65" High Nail
Reference Elevation is 0.0' or:

DISPOSAL FIELD CROSS SECTION

NOTE: SCARIFY ALL GROUND SURFACE TO BE FILLED. USE GRAVELLY COARSE SAND WITHIN 3' OF ELJENS. REMAINING FILL: LOAMY SAND (no clay)

Scales:

Vertical: 1" = 5'
Horizontal: 1" = 5'

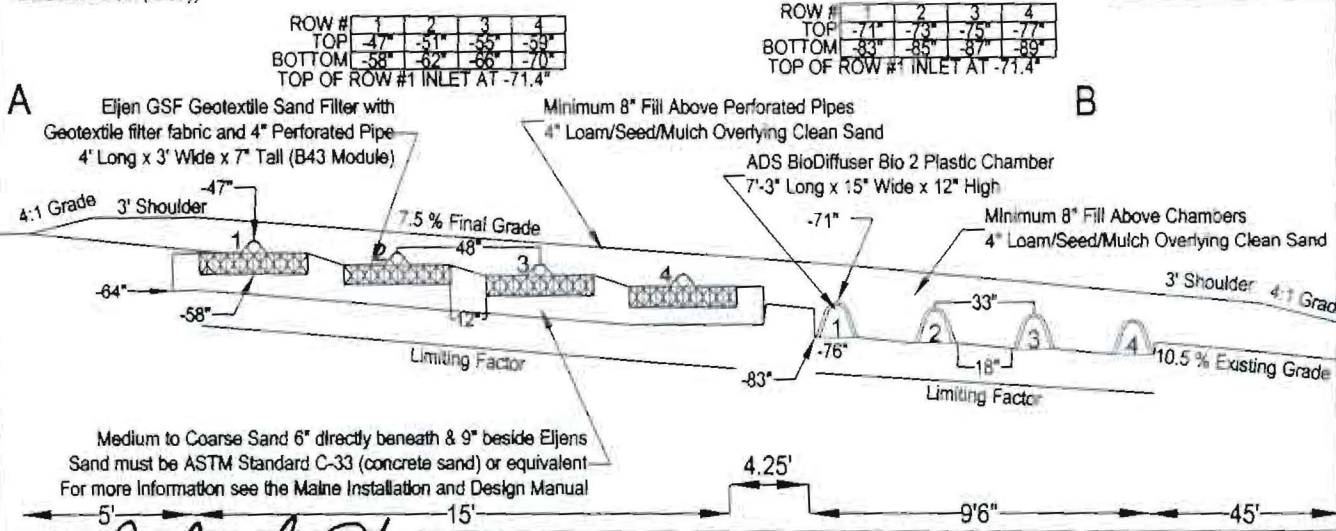

Richard O'Connell
Site Evaluator Signature

034
SE #

04-1-13
Date

Page 3 of 3
HHE-200 Rev. 2/11