

Location of Construction: 270 Riverside St		Owner: Tidy Up Carwash		Phone:		Permit No: 70092	
Owner Address:		Lessee/Buyer's Name:		Phone:		Business Name:	
Contractor Name: Sign Design		Address: 743 Broadway So. Bldg, ME		Phone: 04106 799-2000		<div style="border: 2px solid black; padding: 5px; text-align: center;"> <b>PERMIT ISSUED</b>                  Permit Issued:  <b>FEB - 6 1997</b>  <b>CITY OF PORTLAND</b> </div>	
Past Use: Gas Station		Proposed Use: Same		COST OF WORK: \$ _____ PERMIT FEE: \$ 65.00			
Proposed Project Description:  Erect Signage 200 Sq Ft UL #'s attached				FIRE DEPT. <input type="checkbox"/> Approved <input type="checkbox"/> Denied		INSPECTION: Use Group: Type:	
				Signature: _____		Signature: _____	
Permit Taken By: Mary Grook				Date Applied For: 28 January 1997			

1. This permit application does not preclude the Applicant(s) from meeting applicable State and Federal rules.
2. Building permits do not include plumbing, septic or electrical work.
3. Building permits are void if work is not started within six (6) months of the date of issuance. False information may invalidate a building permit and stop all work..

Zone: CBL: 316-B-008

Zoning Approval:

**Special Zone or Reviews:**

Shoreland  
 Wetland  
 Flood Zone  
 Subdivision  
 Site Plan maj  minor  mm

**Zoning Appeal**

Variance  
 Miscellaneous  
 Conditional Use  
 Interpretation  
 Approved  
 Denied

**Historic Preservation**

Not in District or Landmark  
 Does Not Require Review  
 Requires Review

**Action:**

Approved  
 Approved with Conditions  
 Denied

Date: 1/29/97

**CERTIFICATION**

I hereby certify that I am the owner of record of the named property, or that the proposed work is authorized by the owner of record and that I have been authorized by the owner to make this application as his authorized agent and I agree to conform to all applicable laws of this jurisdiction. In addition, if a permit for work described in the application is issued, I certify that the code official's authorized representative shall have the authority to enter all areas covered by such permit at any reasonable hour to enforce the provisions of the code(s) applicable to such permit

SIGNATURE OF APPLICANT: Eraa Hoyuinen ADDRESS: \_\_\_\_\_ DATE: 28 January 1997 PHONE: \_\_\_\_\_

RESPONSIBLE PERSON IN CHARGE OF WORK, TITLE \_\_\_\_\_ PHONE: \_\_\_\_\_

**PERMIT ISSUED WITH REQUIREMENTS**

**PERMIT ISSUED WITH REQUIREMENTS**

CEO DISTRICT 4

COMMENTS

4.23.98 Signage installed.

Inspection Record

Type	Date
Foundation: _____	_____
Framing: _____	_____
Plumbing: _____	_____
Final: _____	_____
Other: _____	_____

**City of Portland, Maine – Building or Use Permit Application** 389 Congress Street, 04101, Tel: (207) 874-8703, FAX: 874-8716

Location of Construction: 270 Riverside St		Owner: Tidy Up Carwash		Phone:		Permit No: 970092	
Owner Address:		Lessee/Buyer's Name:		Phone:		BusinessName:	
Contractor Name: Sign Design		Address: 743 Broadway So. Ptld, ME		Phone: 04106 799-2000		Permit Issued: FEB - 6 1997	
Past Use: Gas Station		Proposed Use: Same		COST OF WORK: \$		PERMIT FEE: \$ 65.00	
				FIRE DEPT. <input type="checkbox"/> Approved <input type="checkbox"/> Denied		INSPECTION: Use Group: Type:	
Proposed Project Description:  Erect Signage 200 Sq Ft UL #'s attached				Signature:		Signature:	
Permit Taken By: Mary Gresik		Date Applied For: 28 January 1997		PEDESTRIAN ACTIVITIES DISTRICT (P.A.D.) Action: Approved <input type="checkbox"/> Approved with Conditions: <input type="checkbox"/> Denied <input type="checkbox"/>		Zoning Approval: <i>ok with conditions</i> Special Zone or Reviews: <input type="checkbox"/> Shoreland <input type="checkbox"/> Wetland <input type="checkbox"/> Flood Zone <input type="checkbox"/> Subdivision <input type="checkbox"/> Site Plan maj <input type="checkbox"/> minor <input type="checkbox"/> mm <input type="checkbox"/>	
				Signature:		Date:	

**PERMIT ISSUED**  
FEB - 6 1997  
**CITY OF PORTLAND**

Zone: **B-4** CBL: 316-B-008  
Zoning Approval: *ok with conditions*  
Special Zone or Reviews:  
 Shoreland  
 Wetland  
 Flood Zone  
 Subdivision  
 Site Plan maj  minor  mm

**Zoning Appeal**  
 Variance  
 Miscellaneous  
 Conditional Use  
 Interpretation  
 Approved  
 Denied

**Historic Preservation**  
 Not in District or Landmark  
 Does Not Require Review  
 Requires Review

Action:  
 Approved  
 Approved with Conditions  
 Denied

Date: 1/29/97

*D. Andrews*

CEO DISTRICT **4**

*A. Powis*

1. This permit application does not preclude the Applicant(s) from meeting applicable State and Federal rules.
2. Building permits do not include plumbing, septic or electrical work.
3. Building permits are void if work is not started within six (6) months of the date of issuance. False information may invalidate a building permit and stop all work..

**PERMIT ISSUED WITH REQUIREMENTS**

**CERTIFICATION**

I hereby certify that I am the owner of record of the named property, or that the proposed work is authorized by the owner of record and that I have been authorized by the owner to make this application as his authorized agent and I agree to conform to all applicable laws of this jurisdiction. In addition, if a permit for work described in the application is issued, I certify that the code official's authorized representative shall have the authority to enter all areas covered by such permit at any reasonable hour to enforce the provisions of the code(s) applicable to such permit

SIGNATURE OF APPLICANT *Eric A. Moynihan* ADDRESS: \_\_\_\_\_ DATE: 28 January 1997 PHONE: \_\_\_\_\_

RESPONSIBLE PERSON IN CHARGE OF WORK, TITLE \_\_\_\_\_ PHONE: \_\_\_\_\_

LAND USE - ZONING REPORT

ADDRESS: 270 Riverside Street DATE: 2/5/97

REASON FOR PERMIT: Signage for gas station

BUILDING OWNER: Tidy up CARWASH C-B-L: 316-B-008

PERMIT APPLICANT: ERIC Moynihan

APPROVED: With conditions DENIED: \_\_\_\_\_  
#9 & #10

CONDITION(S) OF APPROVAL

1. During its existence, all aspects of the Home Occupation criteria, Section 14-410, shall be maintained.
2. The footprint of the existing \_\_\_\_\_ shall not be increased during maintenance reconstruction.
3. All the conditions placed on the original, previously approved, permit issued on \_\_\_\_\_ are still in effect for this amendment.
4. Your present structure is legally nonconforming as to rear and side setbacks. If you were to demolish the building on your own volition, you will not be able to maintain these same setbacks. Instead you would need to meet the zoning setbacks set forth in today's ordinances. In order to preserve these legally non-conforming setbacks, you may only rebuild the garage in place and in phases.
5. This property shall remain a single family dwelling. Any change of use shall require a separate permit application for review and approval.
6. Our records indicate that this property has a legal use of \_\_\_\_\_ units. Any change in this approved use shall require a separate permit application for review and approval.
7. Separate permits shall be required for any signage.
8. Separate permits shall be required for future decks and/or garage.
9. Other requirements of condition That The canopy signs be reduced from

3 to 2 signs at a size of 33" x 80" each.

10 That the individual building signs (individual letters) be no more than 12" x 161" for the "Stop & Shoppe" signage and no more than 12" x 101" for the "Food Mart" signage.

Marge Schmuckal Marge Schmuckal, Zoning Administrator,  
Asst. Chief of Code Enforcement

3/21/95

UL NUMBERS

AX - 790860

AX - 790861

AX - 790862

AX - 790863

AX - 790864

SIGNAGE APPLICATION

ADDRESS: 270 RIVERSIDE ST.

OWNER: TIDY UP CAR WASH / STOP + SHOPPE

APPLICANT: ~~FOOD~~ SIGN DESIGN INC

ASSESSORS NO.:

SINGLE TENANT LOT? YES:  NO:

MULTI-TENANT LOT? YES:  NO:

FREESTANDING SIGN? YES:  NO:

MORE THAN ONE SIGN? YES:  NO:

BLDG. WALL SIGN? YES:  NO:

MORE THAN ONE SIGN? YES:  NO:

DIMENSIONS: SEE ATTACHED

DIMENSIONS: "

DIMENSIONS: "

DIMENSIONS: "

LIST ALL EXISTING SIGNAGE, INCLUDING THEIR DIMENSIONS:

NONE EXISTING

See figures on drawings

LOT FRONTAGE (IN FEET): RIVERSIDE = 154' WARREN AVE 192'

BLDG FRONTAGE (IN FEET): RIVERSIDE 60' WARREN AVE 32'

AWNING? YES:  NO:  IS AWNING BACKLIT? YES:  NO:

HEIGHT OF AWNING:

IS THERE ANY COMM. MESSAGE, TRADEMARK, OR SYMBOL ON IT?

PLEASE PROVIDE A SITE SKETCH AND A BUILDING SKETCH, SHOWING EXACTLY WHERE EXISTING AND NEW SIGNAGE IS LOCATED.

WE WILL NEED SKETCHES AND/OR PICTURES OF THE PROPOSED SIGNS INCLUDING STRUCTURAL COMPONENTS.

SIGNAGE

PLEASE ANSWER ALL QUESTIONS

ADDRESS: 270 Riverside Ave ZONE: B-4

OWNER: Tidy-Up Car Wash Inc.

APPLICANT: Sign Design Inc.

ASSESSOR NO.: \_\_\_\_\_

SINGLE TENANT LOT? YES  NO \_\_\_\_\_

MULTI TENANT LOT? YES \_\_\_\_\_ NO

FREESTANDING SIGN? YES  NO \_\_\_\_\_ DIMENSIONS See Attached

MORE THAN ONE SIGN? YES  NO \_\_\_\_\_ DIMENSIONS \_\_\_\_\_

BLDG. WALL SIGN? YES  NO \_\_\_\_\_ DIMENSIONS \_\_\_\_\_  
(attached to bldg)

MORE THAN ONE SIGN? YES  NO \_\_\_\_\_ DIMENSIONS \_\_\_\_\_

LIST ALL EXISTING SIGNAGE AND THEIR DIMENSIONS: See Attached

LOT FRONTAGE (FEET) Riverside 154' Warren Ave 192'

BLDG FRONTAGE (FEET) '' 60' '' 32'

AWNING YES \_\_\_\_\_ NO  IS AWNING BACKLIT? YES \_\_\_\_\_ NO \_\_\_\_\_

HEIGHT OF AWNING: \_\_\_\_\_

IS THERE ANY COMMUNICATION, MESSAGE, TRADEMARK OR SYMBOL ON IT? \_\_\_\_\_

A SITE SKETCH AND BUILDING SKETCH SHOWING EXACTLY WHERE EXISTING AND NEW

SIGNAGE IS LOCATED MUST BE PROVIDED. SKETCHES AND/OR PICTURES OF THE

PROPOSED SIGNS ARE ALSO REQUIRED.

INFORMATION REQUIREMENTS FOR SIGN PERMIT APPLICATION

APPLICANTS FOR A SIGN PERMIT WILL BE ASKED TO SUBMIT THE FOLLOWING INFORMATION TO THE CODE ENFORCEMENT OFFICE:

1. PROOF OF INSURANCE
2. LETTER OF PERMISSION FROM THE OWNER
3. A SKETCH PLAN OF THE LOT, INDICATING LOCATION OF BUILDINGS, DRIVEWAYS AND ANY ABUTTING STREETS OR RIGHT OF WAYS. LENGTHS OF BUILDING FRONTAGES AND STREET FRONTAGES SHOULD BE NOTED (SEE ATTACHED)
4. INDICATE ON THE PLAN ALL EXISTING AND PROPOSED SIGNS
5. COMPUTATION OF THE FOLLOWING:
  - A) SIGN AREA OF EACH EXISTING AND PROPOSED BUILDING SIGN
  - B) SIGN AREA HEIGHT AND SETBACK OF EACH EXISTING AND PROPOSED FREESTANDING SIGN

A SKETCH OF ANY PROPOSED SIGN(S), INDICATING DIMENSIONS, MATERIALS, SOURCE OF ILLUMINATION AND CONSTRUCTION METHOD (SEE ATTACHED)

FEE FOR PERMIT - \$25.00 PLUS \$0.20 PER SQUARE FOOT

NOTE: ONCE A SKETCH PLAN HAS BEEN FILED FOR A PROPERTY, THE CODE ENFORCEMENT OFFICE WILL KEEP A RECORD OF THE PLAN SO THAT A NEW SKETCH PLAN WILL NOT BE REQUIRED FOR LATER CHANGES TO SIGNAGE ON THE PROPERTY. IN SUCH AN INSTANCE, APPLICANTS WILL ONLY BE REQUIRED TO SUBMIT INFORMATION APPLICABLE TO THE NEW SIGNS.

Need figures 2/5/97  
 per Roger F.  
 799-2000

Allowed on Bldg 30# for principal Bldg  
 10# for each Add. major activity  
 Gas Station

(2 signs) 12" x 161" = 13.42# ea  
 (2 signs) 12" x 101" = 8.42# ea  
 21.84# x 2 = 43.68#

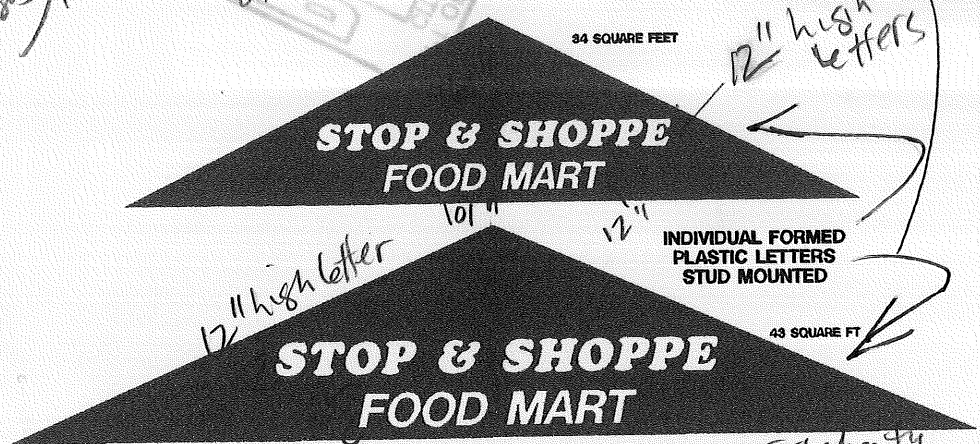

oking since  
 These are individual  
 letters & there are  
 spaces between words  
 60# max  
 36# show

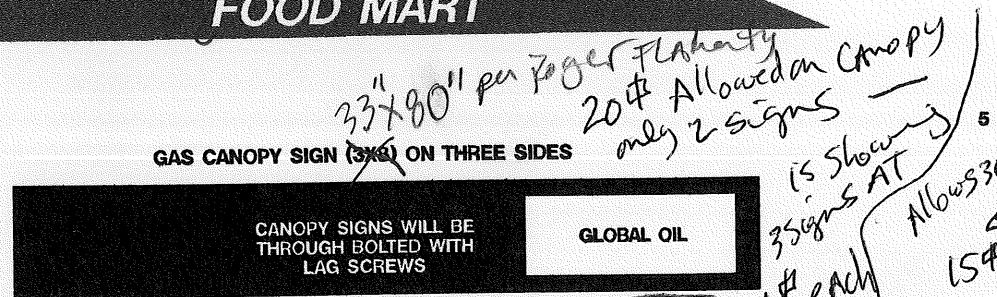
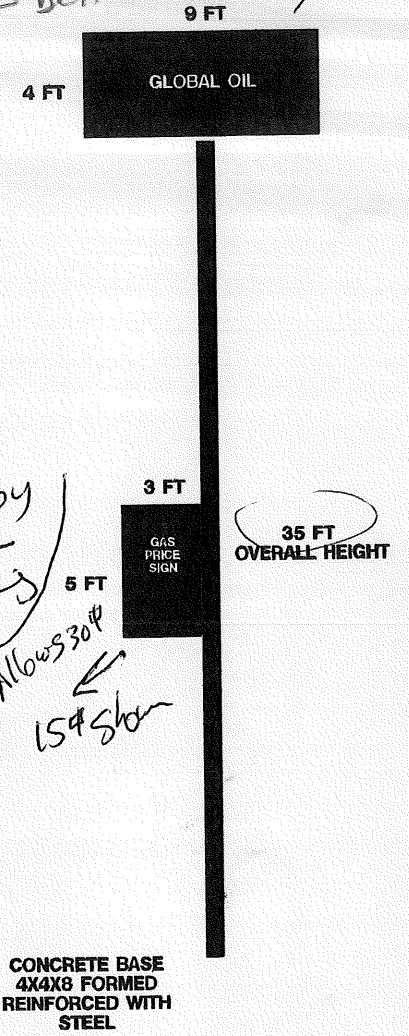

2.75 x 666 = 18.32# ea  
 15#  
 20# Allowed on the canopy  
 is showing 35 signs AT  
 Allows 30#  
 15# show

TOTAL SIGNAGE 200 SQUARE FT

2/5/97 Roger Flaherty  
 will only do 2 signs  
 not 3  
 shall be 5' back  
 from lot lines



OWNERS CONSENT AND AGREEMENT

I, Todd Flanagan, being the owner of the premises located at  
(print property owners name)

270 Riverside St. in Portland, Maine, hereby give consent to the  
(print property address)

erection of a certain sign/awning/banner owned by Stoppa + Shepp  
(print lessee's name)

over the sidewalk or on building from said premises as described in  
application to the Division of Inspection Services.

And in consideration of the issuance of said permit, owner of said premises,  
in event said sign shall cease to serve the purpose for which it was erected  
or shall become dangerous and in event the owner of said sign shall fail to  
remove said sign or make it permanently safe in case the sign still serves  
the purpose for which it was erected, hereby agrees for himself or itself,  
for his heirs, its successors, and his or its assigns, to completely remove  
said sign.

  
\_\_\_\_\_  
Signature of Property Owner

1/29/97  
\_\_\_\_\_  
Date

  
\_\_\_\_\_  
Signature of Lessee

1/28/97  
\_\_\_\_\_  
Date

# NATIONWIDE INSURANCE

RECEIVED  
 JAN 27 1997  
 10:52 AM '91

It is to be understood that the insurance afforded by the policies or portions hereinafter described is not intended to provide coverage in excess of the actual cash value of the property insured. The actual cash value of the property insured shall be determined in accordance with the terms and conditions of the policies. Coverage contained in any policy shall be subject to the terms and conditions of the policy.

TYPE OF INSURANCE	POLICY NUMBER	POLICY	POLICY	LIMITS OF LIABILITY
LIABILITY	ISSUING CO.	EFF. DATE	EXP. DATE	(LIMITS AT INCEPTION)
<input checked="" type="checkbox"/> (A) Liability and Medical Expense	17-PR-270757-3001	NATIONWIDE	10-17-96	Any One Occurrence \$ 1,000,000
<input checked="" type="checkbox"/> (B) Personal and Advertising Injury		NATIONWIDE		Any One Person/Or \$ 1,000,000
<input checked="" type="checkbox"/> (C) Medical Expenses		NATIONWIDE		ANY ONE PERSON \$ 5,000
<input checked="" type="checkbox"/> (D) Fire Legal		NATIONWIDE		Any One Fire or Explosion \$ 50,000
<input type="checkbox"/> (E) Auto Liability		NATIONWIDE		General Aggregate \$ 1,000,000
<input type="checkbox"/> (F) Commercial Liability		NATIONWIDE		Prod/Comp Ops Aggregate \$ 1,000,000
<input type="checkbox"/> (G) Contract Liability		NATIONWIDE		Bodily Injury (Each Person) \$ 1,000,000
<input type="checkbox"/> (H) Professional Liability		NATIONWIDE		(Each Accident) \$ 1,000,000
<input type="checkbox"/> (I) Non-Owned		NATIONWIDE		Property Damage (Each Accident) \$ 1,000,000
<input type="checkbox"/> (J) Auto Liability		NATIONWIDE		Combined Single Limit \$ 1,000,000
<input type="checkbox"/> (K) Umbrella Form		NATIONWIDE		Each Occurrence \$ 1,000,000
<input type="checkbox"/> (L) Workers Compensation		NATIONWIDE		Prod/Comp Ops/Disease Aggregate \$ 1,000,000
<input type="checkbox"/> (M) Employers Liability		NATIONWIDE		STATUTORY LIMITS
		NATIONWIDE		BODILY INJURY/ACCIDENT \$ 1,000,000
		NATIONWIDE		Bodily Injury by Disease EACH EMPLOYEE \$ 500,000
		NATIONWIDE		Bodily Injury by Disease EACH EMPLOYEE \$ 500,000

Should any of the above described policies be cancelled before the expiration date, the insurance company will endeavor to mail written notice to the above named certificate holder, but failure to mail such notice shall impose no obligation or liability upon this company, its agents, or representatives.

DESCRIPTION OF OPERATIONS/LOCATIONS  
 VEHICLES/RESTRICTIONS/SPECIAL ITEMS  
 500000 REPLACEMENT COST COV ON  
 273 RIVERSIDE ST PORTLAND, ME  
 50000 CONTENTS COVERAGE

Effective Date of Certificate: 10-17-1996  
 Date Certificate Issued: 01-27-1997

Authorized Representative: PHILIP W. O'NEARH  
 Countersigned at: NATIONWIDE INSURANCE  
 1087 FOREST AVE PORTLAND



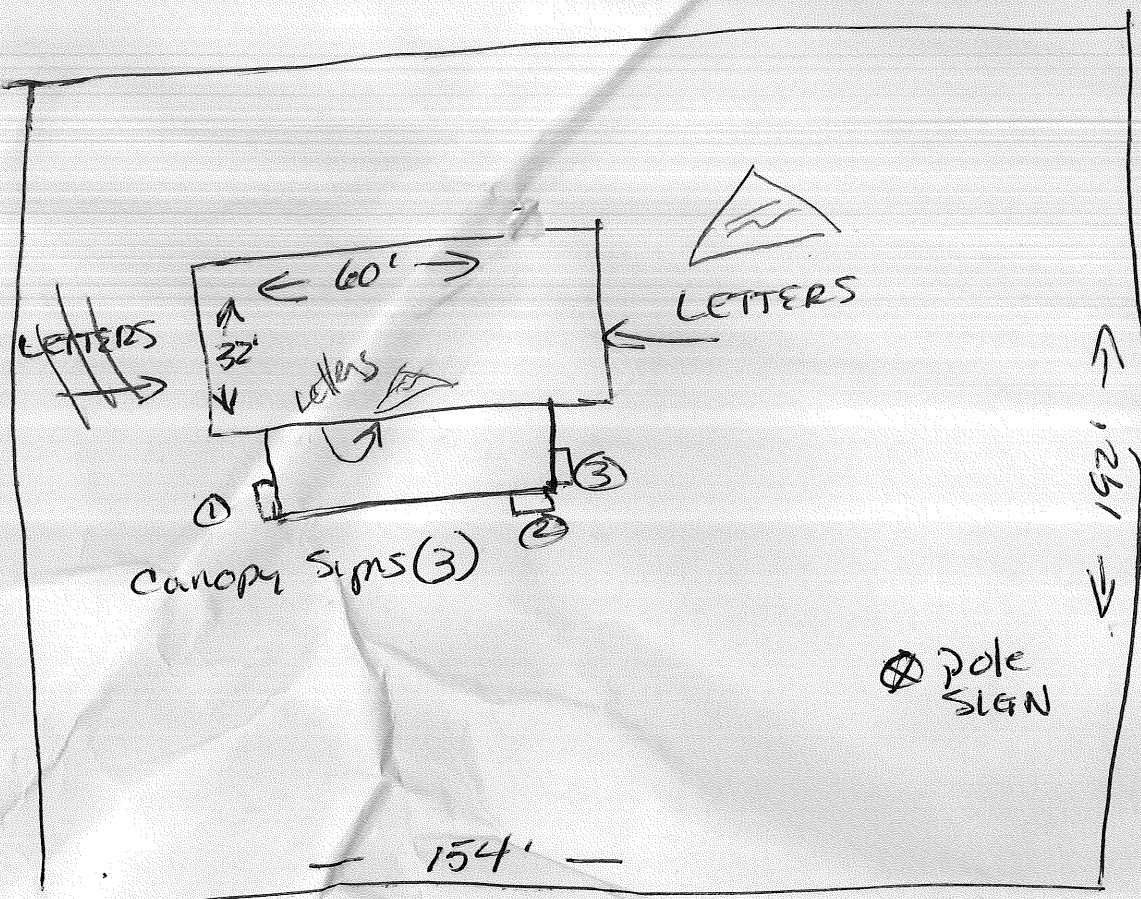

Canopy Signs (3)

⊗ pole sign

154'

192'

WARREN AVE.

RIVERSIDE

