

Revisions:

arkinetics
architects + urbanists
 Architecture - Planning - Interiors - Preservation - Urban Design
 www.arkinetics.com
 Lorain Office
 201 1/2 Fifth Street
 Lorain, OH 44052
 P: 440.246.3100
 F: 440.246.5017
 Cleveland Office
 3723 Pearl Road
 Cleveland, OH 44109
 P: 216.749.7800
 F: 216.749.1300

Project:

A Renovation For:
Irving Oil Marketing
 Store #7017
 270 Riverside Street
 Portland, ME 04103-1040

arkinetics Project #: 12025.07

Drawing Title
 DEMOLITION PLAN

Date of Issue:
 Plan Review 08/28/12

© arkinetics
 Sheet #:

D-101

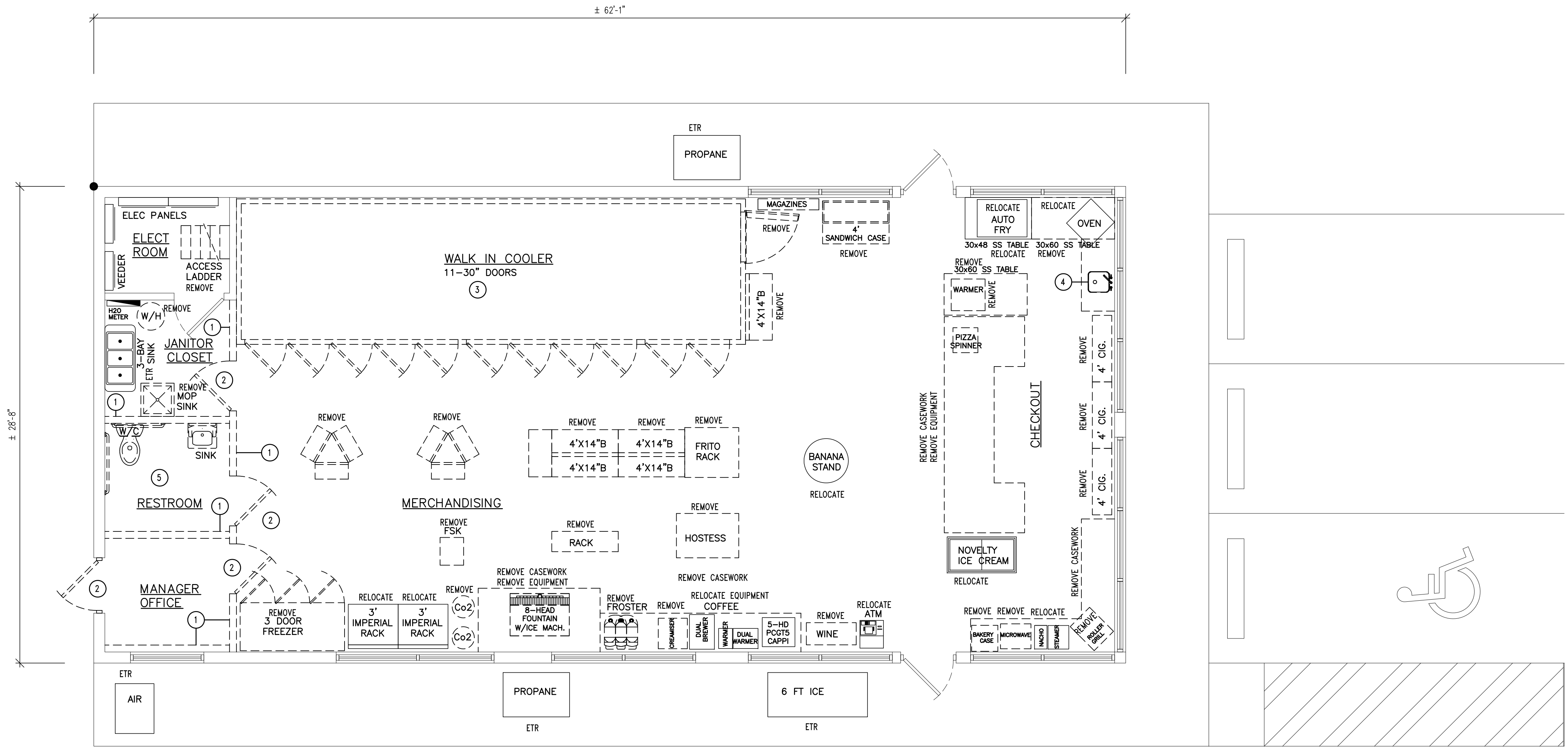

- GENERAL DEMOLITION NOTES:**
1. FIELD VERIFY EXISTING CONDITIONS/DIMENSIONS PRIOR TO START OF WORK.
 2. PROVIDE DEMOLITION AS INDICATED ON DRAWINGS AND AS REQUIRED TO COMPLETE THE WORK SHOWN.
 3. DEMOLITION DIMENSIONS ARE TO BE FIELD VERIFIED AND COORDINATED WITH FLOOR PLAN INFORMATION.
 4. PROVIDE CUTTING AND PATCHING OF EXISTING WALLS, FLOORS & CEILINGS AS REQUIRED TO ACCOMMODATE NEW LAYOUT. PATCH TO MATCH EXISTING ADJACENT WALLS, FLOORS & CEILINGS FOR SMOOTH EVEN APPEARANCE, UNLESS OTHERWISE NOTED.
 5. PROVIDE SHORING/BRACING AS REQUIRED AT AREAS OF DEMOLITION. STRUCTURE SHALL BE SELF SUPPORTING AFTER DEMOLITION IS COMPLETE.
 6. COORDINATE EXTENT AND DISPOSITION OF ALL RELOCATED/SALVAGEABLE ITEMS WITH OWNER.
 7. COORDINATE ASPECTS OF DEMOLITION PLAN WITH NEW FLOOR AND REFLECTED CEILING PLANS, AND ELECTRICAL, MECHANICAL AND PLUMBING DWGS.
 8. REQUIRED MEANS OF EGRESS SHALL BE MAINTAINED DURING CONSTRUCTION AND RENOVATION TO THE BUILDING.
 9. EXISTING FIRE DEPARTMENT VEHICLE ACCESS WILL BE MAINTAINED DURING CONSTRUCTION.

DEMOLITION PLAN
 1/4" = 1'-0"

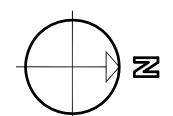

- DEMOLITION PLAN NOTES:**
- 1 REMOVE INTERIOR WALL
 - 2 REMOVE DOOR AND FRAME
 - 3 REMOVE COOLER AND DOORS
 - 4 REMOVE PLUMBING FIXTURE
 - 5 REMOVE PLUMBING FIXTURES AND TOILET ROOM ACCESSORIES