

1-7
ANY INC.

PARCEL 316-B-10
NF
BLOUIN REALTY INC.
6345/205
"FOREST CITY CHEVROLET"

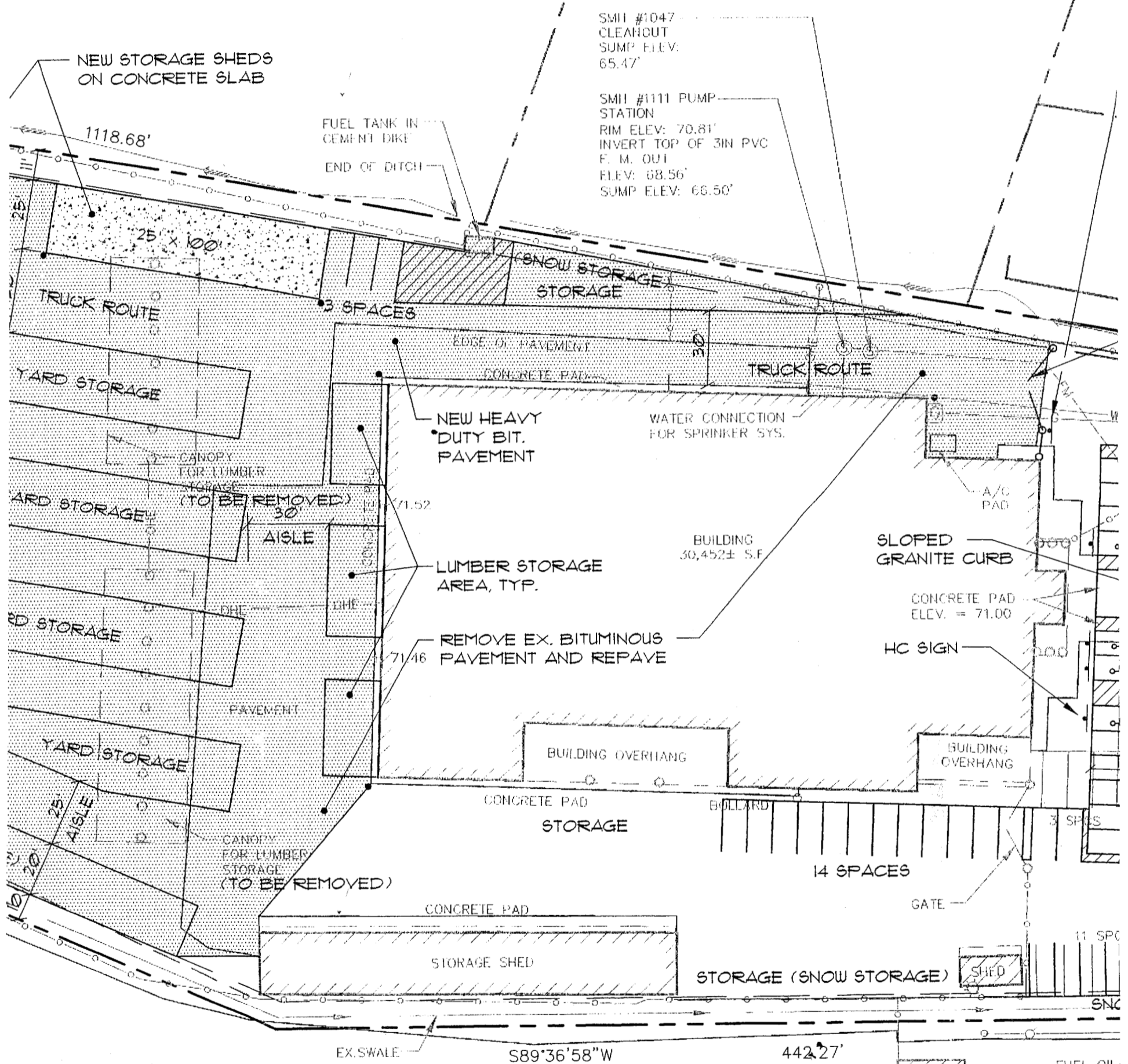

PARCEL 316-B-4
NF
RIVERSIDE CORP.
9255/231
"MADAWASKA LANDSCAPE STONE CO."

RETAIN EXIS
FEDESTAL

EXISTING TOOLS &
HARDWARE AREA

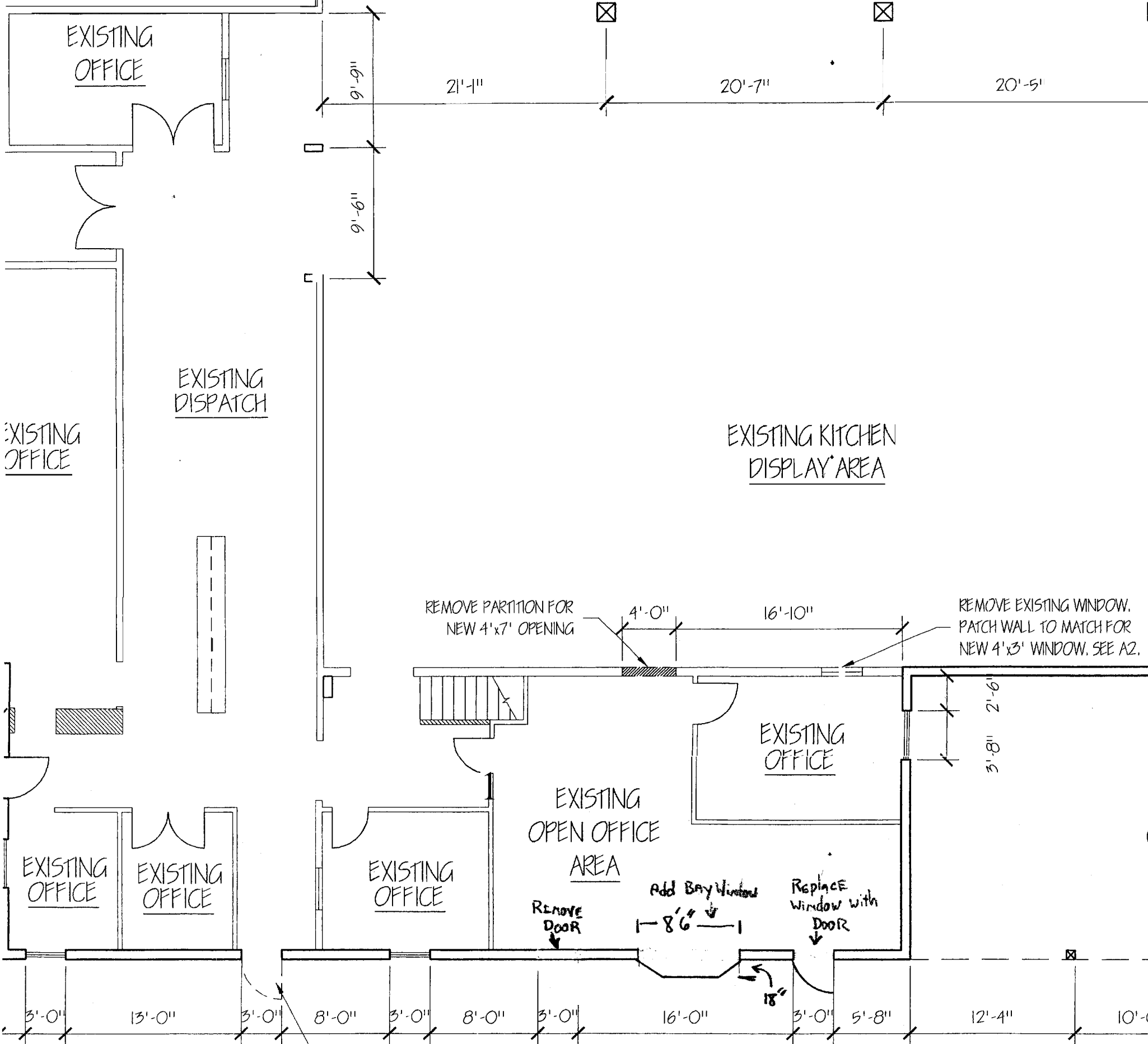

REMOVE EXISTING DOOR
AND FRAME

LOCATION PLAN



LEGEND

	EXISTING WALL
	WALL TO BE REMOVED
	INFILL WALL

108	F	3070	1 3/4	NO	HW-7	NO	NONE	NONE	HM	NO	DW	1-A5	1-A5
109	F	3070	1 3/4	NO	HW-4	NO	NONE	NONE	HM	NO	DW	1-A5	1-A5
110	A	3070PR	1 3/4	NO	HW-8	NO	NONE	NONE	HM	NO	DW	1-A5	1-A5
111	F	3070	1 3/4	NO	HW-4	NO	NONE	NONE	HM	NO	DW	1-A5	1-A5
112	F	3070	1 3/4	NO	HW-2	NO	NONE	NONE	HM	NO	DW	1-A5	1-A5
113	E	3070	1 3/4	NO	HW-6	NO	NONE	NONE	HM	NO	DW	1-A5	1-A5
114	F	3070	1 3/4	NO	HW-1	NO	NONE	NONE	HM	NO	DW	1-A5	1-A5
E										EXISTING			

TRANSPARENT
FINISH S.C.
WOOD BIFOLD
DOORS

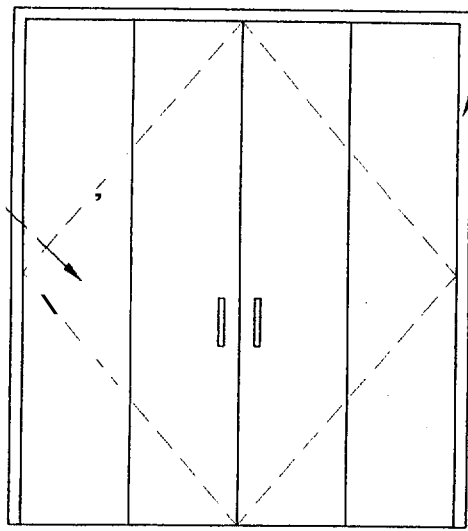

(A) TRANSPARENT FINISH
S.C. WOOD VENEER

PAINTED HOLLOW
METAL FRAME

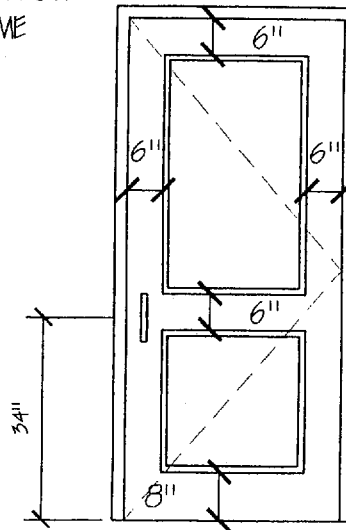

(B) ALUMINUM
STOREFRONT

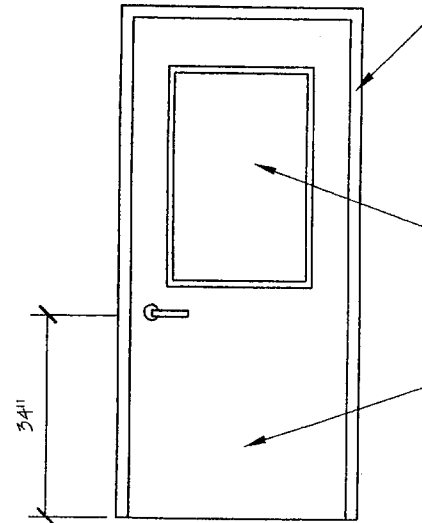

(C) PAINTED
HOLLOW METAL

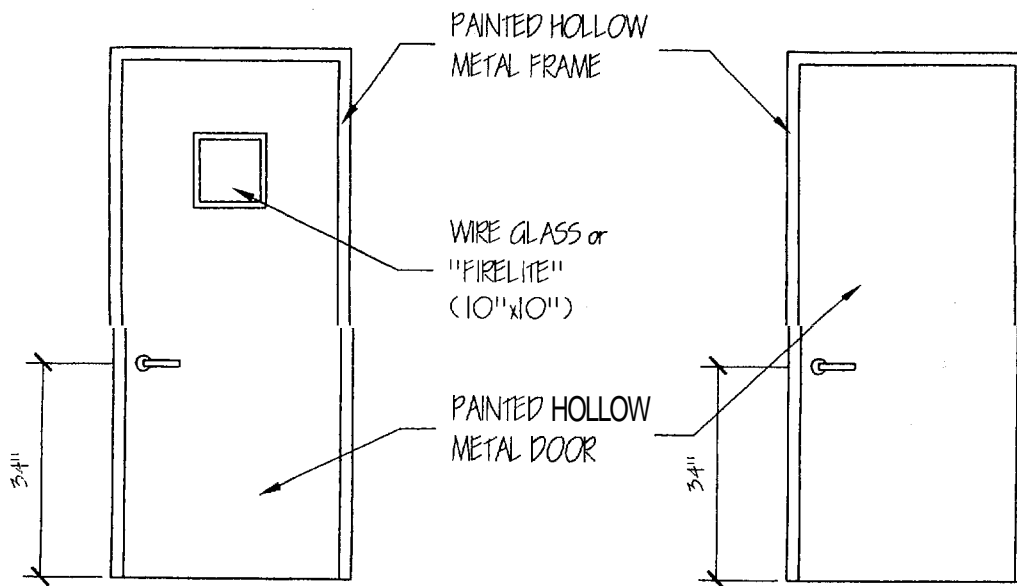

(D) PAINTED
HOLLOW METAL

(E) PAINTED
HOLLOW METAL

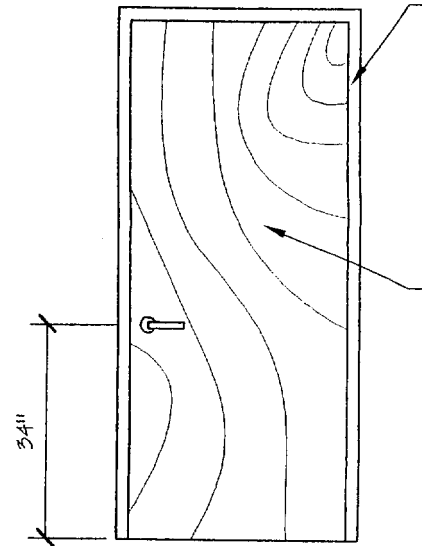

(F) TRANSPARENT FINISH S.C.
WOOD VENEER

PTD
METAL
FRAME

PTD
METAL
SECTIONAL
PANELS

TEMPERED
INSULATED
GLASS

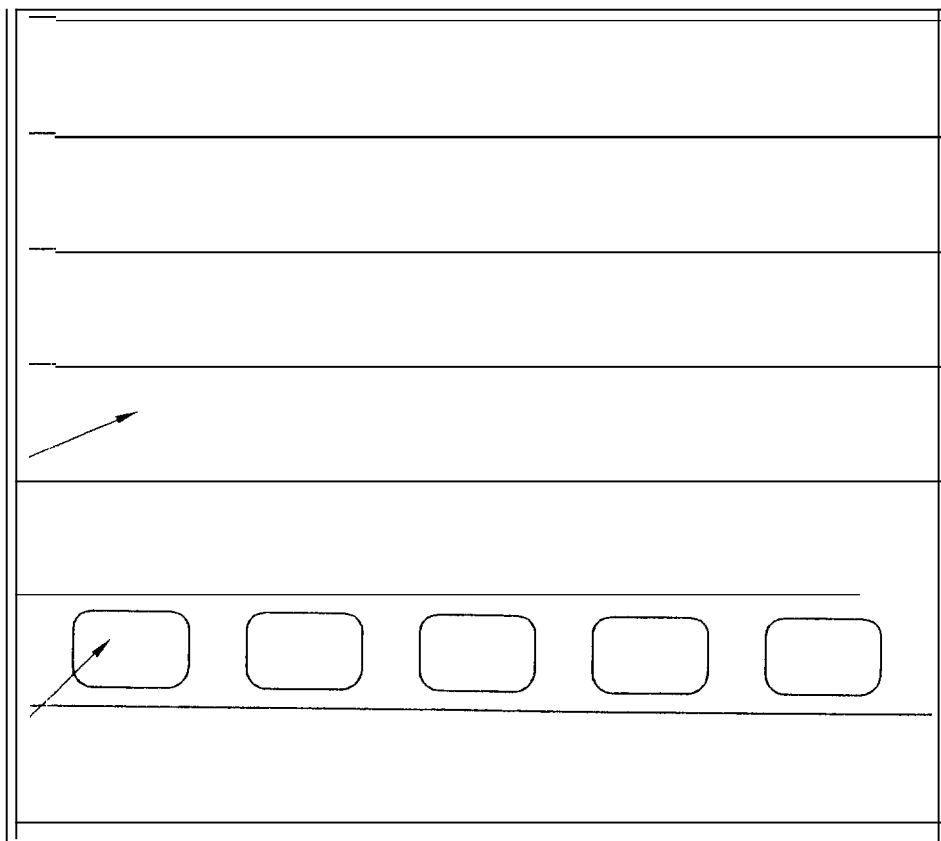

PTD
METAL
FRAME

PTD
METAL
SECTIONAL
PANELS

TEMPERED
INSULATED
GLASS

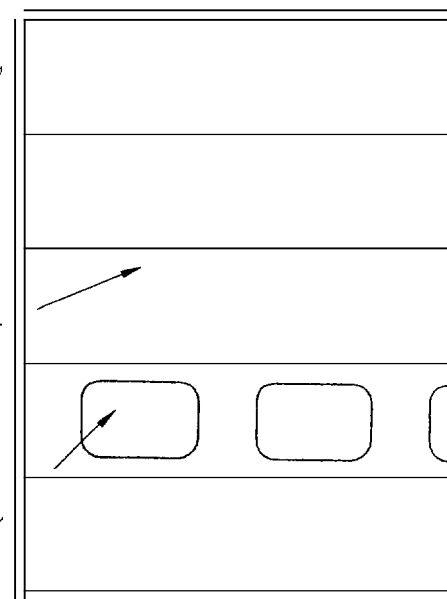

6000 SERIES

Vinyl Casement Bay & Bow Window

6000 SERIES CASEMENT BOW WINDOW

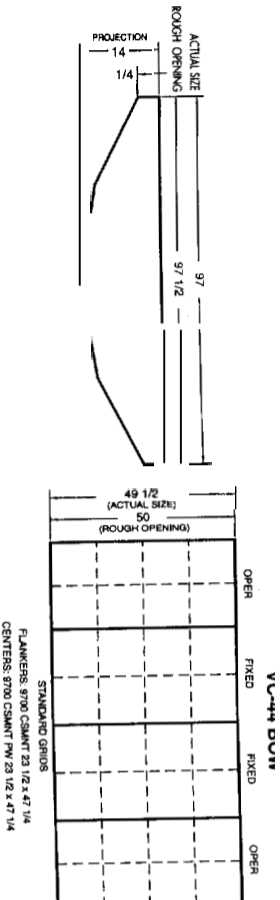
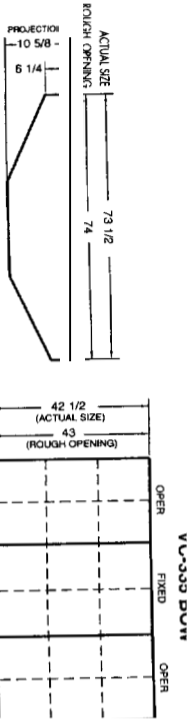

6000 SERIES CASEMENT 30° BAY WINDOW

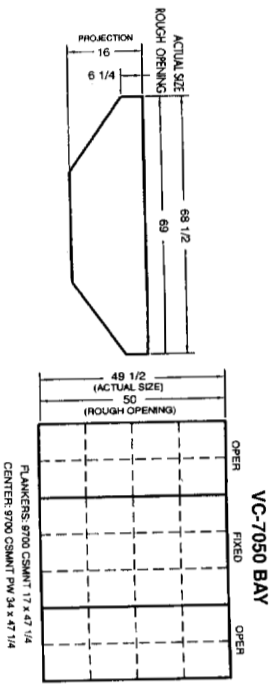
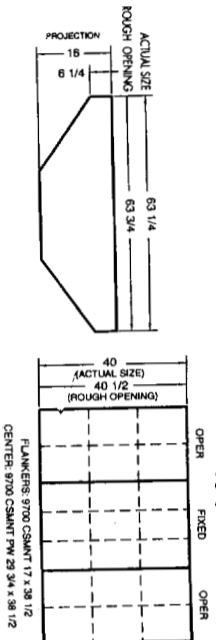

All VDH series units have 5/4" birch laminated plywood head and seat board
 All VC series units (except VC335 & VC6440) have 5/4" birch laminated plywood head and seat board
 VC335 and VC6440 units have 3/4" birch laminated plywood head and seat board
 All VSH series units have 3/4" birch laminated plywood head and seat board

6000 SERIES SINGLE HUNG 45° BAY WINDOW

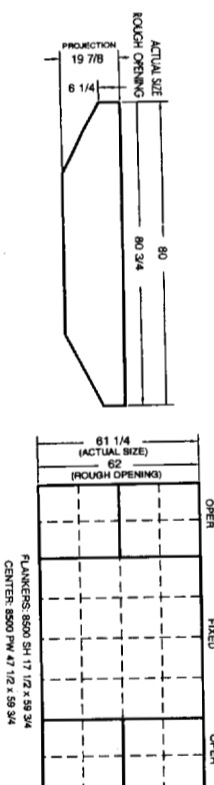
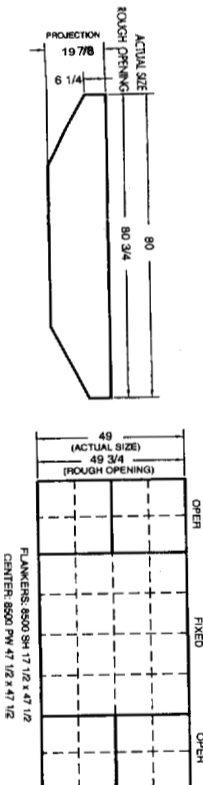
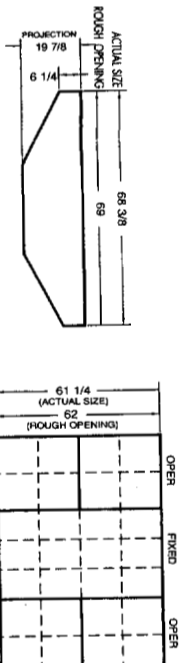
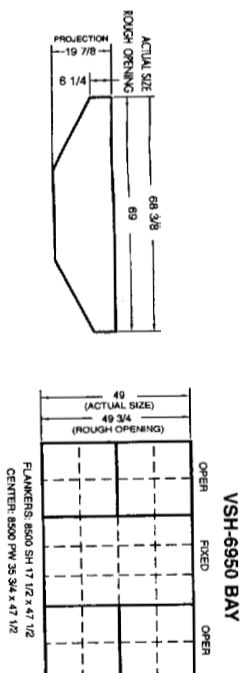

6000 SERIES DOUBLE HUNG 45° BAY WINDOW

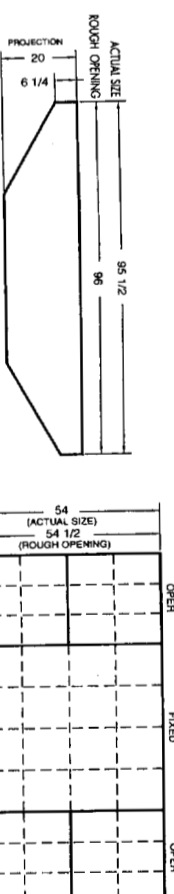
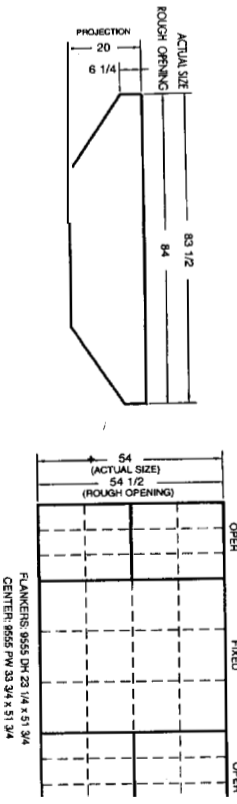

All VDH, VSH, and VC series units are made standard with 6 1/4" side jambs (for use in typical 2x4 framing with 1/2" sheathing and 1/2" drywall)
 8 1/4" side jambs are optional (for use in typical 2x6 framing with 1/2" sheathing and 1/2" drywall) and will increase listed projections by 2"
 Projections shown are measured from extreme inside of unit to extreme outside of unit and are based on standard 6 1/4" side jambs
 To calculate distance window projects on exterior of house, subtract overall wall thickness from overall window projection