

SUBSURFACE WASTEWATER DISPOSAL SYSTEM APPLICATION		Maine Dept. of Health & Human Services Division of Environmental Health, 11 SHS (207) 287-5672 Fax: (207) 287-4172
Town, City, Plantation PORTLAND	Street, Road, Subdivision 739 WARREN AVE	Owner or Applicant Name DOWNEAST VETERINARY EMERGENCY CLINIC

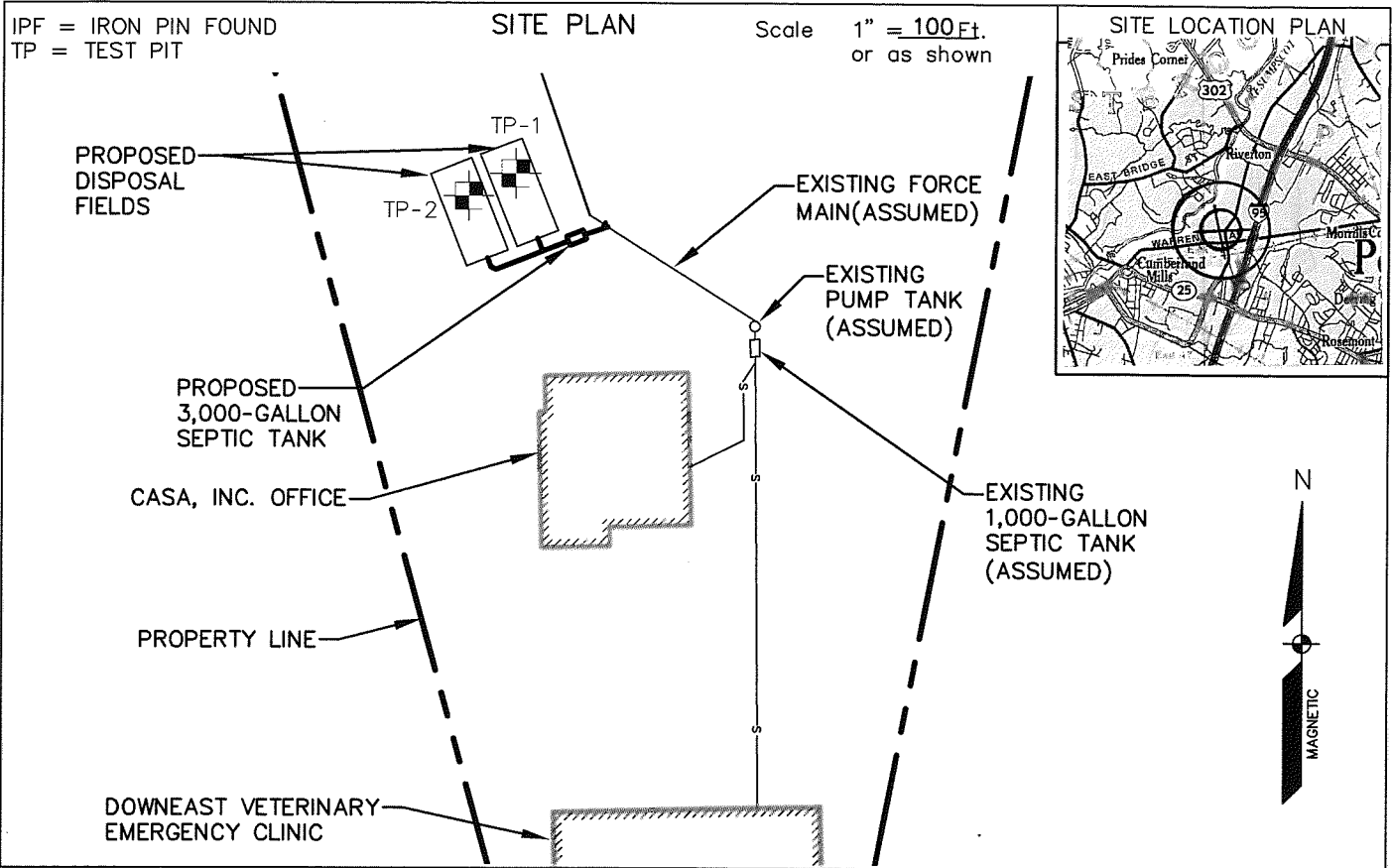

SOIL DESCRIPTION AND CLASSIFICATION				(Location of Observation Holes Shown Above)			
Observation Hole <u>TP-1</u> <input checked="" type="checkbox"/> Test pit <input type="checkbox"/> Boring 1-2 " Depth of Organic Horizon Above Mineral Soil				Observation Hole <u>TP-2</u> <input checked="" type="checkbox"/> Test pit <input type="checkbox"/> Boring 1-2 " Depth of Organic Horizon Above Mineral Soil			
Texture	Consistency	Color	Mottling	Texture	Consistency	Color	Mottling
0	FRIABLE	BROWN		0	FRIABLE	BROWN	
10		OLIVE BROWN		10			
20	FIRM	OLIVE GRAY	FINE, FEW, FAINT	20	FIRM	OLIVE GRAY	FINE, FEW, FAINT
30				30			
40				40			
50				50			
LIMIT OF EXCAVATION = 30"				LIMIT OF EXCAVATION = 30"			
Soil Classification <u>8</u> Profile	Slope <u>3-8</u> %	Limiting Factor <u>16</u> "	<input type="checkbox"/> Ground Water <input type="checkbox"/> Restrictive Layer <input type="checkbox"/> Bedrock <input type="checkbox"/> Pit Depth	Soil Classification <u>8</u> Profile	Slope <u>3-8</u> %	Limiting Factor <u>20</u> "	<input type="checkbox"/> Ground Water <input type="checkbox"/> Restrictive Layer <input type="checkbox"/> Bedrock <input type="checkbox"/> Pit Depth

Site Evaluator Signature

355
SE #

9-18-17
Date

Page 2 of 3
HHE-200 Rev. 02/11