

LEGEND

EXISTING	DESCRIPTION	PROPOSED	EXISTING	DESCRIPTION	PROPOSED
---	BOUNDARY LINE/ROW	---	W	WATER	W
---	ABUTTER LINE/ROW	---	WGV	WATER GATE VALVE	WGV
---	EASEMENT	---	WSO	WATER SHUT OFF	WSO
---	FLOODPLAIN	---	H	HYDRANT	H
---	TEST PIT	TP-1	SD	STORM DRAIN	SD
---	BUILDING	---	UD	UNDERDRAIN	UD
---	WETLANDS	---	CB	CATCH BASIN	CB
---	EDGE WETLAND	---	DMH	DRAINAGE MH	DMH
---	SIGN	---	C	CULVERT	C
---	EDGE PAVEMENT	---	OHU	OVERHEAD UTILITY	OHU
---	EDGE GRAVEL	---	UGU	UNDERGROUND UTILITY	UGU
---	CURBLINE	---	TP	TRANSFORMER PAD	TP
---	EDGE WATER	---	EM	ELECTRICAL MANHOLE	EM
---	TREELINE	---	TM	TELEPHONE MANHOLE	TM
---	CONTOURS	---	LFW	LIGHT POLE/WALL	LFW
---	SPOT GRADE	+30.20	UP	UTILITY POLE	UP
---	DECIDUOUS TREE	---	G	GUY	G
---	CONIFEROUS TREE	---	FB	FILTER BARRIER	FB
---	BOLLARD	---	R	RIFRAP	R
---	GAS	---			
---	GAS GATE VALVE	---			
---	GAS METER	---			

STORM DRAIN STRUCTURE SCHEDULE

STRUCTURE	DIA.	RIM	INV. IN	INV. OUT
CB-1	4 FT.	48.10	39.20 (EXIST.)	39.10
CB-2	4 FT.	45.15	T.B.D. (6" UD)	38.12
CB-3	4 FT.	41.40	38.32	38.61
CB-4	5 FT.	41.40	42.80 (SD-4)	38.21
CB-5	5 FT.	45.50	38.00 (SD-3)	38.00
DMH-1	4 FT.	49.50	T.B.D. (EXIST.)	37.46

STORM DRAIN PIPE SCHEDULE

PIPE	DIA.	LENGTH	SLOPE
SD-1	24"	126 FT.	0.003
SD-2	30"	18 FT.	0.003
SD-3	30"	56 FT.	0.004
SD-4	18"	32 FT.	0.006
SD-5	36"	89 FT.	0.043
SD-6	36"	93 FT.	0.043
SD-7	18"	36 FT.	T.B.D.
SD-8	18"	25 FT.	0.02
SD-9	18"	25 FT.	0.02
SD-10	6"	180 FT.	0.008

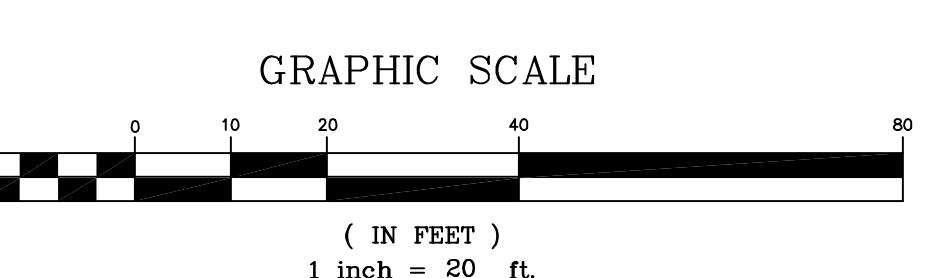
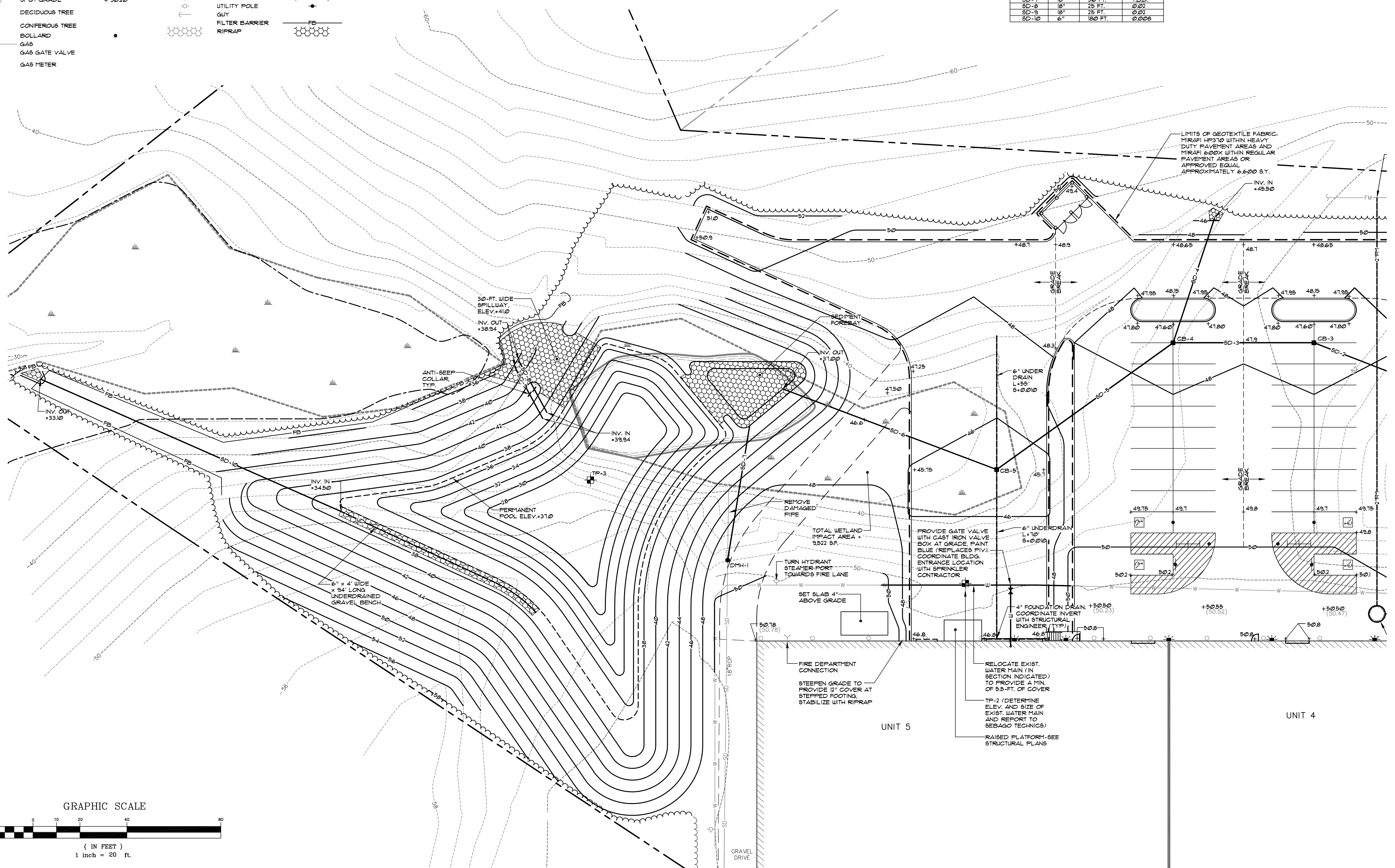
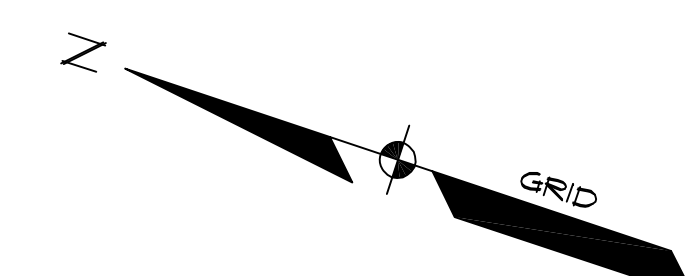

LIMITS OF GEOTEXTILE FABRIC:
MIRAFI HP310 WITHIN HEAVY
DUTY PAVEMENT AREAS AND
MIRAFI 600X WITHIN REGULAR
PAVEMENT AREAS OR
APPROXIMATELY 6.6000 S.Y.

REMOVE DAMAGED PIPE
TOTAL WETLAND IMPACT AREA = 9522 SF.
TURN HYDRANT STEAMER PORT TOWARD FIRE LANE
SET SLAB 4" ABOVE GRADE
FIRE DEPARTMENT CONNECTION
STEEPEN GRADE TO PROVIDE 12" COVER AT STEEPED FOOTING. STABILIZE WITH RIFRAP
RELOCATE EXIST. WATER MAIN (IN SECTION INDICATED) TO PROVIDE A MIN. OF 5.5-FT. OF COVER
TP-2 (DETERMINE ELEV. AND SIZE OF EXIST. WATER MAIN AND REPORT TO SEBAGO TECHNICS)
RAISED PLATFORM-SEE STRUCTURAL PLANS

WTC	REV.	DATE	BY	DESCRIPTION
WTC	05-29-13			OWNER/FIRE DEPT. REVISIONS
WTC	05-15-13			ADD STAIR @ 9 LINE & PLATFORM @ 15 LINE
RLM	05-14-13			REVISED DEMISING WALL NOTE
WTC	04-25-13			REVISED FINAL PLAN IN RESPONSE TO PLANNING COMMENTS
WTC	04-22-13			REVISED FINAL PLAN SUBMISSION TO CITY
WTC	03-07-13			ADD DOORS TO UNITS 3, 4 AND 5. ADD PUMP STATION, SEPTIC TANK
WTC	11-15-12			REVISE UNIT 5 LOADING DOCKS / BID REVISION

SEBAGO TECHNICS
 WWW.SEBAGOTECHNICS.COM
 75 John Roberts Rd., Suite 1A
 South Portland, ME 04106
 Tel: 207-262-2100
 Fax: 207-783-5888

PROJECT NO. 11270
 DESIGN: WTC
 CHECK: WTC
 DRAWN: WTC
 MAL

GRADING AND UTILITY PLAN
 OF:
765 WARREN AVENUE SITE
 WARREN AVENUE
 PORTLAND, MAINE

FOR:
BOULOS PROPERTY MANAGEMENT
 ONE CANAL PLAZA
 PORTLAND, MAINE 04101

DATE	SCALE
08-01-12	1" = 20'