

**LEGEND**

EXISTING	DESCRIPTION	PROPOSED
---	BOUNDARY LINE/ROW	---
---	ABUTTER LINE/ROW	---
---	EASEMENT	---
▨	BUILDING	▨
▨	WETLANDS	▨
▨	EDGE WETLAND	▨
---	SIGN	---
---	EDGE PAVEMENT	---
---	PAVEMENT PAINT	---
---	GRAVEL ROAD	---
---	EDGE WATER	---
---	TREELINE	---
○	DECIDUOUS TREE	○
●	BOLLARD	●

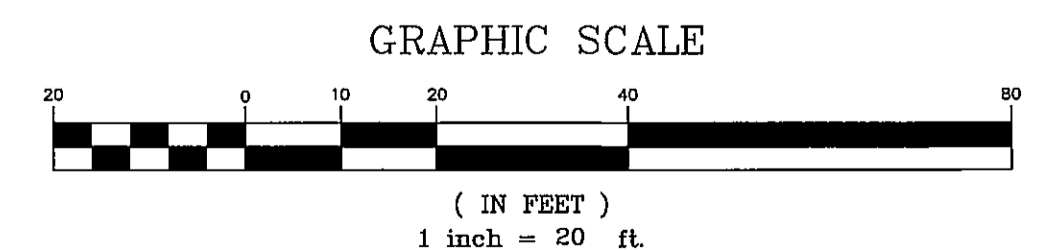
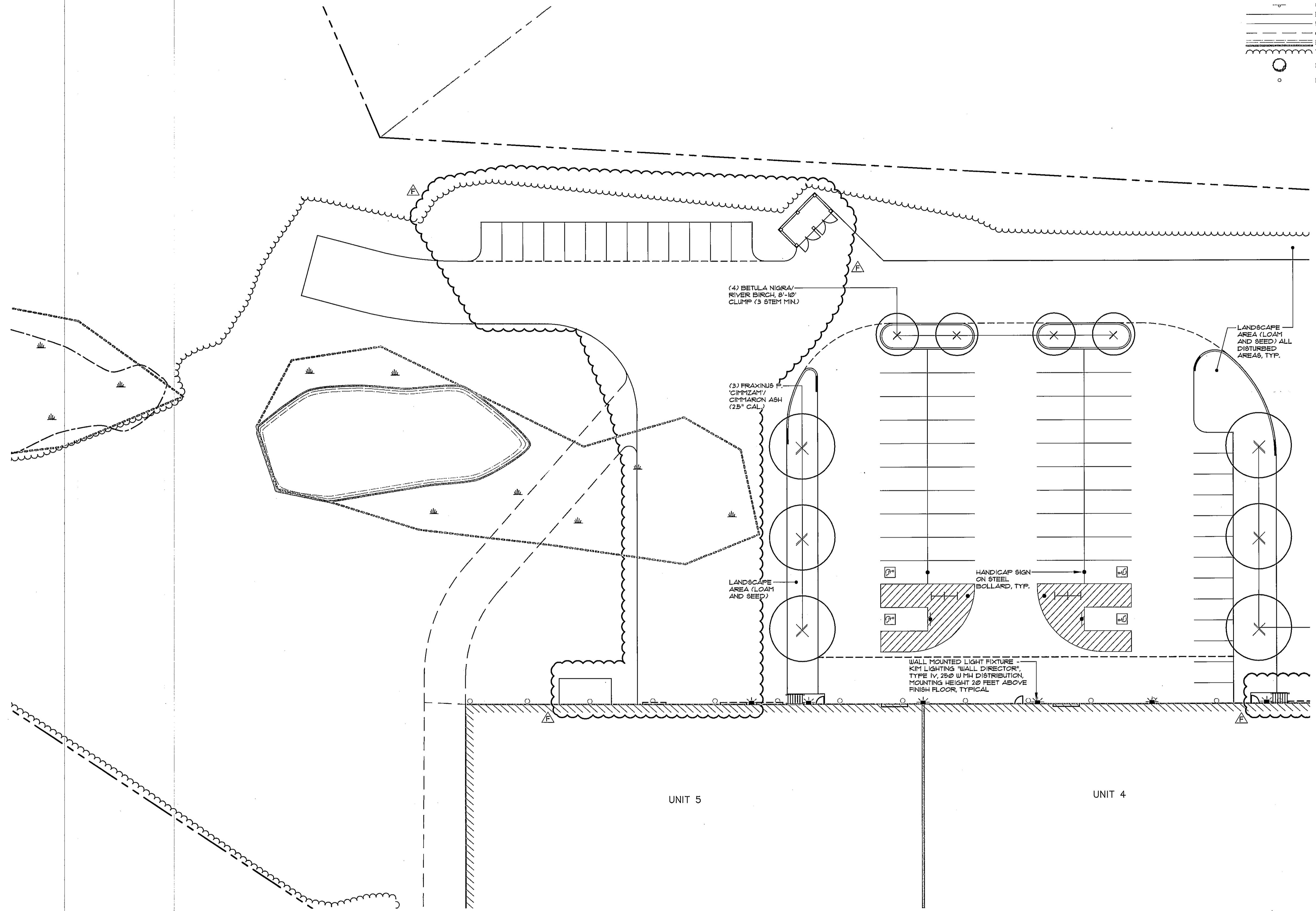

REV.	DATE	BY	DESCRIPTION
A	08-07-13	WTC	ADD DOORS TO UNITS 3, 4 AND 5, ADD PUMP STATION, SEPTIC TANK
E	11-15-12	WTC	REVISE UNIT 5 LOADING DOCKS/ BID REVISION
D	11-02-12	WTC	FINAL PLANS TO CITY
C	10-23-12	WTC	RESUBMIT TO CITY
B	10-09-12	WTC	RESUBMIT TO CITY
A	08-27-12	WTC	SITE PLAN SUBMISSION TO CITY

STATUS: **BY**

THIS PLAN SHALL NOT BE MODIFIED WITHOUT WRITTEN PERMISSION FROM SEBAGO TECHNICS, INC. ANY ALTERATIONS, AUTHORIZED OR OTHERWISE, SHALL BE AT THE USER'S SOLE RISK AND WITHOUT LIABILITY TO SEBAGO TECHNICS, INC.

**SEBAGO TECHNICS**  
 WWW.SEBAGOTECHNICS.COM  
 75 John Roberts Rd., Suite 1A  
 Scarborough, ME 04074  
 TEL: 207.200.2100 FAX: 207.285.5858

PROJECT NO. 11270

DESIGN	CHKD	DRAWN
WTC	WTC	MAL

**LANDSCAPE & LIGHTING PLAN**  
 OF:  
**765 WARREN AVENUE SITE**  
 WARREN AVENUE  
 PORTLAND, MAINE  
 FOR:  
**BOULOS PROPERTY MANAGEMENT**  
 ONE CANAL PLAZA  
 PORTLAND, MAINE 04101