

**LEGEND**

EXISTING	DESCRIPTION	PROPOSED
---	BOUNDARY LINE/ROLL	---
---	ABUTTER LINE/ROLL	---
---	EASEMENT	---
⊙	IRON PIPE/ROD	---
▭	BUILDING	▭
▭	WETLANDS	▭
---	EDGE WETLAND SIGN	---
▭	PARKING LOT PAVING	▭
▭	HEAVY DUTY PAVING	▭
▭	PAVEMENT PAINT	▭
---	GRAVEL ROAD	---
---	EDGE WATER	---
---	TREELINE	---
⊙	DECIDUOUS TREE	⊙
⊙	BOLLARD	⊙
⊙	GAS	⊙
⊙	WATER	⊙
⊙	WATER SHUT OFF	⊙
⊙	HYDRANT	⊙
⊙	CATCH BASIN	⊙
⊙	OVERHEAD UTILITY	⊙
⊙	UNDERGROUND UTILITY	⊙

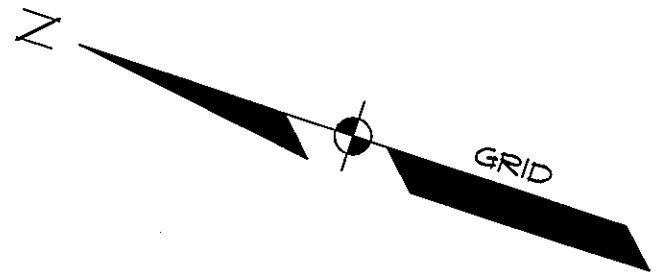

**NOTES:**

1. NEW LOADING DOCK.
2. NEW OVERHEAD DOOR.
3. NEW MAN DOOR.
4. EXISTING MAN DOOR TO REMAIN.
5. EXISTING MAN DOOR TO BE REMOVED.
6. SPRINKLER RISER TO BE RELOCATED.
7. ROOF DOWNSPOUT TO BE RELOCATED.
8. EXTEND ROOF DOWNSPOUT TO NEW LOWERED GRADE.
9. SPRINKLER RISER TO REMAIN.
10. PRE-CAST STAIR
11. BIKE RACK-DERO DOWNTOWN RACK- FREESTANDING (EACH RACK FITS 6 BIKES)

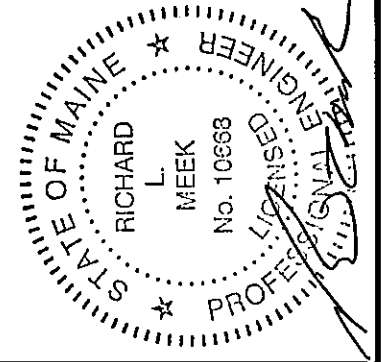
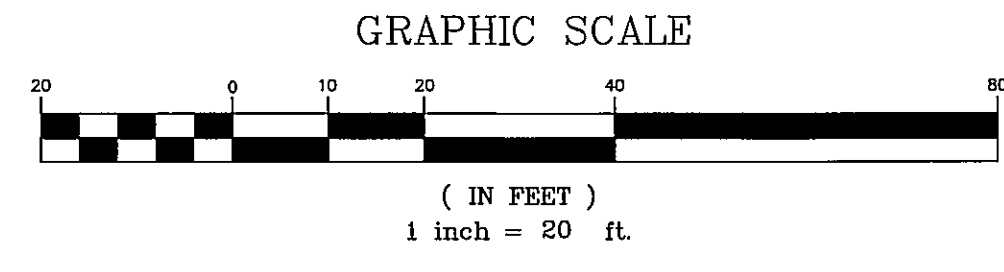
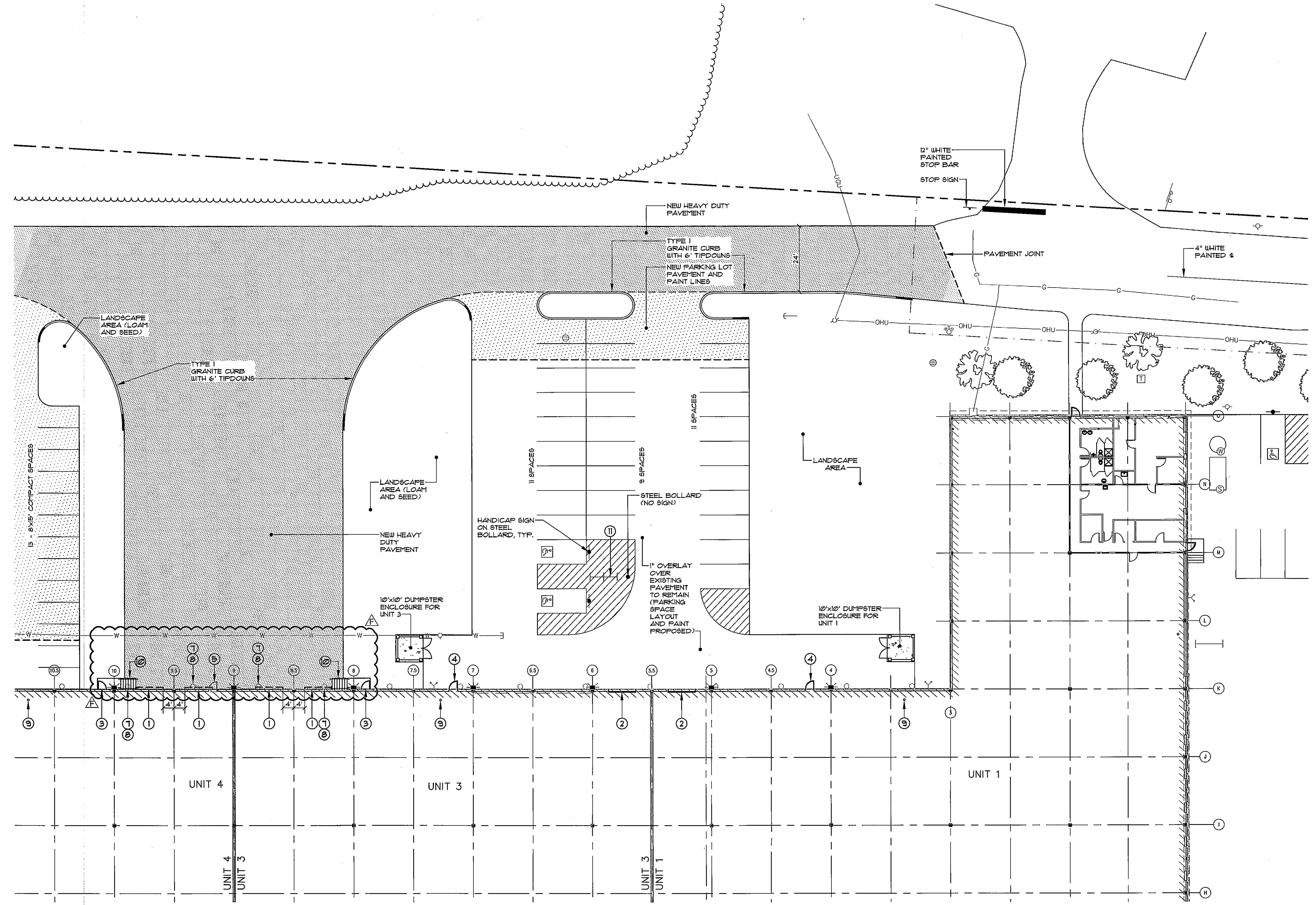

REV.	DATE	BY	DESCRIPTION
A	09-07-13	WTC	ADD DOORS TO UNITS 3, 4 AND 5, ADD PUMP STATION, SEPTIC TANK
E	11-15-12	WTC	REVISE UNIT 5 LOADING DOCKS/ BID REVISION
D	11-02-12	WTC	FINAL PLANS TO CITY
C	10-23-12	WTC	RESUBMIT TO CITY
B	10-09-12	WTC	RESUBMIT TO CITY
A	08-27-12	WTC	SITE PLAN SUBMISSION TO CITY

STATUS:   
 THIS PLAN SHALL NOT BE MODIFIED WITHOUT WRITTEN PERMISSION FROM SEBAGO TECHNICS, INC. ANY ALTERATIONS, AUTHORIZED OR OTHERWISE, SHALL BE AT THE USER'S SOLE RISK AND WITHOUT LIABILITY TO SEBAGO TECHNICS, INC.

**SEBAGO**  
TECHNICS

WWW.SEAGOTECHNICS.COM  
 75 John Roberts Rd., Suite 1A  
 Scarborough, ME 04076  
 Tel: 207-783-5656

PROJECT NO:	11270
FIELD BOOK	DESIGN
CHKD	WTC
DRAWN	MAL

**SITE PLAN**  
 OF: **765 WARREN AVENUE SITE**  
 WARREN AVENUE  
 PORTLAND, MAINE  
 FOR: **BOULOS PROPERTY MANAGEMENT**  
 ONE CANAL PLAZA  
 PORTLAND, MAINE 04101

DATE	SCALE
08-01-12	1" = 20'