

DISPLAY THIS CARD ON PRINCIPAL FRONTAGE OF WORK CITY OF PORTLAND

Please Read
Application And
Notes, If Any,
Attached

BUILDING & INSPECTION

PERMIT

Permit Number: 091438

This is to certify that CHASE JACK & LEIGH PARTNER-CHASE LLC/NeoKraft Signs

has permission to Replacement Pylon Sign "Aromaspe's"

AT 519 WARREN AVE CB# 314 B047001

provided that the person or persons, firm or corporation accepting this permit shall comply with all of the provisions of the Statutes of Maine and of the Ordinances of the City of Portland regulating the construction, maintenance and use of buildings and structures, and of the application on file in this department.

Apply to Public Works for street line and grade if nature of work requires such information.

Notification of inspection must be given and written permission procured before this building or part thereof is lathed or otherwise worked-in. 24 HOURS NOTICE IS REQUIRED.

A certificate of occupancy must be procured by owner before this building or part thereof is occupied.

OTHER REQUIRED APPROVALS

Fire Dept. _____

Health Dept. _____

Appeal Board _____

Other _____

Department Name

Director Building & Inspection Services

PENALTY FOR REMOVING THIS CARD

PERMIT ISSUED

DEC 23 2009

City of Portland

City of Portland, Maine - Building or Use Permit Application

389 Congress Street, 04101 Tel: (207) 874-8703, Fax: (207) 874-8716

Permit No: 09-1438	Issue Date:	CBL: 314 B047001
-----------------------	-------------	---------------------

Location of Construction: 519 WARREN AVE	Owner Name: CHASE JACK & LEIGH PARKER-	Owner Address: 23 AUTUMN ST	Phone:
Business Name:	Contractor Name: NeoKraft Signs	Contractor Address: 686 Main St. Lewiston	Phone: 2077829654
Lessee/Buyer's Name	Phone:	Permit Type: Signs - Permanent	Zone: B-4

Past Use: Commercial "Aroma Joe's" Connected w/ permit#091273 <i>coffee - drive thru.</i>	Proposed Use: Commercial "Aroma Joe's" Connected w/ permit#091273 - Replacement Pylon Sign	Permit Fee: \$110.00	Cost of Work: \$110.00	CEO District: 5
Proposed Project Description: Replacement Pylon Sign "Aroma Joe's"		FIRE DEPT: <input type="checkbox"/> Approved <input checked="" type="checkbox"/> Denied <i>N/A</i> Signature: <i>[Signature]</i>	INSPECTION: Use Group: <i>U</i> Type: <i>Sign</i> <i>IBC 2003</i> Signature: <i>[Signature]</i>	
		PEDESTRIAN ACTIVITIES DISTRICT (P.A.D.) Action: <input type="checkbox"/> Approved <input type="checkbox"/> Approved w/Conditions <input checked="" type="checkbox"/> Denied Signature: <i>[Signature]</i> Date:		

Permit Taken By: Ldobson	Date Applied For: 12/23/2009	Zoning Approval	
-----------------------------	---------------------------------	------------------------	--

1. This permit application does not preclude the Applicant(s) from meeting applicable State and Federal Rules. 2. Building permits do not include plumbing, septic or electrical work. 3. Building permits are void if work is not started within six (6) months of the date of issuance. False information may invalidate a building permit and stop all work..	Special Zone or Reviews <input type="checkbox"/> Shoreland <input type="checkbox"/> Wetland <input type="checkbox"/> Flood Zone <input type="checkbox"/> Subdivision <input type="checkbox"/> Site Plan Maj <input type="checkbox"/> Minor <input type="checkbox"/> MM <input type="checkbox"/> <i>OK w/condition</i> Date: <i>12/23/09</i>	Zoning Appeal <input type="checkbox"/> Variance <input type="checkbox"/> Miscellaneous <input type="checkbox"/> Conditional Use <input type="checkbox"/> Interpretation <input type="checkbox"/> Approved <input type="checkbox"/> Denied Date:	Historic Preservation <input checked="" type="checkbox"/> Not in District or Landmark <input type="checkbox"/> Does Not Require Review <input type="checkbox"/> Requires Review <input type="checkbox"/> Approved <input type="checkbox"/> Approved w/Conditions <input type="checkbox"/> Denied <i>ARM</i> Date:
--	--	---	--

PERMIT ISSUED

DEC 23 2009

City of Portland

CERTIFICATION

I hereby certify that I am the owner of record of the named property, or that the proposed work is authorized by the owner of record and that I have been authorized by the owner to make this application as his authorized agent and I agree to conform to all applicable laws of this jurisdiction. In addition, if a permit for work described in the application is issued, I certify that the code official's authorized representative shall have the authority to enter all areas covered by such permit at any reasonable hour to enforce the provision of the code(s) applicable to such permit.

SIGNATURE OF APPLICANT	ADDRESS	DATE	PHONE
RESPONSIBLE PERSON IN CHARGE OF WORK, TITLE		DATE	PHONE

City of Portland, Maine - Building or Use Permit

389 Congress Street, 04101 Tel: (207) 874-8703, Fax: (207) 874-8716

Permit No: 09-1438	Date Applied For: 12/23/2009	CBL: 314 B047001
------------------------------	--	----------------------------

Location of Construction: 519 WARREN AVE	Owner Name: CHASE JACK & LEIGH PARKER-	Owner Address: 23 AUTUMN ST	Phone:
Business Name:	Contractor Name: NeoKraft Signs	Contractor Address: 686 Main St. Lewiston	Phone (207) 782-9654
Lessee/Buyer's Name	Phone:	Permit Type: Signs - Permanent	

Proposed Use: Commercial "Aroma Joe's" Connected w/ permit#091273 - Replacement Pylon Sign	Proposed Project Description: Replacement Pylon Sign "Aroma Joe's"
---	--

Dept: Zoning	Status: Approved with Conditions	Reviewer: Ann Machado	Approval Date: 12/23/2009
Note: Drive through coffee shop as use was permit #02-1210 (Bellingham Coffee Company).			Ok to Issue: <input checked="" type="checkbox"/>
1) This permit is to replace the pylon sign only. Any signs on the building will have to be permitted separately.			
Dept: Building	Status: Approved with Conditions	Reviewer: Tammy Munson	Approval Date: 12/28/2009
Note:			Ok to Issue: <input checked="" type="checkbox"/>
1) Signage Installation to comply with Chapters 31 & 32 of the IBC 2003 building code.			

PERMIT ISSUED

DEC 23 2009

City of Portland

BUILDING PERMIT INSPECTION PROCEDURES

Please call 874-8703 or 874-8693 (ONLY)

to schedule your inspections as agreed upon

Permits expire in 6 months, if the project is not started or ceases for 6 months.

The Owner or their designee is required to notify the inspections office for the following inspections and provide adequate notice. Notice must be called in 48-72 hours in advance in order to schedule an inspection:

By initializing at each inspection time, you are agreeing that you understand the inspection procedure and additional fees from a "Stop Work Order" and "Stop Work Order Release" will be incurred if the procedure is not followed as stated below.

A Pre-construction Meeting will take place upon receipt of your building permit.

 X Electrical inspection required to verify UL listing of unit.

 X Final inspection required at completion of work.

Certificate of Occupancy is not required for certain projects. Your inspector can advise you if your project requires a Certificate of Occupancy. All projects DO require a final inspection.

If any of the inspections do not occur, the project cannot go on to the next phase, REGARDLESS OF THE NOTICE OR CIRCUMSTANCES.

CERIFICATE OF OCCUPANICES MUST BE ISSUED AND PAID FOR, BEFORE THE SPACE MAY BE OCCUPIED.

Signature of Applicant/Designee

Date

Signature of Inspections Official

Date

PERMIT ISSUED

DEC 23 2009

City of Chicago

ELECTRICAL PERMIT

City of Portland, Me.



To the Chief Electrical Inspector, Portland Maine:
 The undersigned hereby applies for a permit to make electrical installations
 in accordance with the laws of Maine, the City of Portland Electrical Ordinance,
 National Electrical Code and the following specifications:

Date 12-21-09
 Permit # 2009-4775
 CBL# 314-B-47

LOCATION: 519 Warren Avenue METER MAKE & # _____
 CMP ACCOUNT # _____ OWNER Aroma Joe's Coffee LLC
 TENANT Aroma Joe's Coffee PHONE # 603-817-3110

TOTAL EACH FEE

OUTLETS	Receptacles	Switches	Smoke Detector		
				.20	
FIXTURES	Incandescent	Fluorescent	Strips	.20	
SERVICES	Overhead	Underground	TTL AMPS <800	15.00	
	Overhead	Underground	>800	25.00	
Temporary Service	Overhead	Underground	TTL AMPS	25.00	
				25.00	
METERS	(number of)			1.00	
MOTORS	(number of)			2.00	
RESID/COM	Electric units			1.00	
HEATING	oil/gas units	Interior	Exterior	5.00	
APPLIANCES	Ranges	Cook Tops	Wall Ovens	2.00	
	Insta-Hot	Water heaters	Fans	2.00	
	Dryers	Disposals	Dishwasher	2.00	
	Compactors	Spa	Washing Machine	2.00	
	Others (denote)			2.00	
MISC. (number of)	Air Cond/win			3.00	
	Air Cond/cent		Pools	10.00	
	HVAC	EMS	Thermostat	5.00	
	1. Signs			10.00	\$70.00
	Alarms/res			5.00	
	Alarms/com			15.00	
	Heavy Duty (CR)			2.00	
	Circus/Carnv			25.00	
	Alterations			5.00	
	Fire Repairs			15.00	
	E Lights			1.00	
	E Generators			20.00	
PANELS	Service	Remote	Main	4.00	
TRANSFORMER	0-25 Kva			5.00	
	25-200 Kva			8.00	
	Over 200 Kva			10.00	
			TOTAL AMOUNT DUE		\$55.00
			MINIMUM FEE	45.00	
	MINIMUM FEE/COMMERCIAL 55.00				

RECEIVED

Dept. of Building Inspections
 City of Portland Maine

CONTRACTORS NAME Neokraft Signs Inc. MASTER LIC. # MC160016882
 ADDRESS 686 Main St., Lewiston, ME 04240 LIMITED LIC. # _____
 TELEPHONE 782-9654

SIGNATURE OF CONTRACTOR [Signature] Shane Moffett - Neokraft Signs Inc.
 White Copy - Office • Yellow Copy - Applicant



Signage/Awning Permit Application

If you or the property owner owes real estate or personal property taxes or user charges on any property within the City, payment arrangements must be made before permits of any kind are accepted.

Location/Address of Construction: <u>519 Warren Avenue</u>		
Tax Assessor's Chart, Block & Lot Chart# <u>314</u> Block# <u>B</u> Lot# <u>47</u>	Owner: <u>Aroma Joe's Coffee LLC</u> <u>63 Broadway</u> <u>Dover, NH 03820</u>	Telephone: <u>603-817-3110</u>
Lessee/Buyer's Name (If Applicable) <u>Aroma Joe's Coffee</u>	Contractor name, address & telephone: <u>Neokraft Signs Inc.</u> <u>686 Main St.</u> <u>Lewiston, ME 04240</u> <u>782-9654</u>	Total s.f. of signage x \$2.00 Per s.f. plus \$30.00/\$65.00 For H.D. signage= Total Fee: \$ <u>110.00</u> <u>40' sq. ft.</u> Awning Fee= cost of work Total Fee: \$ <u>110.00</u>
Who should we contact when the permit is ready: <u>Shane Moffett</u> phone: <u>782-9654</u>		
Tenant/allocated building space frontage (feet): Length: _____ Height: _____ Lot Frontage (feet) _____ Single Tenant or Multi Tenant Lot <u>single</u> } <u>see attached plot plan</u>		
Current Specific use: <u>coffee shop</u> If vacant, what was prior use: _____ Proposed Use: <u>coffee shop</u>		
Information on proposed sign(s): Freestanding (e.g., pole) sign? Yes <input checked="" type="checkbox"/> No _____ Dimensions proposed: <u>5'0" x 8'0"</u> Height from grade: <u>14'6"</u> Bldg. wall sign? (attached to bldg) Yes _____ No _____ Dimensions proposed: _____		
Proposed awning? Yes _____ No <input checked="" type="checkbox"/> Is awning backlit? Yes _____ No _____ Height of awning: _____ Length of awning: _____ Depth: _____ Is there any communication, message, trademark or symbol on it? Yes _____ No _____ If yes, total s.f. of panels w/communications, message, trademark or symbol: _____ s.f.		
Information on existing and previously permitted sign(s): Freestanding (e.g., pole) sign? Yes <input checked="" type="checkbox"/> No _____ Dimensions: <u>N/A</u> Bldg. wall sign? (attached to bldg) Yes _____ No <input checked="" type="checkbox"/> Dimensions: _____ Awning? Yes _____ No <input checked="" type="checkbox"/> Sq. ft. area of awning w/communication: _____		
RECEIVED DEC 23 2009		
A site sketch and building sketch showing exactly where existing and new signage is located must be provided. Sketches and/or pictures of proposed signage and existing building are also required. Dept of Building Inspections City of Portland Maine		

Please submit all of the information outlined in the Sign/Awning Application Checklist.

Failure to do so may result in the automatic denial of your permit.

In order to be sure the City fully understands the full scope of the project, the Planning and Development Department may request additional information prior to the issuance of a permit. For further information visit us on-line at www.portlandmaine.gov, stop by the Building Inspections office, room 315 City Hall or call 874-8703.

I hereby certify that I am the Owner of record of the named property, or that the owner of record authorizes the proposed work and that I have been authorized by the owner to make this application as his/her authorized agent. I agree to conform to all applicable laws of this jurisdiction. In addition, if a permit for work described in this application is issued, I certify that the Code Official's authorized representative shall have the authority to enter all areas covered by this permit at any reasonable hour to enforce the provisions of the codes applicable to this permit.

Signature of applicant: Shane Moffett Date: 12-21-09

B-y single front This is not a permit; you may not commence ANY work until the permit is issued.
pylon sign - street frontage < 200 65' max ht - 8x5 = 40' (OK)
25' max height - 14.5' (OK)
5' setback. - side plan shows (OK)



Signage/Awning Permit Application Checklist

All of the following information is required and must be submitted. Checking off each item as you prepare your application package will ensure your package is complete and will help to expedite the permitting process.

- Certificate of Liability listing the City as additional insured if any portion of the sign abuts or encroaches on any public right of way, or can fall into any public right of way.
- Letter of permission from the owner indicating the permissions granted and the tenant/space building frontage. — *Owns property*
- A sketch plan of lot indicating location of buildings, driveways and any abutting streets or rights of way, lengths of building frontages, street frontages and all existing setbacks. Please indicate on the plan all existing and proposed signs with their dimensions and specific locations. Be sure to include distance from the ground and building façade dimensions for any signage attached to the building.
- A sketch or photo of any proposed sign(s) indicating content, dimensions, materials, source of illumination, construction method as well as specifics of installation/attachment.
- Certificate of flammability required for awning or canopy.
- A UL# is required for lighted signs at the time of final inspection.
- Pre-application questionnaire completed and attached.
- Photos of existing signage
- Details for sign fastening, attachment or mounting in the ground.

Permit fee for signage or awning-with-signage: \$30.00 plus \$2.00 per square foot of sign.

Permit fee for awning-without-signage is based on cost of work:
\$30.00 for the first \$1,000.00, \$9.00 per additional \$1,000.00 of cost.

Base application fee for any Historic District signage is \$65.00.

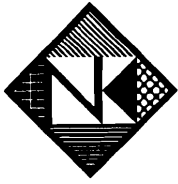

Neokraft

Neokraft Signs Inc.
 686 Main Street
 Lewiston, Maine 04240
 Telephone: 207.782.9654
 Facsimile: 207.782.0009
 1.800.339.2258
<http://www.neokraft.com>

Transmittal to CITY OF PORTLAND
 INSPECTIONS
 389 CONGRESS STREET
 PORTLAND, ME 04101

Date 12.21.2009
Job No. 11290
Re. AROMA JOE'S
 PERMITS
 MAIL

- Item**
- | | | |
|--|---|---|
| <input checked="" type="checkbox"/> Attached | <input type="checkbox"/> Hand Delivered | <input type="checkbox"/> Under separate cover |
| <input type="checkbox"/> Shop Drawings | <input type="checkbox"/> Prints | <input type="checkbox"/> Samples |
| <input type="checkbox"/> Copy of letter | <input type="checkbox"/> Change Order | <input type="checkbox"/> Other |
| | | <input type="checkbox"/> Specifications |

Copies	Date	No.	Description
1 set	12.21.2009	11290	(1) SIGN PERMIT APPLICATION, (1) ELECTRICAL PERMIT APPLICATION, MOUNTING DETAILED DRAWING, PLOT PLAN, LIABILITY INSURANCE CERTIFICATE, AND A CHECK FOR \$165.00 TO OBTAIN SIGN AND ELECTRICAL PERMITS FOR AROMA JOE'S COFFEE LOCATED ON 519 WARREN AVENUE.

- Purpose**
- | | | |
|--|---|---|
| <input checked="" type="checkbox"/> For approval | <input type="checkbox"/> No exception taken | <input type="checkbox"/> Rejected |
| <input type="checkbox"/> For your use | <input type="checkbox"/> Make corrections noted | <input type="checkbox"/> Review and comment |
| <input type="checkbox"/> As requested | <input type="checkbox"/> Revise and resubmit | <input type="checkbox"/> Other |

Remarks PLEASE REVIEW FOR APPROVAL AND MAIL PERMITS TO THIS OFFICE.

Copy to

From SHANE MOFFETT

If enclosures are not as noted kindly notify us at once.

OFFICE:\CLERICAL\TEMPLATES\TRANSMITTAL FORM.DOT

ACORD CERTIFICATE OF LIABILITY INSURANCE		OP ID NG AROMJ-1	DATE (MM/DD/YYYY) 12/16/09
PRODUCER Bernier Insurance, Inc. PO Box 1268 Rochester NH 03866-1268 Phone: 603-335-2345	THIS CERTIFICATE IS ISSUED AS A MATTER OF INFORMATION ONLY AND CONFERS NO RIGHTS UPON THE CERTIFICATE HOLDER. THIS CERTIFICATE DOES NOT AMEND, EXTEND OR ALTER THE COVERAGE AFFORDED BY THE POLICIES BELOW.		
INSURED Aroma Joe's Coffee Shoreville Plaza 113 Highland Street East Rochester NH 03868	INSURERS AFFORDING COVERAGE INSURER A: Peerless Insurance INSURER B: INSURER C: INSURER D: INSURER E:	NAIC # 24198	

COVERAGES

THE POLICIES OF INSURANCE LISTED BELOW HAVE BEEN ISSUED TO THE INSURED NAMED ABOVE FOR THE POLICY PERIOD INDICATED NOTWITHSTANDING ANY REQUIREMENT, TERM OR CONDITION OF ANY CONTRACT OR OTHER DOCUMENT WITH RESPECT TO WHICH THIS CERTIFICATE MAY BE ISSUED OR MAY PERTAIN. THE INSURANCE AFFORDED BY THE POLICIES DESCRIBED HEREIN IS SUBJECT TO ALL THE TERMS, EXCLUSIONS AND CONDITIONS OF SUCH POLICIES. AGGREGATE LIMITS SHOWN MAY HAVE BEEN REDUCED BY PAID CLAIMS.

INSR	ADD'L LTR	TYPE OF INSURANCE	POLICY NUMBER	POLICY EFFECTIVE DATE (MM/DD/YY)	POLICY EXPIRATION DATE (MM/DD/YY)	LIMITS	
A		GENERAL LIABILITY	BOP9423191	06/23/09	06/23/10	EACH OCCURRENCE	\$ 1,000,000
		<input checked="" type="checkbox"/> COMMERCIAL GENERAL LIABILITY				DAMAGE TO RENTED PREMISES (Ea occurrence)	\$ 300,000
		<input type="checkbox"/> CLAIMS MADE <input checked="" type="checkbox"/> OCCUR				MED EXP (Any one person)	\$ 15,000
						PERSONAL & ADV INJURY	\$ 1,000,000
						GENERAL AGGREGATE	\$ 2,000,000
						PRODUCTS - COMPI/OP AGG	\$ 1,000,000
						GEN'L AGGREGATE LIMIT APPLIES PER: <input type="checkbox"/> POLICY <input type="checkbox"/> PRO-JECT <input type="checkbox"/> LOC	
A		AUTOMOBILE LIABILITY	BA9792274	09/06/09	09/06/10	COMBINED SINGLE LIMIT (Ea accident)	\$ 1,000,000
		<input type="checkbox"/> ANY AUTO				BODILY INJURY (Per person)	\$
		<input checked="" type="checkbox"/> SCHEDULED AUTOS				BODILY INJURY (Per accident)	\$
		<input checked="" type="checkbox"/> HIRED AUTOS				PROPERTY DAMAGE (Per accident)	\$
		<input checked="" type="checkbox"/> NON-OWNED AUTOS					
		GARAGE LIABILITY				AUTO ONLY - EA ACCIDENT	\$
		<input type="checkbox"/> ANY AUTO				OTHER THAN EA ACC	\$
						AUTO ONLY: AGG	\$
A		EXCESS/UMBRELLA LIABILITY	CU8071482	09/06/09	09/06/10	EACH OCCURRENCE	\$ 2,000,000
		<input checked="" type="checkbox"/> OCCUR <input type="checkbox"/> CLAIMS MADE				AGGREGATE	\$ 2,000,000
		<input type="checkbox"/> DEDUCTIBLE					\$
		<input checked="" type="checkbox"/> RETENTION \$10,000					\$
A		WORKERS COMPENSATION AND EMPLOYERS' LIABILITY	WC8181772	09/06/09	09/06/10	WC STATU-TORY LIMITS	OTH-ER
		ANY PROPRIETOR/PARTNER/EXECUTIVE OFFICER/MEMBER EXCLUDED?				E.L. EACH ACCIDENT	\$ 500000
		If yes, describe under SPECIAL PROVISIONS below				E.L. DISEASE - EA EMPLOYEE	\$ 500000
		OTHER				E.L. DISEASE - POLICY LIMIT	\$ 500000

DESCRIPTION OF OPERATIONS / LOCATIONS / VEHICLES / EXCLUSIONS ADDED BY ENDORSEMENT / SPECIAL PROVISIONS
 Coffee Kiosk. Ref: application for sign permit. Certificate holder is listed as additional insured for the purpose of liability only with respect to the operations performed by the insured.

ATTN: Neokraft Signs, FAX 207-782-0009.

CERTIFICATE HOLDER CITYP-7 City of Portland ME 389 Congress St Portland ME 04101	CANCELLATION SHOULD ANY OF THE ABOVE DESCRIBED POLICIES BE CANCELLED BEFORE THE EXPIRATION DATE THEREOF, THE ISSUING INSURER WILL ENDEAVOR TO MAIL 00 DAYS WRITTEN NOTICE TO THE CERTIFICATE HOLDER NAMED TO THE LEFT, BUT FAILURE TO DO SO SHALL IMPOSE NO OBLIGATION OR LIABILITY OF ANY KIND UPON THE INSURER, ITS AGENTS OR REPRESENTATIVES. AUTHORIZED REPRESENTATIVE Nora Goodwin
---	---

NF
WARREN AVENUE REALTY TRUST
CCRD 7909-131

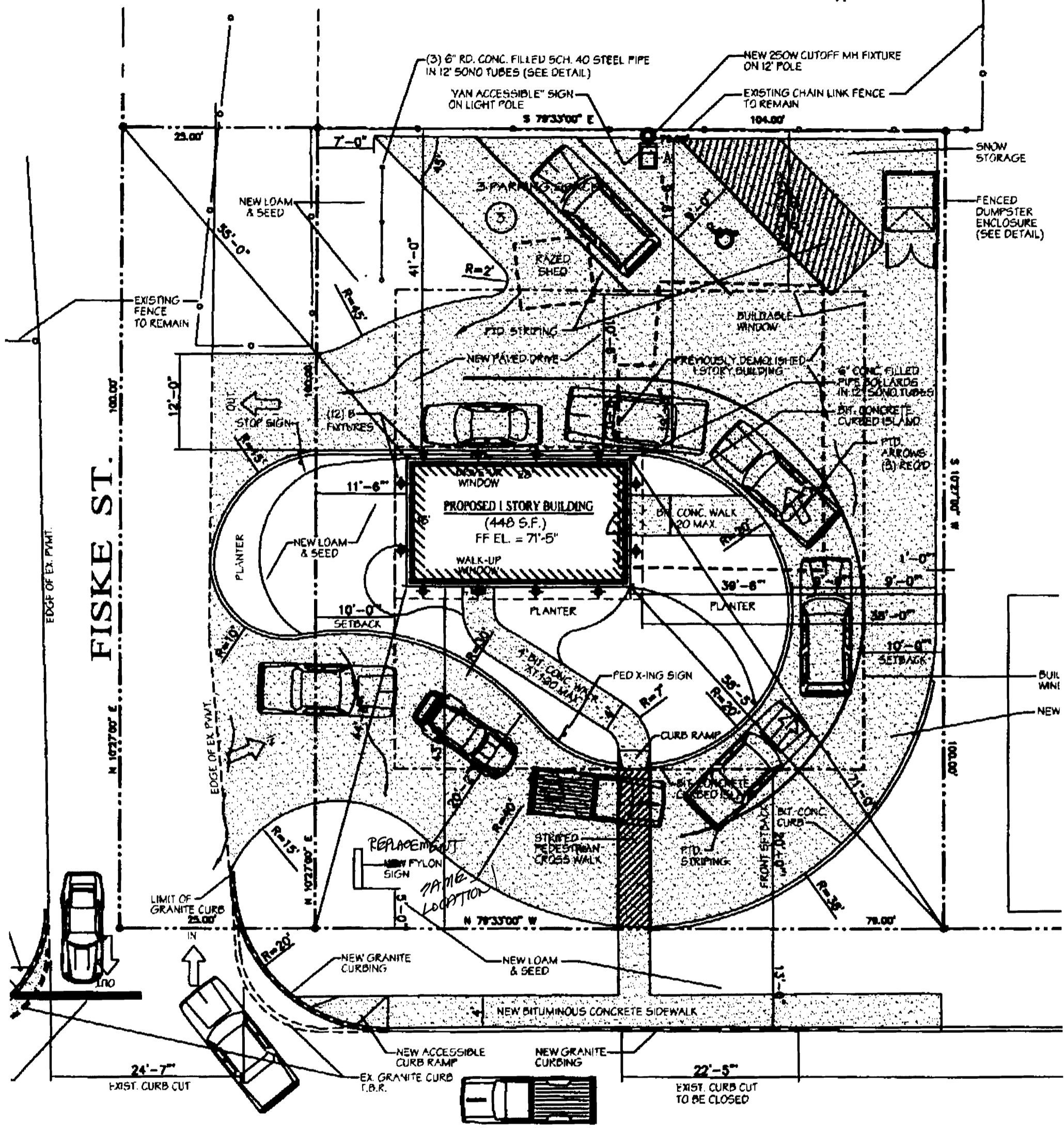

FISKE ST.

PROPOSED 1 STORY BUILDING
(448 S.F.)
FF EL. = 71'-5"

N 10737'00" E

N 7933'00" W

S 7933'00" E

S 10737'00" E

24'-7"
EXIST. CURB CUT

22'-5"
EXIST. CURB CUT
TO BE CLOSED

BUIL WINI

NEW



TOP VIEW

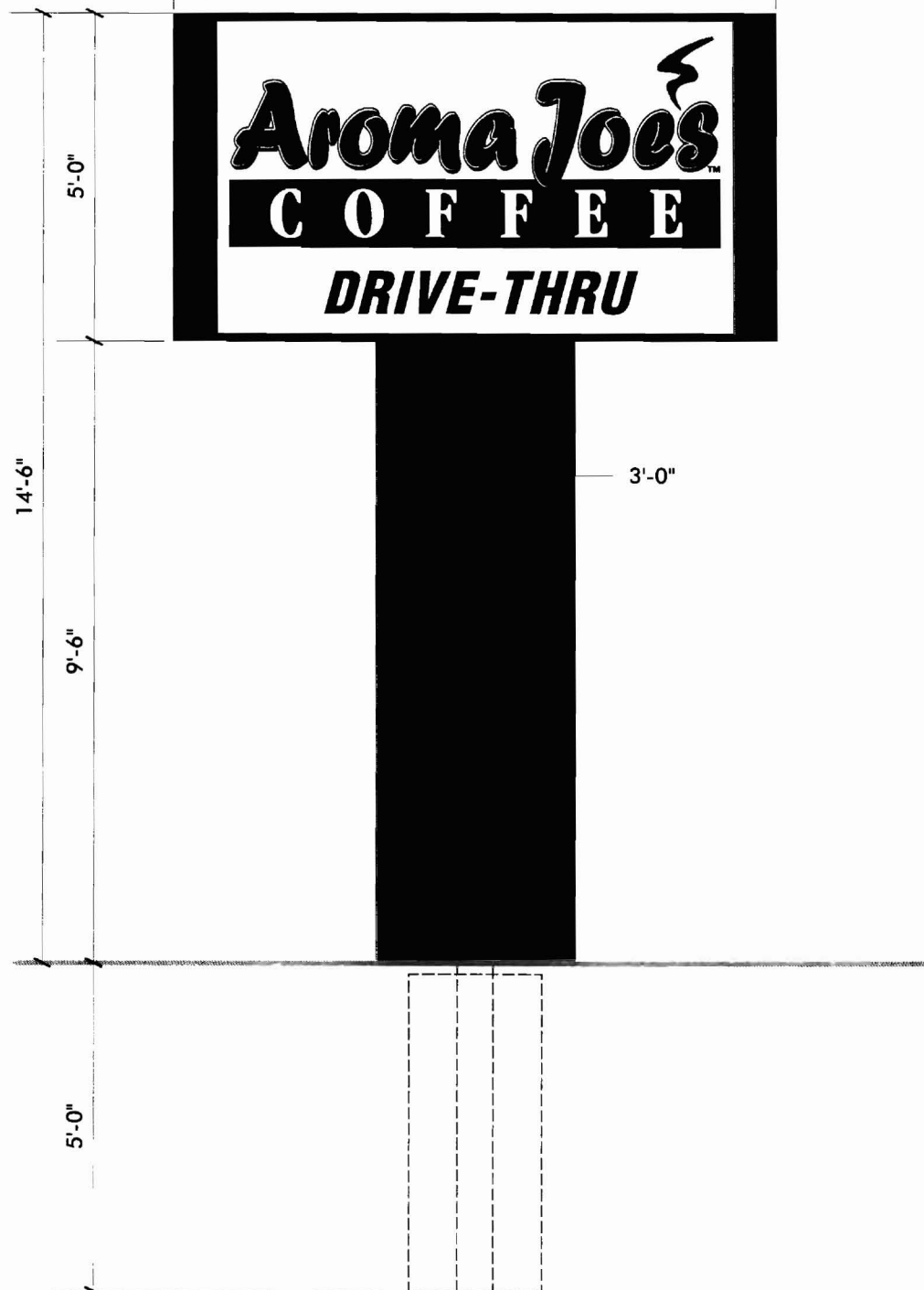
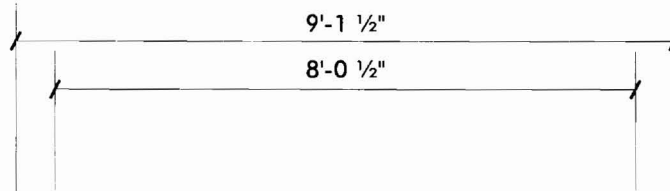

DOUBLE-FACE INTERNALLY ILLUMINATED PYLON

SCALE: 3/8"=1'-0" (1) REQUIRED

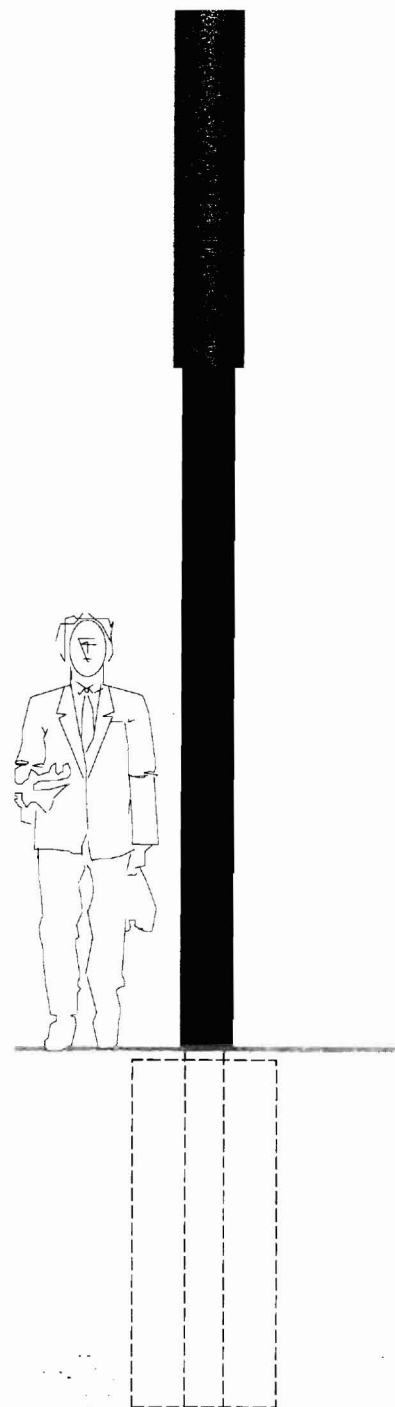

END ELEVATION

ALUMINUM EXTRUSION CABINET, RADIUS ENDS, HINGE RETAINERS, .063" BRAKE-FORMED ALUMINUM POLE COVER OVER ANGLE FRAME; PAINT ALL TO MATCH GSP DELFT BLUE TRANSL [230-97]

3/16" WHITE TRANSLUCENT LEXAN FACES; PROVIDE ADEQUATE HANGING DETAIL; TRANSLUCENT VINYL GRAPHICS:

- GSP DELFT BLUE TRANSL [230-97]
- GSP LIGHT TOMATO RED TRANSL [230-43]
- GSP LIGHT BEIGE TRANSL [230-149]
- GSP MATTE BLACK [230-22]

6" STEEL PIPE SET IN 2' DIA. CONCRETE BASE



EXISTING SIGNAGE

NO SCALE



PHOTO COMPOSITE

NO SCALE

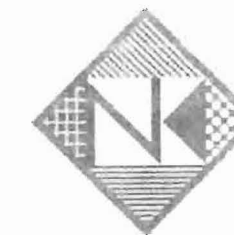

Neokraft
SIGNS

Neokraft Signs Inc.
686 Main Street
Lewiston, Maine 04240
Telephone: 207.782.9654
Facsimile: 207.782.0009
1.800.339.2258
<http://www.neokraft.com>

Custom Sign Fabrication

These plans are the exclusive property of Neokraft Signs, Inc. and are the result of the original work of its employees. They are submitted to Neokraft's client for the sole purpose of consideration of whether to purchase these plans or to purchase from Neokraft a sign manufactured according to these plans.

Distribution or exhibition of these plans to anyone other than employees of said client, or use of these plans to construct a sign similar to the one embodied herein, is expressly forbidden. In the event that such exhibition or construction occurs, Neokraft expects to be reimbursed \$1500 in compensation for time and effort entailed in creating these plans.

Aroma Joe's 11290

PERMIT	
Location:	519 Warren Ave Portland, ME
Drawing No.:	1 of 1
Drawn by:	DS Rep.: RS
Date:	12.14.2009
Revised:	12.21.2009
Lead No.:	HL012845
Gen Ref.:	(07)7788